

STATE OF ALABAMA
COUNTY OF SHELBY

AMENDMENT OF
RESTRICTIVE COVENANTS
As Recorded 07/26/2006

THIS AMENDMENT OF RESTRICTIVE COVENANTS is made this 22nd day of September 2022, by The United States Army, Corps of Engineers, Mobile District ("Corps") and Joshua and Hannah Harris ("Covenantors").

RECITALS

WHEREAS, Covenantors are the owners of a certain parcel of real property located in Shelby County, State of Alabama, (hereinafter "The Property"), and more particularly described as Shelby County Parcel Number: 13 8 34 3 002 001.000; and described in the records of the Property Tax Commissioner of Shelby County, Alabama as: "BEG NE COR NW1/4 SW1/4 SEC 34 W1327.44 S390 SE966.9 E128.73 N217.97 E415.51 N477.95 W130.09 TO POB"; and

WHEREAS, the Corps and Edwards Specialties, Inc., as a requirement of Corps Permit AL 05-02181-V, entered into a DECLARATION OF RESTRICTIVE COVENANTS (hereinafter the "DECLARATION") recorded at page # 20060726000359530 in the Records of the Judge of Probate of Shelby County, AL and recorded 07/26/2006; and

WHEREAS, The DECLARATION imposed certain restrictive covenants which protected an area of land described in that document which extends over multiple platted parcels, including a portion of the Property referenced above; and

WHEREAS the Corps has determined that the restrictions imposed by the DECLARATION, to the extent these restrictions are attached to The Property described above, no longer serve a mitigation interest and are no longer in the Public Interest.

NOW THEREFORE, in consideration of the premises and other good and valuable consideration, the Corps and Covenantor jointly AMEND the DECLARATION as follows:

1. The restrictive covenants described in the DECLARATION and imposed upon The Property are Hereby RELEASED. The area of The property released from the restrictive covenants is more particularly described in Exhibit A:
2. The restrictive covenants described in the DECLARATION and imposed upon lands outside of The Property are NOT RELEASED and remain in full force and effect.

IN WITNESS WHEREOF, the Corps and Covenantors have duly executed this Amendment of Restrictive Covenants the date written above.

Covenantors:

By:

[Signature]
Joshua Harris

By:

[Signature]
Hannah Harris

STATE OF
COUNTY OF

Alabama
Shelby

PERSONALLY appeared before me Brandy Connell, the undersigned witness, and made oath that he/she saw the within named Joshua + Hannah Harris sign, seal and as his/her/its act and deed, deliver the within named Amendment of Restrictive Covenants; and that he/she with the other witness named above witnessed the execution thereof.

[Signature]
Witness

SWORN to and subscribed before me
this 27 day of Sept, 2022

[Signature]
Notary Public

NOTARY PUBLIC FOR

State of Al.
My Commission Expires:

Feb. 4, 2026

My Commission Expires
February 4, 2026

United States Army Corps of Engineers, Mobile District:

By:

[Signature]
Leslie E. Turney
Chief, North Branch
Regulatory Division

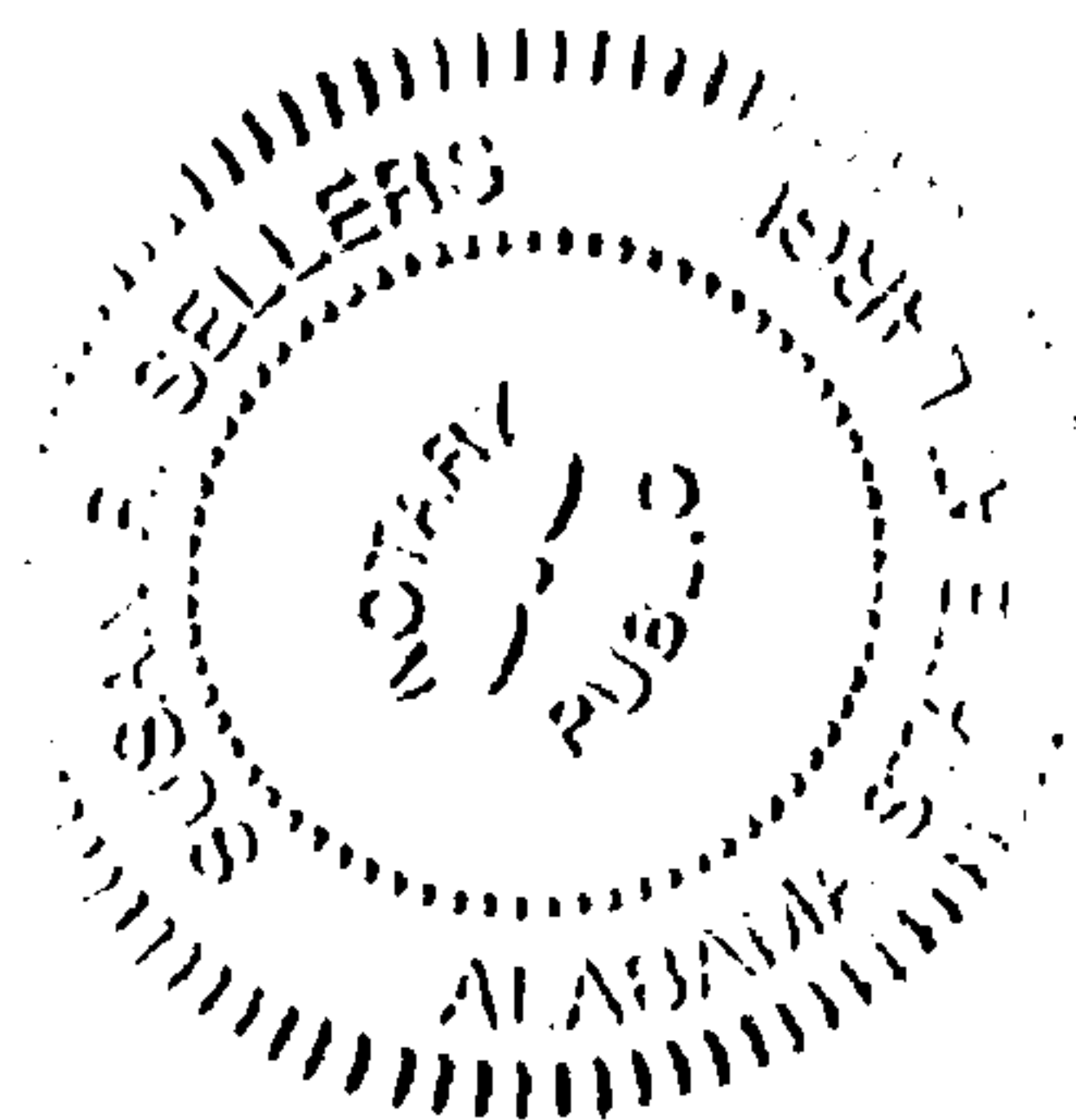

STATE OF ALABAMA
COUNTY OF JEFFERSON

PERSONALLY appeared before me Erik Schoermer, the undersigned witness, and made oath that he/she saw the within named Leslie E. Turney sign, seal and as his/her/its act and deed, deliver the within named Amendment of Restrictive Covenants; and that he/she with the other witness named above witnessed the execution thereof.

[Signature]
Witness

SWORN to and subscribed before me
this 22 day of September 2022

NOTARY PUBLIC FOR

State of Alabama At Large
My Commission Expires:

08/05/2023

[Signature]
Notary Public

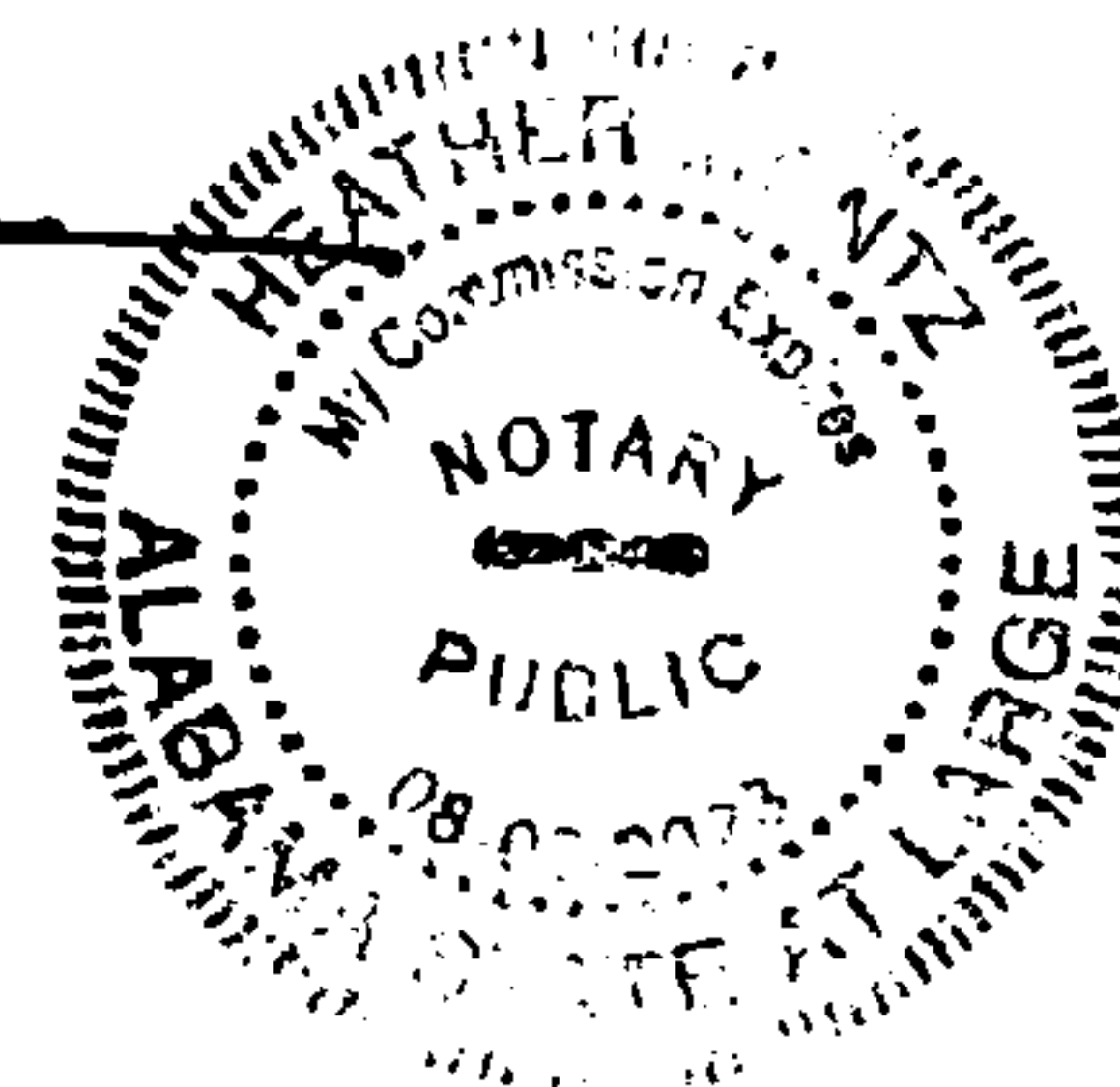
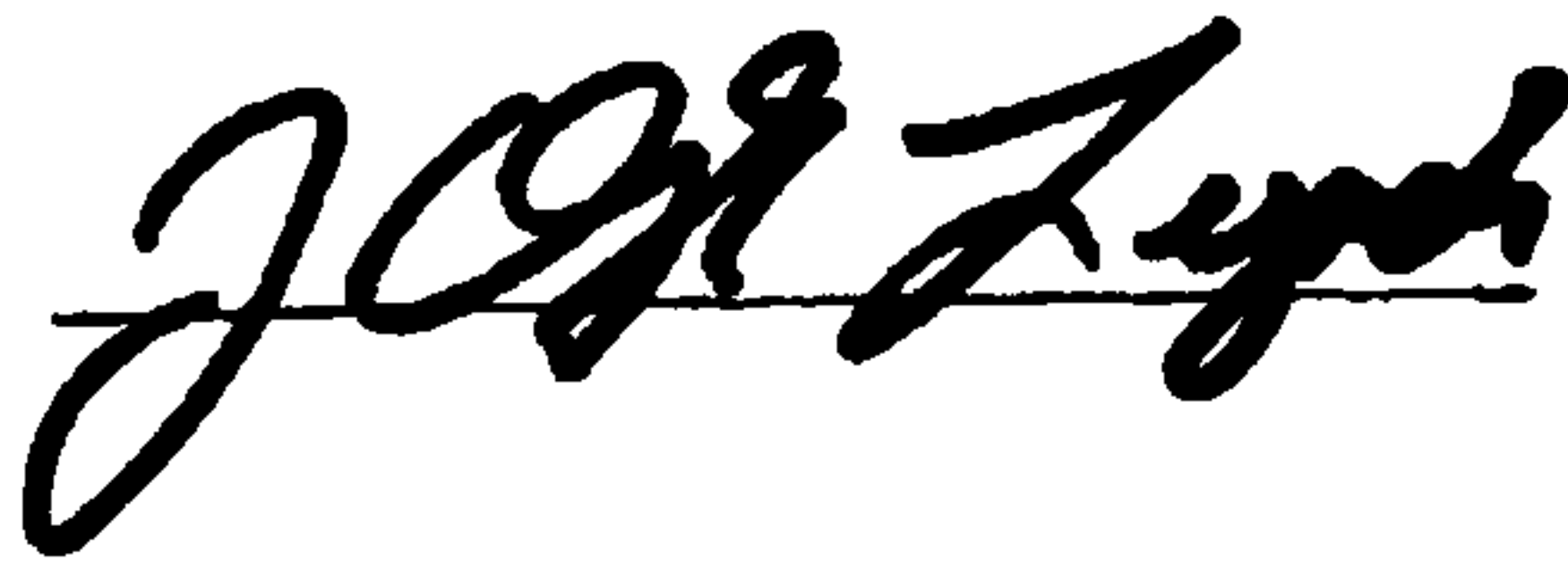
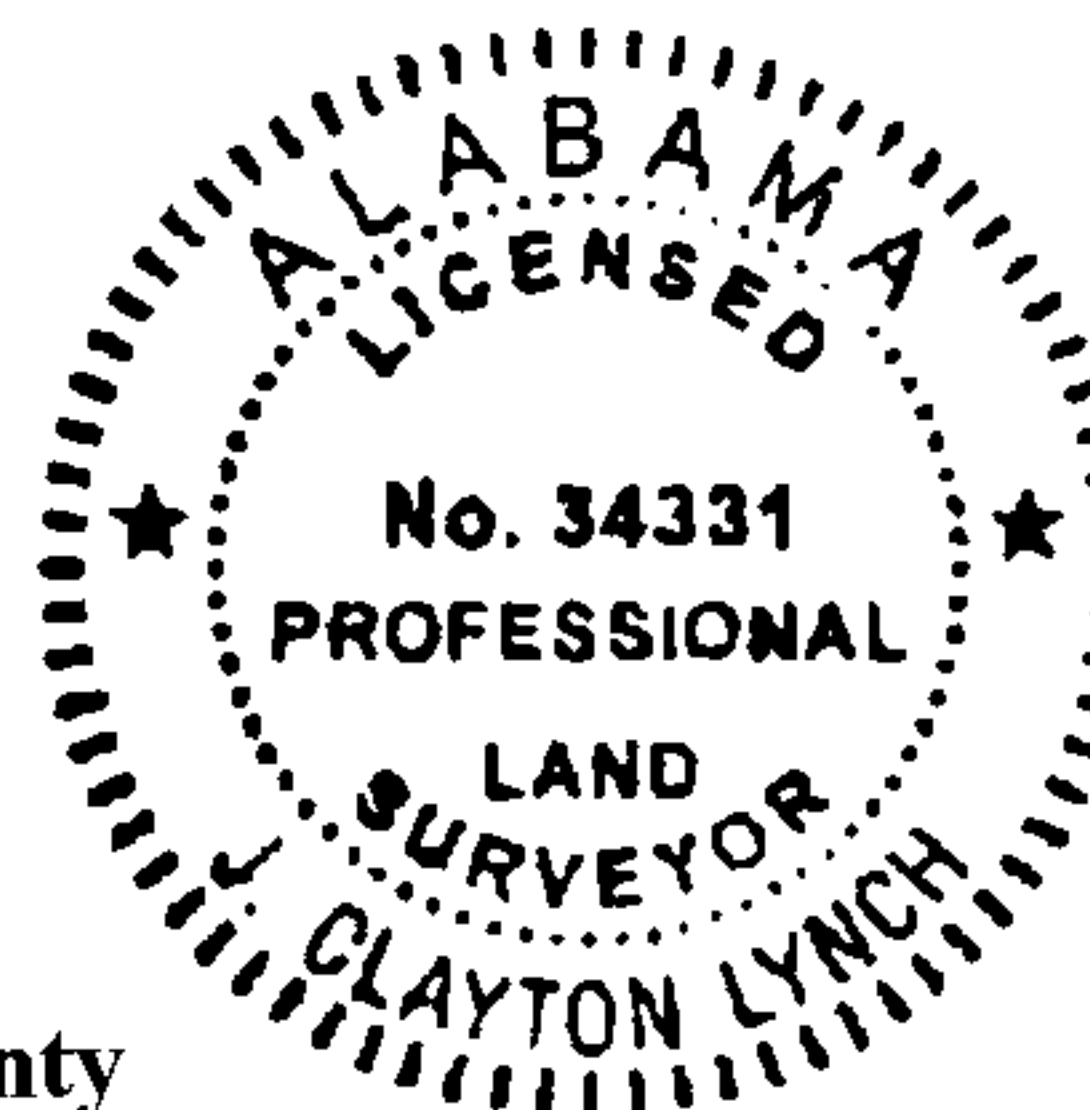

EXHIBIT A:

COMMENCING at the Northwest Corner of the Northwest Quarter of the Southwest Quarter of Section 34, Township 20 South, Range 3 West, Shelby County, Alabama, thence South 88° 38'33" East for a distance of 486.21 feet; thence South 01°21'27" West for a distance of 393.94 feet to the POINT OF BEGINNING; thence South 50°55'31" West for a distance of 141.18 feet; thence North 60°48'35" West for a distance of 23.54 feet; thence North 25°16'02" West for a distance of 37.61 feet; thence North 44°53'23" West for a distance of 23.04 feet; thence South 00°08'15" East for a distance of 69.73 feet; thence South 70°11'53" East for a distance of 286.25 feet; thence North 69°01'55" East for a distance of 47.28 feet; thence North 30°13'04" East for a distance of 29.04 feet; thence North 52°09'17" East for a distance of 22.73 feet; thence North 46° 52'14" East for a distance of 18.06 feet; thence South 79°11'50" East for a distance of 4.93 feet to a curve to the right having a radius of 455.00 feet, with a chord bearing of North 50°21'01" East and a chord length of 72.78 feet; thence along said arc, an arc length of 72.86 feet; thence North 33°13'31" West for a distance of 59.21 feet; thence North 52°46'07" East for a distance of 50.66 feet; thence North 41°35'45" East for a distance of 34.24 feet; thence North 85°27'31" East for a distance of 49.88 feet; thence South 24°20'05" East for a distance of 36.81 feet; thence South 52° 31'24" East for a distance of 13.94 feet; thence North 57°49'40" East for a distance of 26.31 feet; thence South 32°10'20" East for a distance of 62.79 feet; thence South 55°52'08" East for a distance of 7.96 feet; thence North 82°07'23" East for a distance of 55.01 feet; thence South 88° 54'14" East for a distance of 44.64 feet; thence North 61°07'02" East for a distance of 64.37 feet; thence North 56°34'43" East for a distance of 81.87 feet; thence North 81°38'18" East for a distance of 51.50 feet; thence North 80°39'18" East for a distance of 66.38 feet; thence South 83° 02'18" East for a distance of 200.98 feet; thence North 30°00'39" West for a distance of 45.45 feet; thence North 08°30'47" East for a distance of 59.42 feet; thence North 32°48'19" West for a distance of 60.50 feet; thence North 23°01'29" West for a distance of 28.96 feet; thence North 17°04'04" West for a distance of 42.41 feet; thence North 01°46'57" West for a distance of 36.55 feet; thence North 01°42'06" East for a distance of 99.20 feet; thence North 88°34'04" West for a distance of 305.84 feet; thence South 29°46'29" West for a distance of 51.18 feet; thence South 07°40'31" East for a distance of 37.99 feet; thence South 33°01'34" West for a distance of 53.15 feet; thence South 73°44'12" West for a distance of 65.22 feet; thence South 65°08'37" West for a distance of 55.16 feet; thence South 46°43'47" West for a distance of 81.34 feet; thence South 28°13'22" West for a distance of 52.89 feet; thence North 39°15'48" West for a distance of 41.36 feet; thence North 74°44'26" West for a distance of 20.67 feet; thence North 32°17'00" West for a distance of 39.24 feet; thence South 81°00'30" West for a distance of 24.89 feet; thence South 34°24'05" West for a distance of 91.69 feet; thence South 79°20'56" West for a distance of 111.34 feet; thence South 05°25'22" West for a distance of 45.74 feet; thence South 35°57'21" West for a distance of 66.90 feet; thence South 58°16'42" West for a distance of 17.27 feet; thence North 50°40'51" West for a distance of 44.76 feet to the POINT OF BEGINNING. Said Description containing 5.92 Acres, 257684 Square Feet, more or less.

Filed and Recorded
 Official Public Records
 Judge of Probate, Shelby County Alabama, County
 Clerk
 Shelby County, AL
 09/27/2022 11:30:28 AM
 \$29.00 JOANN
 20220927000370310

