



20220728000296030 1/2 \$26.00
Shelby Cnty Judge of Probate, AL
07/28/2022 02:02:32 PM FILED/CERT

Date: July 26, 2022

Re: Assessment placed on 1054 6th Ct SW, Alabaster, AL

Assessment to be released

PIN: 3 1 02 2 004 023.000

Abatement (Weeds) / Lien in the amount of \$672.03

Instrument # 20211217000598470 (Resolution 121321-B)

Assessment recorded on 12/17/21

Property Taxes Last Paid by: George Daniel Campbell

Shelby County Probate:

The City of Alabaster has received in full, payment in the amount of \$672.03 from Addhanari Lilibeth Orozco Cruz (A & LR Properties LLC) on July 13, 2022, for a lien / assessment on property located at 1054 6th Court SW in Alabaster, Alabama.

In consideration, therefore such assessment is released by the City of Alabaster.

Please contact Mark Frey, City Clerk with any questions at 205-664-6833.

M. Mark Frey

City Clerk

JMF / lg

Subscribed and sworn before me in my presence
this 26th day of July 2022
Misty Gordon a Notary Public in and for the
State of Alabama at Large
Misty Gordon
(Signature) Notary Public
My Commission Expires 11-25-23

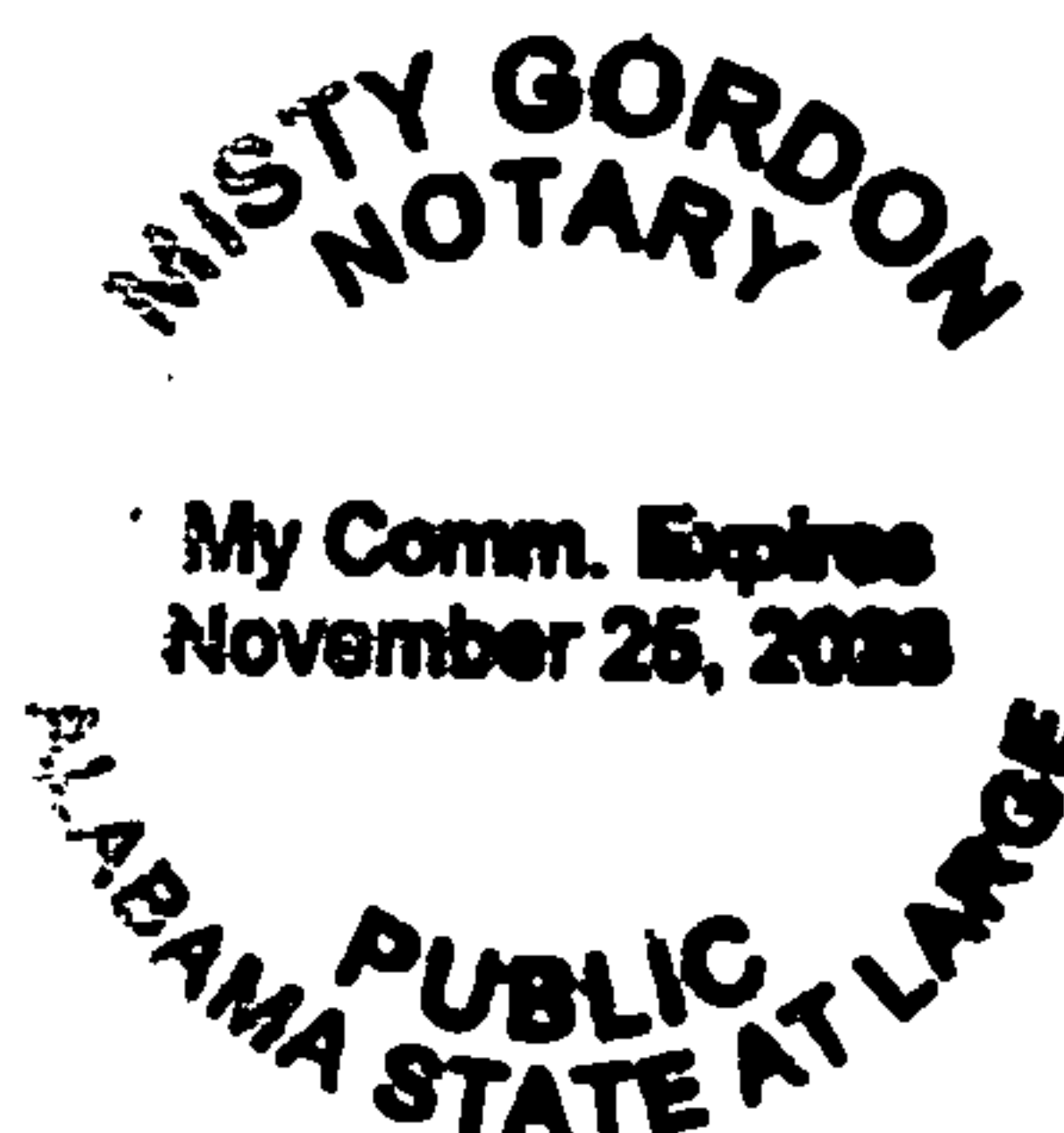

Owner Information

Tax Year: 2021
CAMPBELL GEORGE
1054 6TH CT SW
ALABASTER, AL 35007
Parcel Number: 23 1 02 2 004 023,000

Site Information

Municipal Code: 2
School District: 2
Subdivision: FALL ACRES 1ST ADDITION
Primary Lot: 6
Secondary Lot:
Block: 2
Section: 2
Township: 21S
Range: 03W
Map Book: 4
Map Page: 77
Lot Dimension 1: 106
Lot Dimension 2: 200
Acres:
Sq Ft:
Description:

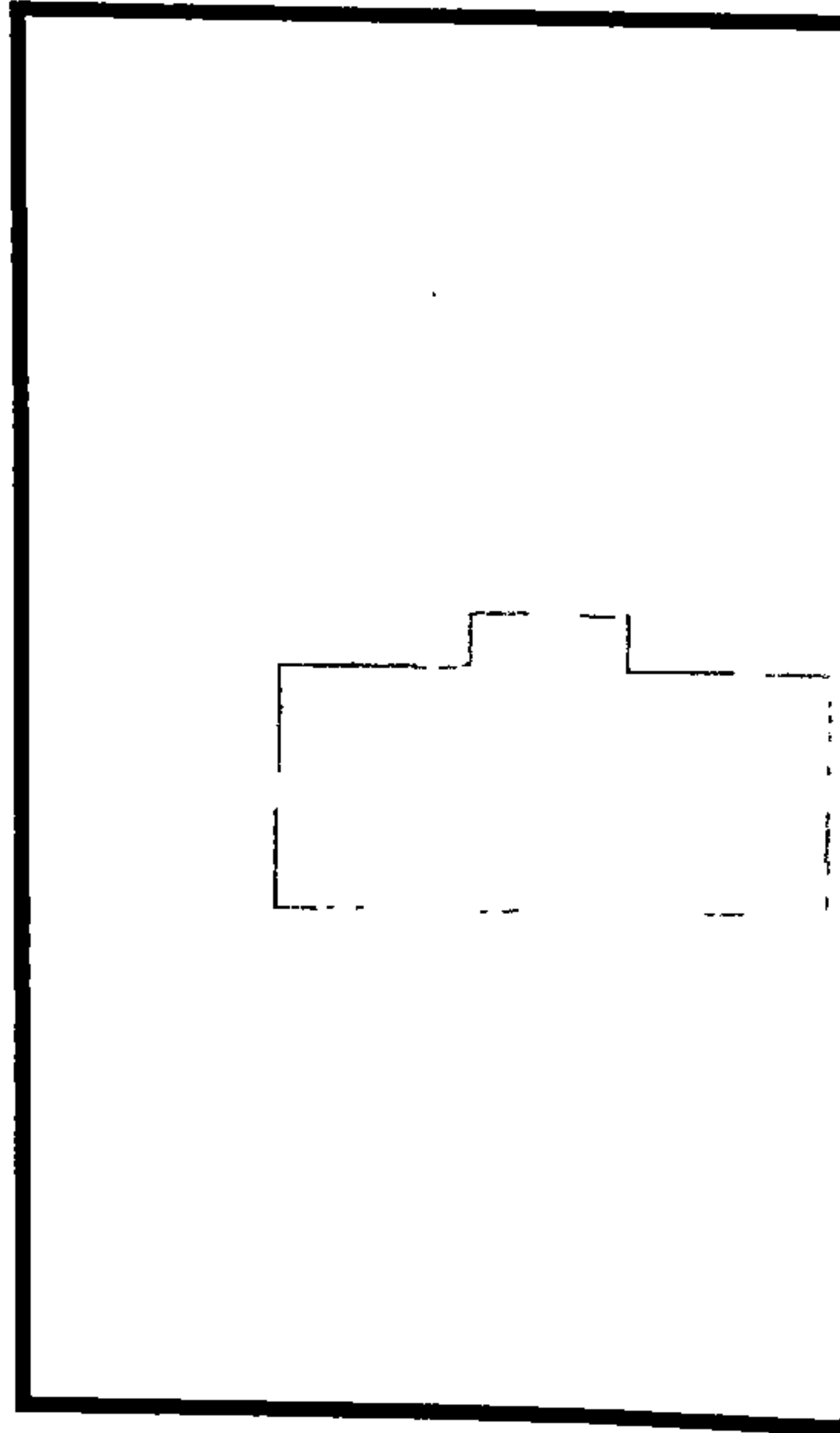

Shelby County AL, GA
POWERED BY
esri



Shelby County Land Information
Date Printed:

Use this item at your own risk. Accuracy is not guaranteed for any reason. The material and information contained in this document is provided for general information only and should not be used for Legal, Engineering or Surveying purposes. Shelby County specifically disclaims all warranties, express or implied regarding this document. Shelby County is not liable and/or responsible for the consequences caused by or related to, in any way, the actions take or not take in reliance on this document.



20220728000296030 2/2 \$26.00
Shelby Cnty Judge of Probate, AL
07/28/2022 02:02:32 PM FILED/CERT