

EASEMENT - DISTRIBUTION FACILITIES

STATE OF ALABAMA

COUNTY OF SHELBY

This instrument prepared by: S. HOPKINS

Alabama Power Company
Corporate Real Estate
2 Industrial Park Drive
Pelham, AL 35124

20191115000425520

11/15/2019 03:43:19 PM

ESMTAROW 1/3

KNOW ALL MEN BY THESE PRESENTS That the undersigned CITY OF PELHAM (hereinafter known as "Grantors", whether one or more) for and in consideration of One and No/100 Dollar (\$1.00) and other good and valuable consideration paid to Grantors in hand by Alabama Power Company, a corporation, the receipt and sufficiency of which are hereby acknowledged, do hereby grant to said Alabama Power Company, its successors and assigns (hereinafter the "Company"), the following easements, rights, and privileges:

Overhead and/or Underground. The right from time to time to construct, install, operate and maintain, upon, over, under and across the Property described below, all poles, towers, wires, conduits, fiber optics, cables, communication lines, translosures, transformers, anchors, guy wires, and other facilities useful or necessary in connection therewith (collectively, "Facilities"), for the overhead and/or underground transmission and distribution of electric power and communications, along a route selected by the Company, as determined by the location(s) in which the Company's facilities are to be installed. The width of the Company's right of way will depend on whether the Facilities are underground or overhead: for underground, the right of way will extend five (5) feet on all sides of said Facilities as and where installed; for overhead Facilities, the right of way will extend fifteen (15) feet on all sides of said Facilities as and where installed.

The Company is further granted all the rights or privileges necessary or convenient for the full enjoyment and use of said right of way for the purposes above described, including, without limitation, the right of ingress and egress to and from said Facilities, as applicable, the right to excavate for installation, replacement, repair and removal of said Facilities, the right in the future to install intermediate poles and facilities on said right of way, the right to install, maintain, and use anchors and guy wires on land adjacent to said right of way, and also the right to cut, remove, and otherwise keep clear any and all trees, undergrowth, structures, obstructions, or obstacles of whatever character, on, under and above said right of way, as applicable. Further, with respect to overhead Facilities, the Company is also granted the right to trim and cut, and keep trimmed and cut, all dead, weak, leaning or dangerous trees or limbs outside of the aforementioned right of way that, in the opinion of the Company, may now or hereafter endanger, interfere with, or fall upon any of said overhead Facilities.

The easements, rights and privileges granted hereby shall apply to, and the word "Property" as used in this instrument shall mean the real property more particularly described in that certain instrument recorded in INSTRUMENT # 20110805000230300 in the Office of the Judge of Probate of the above named County.

In the event it becomes necessary or desirable for the Company from time to time to move any of the Facilities in connection with the construction or improvement of any public road or highway in proximity to the Facilities, Grantors hereby grant to the Company the right to relocate the Facilities and, as to such relocated Facilities, to exercise the rights granted above; provided, however, the Company shall not relocate said Facilities on the Property at a distance greater than ten feet (10') outside the boundary of the right of way of any such public road or highway as established or re-established from time to time. This grant and agreement shall be binding upon and shall inure to the benefit of Grantors, the Company and each of their respective heirs, personal representatives, successors and assigns and the words "Company" and "Grantors" as used in this instrument shall be deemed to include the heirs, personal representatives, successors and assigns of such parties.

TO HAVE AND TO HOLD the same to the Company, its successors and assigns, forever.

IN WITNESS WHEREOF, the said Grantors have caused this instrument to be executed by Gary W. Waters, its authorized representative, as of the 16th of October, 2019.

ATTEST (if required) or WITNESS:

By: [Signature]
Tom Seale
Its: City Clerk/Treasurer

[Signature]
(Grantor)

By: Gary W. Waters
Its: Mayor

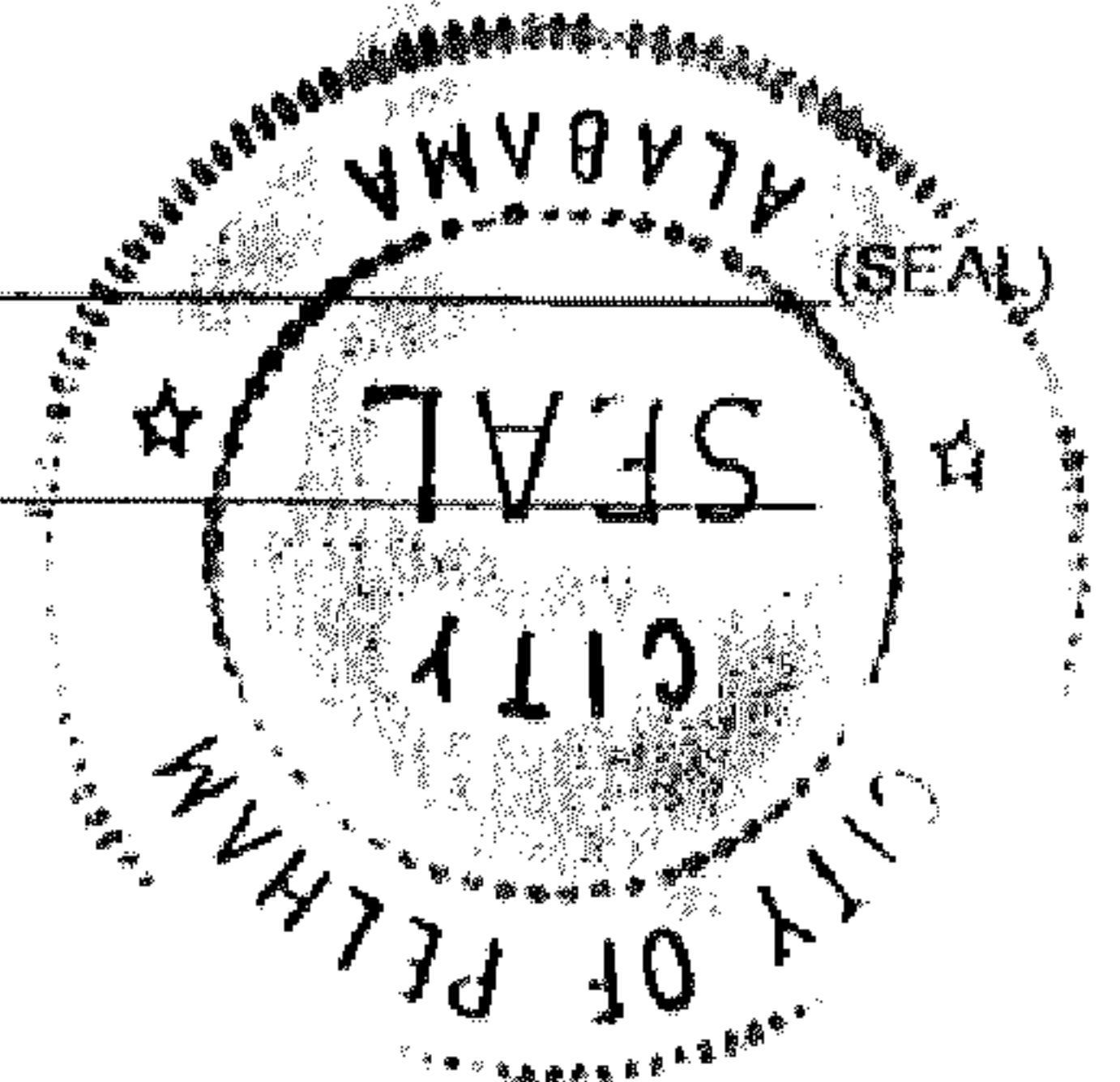

-----For Alabama Power Company Corporate Real Estate Department Use Only-----
W.E. # A6170-06-AT19 Transformer # T00CPH All facilities on Grantor: YES % 1/4 STR & LOC to LOC 20S-03W-12 NE/SW

CORPORATION NOTARY

STATE OF Alabama
COUNTY OF Shelby

I, Paula Holly, a Notary Public, in and for said County in said State,
hereby certify that Gary W. Waters, whose
name as Mayor of City of Pelham, a corporation, is signed to the foregoing instrument, and who is
known to me, acknowledged before me on this day that, being informed of the contents of this instrument, he/she, as such officer and with full authority, executed
the same voluntarily for and as the act of said Corporation.

Given under my hand and official seal, this the 16th day of October, 2019.

[SEAL]

Notary Public: Paula Holly
My commission expires: Nov. 17, 2020

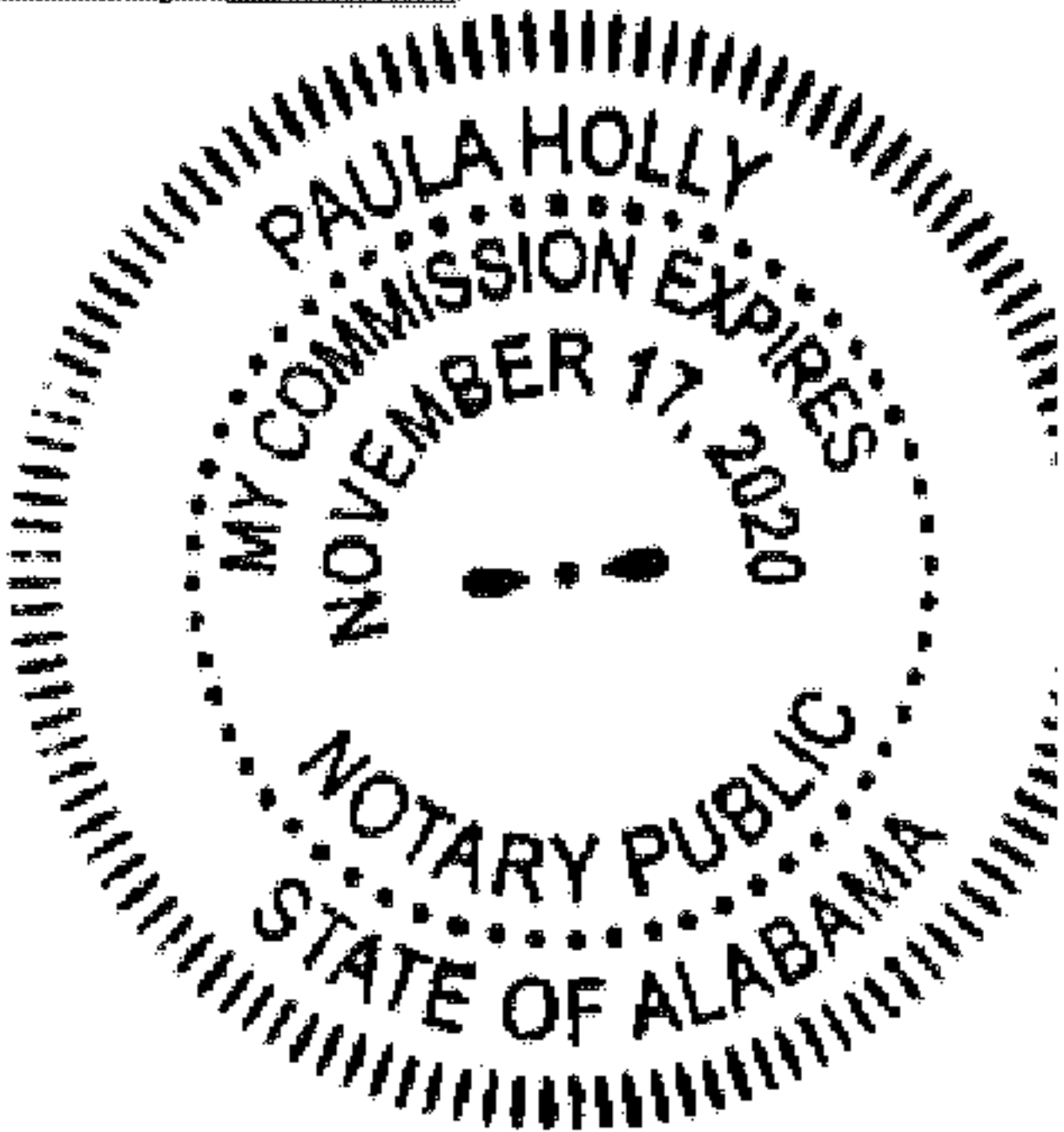

Customer	Address	Contact Info		County	Section	Twnshp	Range	Operating Voltage		Estimate / Job No.
City of Pelham	0 Pelham Park Blvd	[REDACTED]	[REDACTED]	Shelby	12	20S	03W	PRI : 12kV SEC : 120/240V	A6170-06-AT19	
Division	District	Town	Engineer	Right of Way Agent:	Tree Crew	Substation :				Call Date:
Birmingham	PD - Varmons	Pelham	[REDACTED]	Date Sent: _____ Book/Page: _____	Nikki Date Create: _____	BKR : 34636 SW : XA3563 TRF : T01AH0				
										Miss-Air : 192622369
										Water Co :
										Other :

Missall Info:
#: 192622369
Update: 10/03/19
Expires: 10/07/19

Supporting Statement:
APCO to provide 120/240V service to 12x52 all electric mobile home with window unit. APCO to install span of primary, transformer, secondary, and service.

All facilities covered by R/W acquired from:

Job:

Parcel No.

RECORD THIS DRAWING!

APCO to pull 1-1/2 & 2-4/0 UTA (50')
in customer provided 3" conduit and
trench = 42"

- 1: 10kVA 120/240V Conv. OH xfmr
- 1: 2" SVC rsef
- 1: 50' 1-1/2 & 2-4/0 UTA SVC
- 1: #6 CU Enhanced Ground
- 1: 200A Meter/Socket

Loading: 5 kVA
VD: 1.6%

GPS Coordinates:
Lat: 33.306884
Long: -86.81055

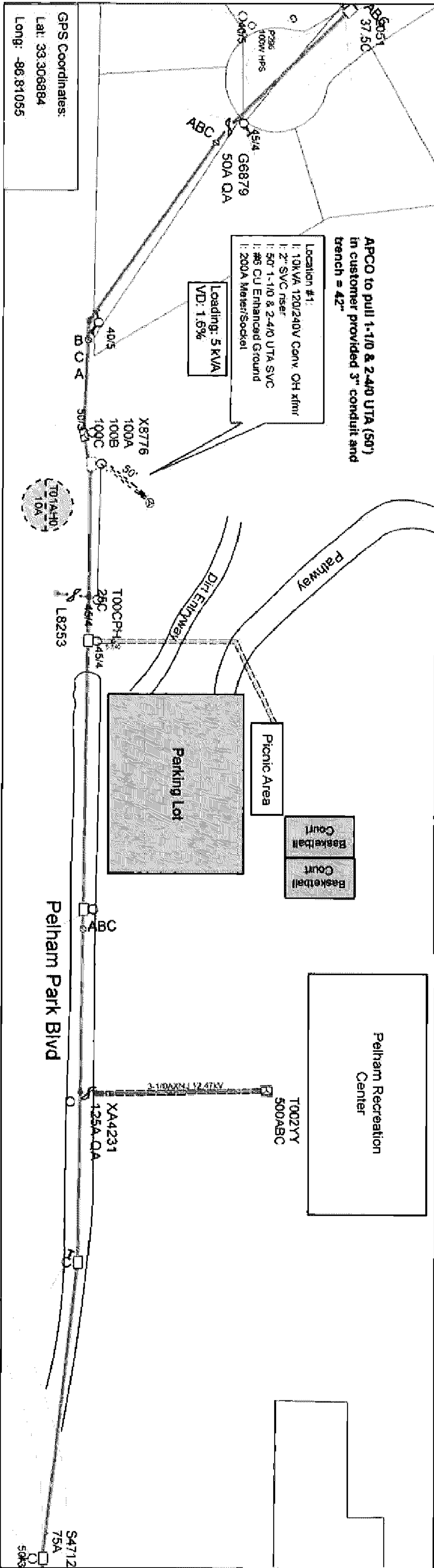
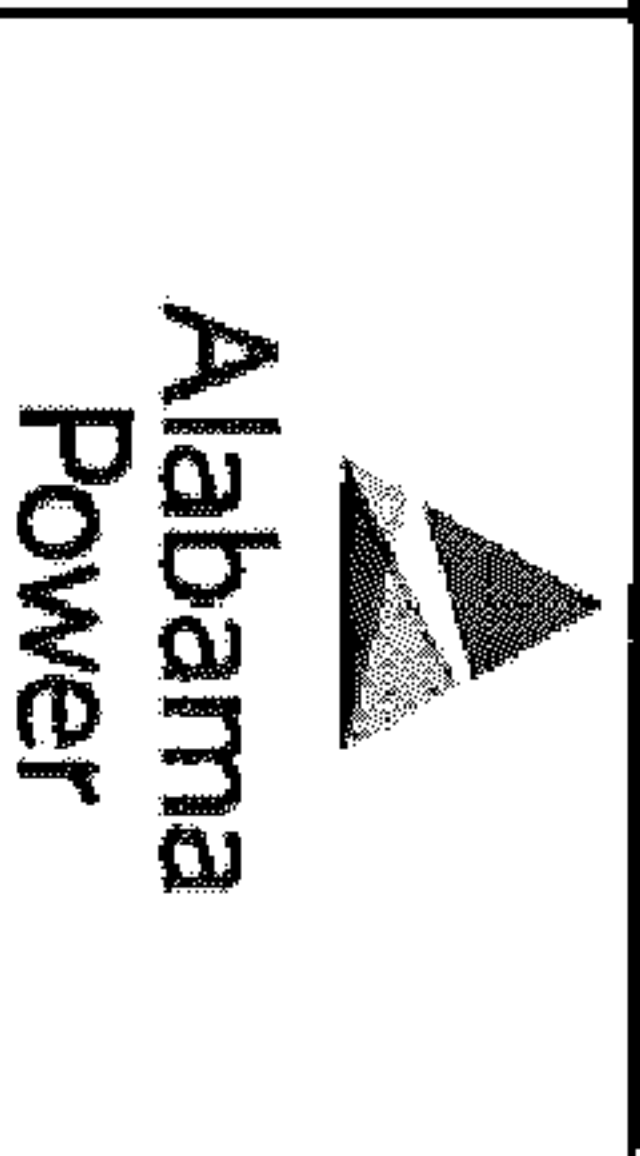
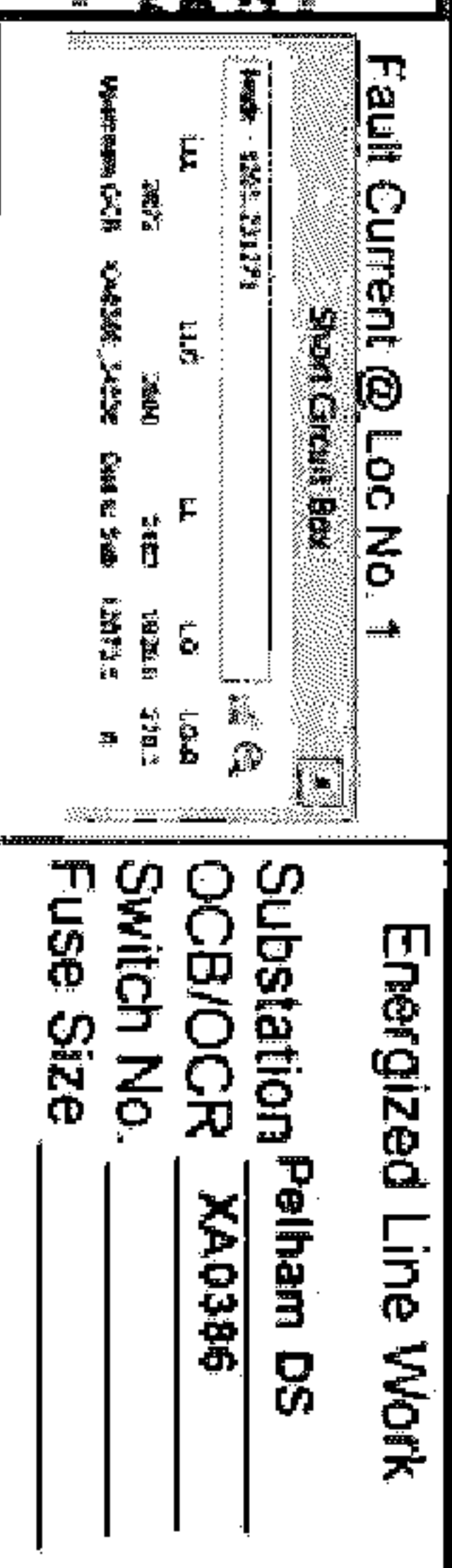
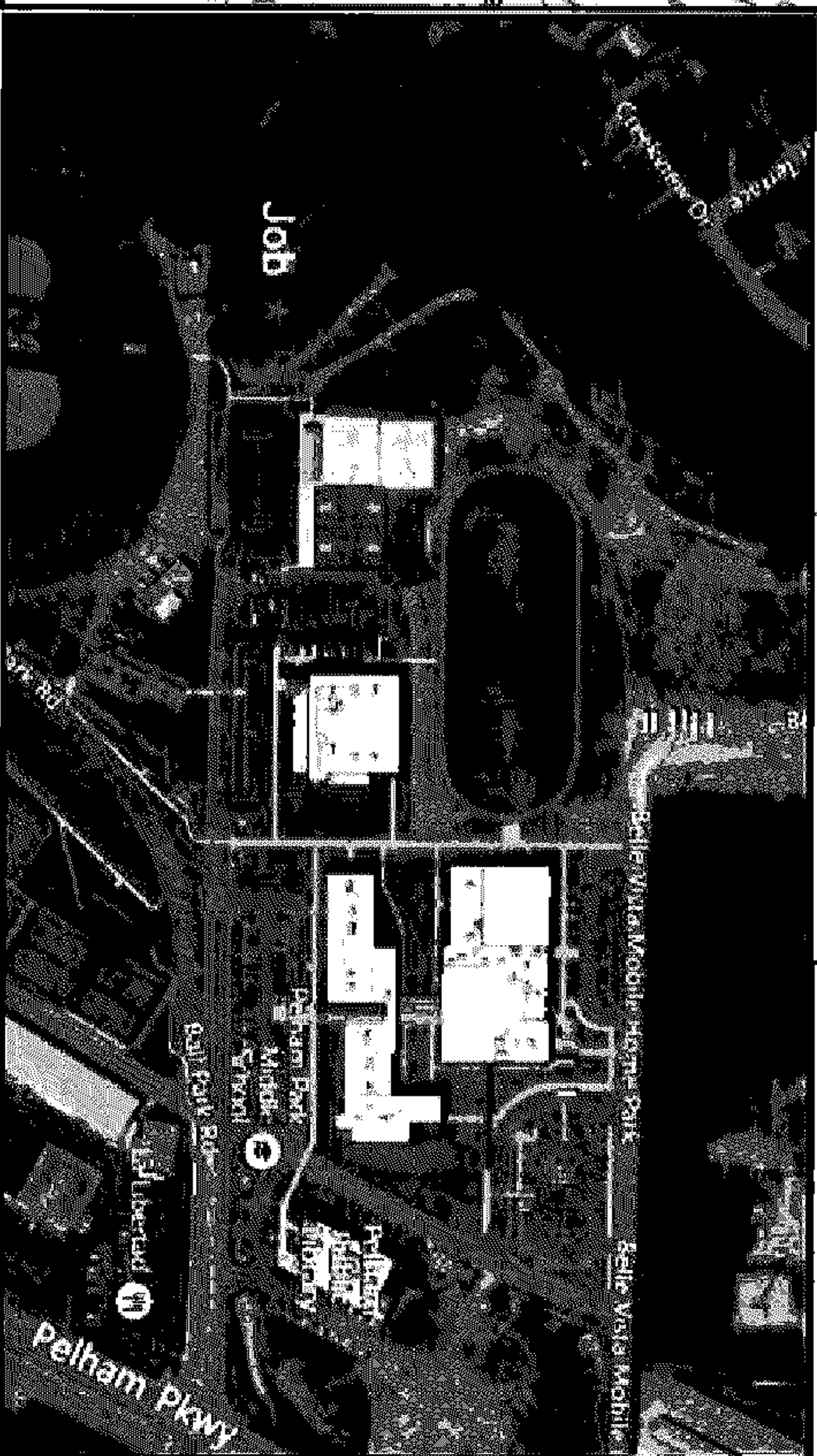
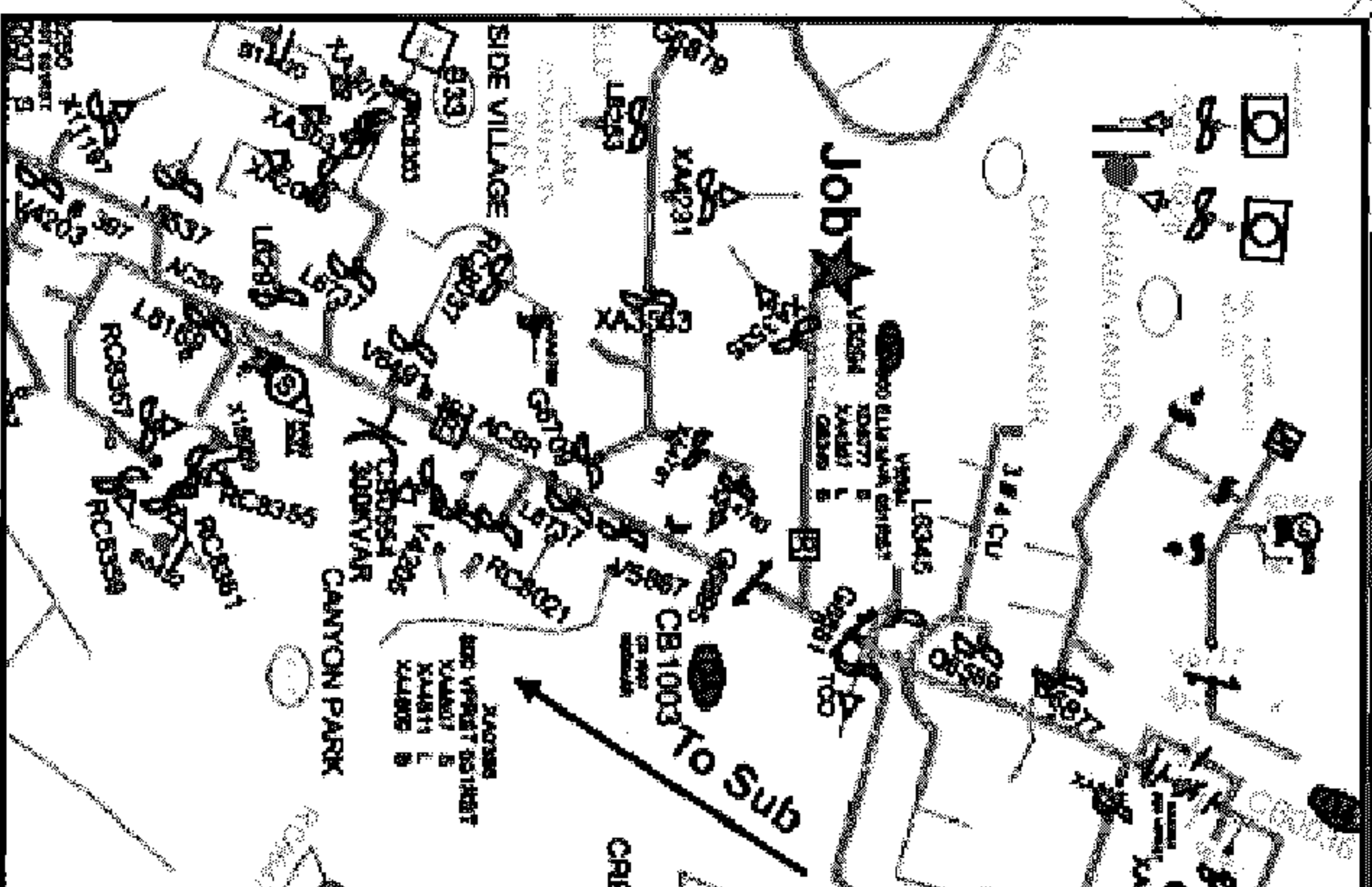

Filed and Recorded
Official Public Records
Judge of Probate, Shelby County Alabama, County
Clerk
Shelby County, AL
11/15/2019 03:43:19 PM
\$29.00 CHERRY
20191115000425520

Allie S. Beryl