

EASEMENT – UNDERGROUND

STATE OF ALABAMA

COUNTY OF **SHELBY**

This instrument prepared by: **S. HOPKINS**

Alabama Power Company
Corporate Real Estate
2 Industrial Park Drive
Pelham, AL 35124

20190905000327780

09/05/2019 02:31:21 PM

ESMTAROW 1/3

KNOW ALL MEN BY THESE PRESENTS, That the undersigned PHILLIP A HARRIS and MARY H HARRIS, husband and wife (hereinafter known as "Grantors", whether one or more) for and in consideration of One and No/100 Dollar (\$1.00) and other good and valuable consideration paid to Grantors in hand by Alabama Power Company, a corporation, the receipt and sufficiency of which are hereby acknowledged, do hereby grant to said Alabama Power Company, its successors and assigns (hereinafter the "Company"), the following easements, rights, and privileges:

The right from time to time to construct, install, operate, and maintain, upon, under, and across the Property described below, all wires, conduits, cables, trans closures, transformers, fiber optics, communication lines, and other facilities useful or necessary in connection therewith (collectively, "Facilities"), for the underground transmission and distribution of electric power and communications, along a route selected by the Company, as determined by the location(s) in which the Company's facilities are to be installed. The Company's right of way will extend five (5) feet on all sides of said Facilities as and where installed, and shall include the right to clear and keep clear said right of way.

The Company is further granted all the rights or privileges necessary or convenient for the full enjoyment and use of said right of way for the purposes above described, including, without limitation, the right of ingress and egress to and from said Facilities, as applicable, the right to excavate for installation, replacement, repair and removal of said Facilities, and also the right to cut, remove, and otherwise keep clear any and all structures, obstructions, or obstacles of whatever character, on, under, adjacent to, and above said Facilities.

The easements, rights and privileges granted hereby shall apply to, and the word "Property" as used in this instrument shall mean the real property more particularly described in that certain instrument recorded in INSTRUMENT #19990212000063111 in the Office of the Judge of Probate of the above named County.

In the event it becomes necessary or desirable for the Company from time to time to move any of the Facilities in connection with the construction or improvement of any public road or highway in proximity to the Facilities, Grantors hereby grant to the Company the right to relocate the Facilities and, as to such relocated Facilities, to exercise the rights granted above; provided, however, the Company shall not relocate said Facilities on the Property at a distance greater than ten feet (10') outside the boundary of the right of way of any such public road or highway as established or re-established from time to time. This grant and agreement shall be binding upon and shall inure to the benefit of Grantors, the Company and each of their respective heirs, personal representatives, successors and assigns and the words "Company" and "Grantors" as used in this instrument shall be deemed to include the heirs, personal representatives, successors and assigns of such parties.

TO HAVE AND TO HOLD the same to the Company, its successors and assigns, forever.

IN WITNESS WHEREOF, the undersigned Grantors have executed this instrument on this the 21 day of August, 2019.

Witness Signature (non-relative)

Print Name

Witness Signature (non-relative)

Print Name

Phillip A. Harris
(Grantor) **PHILLIP A HARRIS**

Phillip A. Harris
Print Name

Mary H. Harris
(Grantor) **MARY H HARRIS**

MARY H HARRIS
Print Name

-----For Alabama Power Company Corporate Real Estate Department Use Only-----

W.E. # A6170-00-EH19 Transformer # T01047 All facilities on Grantor: YES ¼, ¼ STR & LOC to LOC: 24N-15-02 E ½ OF SE 1/4

20190905000327780 09/05/2019 02:31:21 PM ESMTAROW 2/3

STATE OF Alabama

COUNTY OF Shelby

I, Stacey M. Padgett, a Notary Public, in and for said County in said State, hereby certify that _____

Phillip A. Harris whose name(s) [as _____] is/are signed to the foregoing instrument and who is/are known to me, acknowledged before me on this day that being informed of the contents of the instrument, he/she/they [in such capacity as aforesaid] executed the same voluntarily.

Given under my hand and official seal this the 21 day of August, 20 19.

Stacey M. Padgett
Notary Public

My commission expires: 7/23/23

STATE OF Alabama

COUNTY OF Shelby

I, Stacey M. Padgett, a Notary Public, in and for said County in said State, hereby certify that _____

Mary H. Harris whose name(s) [as _____] is/are signed to the foregoing instrument and who is/are known to me, acknowledged before me on this day that being informed of the contents of the instrument, he/she/they [in such capacity as aforesaid] executed the same voluntarily.

Given under my hand and official seal this the 21 day of August, 20 19.

Stacey M. Padgett
Notary Public

My commission expires: 7/23/23

SKETCH OF PROPOSED WORK - SIMPLIFIED W.E.

Map Center UTM: 1783073 12012458

Map Center Lat/lon: 33.090393 -86.534063

1 inch = 100 feet

Customer	Location	Cmted. Svc Date	County	Section	Township	Range	Add'l Info.	Estimate No.
PHILLIP HARRIS	170 L AND M TRACE		Shelby	2	24N	15E		A617000EH19
Division	District	Town	UserID	Created:	Substation			MISSALL#
BIRMINGHAM	METRO-SOUTH	SHELBY	jacofe	8/19/2019	X- 49162		Y- XA3827	

Job: _____
Parcel No. 722479041-001
SHELBY CO HWY 71

RECORD THIS DRAWING!

Alvin S. Bayl

SHELBY CO HWY 404

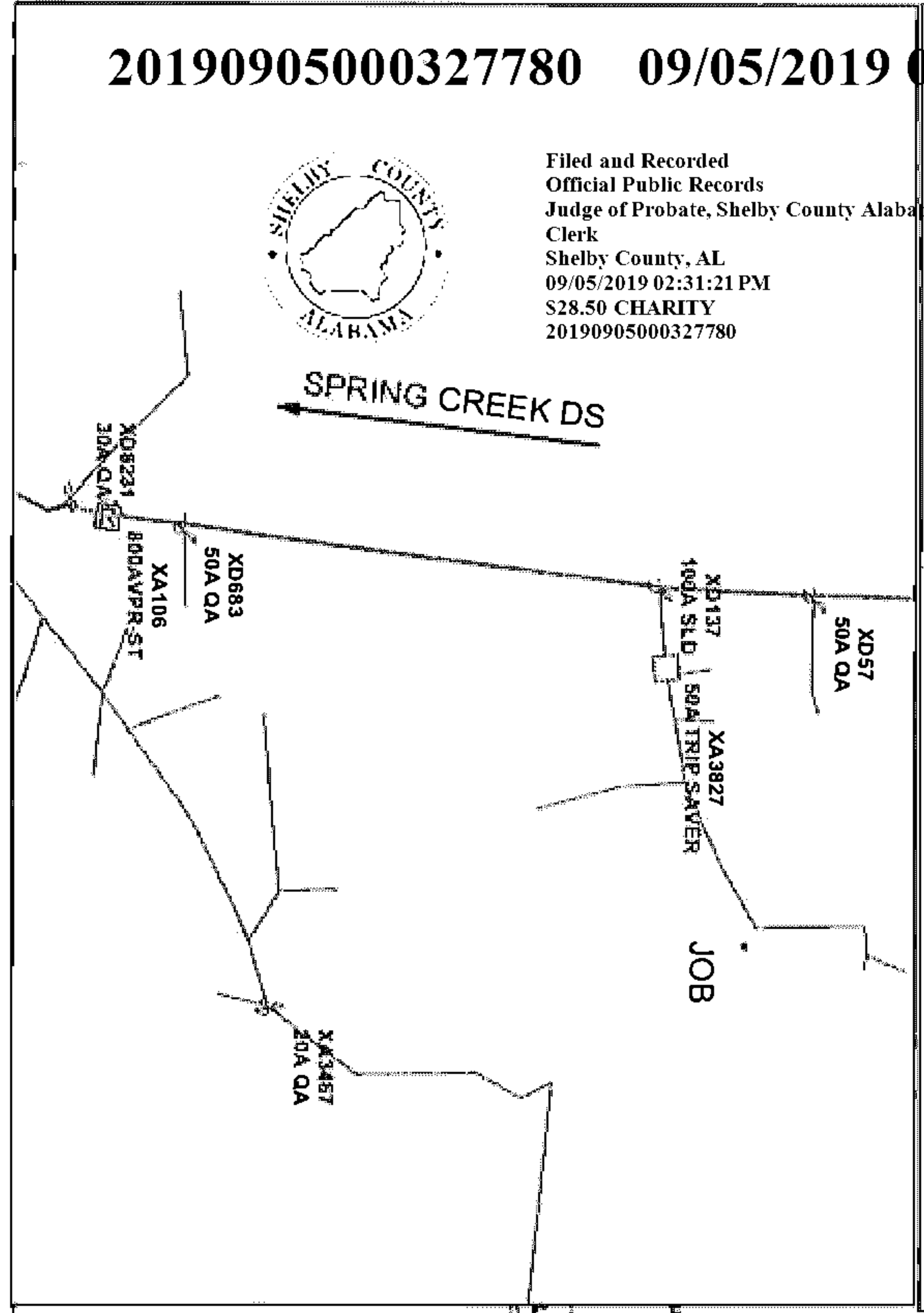

SHORT CIRCUIT INFORMATION
@ XD137
LG = 4185
LGR = 284

ENERGIZED LINE WORK
Sub SPRING CREEK DS
OCB/OCR XA108
Scheme NO
Scheme Name

Loc	Transformer Loading
1	10.2KVA

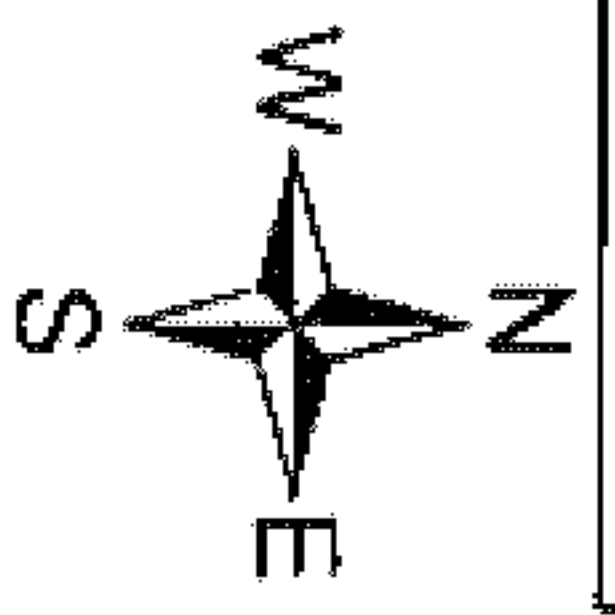

PHILLIP HARRIS
170 L AND M TRACE
PROP LD = 10.2KVA
VD = 1.92%
FVD = 4.73%
CUST MAIN = 200A
METERING 1PH, 200A

LOC #1
1: 2" SERV RISER
CALC LD = 10.2KVA
VD = 1.92%
FL = 4.73%
1: 1 # 2 & 2 # 1/0 UAL
DIRECT BURIED 65'

NOTE:
1. CUSTOMER TO PAY FOR UNDERGROUND SERVICE.
2. APCO CONTRACTOR TO OPEN DITCH, INSTALL CONDUCTOR AND CLOSE DITCH.
3. TRANSFORMER SIZED FOR FLICKER
4. CONTRACTOR'S

Voltage		Cable Co.	Phone Co.	Accessible	Tree Crew	Rock Hole	Permits	RW	CITY	COUNTY	STATE	OTHER
Pri	Sec											
7.2KV	120/240	N	N	N	N	N		Y	N	N	N	



Filed and Recorded
Official Public Records
Judge of Probate, Shelby County Alabama, County Clerk
Shelby County, AL
09/05/2019 02:31:21 PM
S28.50 CHARITY
20190905000327780