



1014 West Main Street  
Centre, AL 35960  
205-257-0727 tel  
kanowak@southernco.com

August 26, 2019

Candace Roberson  
The Title Group Incorporated  
2101 First Avenue North,  
Birmingham, AL 35203

SRC Inverness Cliffs, LLC  
Tax Parcels: 10-1-01-0-001-003.000; 10-1-01-0-001-003.008; 10-1-01-0-001-003.009

Re: Alabama Power Company Easement Containment Letter for Parcels 445230 and 471537

Ms. Roberson,

Alabama Power Company (APC) heretofore acquired and recorded the following easements in the Office of the Judge of Probate, Shelby County, Alabama:

Those certain instruments recorded in Real Volume 14, Page 424, Real Volume 348, Page 751, and Real Volume 34, Page 614.

The above easements were acquired to construct, operate, and maintain APC electrical line facilities. APC does not claim the right to construct additional lines under the authority granted in the above referenced documents. APC does retain all rights and privileges associated with the existing facilities and right-of-way specifically associated therewith, which are located on or adjacent to said property as of the date of this letter. APC does hereby contain its rights in the existing easement to remain substantially as presently constructed, with certain exceptions. APC agrees not to set additional poles or anchors at locations within the easement area, except as needed for the safety and maintenance of the existing facilities.

Land Description:

Exhibit "A" attached hereto and made a part hereof.

Please feel free to contact me at (205) 257-0727 if you have any questions or concerns.

Sincerely,

Kadie Nowak  
Real Estate Specialist



20190827000314250 1/2 \$18.00  
Shelby Cnty Judge of Probate, AL  
08/27/2019 09:10 23 AM FILED/CERT

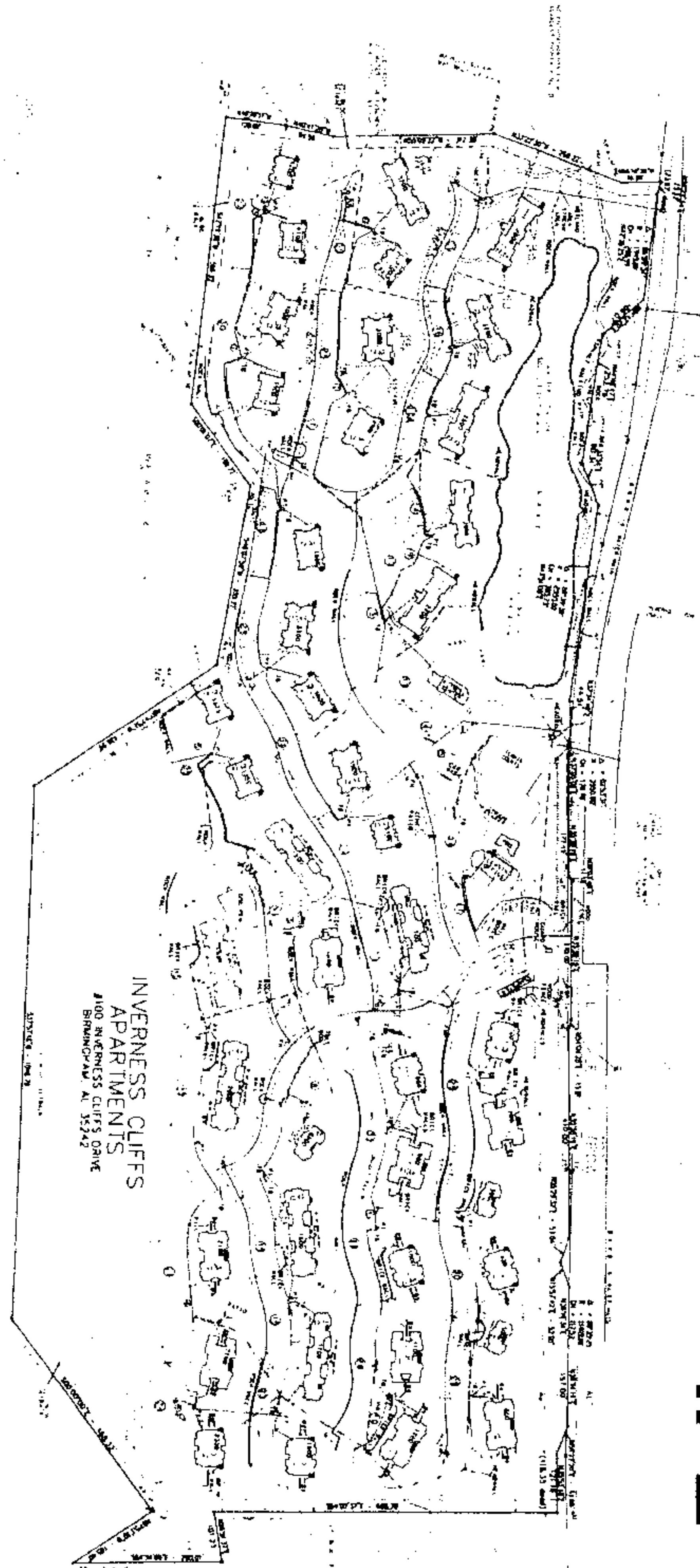

20190827000314250 2/2 \$18.00  
Shelby Cnty Judge of Probate, AL  
08/27/2019 09:10:23 AM FILED/CERT

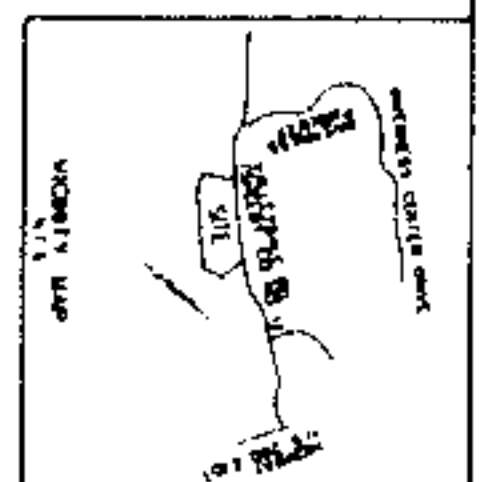

FOR REVIEW AND COMMENT		FOR APPROVAL		FOR RD ONLY		RELEASED FOR CONSTRUCTION		FOR RECORD	
1 OF 1		<b>ALT/NSPS</b> <b>LANDTITLE SURVEY</b> <b>INVERNESS CLIFFS APARTMENTS</b>		<b>M</b> <b>MOTT</b> <b>MACDONALD</b>		<b>MOTT MACDONALD</b> 1800 INTERNATIONAL PARK DRIVE SUITE 210 BIRMINGHAM, ALABAMA 35243 (205)939-1119			
LOCATED IN THE NE 1/4 SECTION 01, TWP 19 S, R 2 W SHELBY COUNTY, ALABAMA									