

EASEMENT – DISTRIBUTION FACILITIES

STATE OF ALABAMA

COUNTY OF **SHELBY**This instrument prepared by: **S. HOPKINS**Alabama Power Company
Corporate Real Estate
2 Industrial Park Drive
Pelham, AL 35124**20190625000225950****06/25/2019 03:54:09 PM****ESMTAROW 1/3**

KNOW ALL MEN BY THESE PRESENTS That the undersigned **D.R. HORTON, INC. - BIRMINGHAM** (hereinafter known as "Grantors", whether one or more) for and in consideration of One and No/100 Dollar (\$1.00) and other good and valuable consideration paid to Grantors in hand by Alabama Power Company, a corporation, the receipt and sufficiency of which are hereby acknowledged, do hereby grant to said Alabama Power Company, its successors and assigns (hereinafter the "Company"), the following easements, rights, and privileges:

Overhead and/or Underground. The right from time to time to construct, install, operate and maintain, upon, over, under and across the Property described below, all poles, towers, wires, conduits, fiber optics, cables, communication lines, trans closures, transformers, anchors, guy wires, and other facilities useful or necessary in connection therewith (collectively, "Facilities"), for the overhead and/or underground transmission and distribution of electric power and communications, along a route selected by the Company, as determined by the location(s) in which the Company's facilities are to be installed. The width of the Company's right of way will depend on whether the Facilities are underground or overhead: for underground, the right of way will extend five (5) feet on all sides of said Facilities as and where installed; for overhead Facilities, the right of way will extend fifteen (15) feet on all sides of said Facilities as and where installed.

The Company is further granted all the rights or privileges necessary or convenient for the full enjoyment and use of said right of way for the purposes above described, including, without limitation, the right of ingress and egress to and from said Facilities, as applicable, the right to excavate for installation, replacement, repair and removal of said Facilities, the right in the future to install intermediate poles and facilities on said right of way, the right to install, maintain, and use anchors and guy wires on land adjacent to said right of way, and also the right to cut, remove, and otherwise keep clear any and all trees, undergrowth, structures, obstructions, or obstacles of whatever character, on, under and above said right of way, as applicable. Further, with respect to overhead Facilities, the Company is also granted the right to trim and cut, and keep trimmed and cut, all dead, weak, leaning or dangerous trees or limbs outside of the aforementioned right of way that, in the opinion of the Company, may now or hereafter endanger, interfere with, or fall upon any of said overhead Facilities.

The easements, rights and privileges granted hereby shall apply to, and the word "Property" as used in this instrument shall mean the real property more particularly described in that certain instrument recorded in **INSTRUMENT #20170502000151390** in the Office of the Judge of Probate of the above named County.

In the event it becomes necessary or desirable for the Company from time to time to move any of the Facilities in connection with the construction or improvement of any public road or highway in proximity to the Facilities, Grantors hereby grant to the Company the right to relocate the Facilities and, as to such relocated Facilities, to exercise the rights granted above; provided, however, the Company shall not relocate said Facilities on the Property at a distance greater than ten feet (10') outside the boundary of the right of way of any such public road or highway as established or re-established from time to time. This grant and agreement shall be binding upon and shall inure to the benefit of Grantors, the Company and each of their respective heirs, personal representatives, successors and assigns and the words "Company" and "Grantors" as used in this instrument shall be deemed to include the heirs, personal representatives, successors and assigns of such parties.

TO HAVE AND TO HOLD the same to the Company, its successors and assigns, forever.

IN WITNESS WHEREOF, the said Grantors have caused this instrument to be executed by Andrew Hancock, its authorized representative, as of the 19th of June, 2019.

ATTEST (if required) or WITNESS:

By: Eric ShulaIts: Land Development Manager

(Grantor)

By: Andrew HancockIts: Division President

-----For Alabama Power Company Corporate Real Estate Department Use Only-----

W.E. # A6170-40-AC19 Transformer # XA4453, XA4451 All facilities on Grantor: NO ¼, ¼ STR & LOC to LOC 22S-02W-06 SW/NE

20190625000225950 06/25/2019 03:54:09 PM ESMTAROW 2/3

CORPORATION NOTARYSTATE OF AlabamaCOUNTY OF ShelbyI, Jerry Howard, Jr, a Notary Public, in and for said County in said State,hereby certify that Andrew Hancock, whose

name as Division President of DR Horton - Birmingham, a corporation, is signed to the foregoing instrument, and who is known to me, acknowledged before me on this day that, being informed of the contents of this instrument, he/she, as such officer and with full authority, executed the same voluntarily for and as the act of said Corporation.

Given under my hand and official seal, this the 15th day of June, 2019.



Notary Public: _____

My commission expires: _____

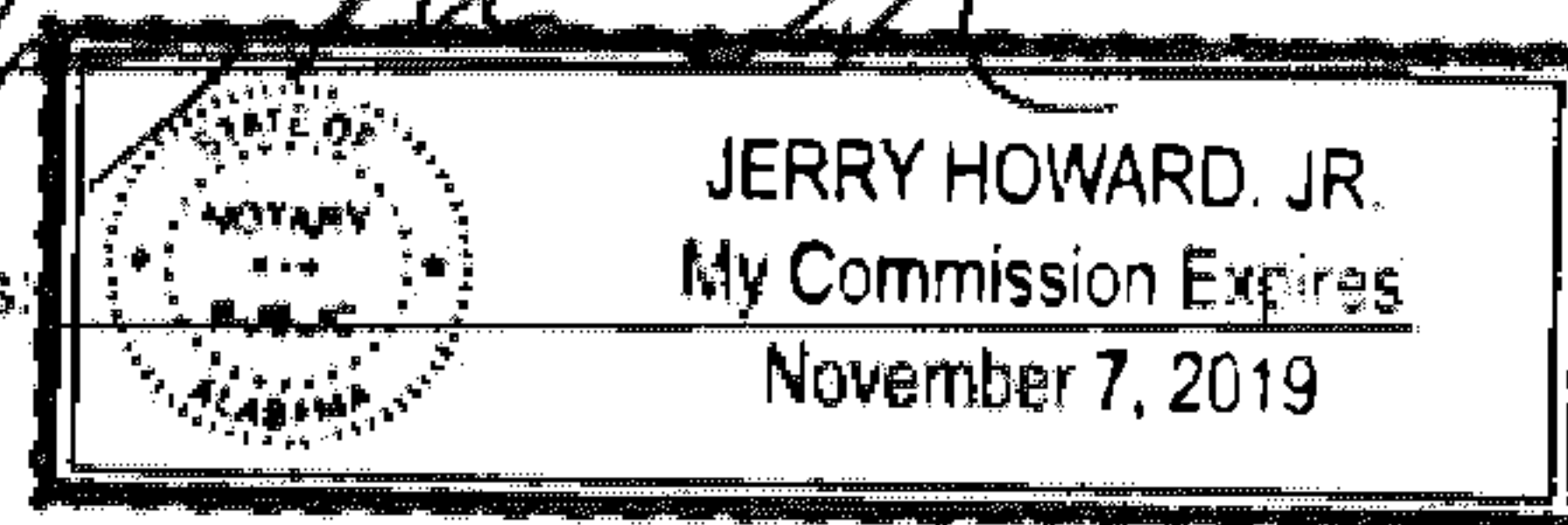
**CORPORATION/PARTNERSHIP/LLC NOTARY**

STATE OF _____

COUNTY OF _____

I, _____, a Notary Public in and for said County in said State, hereby certify that

_____, whose name as _____ of

_____, a _____, [acting in its capacity as

_____ of _____, a _____

_____] is signed to the foregoing instrument, and who is known to me, acknowledged before me on this day that, being

informed of the contents of the instrument, he/she, as such _____ and with full authority, executed the

same voluntarily, for and as the act of said _____ [acting in such capacity as aforesaid].

Given under my hand and official seal this the _____ day of _____, 20____.

[SEAL]

Notary Public: _____

My commission expires: _____

SKETCH OF PROPOSED WORK - SIMPLIFIED W.E.

Map Center UTM:
1706793 12033295

Map Center Lat/lon:
33.148363 -86.783061

1 inch = 102 feet

Customer	Location	Cmtd. Svc Date	County	Section	Township	Range	Add'l Info.	Estimate No.
WATERSTONE SUBDIVISION	WATERSTONE DR LOT 4 & 5		Shelby	6	22S	02W	SHEET 1 OF 1	A6170-40AC19
Division	District	Town	UserID	Created:	Substation	Longview D.S.	MISSALL#	Good Thru:
BIRMINGHAM	SOUTH-VARNONS	MONTEVALLO	inwilder	6/13/2019	X: 48876 Y: XA4455		Worked by:	Update by:

CUSTOMER CONTACT:

ENGINEER CONTACT:

ENERGIZED LINE WORK
Sub LONGVIEW D.S.
OCB/OCR 48876/08188 BNUA VPR 851
Switch# XA4455
Fuse Size 75A
Ref Pts: XA4455 & STAG T10069X
Scheme:

Short-Circuit Box

LL	LLG	LL	LG	LG-R
0	0	0	1679.4	272.6
D1 D11	V1 P11	V1 J01	D1 D11	V1 D11

Filed and Recorded
Official Public Records
Judge of Probate, Shelby County Alabama, County
Clerk
Shelby County, AL
06/25/2019 03:54:09 PM
S21.50 CHARITY
20190625000225950



WORK LOCATION 1:
1: 100W MH COLONIAL FIXTURE
20FT FIBERGLASS POLE
LT#: FC276

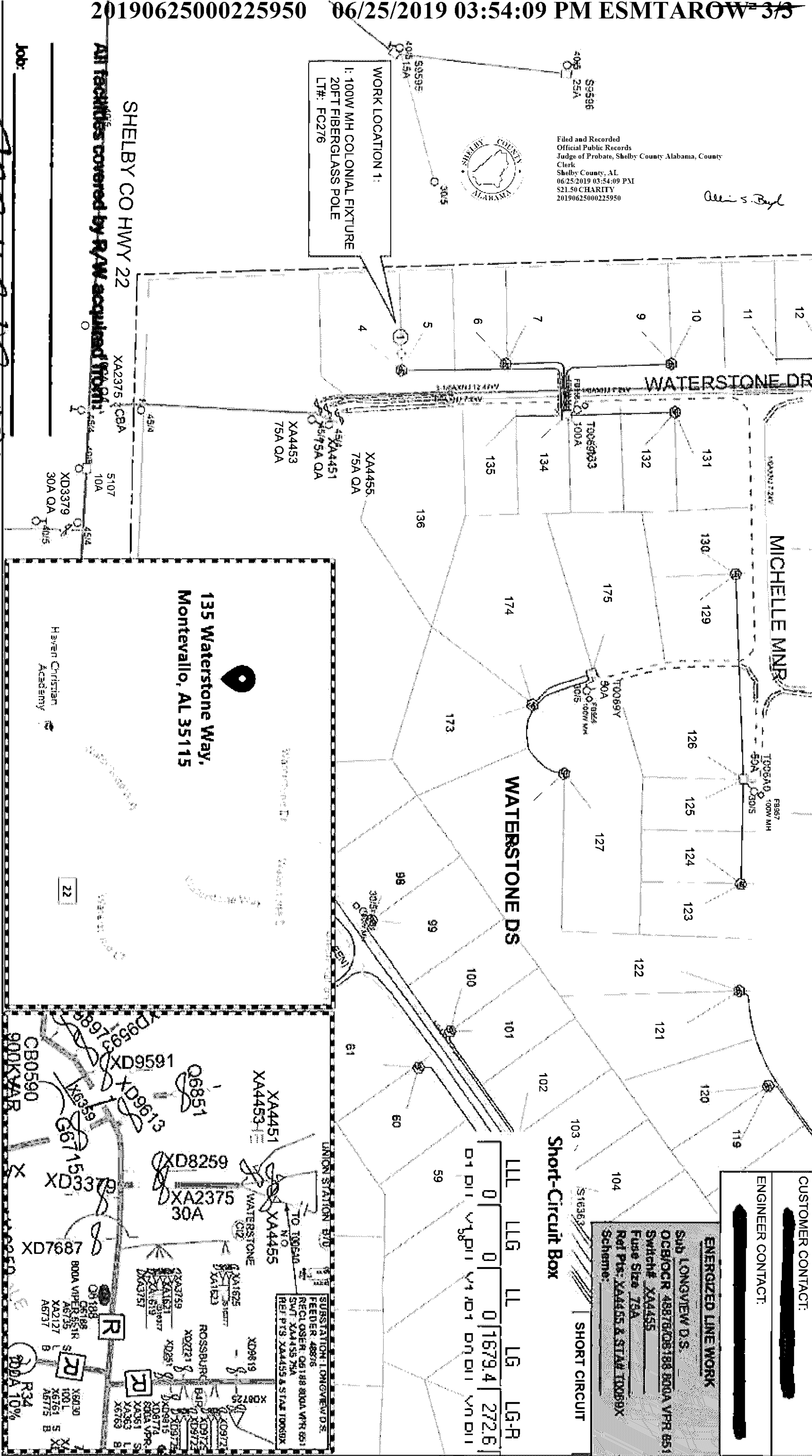

Parcel No. 102810209-001

RECORD THIS DRAWING!