

EASEMENT – DISTRIBUTION FACILITIES

STATE OF ALABAMA

COUNTY OF SHELBY

This instrument prepared by: S. HOPKINS

Alabama Power Company  
Corporate Real Estate  
2 Industrial Park Drive  
Pelham, AL 35124

20190625000224320

06/25/2019 08:54:13 AM

ESMTAROW 1/3

KNOW ALL MEN BY THESE PRESENTS That the undersigned STATE OF ALABAMA C/O SHELBY COUNTY BOARD OF EDUCATION (hereinafter known as "Grantors", whether one or more) for and in consideration of One and No/100 Dollar (\$1.00) and other good and valuable consideration paid to Grantors in hand by Alabama Power Company, a corporation, the receipt and sufficiency of which are hereby acknowledged, do hereby grant to said Alabama Power Company its successors and assigns (hereinafter the "Company"), the following easements, rights, and privileges:

**Overhead and/or Underground.** The right from time to time to construct, install, operate and maintain, upon, over, under and across the Property described below all poles, towers, wires, conduits, fiber optics, cables, communication lines, trans closures, transformers, anchors, guy wires, and other facilities useful or necessary in connection therewith (collectively, "Facilities"), for the overhead and/or underground transmission and distribution of electric power and communications, along a route selected by the Company, as determined by the location(s) in which the Company's facilities are to be installed. The width of the Company's right of way will depend on whether the Facilities are underground or overhead: for underground, the right of way will extend five (5) feet on all sides of said Facilities as and where installed; for overhead Facilities, the right of way will extend fifteen (15) feet on all sides of said Facilities as and where installed.

The Company is further granted all the rights or privileges necessary or convenient for the full enjoyment and use of said right of way for the purposes above described, including, without limitation, the right of ingress and egress to and from said Facilities, as applicable, the right to excavate for installation, replacement repair and removal of said Facilities, the right in the future to install intermediate poles and facilities on said right of way, the right to install, maintain, and use anchors and guy wires on land adjacent to said right of way, and also the right to cut, remove, and otherwise keep clear any and all trees, undergrowth, structures, obstructions or obstacles of whatever character, on, under and above said right of way, as applicable. Further, with respect to overhead Facilities, the Company is also granted the right to trim and cut, and keep trimmed and cut, all dead, weak, leaning or dangerous trees or limbs outside of the aforementioned right of way that, in the opinion of the Company, may now or hereafter endanger, interfere with, or fall upon any of said overhead Facilities.

The easements, rights and privileges granted hereby shall apply to, and the word "Property" as used in this instrument shall mean the real property more particularly described in that certain instrument recorded in DEED BOOK 226 PAGE 308 in the Office of the Judge of Probate of the above named County.

In the event it becomes necessary or desirable for the Company from time to time to move any of the Facilities in connection with the construction or improvement of any public road or highway in proximity to the Facilities, Grantors hereby grant to the Company the right to relocate the Facilities and, as to such relocated Facilities, to exercise the rights granted above; provided, however, the Company shall not relocate said Facilities on the Property at a distance greater than ten feet (10') outside the boundary of the right of way of any such public road or highway as established or re-established from time to time. This grant and agreement shall be binding upon and shall inure to the benefit of Grantors, the Company and each of their respective heirs, personal representatives, successors and assigns and the words "Company" and "Grantors" as used in this instrument shall be deemed to include the heirs, personal representatives, successors and assigns of such parties.

TO HAVE AND TO HOLD the same to the Company, its successors and assigns, forever.

IN WITNESS WHEREOF, the said Grantors have caused this instrument to be executed by Dr. Lewis Brooks, its authorized representative, as of the 4th of June, 2019.

ATTEST (if required) or WITNESS:

(Grantor)

By: David Carmichael

By: Shelby County Board of Education

Its: Assistant Superintendent Operations Its: Superintendent

For Alabama Power Company Corporate Real Estate Department Use Only

W.E. # A6170-05-AJ19 Transformer # T015GE All facilities on Grantor: NO ¼, ¼ STR & LOC to LOC

22S-03W-21 SW/SE

20190625000224320 06/25/2019 08:54:13 AM ESMTAROW  
2/3

CORPORATION NOTARY

STATE OF Alabama

COUNTY OF Shelby

I, Tracy M Whitfield, a Notary Public, in and for said County in said State,

hereby certify that Lewis Brooks, whose

name as Superintendent SCBOE, a corporation, is signed to the foregoing Instrument, and who is known to me, acknowledged before me on this day that, being informed of the contents of this instrument, he/she, as such officer and with full authority, executed the same voluntarily for and as the act of said Corporation.

Given under my hand and official seal, this the 6<sup>th</sup> day of June, 2019.

[SEAL]

Notary Public: Tracy M Whitfield

My commission expires: 9-26-20

SKETCH OF PROPOSED WORK - SIMPLIFIED W.E.

Map Center UTM: 1684468 12016489

Map Center LatLon: 33.102262 -86.856101

1 inch = 71 feet N.T.S.

Customer CDI HEADSTART	Location 100 JIMMY JONES DR.	Cmtd. Svc Date 06/25/2019	County Shelby	Section 21	Township 22S	Range 03W	Add'l Info.	Estimate No. A6170-05-AJ19
Division BIRMINGHAM- SOUTH	District METRO SOUTH	Town MONTEVALLO	UserID kmharri	Created: 5/23/2019	Substation : MONTEVALLO D.S.	X- 34028	Y- XA3909	MISSALL#

- Notes:
1. APCO to trim/drop trees for pri. ROW
  2. Service to existing Headstart building will remain until summer after complete conversion to new building
  3. Electrician: Nick Ambrester
- PH #:

ENERGIZED WORK PERMIT:  
Substation: MONTEVALLO D.S.  
Feeder: XA3909  
Fused: SOLID  
OCR: XA0266

Loc	2
Transformer Loading	25 KVA

Voltage	Pri	Sec
	7.2KV / 12.47KV	120/240V
Phone Co.	N	
Cable Co.	N	
Accessible	Y	
Tree Crew	Y	
Rock Hole	N	
Permits		
R/W	Y	
CITY		
COUNTY		
STATE		
OTHER		

All facilities covered by R/W acquired from:

Job:

Parcel No. 72245844-001

RECORD THIS DRAWING!

LOC 2:  
I: 40/5 CCA POLE  
I: #6CU ENH. GND.  
I: 10 PRL D.E  
I: 25 KVA 120/240  
CONV. XFMR.  
I: (60") #1/0 TPX SVC.  
I: ANCH W/ 8"HX, 5/8" ROD  
5/16" STR. GUY W/INS.  
I: 600A TRANSOCKET

LOC 1:  
I: PRL D.E.  
I: (103") #2ACSR/#ACSRN

NOTE:  
LOAD: 25KVA  
PRO FL: 3.79%  
PRO VD: 2.81%  
SVC AMPS: 104.1A

20190625000224320  
06/25/2019 08:54:13  
AM ESMTAROW 3/3

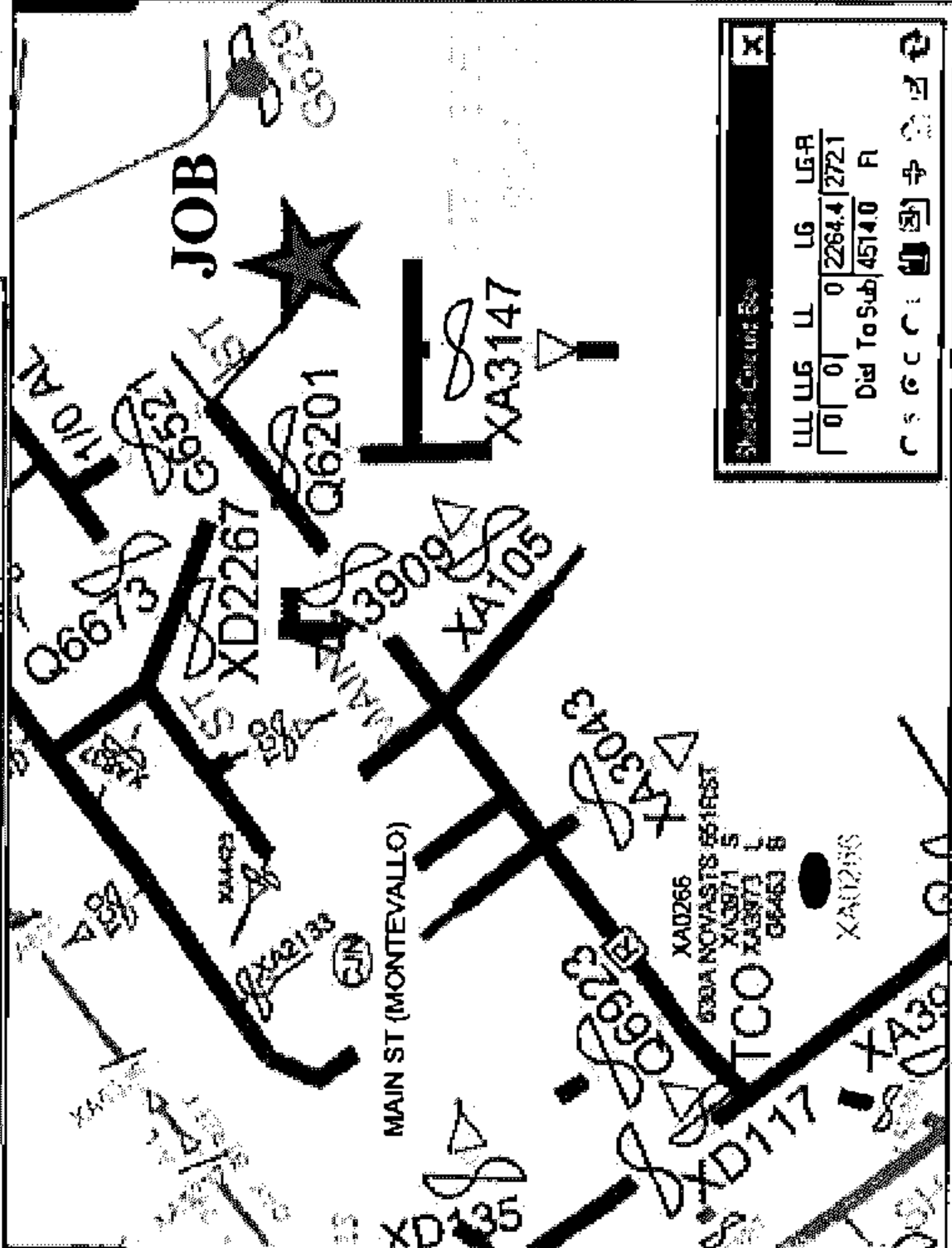
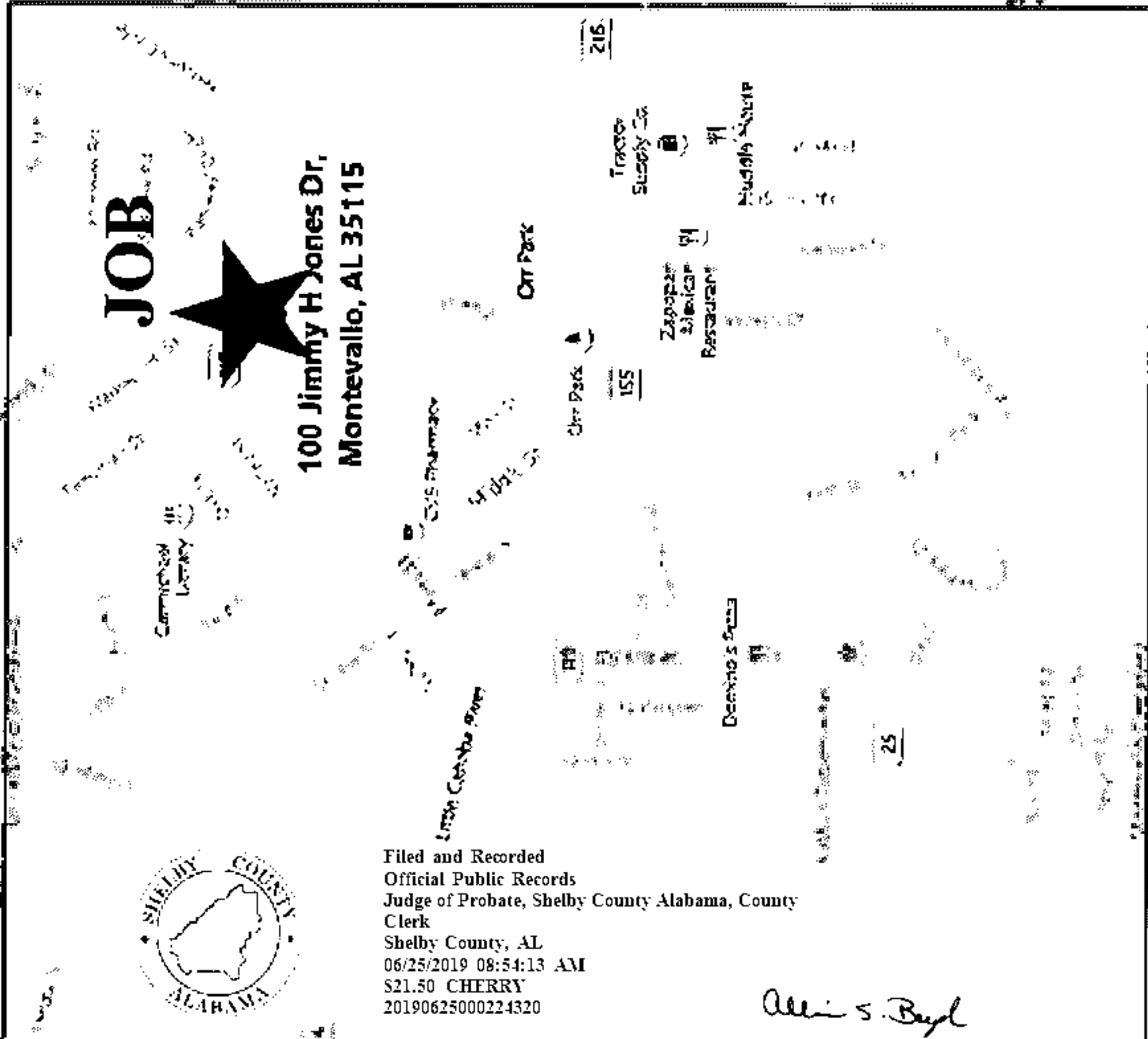

Source: Esri, DigitalGlobe, GeoEye, Earthstar Geographics, CNES/Airbus DS.