

Source of Title: INSTRUMENT #20110628000187870

EASEMENT – UNDERGROUND DISTRIBUTION FACILITIES

STATE OF ALABAMA

COUNTY OF SHELBY

20190212000045220
02/12/2019 12:21:45 PM
ESMTAROW 1/2

This instrument prepared by: S. HOPKINS

Alabama Power Company
Corporate Real Estate
2 Industrial Park Drive
Pelham, AL 35124

KNOW ALL MEN BY THESE PRESENTS, That the undersigned PATRICIA M. BATES, a married woman (hereinafter known as "Grantors", whether one or more) for and in consideration of One and No/100 Dollar (\$1.00) and other good and valuable consideration paid to Grantors in hand by Alabama Power Company, a corporation, the receipt and sufficiency of which are hereby acknowledged, do hereby grant to said Alabama Power Company, its successors and assigns (hereinafter the "Company"), the following easements, rights, and privileges:

The right from time to time to construct, install, operate, and maintain, upon, under, and across the Property described below, all wires, conduits, cables, trans closures, transformers, fiber optics, communication lines, and other facilities useful or necessary in connection therewith (collectively, "Facilities"), for the underground transmission and distribution of electric power and communications, along a route selected by the Company, as determined by the location(s) in which the Company's facilities are to be installed. The Company's right of way will extend five (5) feet on all sides of said Facilities as and where installed, and shall include the right to clear and keep clear said right of way.

The Company is further granted all the rights or privileges necessary or convenient for the full enjoyment and use of said right of way for the purposes above described, including, without limitation, the right of ingress and egress to and from said Facilities, as applicable, the right to excavate for installation, replacement, repair and removal of said Facilities, and also the right to cut, remove, and otherwise keep clear any and all structures, obstructions, or obstacles of whatever character, on, under, adjacent to, and above said Facilities.

The easements, rights and privileges granted hereby shall apply to, and the word "Property" as used in this instrument shall mean the real property more particularly described in that certain instrument recorded in **INSTRUMENT # 20110628000187870**, in the Office of the Judge of Probate of the above named County.

In the event it becomes necessary or desirable for the Company from time to time to move any of the Facilities in connection with the construction or improvement of any public road or highway in proximity to the Facilities, Grantors hereby grant to the Company the right to relocate the Facilities and, as to such relocated Facilities, to exercise the rights granted above; provided, however, the Company shall not relocate said Facilities on the Property at a distance greater than ten feet (10') outside the boundary of the right of way of any such public road or highway as established or re-established from time to time. This grant and agreement shall be binding upon and shall inure to the benefit of Grantors, the Company and each of their respective heirs, personal representatives, successors and assigns and the words "Company" and "Grantors" as used in this instrument shall be deemed to include the heirs, personal representatives, successors and assigns of such parties.

TO HAVE AND TO HOLD the same to the Company, its successors and assigns, forever.

IN WITNESS WHEREOF, the undersigned Grantors have executed this instrument on this the 7th Day of February, 2019.

[Signature]
Witness Signature (non-relative)
Krista chick

Print Name
Cindy Brown
Witness Signature (non-relative)
Cindy Brown
Print Name

[Signature]
(Grantor) PATRICIA M BATES
PATRICIA MARKEN BATES

Print Name
[Signature]
(Grantor) DR JOHN BATES
Johnny E. Bates
Print Name

For Alabama Power Company Corporate Real Estate Department Use Only

All facilities on Grantor: Yes Location to Location: _____

Section 30, Township 20S, Range 01W

W.E. No. A6170-08-A519 Transformer No. S80451

SKETCH OF PROPOSED WORK - SIMPLIFIED W.E.

Map Center UTM: 1766039 12093947

Map Center Lat/lon: 33.314623 -86.585157

1 inch = 150 feet



Customer DR. JOHN BATES	Location 88 SALSER LN	Comtd. Svc Date 4/30/2019	County Shelby	Section 1	Township 20S	Range 01W	Add'l Info.	Estimate No. A617008A519
Division BIRMINGHAM	District METRO SOUTH	TOWN WILSONVILLE	UserID	Created: 2/4/2019	Substation X.	Y.		MISSALL#

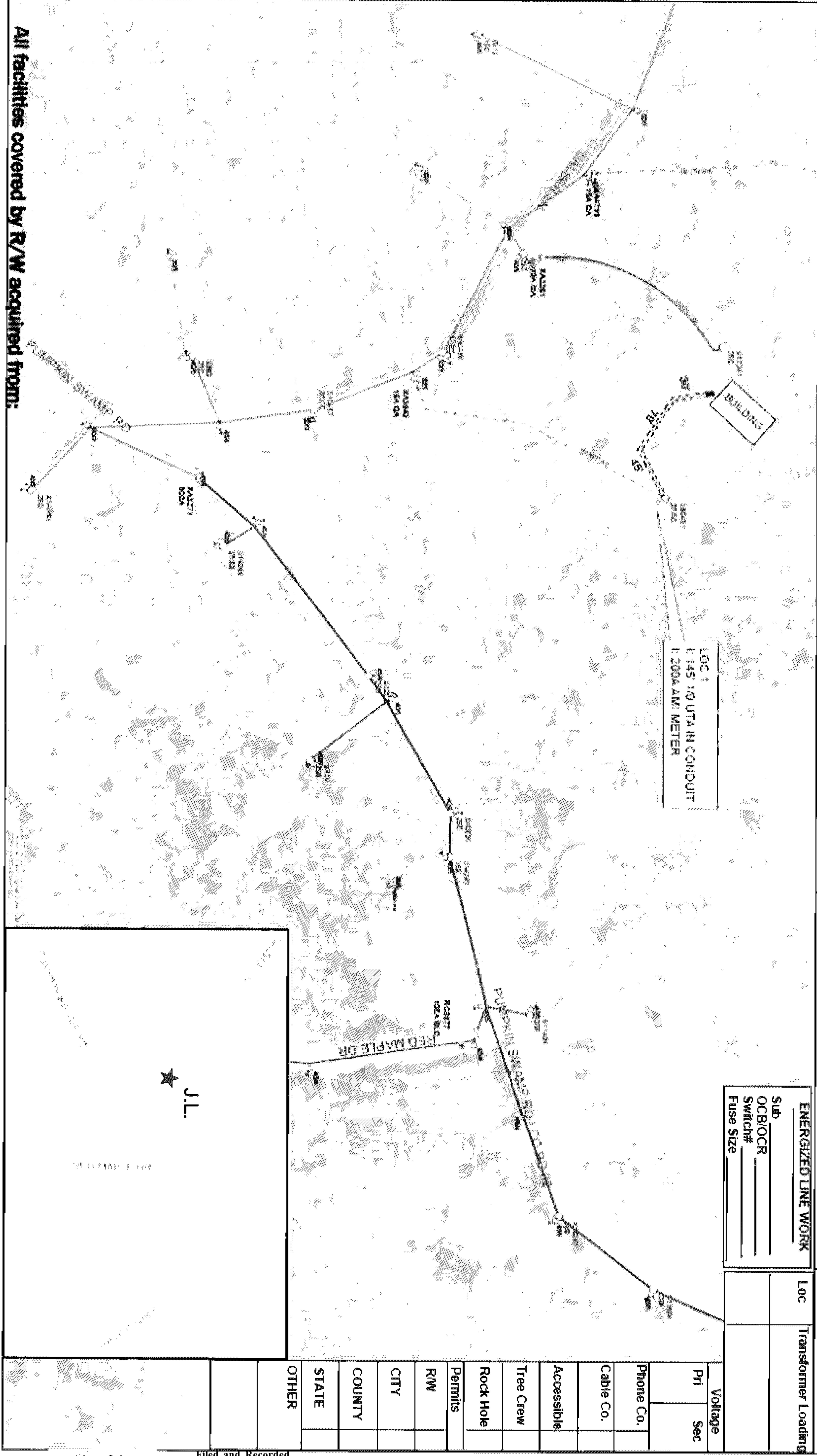

All facilities covered by R/W acquired from:

Job: _____

Parcel No. 1224298-001

RECORD THIS DRAWING!



Filed and Recorded
Official Public Records
Judge of Probate, Shelby County Alabama, County
Clerk
Shelby County, AL
02/12/2019 12:21:45 PM
\$18.50 CHARITY
20190212000045220

Allen S. Bayl