

EASEMENT - SECONDARY VOLTAGE

STATE OF ALABAMA

COUNTY OF ShelbyThis instrument prepared by **S. HOPKINS**

Alabama Power Company
 Corporate Real Estate
 2 Industrial Park Drive
 Pelham, AL 35124

20181219000443790

12/19/2018 02:44:18 PM

ESMTAROW 1/3

KNOW ALL MEN BY THESE PRESENTS, That the undersigned Robert E. Gosnell, Single man (hereinafter known as "Grantors", whether one or more) for and in consideration of One and No/100 Dollar (\$1.00) and other good and valuable consideration paid to Grantors in hand by Alabama Power Company, a corporation, the receipt and sufficiency of which are hereby acknowledged, do hereby grant to said Alabama Power Company, its successors and assigns (hereinafter the "Company"), the following easements, rights, and privileges:

The right from time to time to construct, install, operate and maintain, along a route to be selected by the Company, as determined by the actual location(s) in which the Company's facilities are to be installed, all poles, wires, and other appliances and facilities useful or necessary in connection therewith (collectively "Facilities"), for the overhead distribution of communications and secondary voltages not to exceed 600 volts of electric power for overhead service upon, over, under and across real property more particularly described in that certain instrument recorded in Shelby County in the Office of the Judge of Probate of the above named County.

Instrument # 20070427000194730

Together with all rights and privileges necessary or convenient for the full enjoyment or use thereof, including the right of ingress and egress to and from said Facilities; the right to cut, remove and otherwise keep clear any and all trees, undergrowth, structures, obstructions, or obstacles of whatever character, on, under and above said right of way, which shall extend five feet (5') from all sides of said Facilities; and the right to trim and cut, and keep trimmed and cut, all dead, weak, leaning or dangerous trees or limbs outside of the aforementioned right of way that, in the opinion of Company, may now or hereafter endanger, interfere with, or fall upon any of said overhead facilities.

In the event it becomes necessary or desirable for the Company from time to time to move any of the Facilities in connection with the construction or improvement of any public road or highway in proximity to the Facilities, Grantor hereby grants to the Company the right to relocate the Facilities and, as to such relocated Facilities, to exercise the rights granted above; provided, however, the Company shall not relocate the Facilities on the Property at a distance greater than ten feet (10') outside the boundary of the right of way of any such public road or highway as established or re-established from time to time. This grant and agreement shall be binding upon and shall inure to the benefit of Grantor, the Company and each of their respective heirs, personal representatives, successors and assigns and the words "Company" and "Grantor" as used in this instrument shall be deemed to include the heirs, personal representatives, successors and assigns of such parties.

TO HAVE AND TO HOLD the same to the Company, its successors and assigns, forever.

IN WITNESS WHEREOF, the undersigned Grantors have executed this instrument on this the 26 day of November, 2018.

Witness Signature (non-relative)

Print Name

Witness Signature (non-relative)

Print Name

(Grantor)

(Grantor)

(SEAL)

(SEAL)

-----For Alabama Power Company Corporate Real Estate Department Use Only-----

W.E. # A6170-14-C118 Transformer # TODUCL All facilities on Grantor: Yes 1/4, 1/4 STR & LOC to LOC
22 South - 2 East - 18 NW/1/4, NE/1/4

20181219000443790 12/19/2018 02:44:18 PM ESMTAROW 2/3

IN WITNESS WHEREOF, the said Grantor, has caused this instrument to be executed by Robert E Gosnell, its authorized representative, as of the 26 day of November, 2018.

ATTEST (if required) or WITNESS:

Robert E Gosnell
GRANTOR

By: _____

By: _____ (SEAL)

Its: _____

Its: _____
(Indicate President, Partner, Member, etc.)

INDIVIDUAL NOTARIES

STATE OF Alabama

COUNTY OF Shelby

I, Jeremy Bouet, a Notary Public, in and for said County in said State, hereby certify that Robert E Gosnell whose name(s) [as _____] is/are signed to the foregoing instrument and who is/are known to me, acknowledged before me on this day that being informed of the contents of the instrument he/she/they [in such capacity as aforesaid] executed the same voluntarily.

Given under my hand and official seal this the 26 day of November, 2018.

[SEAL]

[Signature]
Notary Public
My commission expires: 09/26/2022

STATE OF _____

COUNTY OF _____

I, _____, a Notary Public, in and for said County in said State, hereby certify that _____

_____ whose name(s) [as _____] is/are signed to the foregoing instrument and who is/are known to me, acknowledged before me on this day that being informed of the contents of the instrument he/she/they [in such capacity as aforesaid] executed the same voluntarily.

Given under my hand and official seal this the _____ day of _____, 20____.

[SEAL]

Notary Public
My commission expires: _____

SKETCH OF PROPOSED WORK - SIMPLIFIED W.E.

Map Center UTM: 1799489 12024564

Map Center Lat Long: 33.123464 -86.480252

1 inch = 50 feet



Customer	Location	Cont'd. Sec Date	County	Section	Township	Range	Add'l Info.	Estimate No.
ROBERT GOSNELL	235 WALLACE DR	12/31/18	Shelby	18	22S	02E		A6170-14CJ18
Division	District	Town	Use/ID	Created	Substation			MISSALL#
BIRMINGHAM	METRO SOUTH	SHELBY		8/28/2018				182-400-339
								83018 @8:15AM

Loc	Transformer Loading
1	16.7 kVA

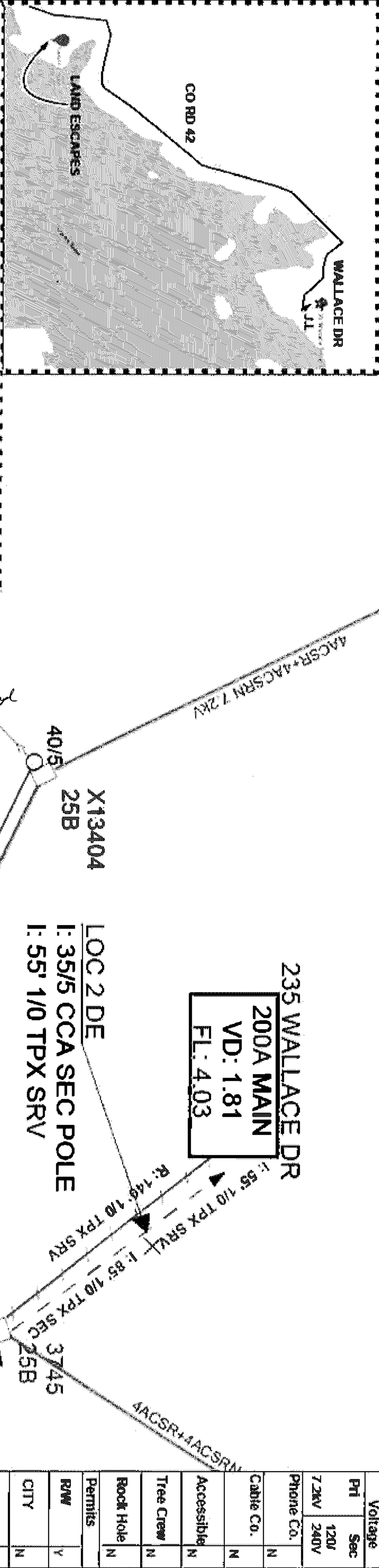

Voltage	Pri	Sec
7.2KV	120V	240V
Phone Co.	N	
Cable Co.	N	
Accessib	N	
Tree Crew	N	
Rock Hole	N	
Permits		
R/W	Y	
CITY	N	
COUNTY	N	
STATE	N	
OTHER		

All facilities covered by R/W acquired from:

Job:

Parcel No.

RECORD THIS DRAWING!



Filed and Recorded
Official Public Records
Judge of Probate, Shelby County Alabama, County
Clerk
Shelby County, AL
12/19/2018 02:44:18 PM
\$21.50 CHERRY
20181219000443790