

Source of Title:  
Instrument Number 20120713000249700

**EASEMENT – DISTRIBUTION FACILITIES**

STATE OF ALABAMA  
COUNTY OF SHELBY

A6170-06-AF18

This instrument prepared by: Eric Brasher

Alabama Power Company  
Attn: Engineering/Right of way  
2 Industrial Park Drive  
Pelham, AL 35124

*\$500.00*

20180412000122680  
04/12/2018 12:41:42 PM  
ESMTAROW 1/3

**KNOW ALL MEN BY THESE PRESENTS**, That the undersigned McNeill & Storm Properties, Inc., an Alabama Corporation

(hereinafter known as "Grantors", whether one or more) for and in consideration of One and No/100 Dollar (\$1.00) and other good and valuable consideration paid to Grantors in hand by Alabama Power Company, a corporation, the receipt and sufficiency of which are hereby acknowledged, do hereby grant to said Alabama Power Company, its successors and assigns (hereinafter the "Company"), the following easements, rights, and privileges:

**Overhead and/or Underground.** The right from time to time to construct, install, operate and maintain, upon, over, under and across the Property described below, all poles, towers, wires, conduits, fiber optics, cables, communication lines, transclosures, transformers, anchors, guy wires, and other facilities useful or necessary in connection therewith (collectively, "Facilities"), for the overhead and/or underground transmission and distribution of electric power and communications, along a route selected by the Company, as determined by the location(s) in which the Company's facilities are to be installed. The width of the Company's right of way will depend on whether the Facilities are underground or overhead: for underground, the right of way will extend five (5) feet on all sides of said Facilities as and where installed; for overhead Facilities, the right of way will extend fifteen (15) feet on all sides of said Facilities as and where installed.

The Company is further granted all the rights or privileges necessary or convenient for the full enjoyment and use of said right of way for the purposes above described, including, without limitation, the right of ingress and egress to and from said Facilities, as applicable, the right to excavate for installation, replacement, repair and removal of said Facilities, the right in the future to install intermediate poles and facilities on said right of way, the right to install, maintain, and use anchors and guy wires on land adjacent to said right of way, and also the right to cut, remove, and otherwise keep clear any and all trees, undergrowth, structures, obstructions, or obstacles of whatever character, on, under and above said right of way, as applicable. Further, with respect to overhead Facilities, the Company is also granted the right to trim and cut, and keep trimmed and cut, all dead, weak, leaning or dangerous trees or limbs outside of the aforementioned right of way that, in the opinion of the Company, may now or hereafter endanger, interfere with, or fall upon any of said overhead Facilities.

The easements, rights and privileges granted hereby shall apply to, and the word "Property" as used in this instrument shall mean the real property more particularly described in that certain instrument recorded in **Instrument Number 20120713000249700**, in the Office of the Judge of Probate of the above named County.

In the event it becomes necessary or desirable for the Company from time to time to move any of the Facilities in connection with the construction or improvement of any public road or highway in proximity to the Facilities, Grantors hereby grant to the Company the right to relocate the Facilities and, as to such relocated Facilities, to exercise the rights granted above; provided, however, the Company shall not relocate said Facilities on the Property at a distance greater than ten feet (10') outside the boundary of the right of way of any such public road or highway as established or re-established from time to time. This grant and agreement shall be binding upon and shall inure to the benefit of Grantors, the Company and each of their respective heirs, personal representatives, successors and assigns and the words "Company" and "Grantors" as used in this instrument shall be deemed to include the heirs, personal representatives, successors and assigns of such parties.

TO HAVE AND TO HOLD the same to the Company, its successors and assigns, forever.

IN WITNESS WHEREOF, the said Grantors have caused this instrument to be executed by Richard P. Storm, its authorized representative, as of the 6th of April, 2018.

ATTEST (if required) or WITNESS:

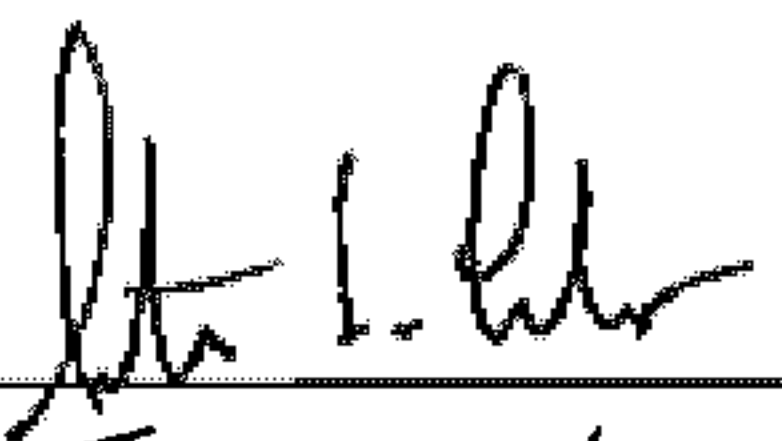
By:   
Its: Treasurer / CFO

McNeill & Storm Properties, Inc.,  
(Grantor)

 (SEAL)  
Its: President  
[Indicate President, General Partner, Member, etc.]

**For Alabama Power Company Corporate Real Estate Department Use Only**

All facilities on Grantor: Yes Location to Location: \_\_\_\_\_

NW ¼ of the SE¼ of Section 13; Township 20 SOUTH; Range 03 WEST

W.E. No. A6170-06-AF18

Transformer No. T00GJ8

**CORPORATION NOTARY**

STATE OF Alabama

20180412000122680 04/12/2018 12:41:42 PM ESMTAROW 2/3

COUNTY OF Jefferson

I, Nancy Ledbetter, a Notary Public, in and for said County in said State, hereby certify that  
Richard P. Storm, whose name as President  
of McNeill & Storm Properties, Inc.

\_\_\_\_\_, a corporation, is signed to the foregoing instrument, and who is known to me, acknowledged before me on this day that, being informed of the contents of this instrument, he/she, as such officer and with full authority, executed the same voluntarily for and as the act of said Corporation.

Given under my hand and official seal, this the 6th day of April, 2018.

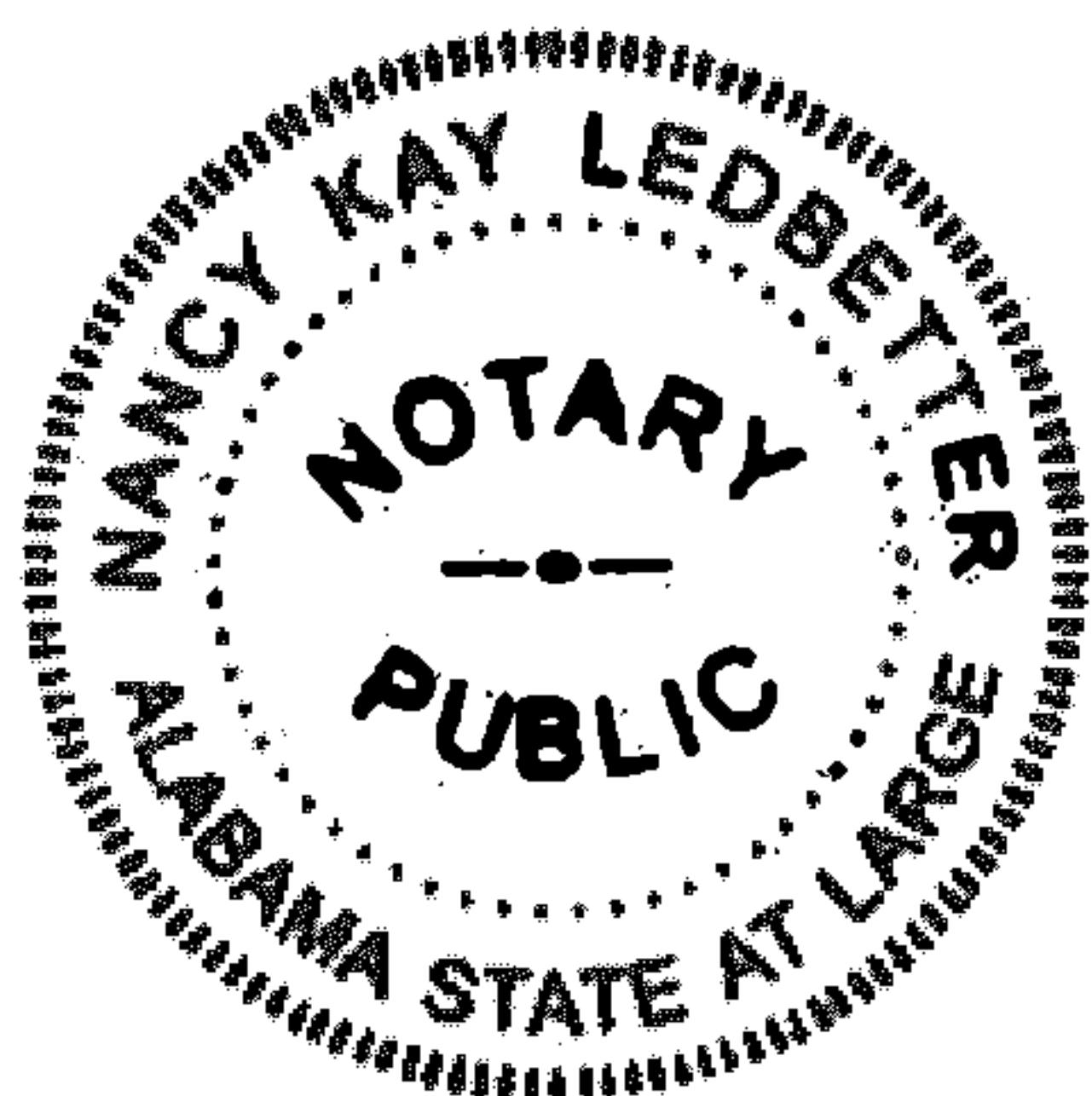

Notary Public Nancy Kay Folsom  
My commission expires: 10-8-18

**NANCY KAY LEDBETTER**  
Notary Public, Alabama State At Large  
My Commission Expires October 8, 2018



SKETCH OF PROPOSED WORK - SIMPLIFIED W.E.

Map Center UTM: 1700335 12085801

Map Center LatLon: 33.292754 -86.803846

1 inch = 100 feet N.T.S.

Customer INNOVATIVE COMBUSTION	Location 10 COMMERCE DR	Cmited. Svc Date 05/30/2018	County Shelby	Section 13	Township 20S	Range 03W	Add'l Info.	Estimate No. A6170-06-AF18
Division BIRMINGHAM-SOUTH	District METRO SOUTH	Town PELHAM	UserID #11507 aachand	Created: 4/6/2018	Substation : HELENA D.S. X- 39814	Y- XA4561 (F)		MISALL#

NOTES:  
1) WORK ORDER REQUIRED IN ORDER TO PROVIDE 3PH 277/480V UNDERGROUND SERVICE TO NEW BUILDING WITH A 800A MAIN.  
2) NO CSP DIFFERENTIAL BILLING PER APPENDIX F.  
3) MARKETING REP: TERRANCE HAWKINS@ (205) 226-1917.  
4) ELECTRICIAN CONTACT: MIKE FLOWERS@ (205) 281-0321.

LOCATION #1:

1- 45/4 WOOD POLE, J U.  
1- #4 CU ENH GND  
1- 3PH TANGENT (ANGLE = 0°)  
1- 3PH PRIMARY RISER ASSEMBLY (XA4561)  
W/ (3) 100A COS, LAs & BKT  
FUSE @ 50A QA  
(1)in = 57A)  
1- (3) #10 AXNUUG, PRIMARY 100"  
IN CUSTOMER PROVIDED & INSTALLED  
5 SCH 40 CONDUIT  
(CABLE PULL = 427.91#)

ENERGIZED WORK PERMIT:  
Substation: HELENA D.S.  
Feeder: #1 : 39814  
Switch: N/A  
Fused: N/A  
OCR: L6000

Loc 2 Transformer Loading  
341.1KVA  
NOTE: XFMR SIZED FOR FUTURE  
LOAD & CTS SIZED TO APPROACH  
75% INITIAL LOADING FACTOR.

20180412000122680  
04/12/2018 12:41:42 PM  
ESMTAROW 3/3

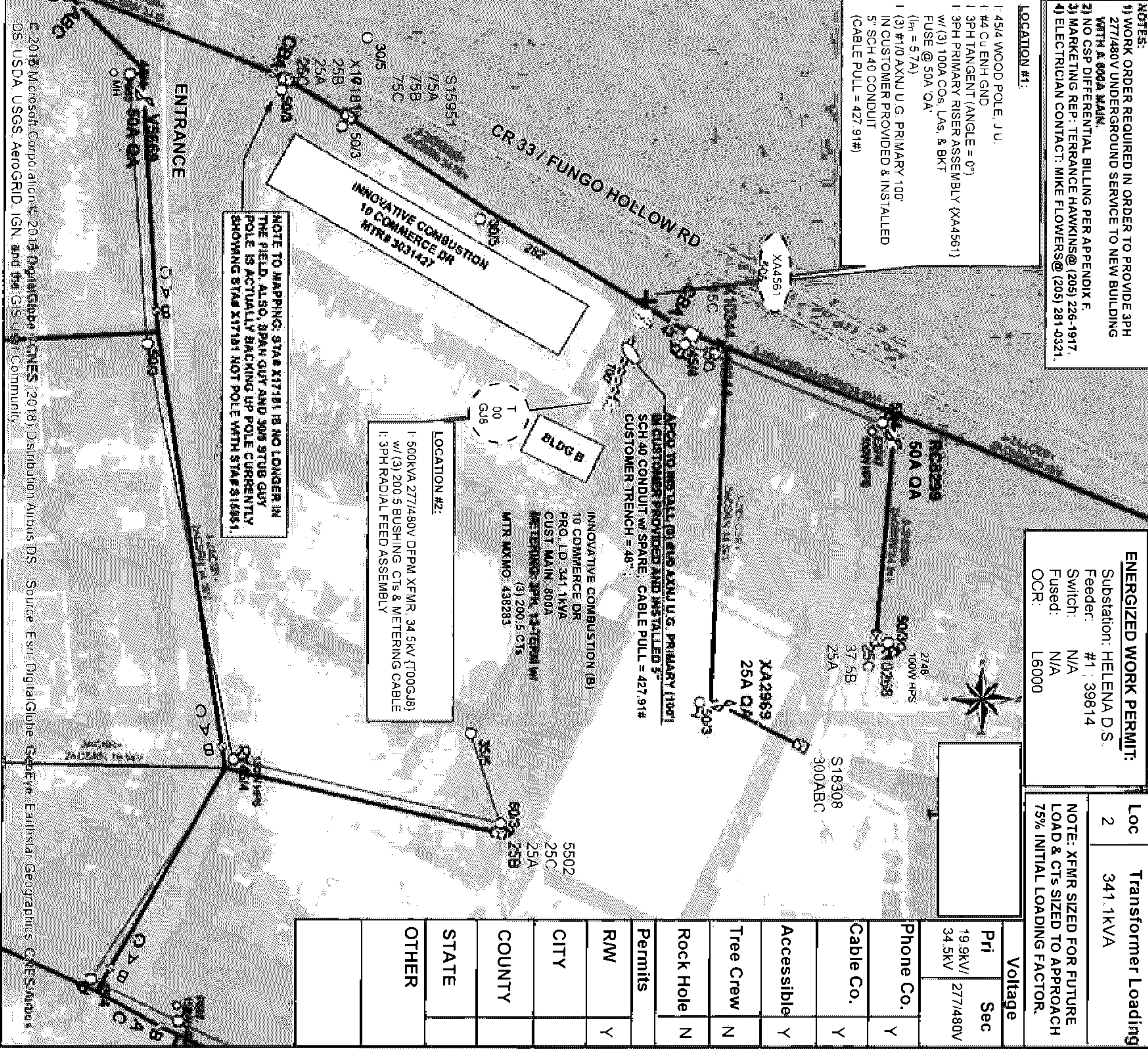
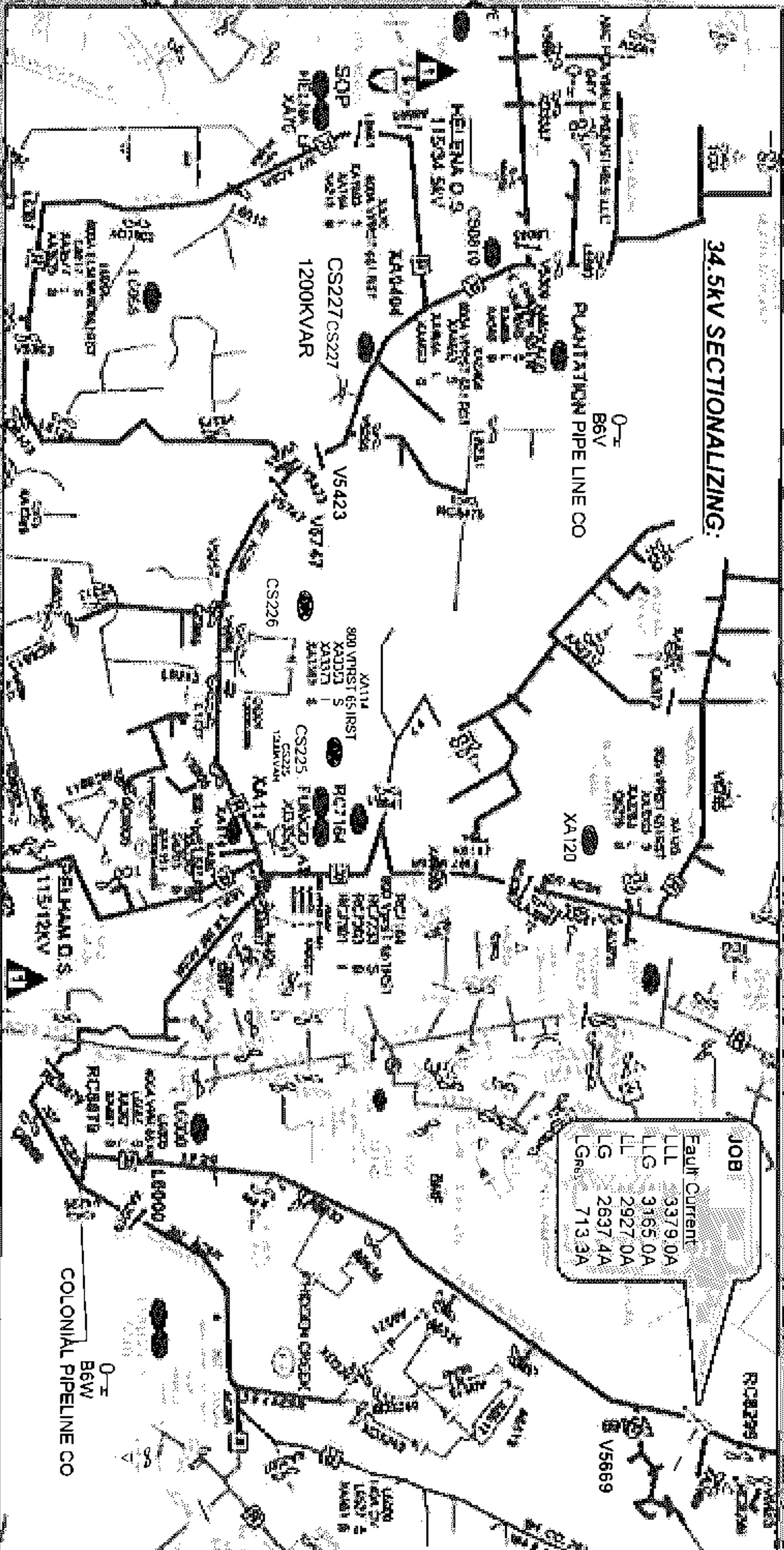
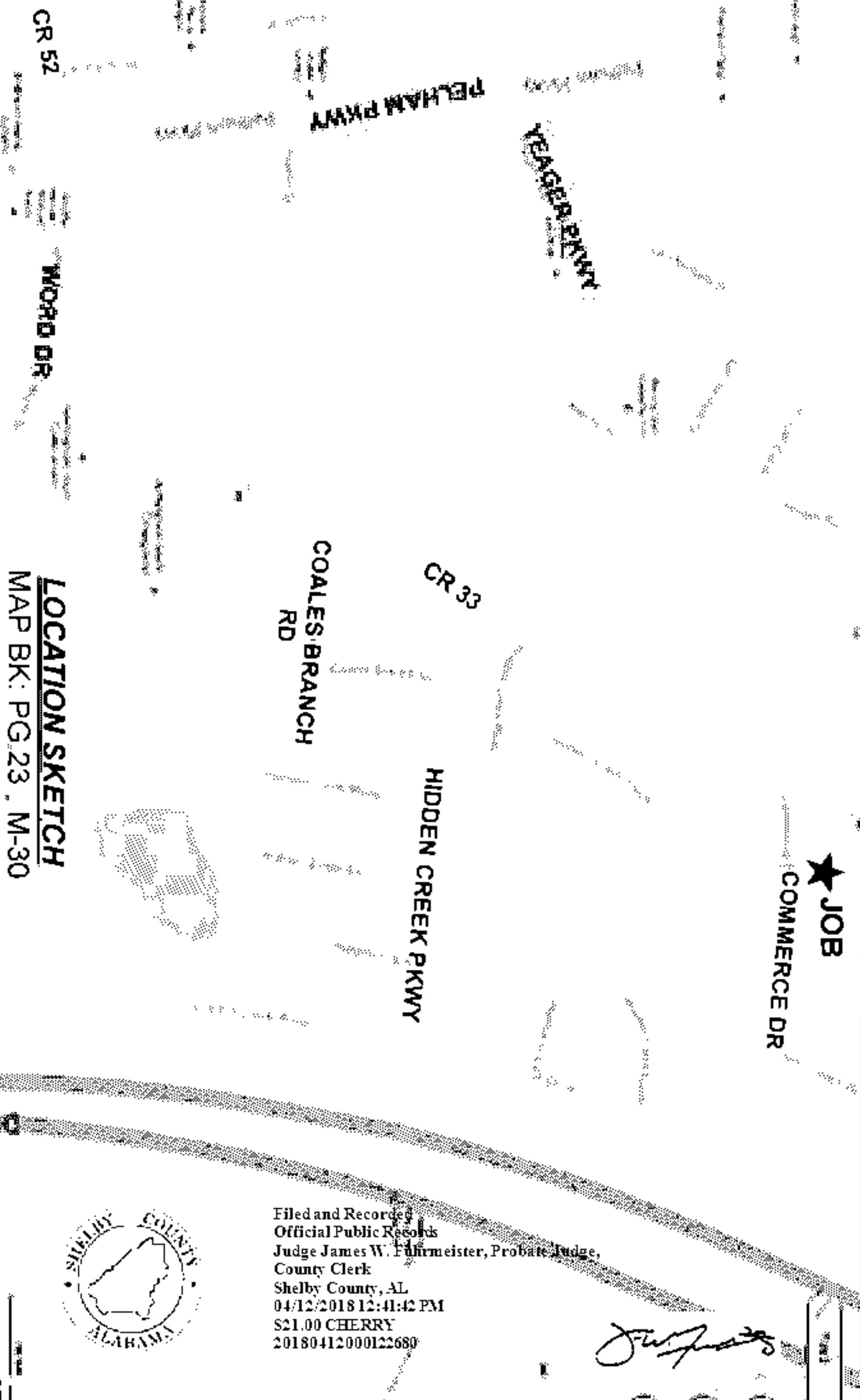

R/W Agent: Eric Brasher  
Date Assigned: 04/06/2018  
Date Cleared: 04/06/2018  
APC Doc#: 72235249-001