

Source of Title:
Instrument #20170718000256540
EASEMENT - UNDERGROUND

STATE OF ALABAMA
COUNTY OF SHELBY

W.E. No. A6170-14-CY17 *

APCO Parcel No. 72230307-001

Transformer No. S1919

This instrument prepared by: Dean Fritz

Alabama Power Company
2 Industrial Park Drive
Pelham, AL 35124

20171102000397520
11/02/2017 10:35:18 AM
ESMTAROW 1/3

KNOW ALL MEN BY THESE PRESENTS, That **CR Equities, LLC** as grantor(s), (the "Grantor", whether one or more) for and in consideration of One and No/100 Dollar (\$1.00) and other good and valuable consideration paid to Grantor in hand by Alabama Power Company, a corporation, the receipt and sufficiency of which are hereby acknowledged, does hereby grant to Alabama Power Company, its successors and assigns (the "Company"), the easements, rights and privileges described below.

The right from time to time to construct, install, operate and maintain upon, under and across the Property described below, all wires, cables, trans closures, transformers, conduits, fiber optics, communication lines and other facilities useful or necessary in connection therewith (collectively, the "Facilities"), for the underground transmission and distribution of electric power and communications, along a route selected by the Company which is generally shown on the Company's drawing attached hereto and made a part hereof and which is to be determined by the locations in which the Company's Facilities are installed, such drawing showing the general location of underground facilities in an area ten feet (10') in width and also the right to clear and keep clear a strip of land extending five feet (5') from each side of said Facilities. Grantor hereby grants to the Company all easements, rights and privileges necessary or convenient for the full enjoyment and use thereof, including without limitation the right of ingress and egress to and from the Facilities and the right to excavate for installation, replacement, repair and removal thereof; and also the right to cut, remove and otherwise keep clear any and all structures, obstructions or obstacles of whatever character, on, under, adjacent to, and above said Facilities.

The easements, rights and privileges granted hereby shall apply to, and the word "Property" as used in this instrument shall mean, the following real property situated in Shelby County, Alabama (the "Property"): A portion of a parcel of land located in the SW¼ of the NW¼ of Section 23, Township 22 South, Range 2 West, more particularly described in that certain instrument recorded in Instrument #20170718000256540, in the Office of the Judge of Probate of said county, Alabama.

In the event it becomes necessary or desirable for the Company from time to time to move any of the Facilities in connection with the construction or improvement of any public road or highway in proximity to the Facilities, Grantor hereby grants to the Company the right to relocate the Facilities and, as to such relocated Facilities, to exercise the rights granted above; provided, however, the Company shall not relocate the Facilities on the Property at a distance greater than ten feet (10') outside the boundary of the right of way of any such public road or highway as established or re-established from time to time. This grant and agreement shall be binding upon and shall inure to the benefit of Grantor, the Company and each of their respective heirs, personal representatives, successors and assigns and the words "Company" and "Grantor" as used in this instrument shall be deemed to include the heirs, personal representatives, successors and assigns of such parties.

TO HAVE AND TO HOLD the same to the said Company, its successors and assigns, forever.

IN WITNESS WHEREOF, the said Grantor, has caused this instrument to be executed by Kenneth Coreno, its authorized representative, as of the 4th day of October, 2017.

ATTEST (if required) or WITNESS:

CR Equities, LLC
(Grantor - Name of Corporation/Partnership/LLC)

By: _____

By: [Signature] (SEAL)

Its: _____

Its: member
(Indicate: President, General Partner, Member, etc]

For Alabama Power Company Corporate Real Estate Department Use Only Parcel No: 72230307-001

All facilities on Grantor: X

CORPORATION/LLC NOTARY

STATE OF Alabama

COUNTY OF Shelby

i. Christy L Higgins, a Notary Public, in and for said County in said State, hereby

certify that Kenneth Coreno, whose name as member of

CR Equities, LLC is signed to the foregoing instrument, and who is known to me, has acknowledged before me on this day that, being informed of the contents of this instrument, he/she as such member and with full authority, executed the same voluntarily for and as the act of said LLC.

Given under my hand and official seal, this the 4 day of October, 2017.

[SEAL]

Christy L Higgins
Notary Public

MY COMMISSION EXPIRES JUNE 27, 2020
My commission expires: _____

SKETCH OF PROPOSED WORK - SIMPLIFIED W.E.

Map Center UTM: 1724770 12017683

Map Center Lat/lon: 33 1053.76 -86.72441

1 inch = 50 feet



Customer Kenny Cost	Location 116 GREEN WOOD CIR	Map Center UTM: 1724770 12017683	Map Center Lat/lon: 33 1053.76 -86.72441	1 inch = 50 feet	Alabama Power
Division Birmingham	District Metro - Varnons	Town <i>Calera</i>	County Shelby	Section 23	Estimate No. A6170-14-CY17
		Created: 9/21/2017	Substation Calera DS	Range 02W	ADD'l Info. Kenny Cost
			X- 45192		MISSALL# N/A

Loc	Transformer Loading	Substation	ENERGIZED LINE WORK
S1919	89%	VD: 2.98%	OCB / OCB
2	FL: 4.15%	LL	SWITCH #
		LG	FUSE SIZE
		LG1	253
		SCHEME	280
			No

RW Agent *Dean Tritz*
Date Assigned *9-25-17*
Date Cleared *10-14-17*
Parcel # *72230307-001*

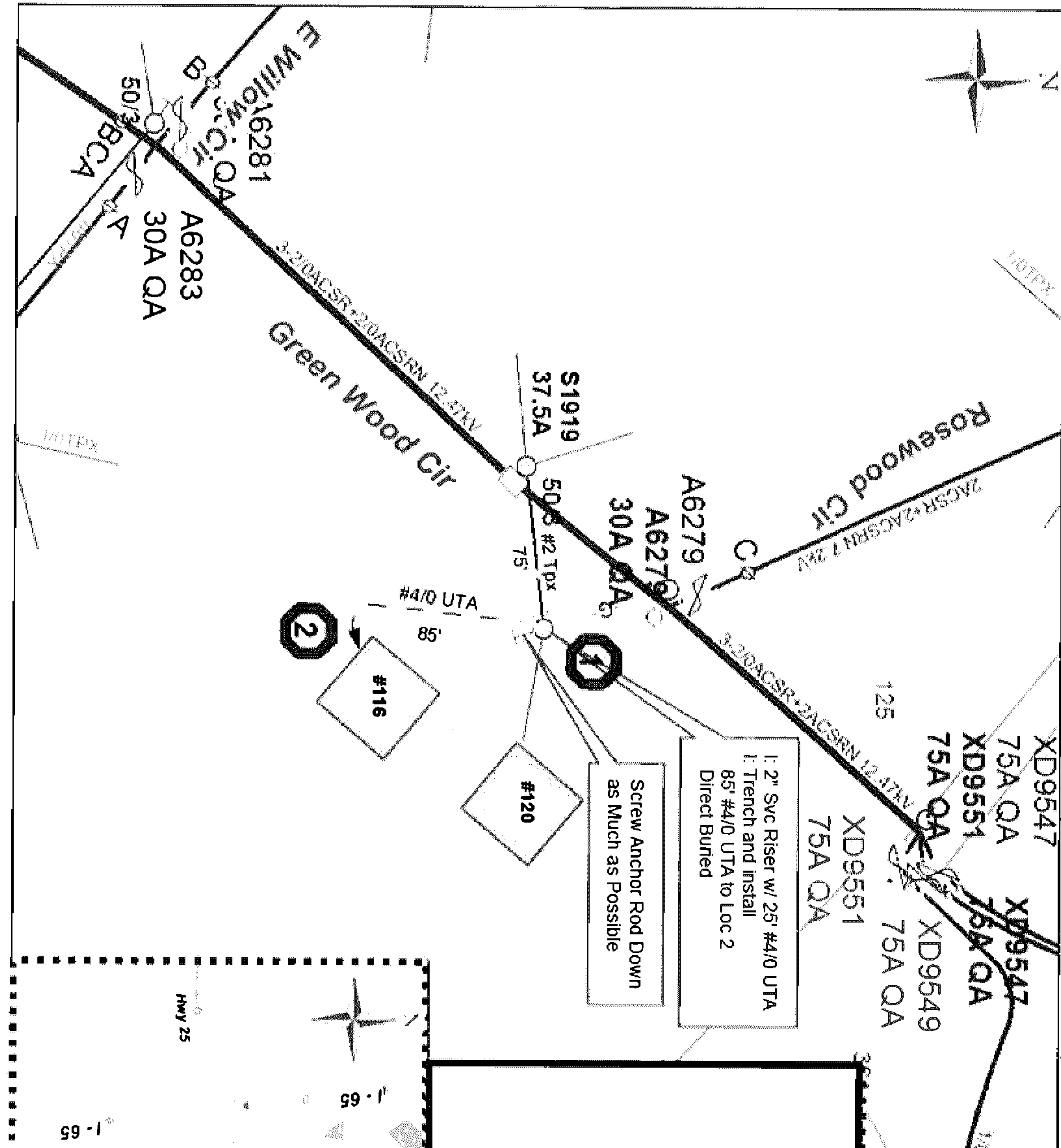

Loc	Transformer Loading	Substation	ENERGIZED LINE WORK
S1919	89%	VD: 2.98%	OCB / OCB
2	FL: 4.15%	LL	SWITCH #
		LG	FUSE SIZE
		LG1	253
		SCHEME	280
			No

Phone Co.	N
Cable Co.	N
Accessible	Y
Tree Crew	N
Rock Hole	N
Permits	N
RW	Y
CITY	N
COUNTY	N
STATE	N
OTHER	

Sketch 116 Green Wood Cir OH - UG Svc

Filed and Recorded
Official Public Records
Judge James W. Furrmeister, Probate Judge,
County Clerk
Shelby County, AL
11/02/2017 10:35:18 AM
\$21.50 DEBBIE
20171102000397520

