

APC Document # \_\_\_\_\_

Source of Title:  
Instrument #20151125000407430

EASEMENT – DISTRIBUTION FACILITIES

STATE OF ALABAMA  
COUNTY OF SHELBY  
This instrument prepared by: Dean Fritz

Alabama Power Company  
2 Industrial Park Drive  
Pelham, AL 35124

500.00

20170922000346250  
09/22/2017 12:53:57 PM  
ESMTAROW 1/2

KNOW ALL MEN BY THESE PRESENTS, That the undersigned Joshua Neil Blackerby and wife, Johnna Leigh Headley Blackerby

(hereinafter known as "Grantors", whether one or more) for and in consideration of One and No/100 Dollar (\$1.00) and other good and valuable consideration paid to Grantors in hand by Alabama Power Company, a corporation, the receipt and sufficiency of which are hereby acknowledged, do hereby grant to said Alabama Power Company, its successors and assigns (hereinafter the "Company"), the following easements, rights, and privileges:

**Overhead and/or Underground.** The right from time to time to construct, install, operate and maintain, upon, over, under and across the Property described below, all poles, towers, wires, conduits, fiber optics, cables, communication lines, translosures, transformers, anchors, guy wires, and other facilities useful or necessary in connection therewith (collectively, "Facilities"), for the overhead and/or underground transmission and distribution of electric power and communications, along a route selected by the Company, as determined by the location(s) in which the Company's facilities are to be installed. The width of the Company's right of way will depend on whether the Facilities are underground or overhead: for underground, the right of way will extend five (5) feet on all sides of said Facilities as and where installed; for overhead Facilities, the right of way will extend fifteen (15) feet on all sides of said Facilities as and where installed.

The Company is further granted all the rights or privileges necessary or convenient for the full enjoyment and use of said right of way for the purposes above described, including, without limitation, the right of ingress and egress to and from said Facilities, as applicable, the right to excavate for installation, replacement, repair and removal of said Facilities, the right in the future to install intermediate poles and facilities on said right of way, the right to install, maintain, and use anchors and guy wires on land adjacent to said right of way, and also the right to cut, remove, and otherwise keep clear any and all trees, undergrowth, structures, obstructions, or obstacles of whatever character, on, under and above said right of way, as applicable. Further, with respect to overhead Facilities, the Company is also granted the right to trim and cut, and keep trimmed and cut, all dead, weak, leaning or dangerous trees or limbs outside of the aforementioned right of way that, in the opinion of the Company, may now or hereafter endanger, interfere with, or fall upon any of said overhead Facilities.

The easements, rights and privileges granted hereby shall apply to, and the word "Property" as used in this instrument shall mean the real property more particularly described in that certain instrument recorded in Instrument #20151125000407430, in the Office of the Judge of Probate of the above named County.

In the event it becomes necessary or desirable for the Company from time to time to move any of the Facilities in connection with the construction or improvement of any public road or highway in proximity to the Facilities, Grantors hereby grant to the Company the right to relocate the Facilities and, as to such relocated Facilities, to exercise the rights granted above; provided, however, the Company shall not relocate said Facilities on the Property at a distance greater than ten feet (10') outside the boundary of the right of way of any such public road or highway as established or re-established from time to time. This grant and agreement shall be binding upon and shall inure to the benefit of Grantors, the Company and each of their respective heirs, personal representatives, successors and assigns and the words "Company" and "Grantors" as used in this instrument shall be deemed to include the heirs, personal representatives, successors and assigns of such parties.

TO HAVE AND TO HOLD the same to the Company, its successors and assigns, forever.

IN WITNESS WHEREOF, the undersigned Grantors have executed this instrument on this the 28<sup>th</sup> day of August, 2017.

Christiana Edmondson  
Witness Signature (non-relative)

Christiana Edmondson  
Print Name

Joshua Neil Blackerby (SEAL)  
(Grantor)

Joshua Neil Blackerby  
Print Name

Johnna Leigh Headley Blackerby (SEAL)  
(Grantor)

Johnna Leigh Headley Blackerby  
Print Name

For Alabama Power Company Corporate Real Estate Department Use Only

All facilities on Grantor: \_\_\_\_\_

Location to Location: loc 1+220 to loc 2+250; buy at loc 2+00

NW ¼ of the NE ¼ of Section 10, Township 24 North, Range 15 East

W.E. No. A6170-00-E217

Transformer No. T006GR

REV 3/15/16

SKETCH OF PROPOSED WORK - SIMPLIFIED W.E.

Map Center UTM:  
177807.6 E2010436

Map Center Lat/lon:  
33.084918 -86.556943

1 inch = 100 feet N.T.S.

Customer	Location	Comtd. Svc Date	County	Section	Township	Range	Add'l Info.	Estimate No.
KENNY COST	1239 HIGHWAY 46	11/30/2017	Shelby	10	2-35	15E		A6170-00-E217
Division	District	Town	UserID	Created:	Substation	Y-		MISSALL#
BIRMINGHAM- SOUTH	METRO SOUTH	SHELBY	#11507	8/18/2017	SPRING CREEK D.S.	X- 49152	Y- V6595	

Device Map:	WATER
Feeder:	49152
Equipment Type:	UL
	UL
	UL
	UL

ENERGIZED WORK PERMIT:  
Substation: SPRING CREEK D.S.  
Feeder: 49152  
Switch: V6595  
Fused: TS, OA  
OCB: N/A

Loc	Transformer Loading
2	12.4

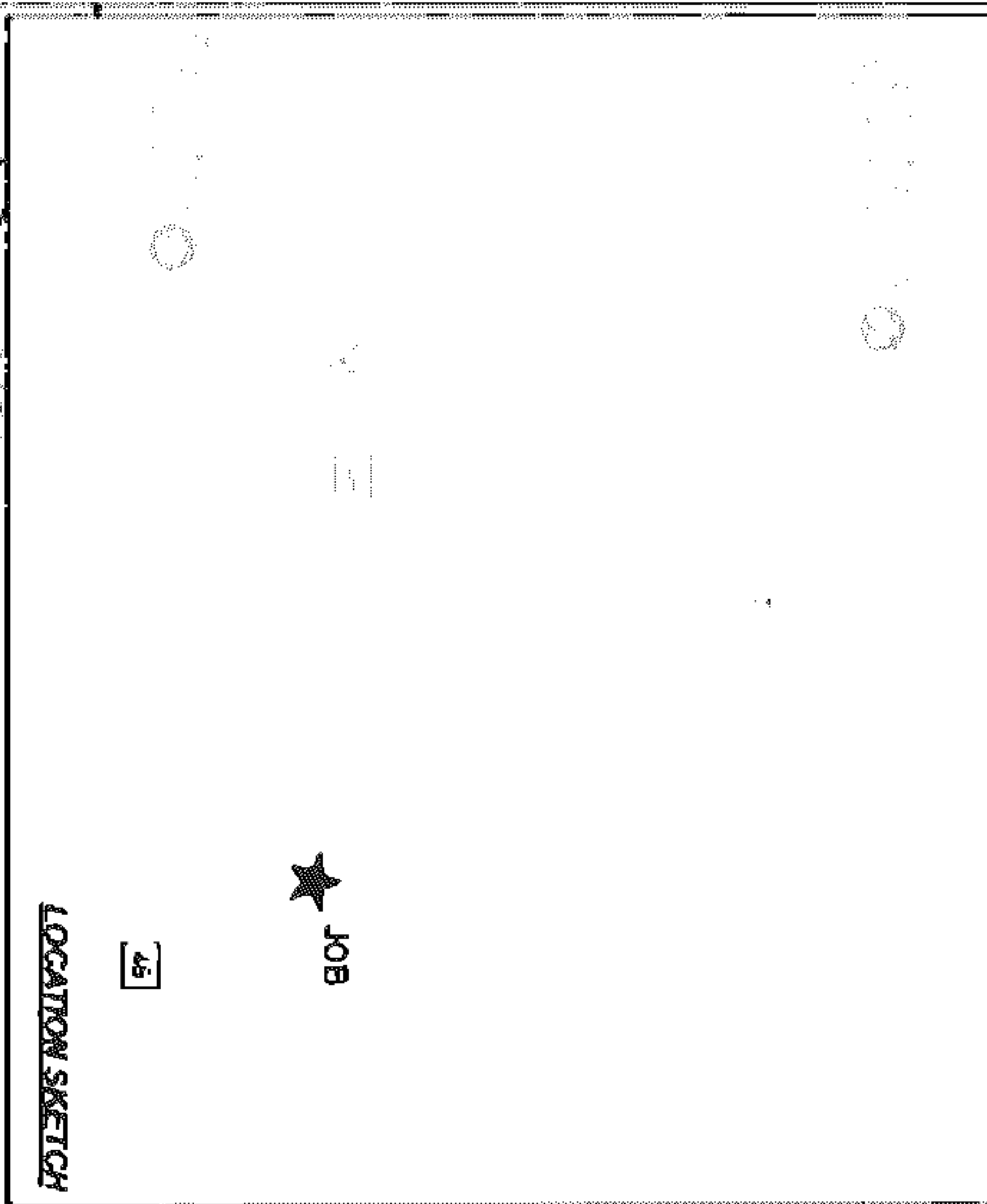

LOCATION #1:  
1. 10' PRIMARY D.E.  
2. 10' 450V 25ACSR 42ACSRN  
3. 10' 450V 1" ROD  
4. 10' 450V 1" ROD  
5. 10' 450V 1" ROD  
6. 10' 450V 1" ROD  
7. 10' 450V 1" ROD  
8. 10' 450V 1" ROD  
9. 10' 450V 1" ROD  
10. 10' 450V 1" ROD

NOTE:  
2000 SQ. FT.  
ALL ELECTRIC  
4 TON HP  
PRO FL: 4.05%  
PRO VD: 1.73%

NOTE:  
PERIOD TO INSTALL IN FROM OF 450V UTA U.G.  
SERVICE (250') TO BE DIRECT BURIED IN  
COMPANY PROVIDED TRENCHING - 36"

NOTE:  
1. 400A METER  
2. 400A METER SOCKET

RW Agent Ben Fritz  
Date Assigned 8-25-17  
Date Cleared 8-29-17  
Parcel # \_\_\_\_\_

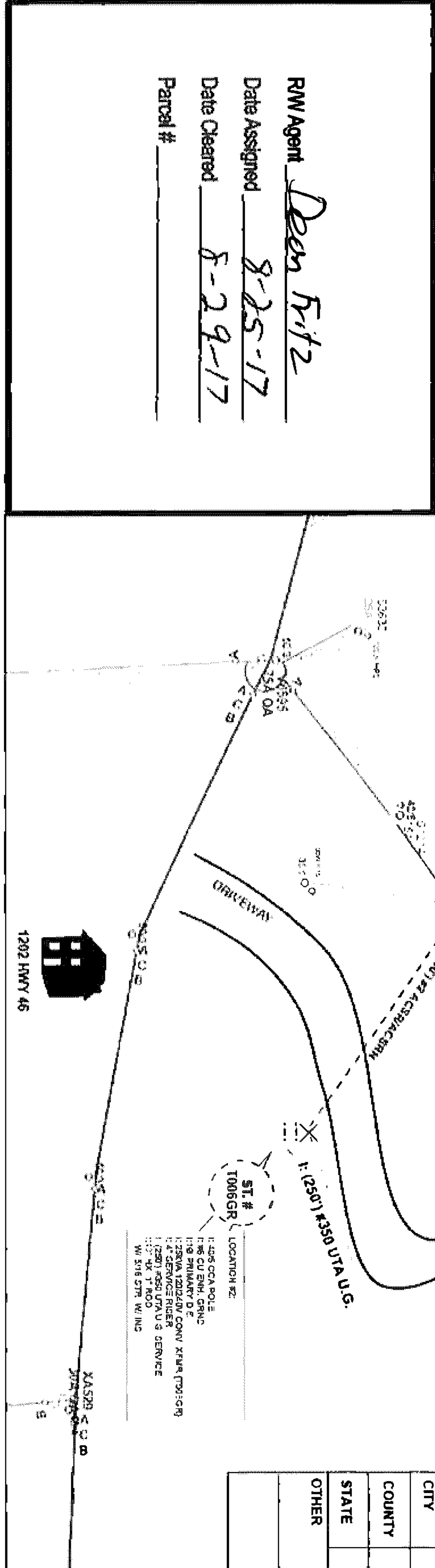

LOCATION #2:  
1. 400A METER  
2. 400A METER SOCKET  
3. 400A METER SOCKET  
4. 400A METER SOCKET  
5. 400A METER SOCKET  
6. 400A METER SOCKET  
7. 400A METER SOCKET  
8. 400A METER SOCKET  
9. 400A METER SOCKET  
10. 400A METER SOCKET

Phone Co.	N
Cable Co.	N
Accessible	Y
Tree Crew	N
Rock Hole	N
Permits	
R/W	N
CITY	
COUNTY	
STATE	
OTHER	



Filed and Recorded  
Official Public Records  
Judge James W. Fuhrmeister, Probate Judge,  
County Clerk  
Shelby County, AL  
09/22/2017 12:53:57 PM  
\$18.50 CHERRY  
20170922000346250

*Ben Fritz*