

ORDINANCE NUMBER 2016-04-26-192

WHEREAS, on the 20th day of April, 2016, Norvell, Marvin B Jr, & Mary M & Vicens, Susan N filed a petition with the City of Westover, Alabama as required by §§ 11-42-20 and 11-42-21, Code of Alabama 1975, as amended, petitioning and requesting that the property hereinafter described be annexed to the municipality of the City of Westover, Alabama, which petition contained an accurate description of the property proposed to be annexed together with a map of said property showing its relationship to the corporate limits of the City of Westover, Alabama, and the signatures of the owners of the property described were signed thereto:

NOW, THEREFORE, BE IT ORDAINED BY THE CITY COUNCIL OF THE CITY OF WESTOVER, ALABAMA, AS FOLLOWS:

1. That the City of Westover, Alabama does adopt this ordinance assenting to the annexation of the following described property to the municipality of the City of Westover:

EXHIBIT A

Parcel # 08-8-33-0-000-010.000

2. That the corporate limits of the City of Westover, Alabama be extended and rearranged so as to embrace and include such property and such property shall become a part of the corporate area of such municipality upon the date of publication or posting of this Ordinance, as provided for in the Code of Alabama as cited above.
3. That the City Clerk be and is hereby authorized and directed to file a copy of this Ordinance, including an accurate description of the property being annexed, together with a map of the said property, showing its relationship to the corporate limits of the City of Westover, Alabama, to which said property is being annexed, in the office of the Judge of Probate of Shelby County, Alabama.
4. That the Zoning Map of the City of Westover, Alabama and any other official maps of surveys of the City shall be amended to reflect the annexation of the above-described property, and that a copy of this Ordinance be transmitted to the City Planning Commission.

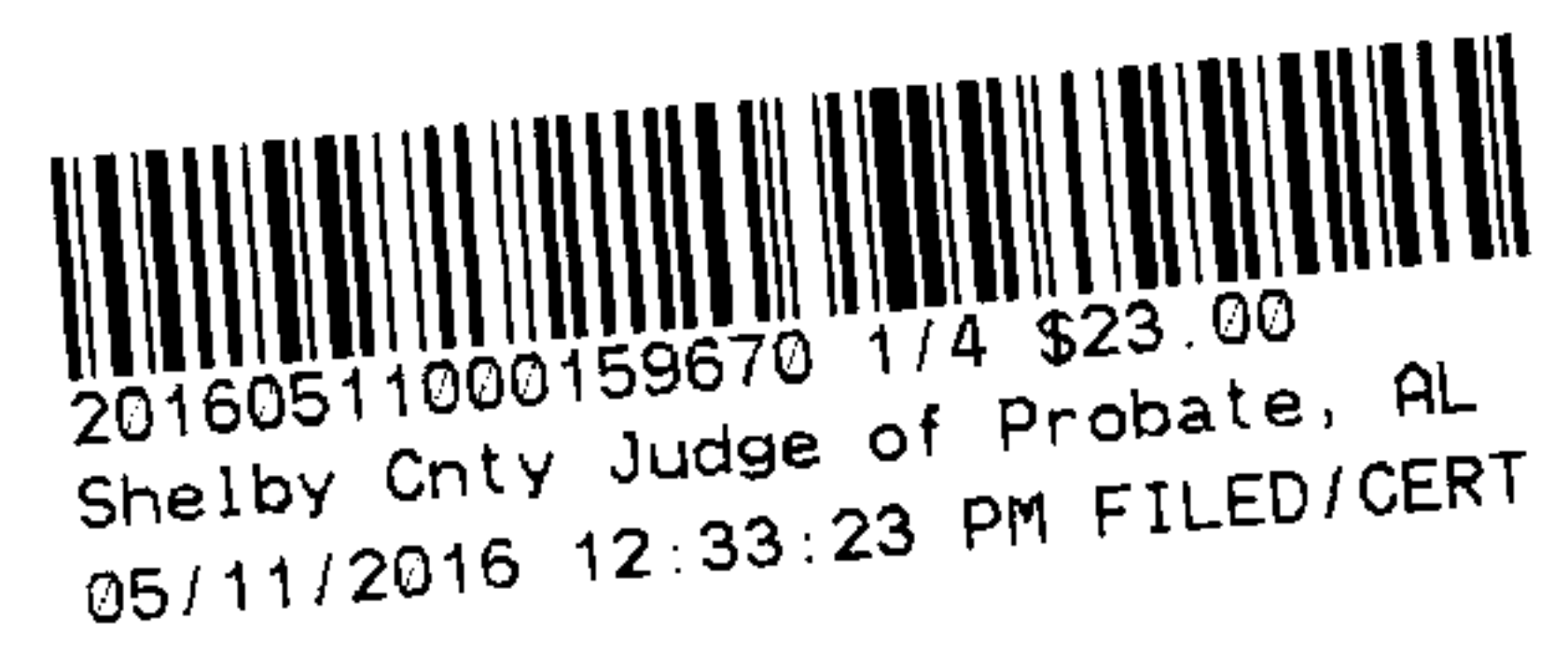

5. That this property is temporarily zoned AP, as provided in the Zoning Ordinance of the City of Westover, Alabama.

This Ordinance was adopted and passed by the City Council of the City of Westover, Alabama, this 3rd day of May 2016

20160511000159670 2/4 \$23.00
Shelby Cnty Judge of Probate, AL
05/11/2016 12:33:23 PM FILED/CERT

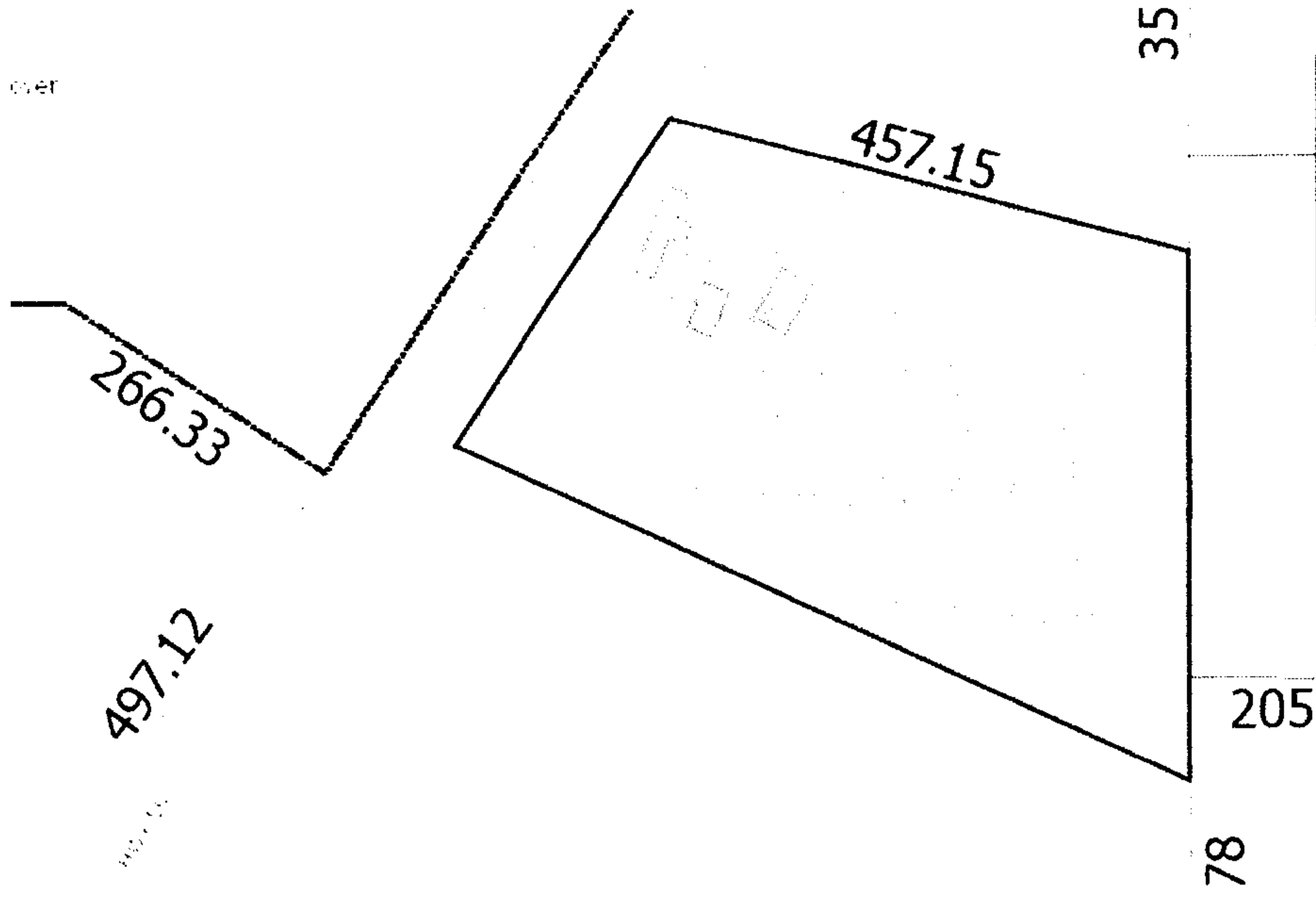

Owner Information
 Tax Year: 2016
 NORVELL MARVIN B JR & MARY M
 & VICENS SUSAN M
 3171 WOODBRIDGE DR
 BIRMINGHAM, AL 35242
 Parcel Number: 08 8 33 0 000 010.000

Site Information
 Municipal Code: 1 - Unincorporated
 School District: 2
 Subdivision:
 Primary Lot:
 Secondary Lot:
 Block: 000
 Section: 33
 Township: 19S
 Range: 01E

20160511000159670 3/4 \$23.00
 Shelby Cnty Judge of Probate, AL
 05/11/2016 12:33:23 PM FILED/CERT

RECORDER'S MEMORANDUM
At the time of recordation, this instrument was found to be inadequate for the best photographic reproduction.

**PETITION FOR ANNEXATION
TOWN OF WESTOVER, AL.**

APR 28 2016

The undersigned owner(s) of the property described below, which is described in the attached "Exhibit A" and is contiguous to the corporate limits of Westover, Alabama do hereby petition the town of Westover to annex said property into the corporate limits of the municipality.

Name of Land Owner: MARVIN A NORVELL, JR
MARY M NORVELL
SUZAN NORVELL VIGUS

Property Address: 8546 HWY 55 SOUTH, WESTOVER, AL 35185
3171 WOODBRIDGE LN

Home Address City/State/Zip Code: BIANCAHOLM, AL 35242

Telephone Number: 205-991-5602

Parcel ID Number: 048330000010000
(As listed on property tax notice)

Number of registered voters residing at this Parcel: 1

SIGNATURE OF PROPERTY OWNER(S)

(All owners listed on the deed must sign)

Marvin Norvell, Jr

4/20/16

Date

Mary M Norvell

4/20/16

Date

Suzanne Norvell Vigus

4-20-16

Date

**PLEASE RETURN COMPLETED PETITION IMMEDIATELY TO THE PERSON PROVIDING THE PETITION, OR MAIL TO:
WESTOVER ANNEXATION COMMITTEE • P.O. BOX 356 • WESTOVER, AL
35185 Phone 205-678-3375**

20160511000159670 4/4 \$23.00
Shelby Cnty Judge of Probate, AL
05/11/2016 12:33:23 PM FILED/CERT