

EASEMENT – DISTRIBUTION FACILITIES

STATE OF ALABAMA

COUNTY OF SHELBY

W.E. No. A6272-00-BX15

APCO Parcel No. 70274416

Transformer No. 8204

This instrument prepared by: Patrick Robinson

Alabama Power Company
700 Martin St. S
Pell City, AL 35128

500.00



20151006000350340 1/2 \$17.50
Shelby Cnty Judge of Probate, AL
10/06/2015 01:07:41 PM FILED/CERT

Shelby County, AL 10/06/2015
State of Alabama
Deed Tax: \$.50

KNOW ALL MEN BY THESE PRESENTS, That Abraham L. Davis Jr. and his wife, Dorothy Davis; A.K.A. Abraham L. Davis, Jr. and his wife, Dorothy R. Davis as grantor(s), (the "Grantor", whether one or more) for and in consideration of One and No/100 Dollar (\$1.00) and other good and valuable consideration paid to Grantor in hand by Alabama Power Company, a corporation, the receipt and sufficiency of which are hereby acknowledged, does hereby grant to Alabama Power Company, its successors and assigns (the "Company"), the easements, rights and privileges below.

Overhead and/or Underground. The right from time to time to construct, install, operate and maintain, upon, over, under and across the Property described below, all poles, towers, wires, conduits, fiber optics, cables, communication lines, translosures, transformers, anchors, guy wires and other facilities useful or necessary in connection therewith (collectively, "Facilities"), for the overhead and/or underground transmission and distribution of electric power and communications, along a route selected by the Company, as generally shown on the Company's drawing attached hereto and made a part hereof, but which is to be determined by the actual location(s) in which the Company's facilities are installed. The width of the Company's easement will depend on whether the Facilities are underground or overhead: for underground, the easement will extend five (5) feet on each side of said Facilities as and where installed; for overhead Facilities, the easement will extend fifteen (15) feet on each side of the centerline of said Facilities as and where installed. The Company is granted the right to clear, and keep clear, all trees, undergrowth and other obstructions on a strip of land extending five (5) feet from each side of said underground Facilities, and to clear, and keep clear, all trees, undergrowth and other obstructions on a strip of land extending fifteen (15) feet from each side of the centerline of said overhead Facilities and the right in the future to install intermediate poles and facilities on said strip. Further, with respect to overhead Facilities, the Company is also granted the right to trim and cut, and keep trimmed and cut, all dead, weak, leaning or dangerous trees or limbs outside of the thirty (30) foot strip that, in the sole opinion of the Company, may now or hereafter endanger, interfere with, or fall upon any of said overhead Facilities.

Grantor hereby grants to the Company all easements, rights and privileges necessary or convenient for the full enjoyment and use thereof, including without limitation the right of ingress and egress to and from said Facilities, as applicable, and the right to excavate for installation, replacement, repair and removal thereof; and also the right to cut, remove and otherwise keep clear any and all structures, obstructions or obstacles of whatever character, on, under and above said Facilities, as applicable.

The easements, rights and privileges granted hereby shall apply to, and the word "Property" as used in this instrument shall mean, the following described real property situated in Shelby County, Alabama (the "Property"):
A parcel of land located in the NW 1/4 of the NE 1/4 of Section 22, Township 19 South, Range 02 East, more particularly described in that certain instrument recorded in deed instrument 20080606000236030, in the office of the Judge of Probate, Shelby county, Alabama.

In the event it becomes necessary or desirable for the Company from time to time to move any of the Facilities in connection with the construction or improvement of any public road or highway in proximity to the Facilities, Grantor hereby grants to the Company the right to relocate the Facilities and, as to such relocated Facilities, to exercise the rights granted above; provided, however, the Company shall not relocate said Facilities on the Property at a distance greater than ten feet (10') outside the boundary of the right of way of any such public road or highway as established or re-established from time to time. This grant and agreement shall be binding upon and shall inure to the benefit of Grantor, the Company and each of their respective heirs, personal representatives, successors and assigns and the words "Company" and "Grantor" as used in this instrument shall be deemed to include the heirs, personal representatives, successors and assigns of such parties.

TO HAVE AND TO HOLD the same to the Company, its successors and assigns, forever.

IN WITNESS WHEREOF, the undersigned Grantor has executed this instrument on this the 2nd day of September, 2015.

Branch Johnson
Witness Signature

Brandon Johnson
Print Name

Branch Johnson
Witness Signature

Brandon Johnson
Print Name

Abraham L. Davis Jr. (SEAL)
(Grantor)

Abraham L Davis Jr.
Print Name

Dorothy Davis (SEAL)
(Grantor)

Dorothy Davis
Print Name

All facilities on Grantor.
less and except road right of way.

Parcel # 70274416

1 inch = 50 feet

Customer	Location	Comtd. Svc Date	County	Section	Township	Range	Add'l Info.	Estimate No.
ABRAHAM DAVIS	65 MILAM DR		Shelby	22	19S	02E		A627200BX15
Division Eastern	District Oak Grove	Town Vincent	UserID bmjohuso	Created:	Substation X- 21684		Y- EB1545	MISSALL# 152451156 Start 09/04/15 End 09/21/15 Update 09/17/15

ENERGIZED LINE WORK	Loc	Transformer Loading
Sub Harpersville#1 21684	#8204	6 kVA
OCR EB340		
Switch# EB1545		
Fuse Size 75A OA		

Voltage	
Pr	Sec
12.47kV	120/ 240V

Phone Co.	
Cable Co.	

Accessible		
------------	--	--

Tree Crew		
-----------	--	--

Rock Hole	
Permits	

R/W	CITY
-----	------

COUNTY	
--------	--

STATE	
OTHER	

T

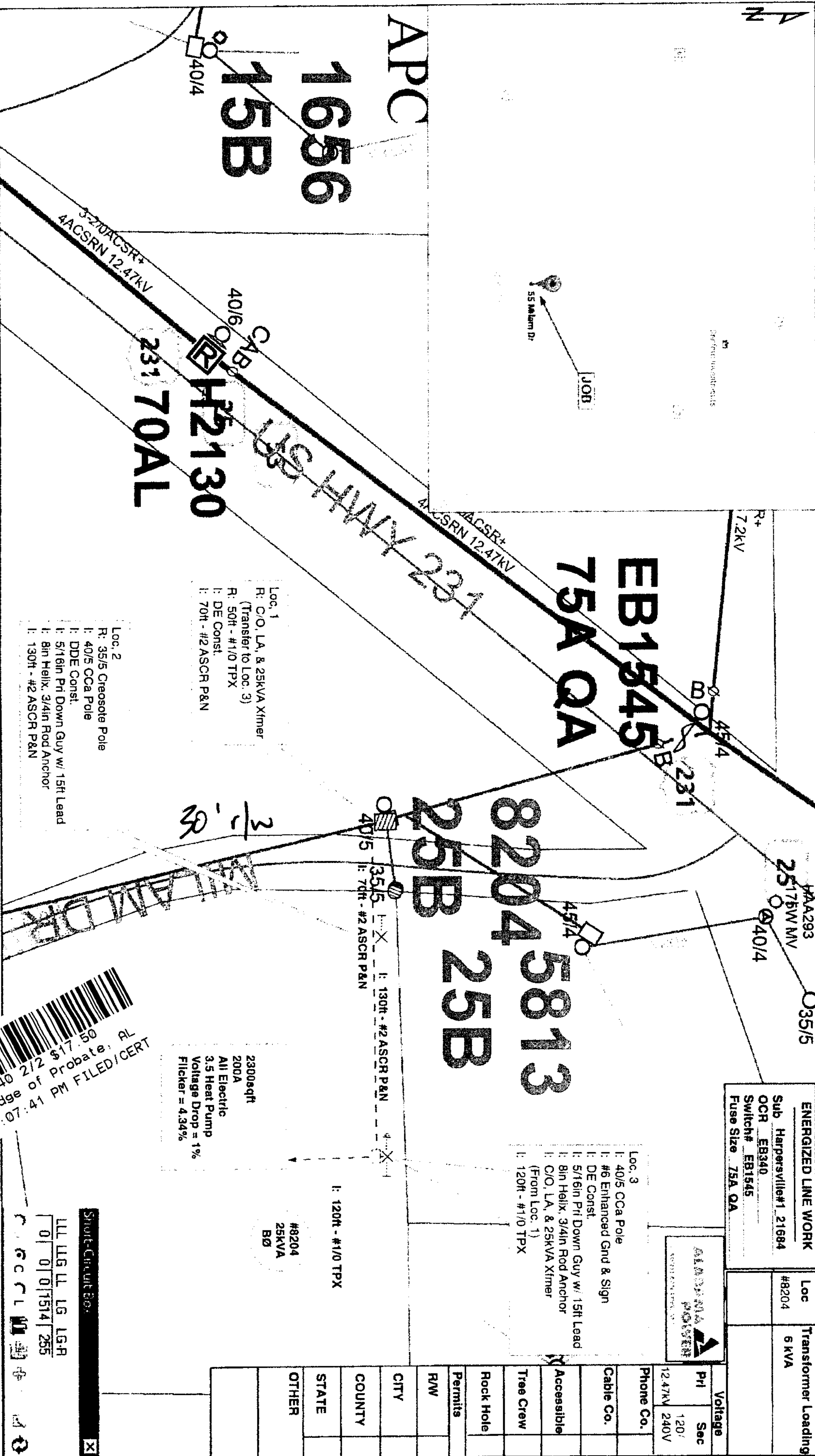

20151006000350340 2/2 \$17.50
Shelby Cnty Judge of Probate, AL
10/06/2015 01:07:41 PM FILED/CERT

Short-Circuit Box

0	0	0	1514	255
---	---	---	------	-----

700