



20150824000293520 1/2 \$18.00
Shelby Cnty Judge of Probate, AL
08/24/2015 12:11:52 PM FILED/CERT

AN EASEMENT
FOR THE CONSTRUCTION, OPERATION, AND MAINTENANCE
OF UTILITIES BY THE CITY OF CALERA

This EASEMENT, executed this 1st day of July, 2015, for the construction, operation, and maintenance of utilities with appurtenances, by The City of Calera, hereinafter called the OWNER across the property of the LANDOWNER, Jason & Andrea Lucia., as shown on the attached sketch, is granted by the LANDOWNER to the OWNER for valuable considerations, the receipt and sufficiency of which are acknowledged by the LANDOWNER, for himself, and his heirs, executors, successors, and assigns.

One permanent easement, to go with the land to allow the OWNER, its employees and agents to construct, operate, repair, and maintain the OWNER'S utilities including the right of access by the OWNER, its employees and agents, or officials, and necessary related equipment. Included is the right to uncover the utilities, with the obligation to leave the LANDOWNER'S property in good repair after completion of any repair to the utilities.

The easement is described as follows:

Located in the City of Calera, Shelby County, Alabama a 15-foot wide permanent utility easement. Being in the most north western corner of said parcel and following along Cypress Lake Road as shown on the attached sketch.

Executed the date above in four copies.

LANDOWNER:

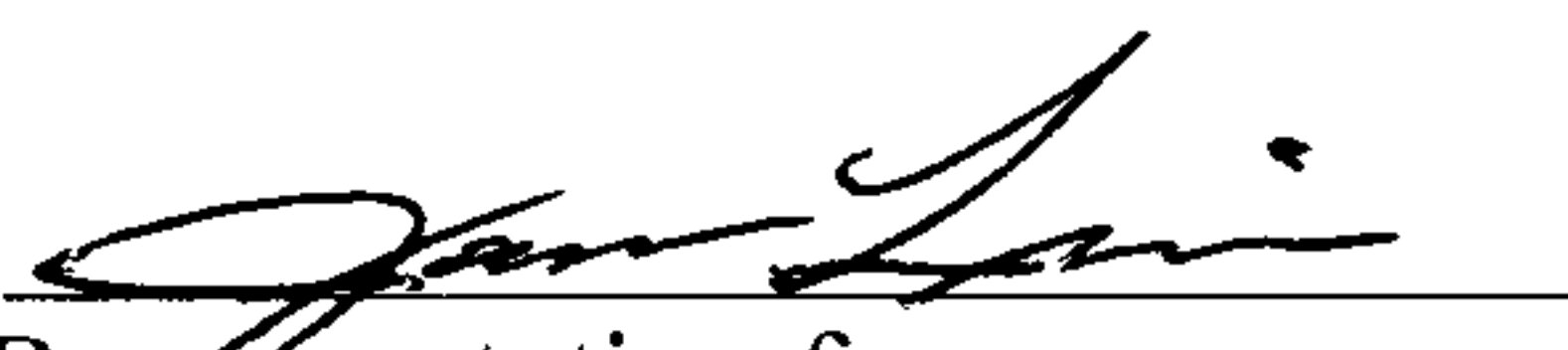
By: 
Representative for
Jason & Andrea Lucia.

WITNESS:

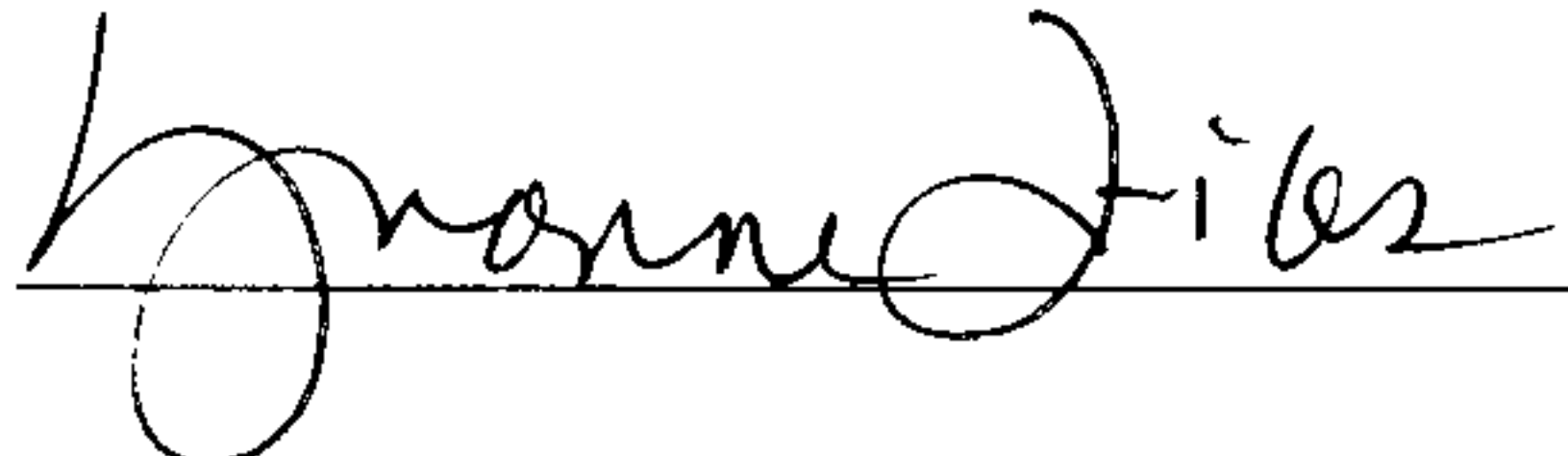
By: 

For the City of Calera

By: 
Jon G. Graham, Mayor

WITNESS:

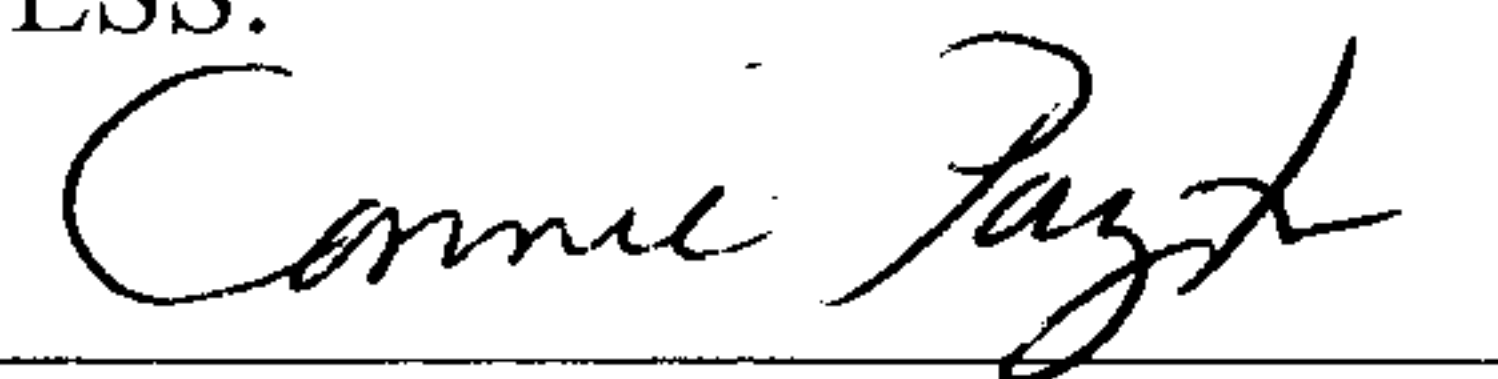
By: 
Connie Payton, City Clerk

Recorded the _____ day of _____, 2015 in Deed Book _____ Page _____,
Of public records of Shelby County, Alabama.

Parcel I.D. No. 34-3-06-0-000-008.002

20150824000293520 2/2 \$18.00
Shelby Cnty Judge of Probate, AL
08/24/2015 12:11:52 PM FILED/CERT



GRAPHIC SCALE
1" = 200'

Lucia Jason E & Andrea B
Parcel Number
34-3-06-0-000-001.001

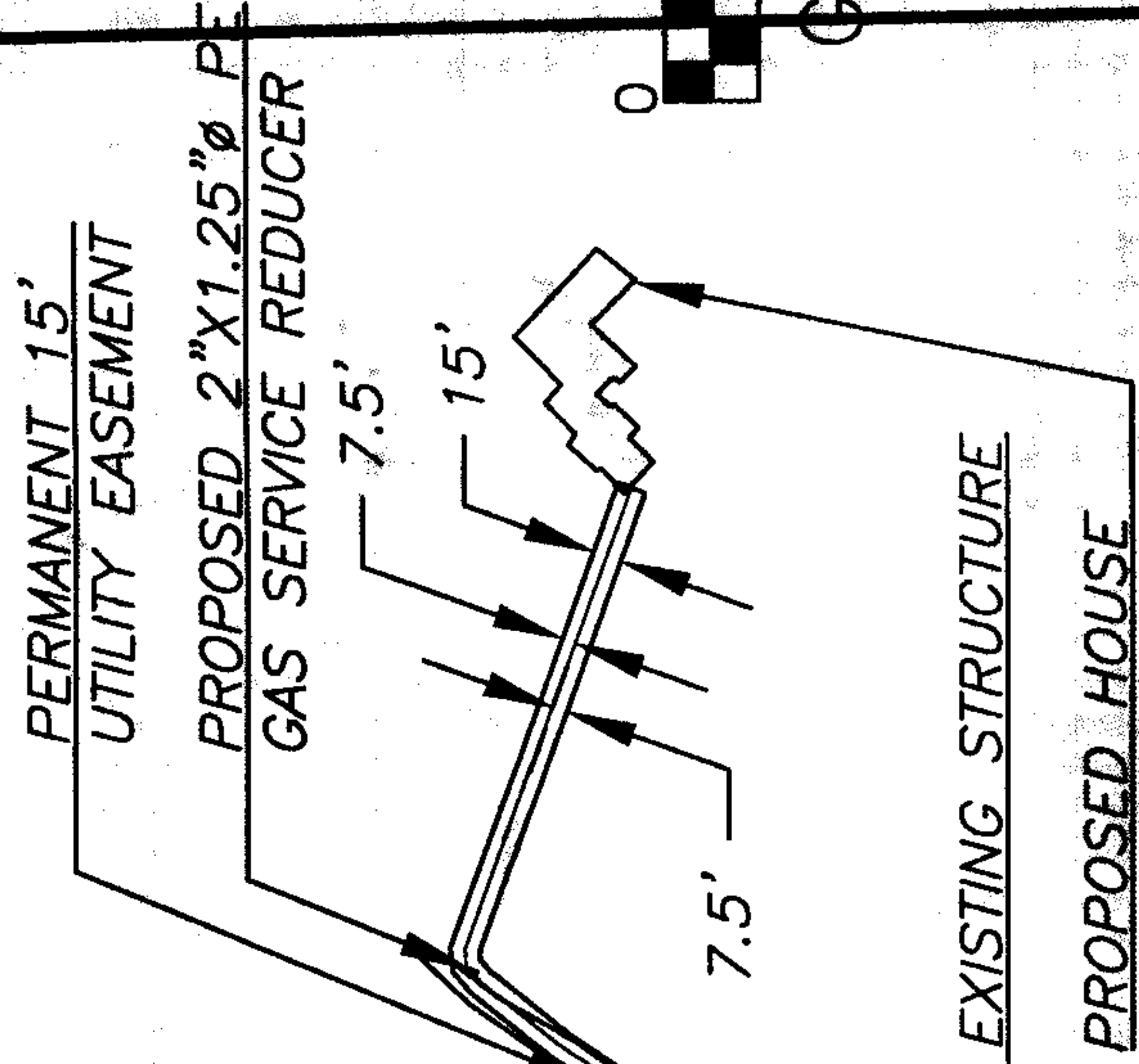

PROPOSED 2"Ø PE
GAS SERVICE

PROPOSED 1.25"Ø PE
GAS STUBOUT & VALVE
PERMANENT 15'
UTILITY EASEMENT

CYPRESS LAKE ROAD

Lucia Jason E & Andrea B
Parcel Number
34-3-06-0-000-008.002

CALERA
ALABAMA

CITY OF CALERA
ENGINEERING DEPARTMENT
1070 10TH STREET
CALERA, ALABAMA 36040
PHONE (205) 668-3821 FAX (205) 668-3821