

EASEMENT – DISTRIBUTION FACILITIES

STATE OF ALABAMA

COUNTY OF SHELBY

W.E. No. A6170-05-AP15

APCO Parcel No. 70271443

Transformer No. S3997

This instrument prepared by: Shannon D. Floyd

Alabama Power Company  
P. O. Box 2641  
Birmingham, Alabama 35291



20150619000206480 1/2 \$17.50  
Shelby Cnty Judge of Probate, AL  
06/19/2015 11:54:41 AM FILED/CERT

KNOW ALL MEN BY THESE PRESENTS, That Edwin B. Lumpkin, Jr., an unmarried man,

as grantor(s), (the "Grantor", whether one or more) for and in consideration of One and No/100 Dollar (\$1.00) and other good and valuable consideration paid to Grantor in hand by Alabama Power Company, a corporation, the receipt and sufficiency of which are hereby acknowledged, does hereby grant to Alabama Power Company, its successors and assigns (the "Company"), the easements, rights and privileges below.

**Overhead and/or Underground.** The right from time to time to construct, install, operate and maintain, upon, over, under and across the Property described below, all poles, towers, wires, conduits, fiber optics, cables, communication lines, trans closures, transformers, anchors, guy wires and other facilities useful or necessary in connection therewith (collectively, "Facilities"), for the overhead and/or underground transmission and distribution of electric power and communications, along a route selected by the Company, as generally shown on the Company's drawing attached hereto and made a part hereof, but which is to be determined by the actual location(s) in which the Company's facilities are installed. The width of the Company's easement will depend on whether the Facilities are underground or overhead: for underground, the easement will extend five (5) feet on each side of said Facilities as and where installed; for overhead Facilities, the easement will extend fifteen (15) feet on each side of the centerline of said Facilities as and where installed. The Company is granted the right to clear, and keep clear, all trees, undergrowth and other obstructions on a strip of land extending five (5) feet from each side of said underground Facilities, and to clear, and keep clear, all trees, undergrowth and other obstructions on a strip of land extending fifteen (15) feet from each side of the centerline of said overhead Facilities and the right in the future to install intermediate poles and facilities on said strip. Further, with respect to overhead Facilities, the Company is also granted the right to trim and cut, and keep trimmed and cut, all dead, weak, leaning or dangerous trees or limbs outside of the thirty (30) foot strip that, in the sole opinion of the Company, may now or hereafter endanger, interfere with, or fall upon any of said overhead Facilities.

Grantor hereby grants to the Company all easements, rights and privileges necessary or convenient for the full enjoyment and use thereof, including without limitation the right of ingress and egress to and from said Facilities, as applicable, and the right to excavate for installation, replacement, repair and removal thereof; and also the right to cut, remove and otherwise keep clear any and all structures, obstructions or obstacles of whatever character, on, under and above said Facilities, as applicable.

The easements, rights and privileges granted hereby shall apply to, and the word "Property" as used in this instrument shall mean, the following described real property situated in SHELBY County, Alabama (the "Property"): a parcel of land located in the SW ¼ of the SE ¼ of Section 33, Township 21 South, Range 2 West, more particularly described in that certain instrument recorded in instrument numbers 20060414000174650 and 20020708000314170, in the office of the Judge of Probate of said County.

In the event it becomes necessary or desirable for the Company from time to time to move any of the Facilities in connection with the construction or improvement of any public road or highway in proximity to the Facilities, Grantor hereby grants to the Company the right to relocate the Facilities and, as to such relocated Facilities, to exercise the rights granted above; provided, however, the Company shall not relocate said Facilities on the Property at a distance greater than ten feet (10') outside the boundary of the right of way of any such public road or highway as established or re-established from time to time. This grant and agreement shall be binding upon and shall inure to the benefit of Grantor, the Company and each of their respective heirs, personal representatives, successors and assigns and the words "Company" and "Grantor" as used in this instrument shall be deemed to include the heirs, personal representatives, successors and assigns of such parties.

TO HAVE AND TO HOLD the same to the Company, its successors and assigns, forever.

IN WITNESS WHEREOF, the undersigned Grantor has executed this instrument on this the 11<sup>th</sup> day of JUNE, 2015.

[Signature]  
Witness Signature  
SONATHAN DENTON  
Print Name

\_\_\_\_\_  
Witness Signature  
\_\_\_\_\_  
Print Name

Edwin B. Lumpkin Jr (SEAL)  
Edwin B. Lumpkin, Jr. (Grantor)  
\_\_\_\_\_  
Print Name  
\_\_\_\_\_  
(Grantor)  
\_\_\_\_\_  
Print Name

Shelby County, AL 06/19/2015  
State of Alabama  
Deed Tax: \$.50

*All on Grantor*



SKETCH OF PROPOSED WORK - SIMPLIFIED W.E.

Map Center UTM: 1716541 12039901

Map Center Lat/lon: 33.155467 -86.751183

1 inch = 55 feet

ALABAMA POWER

Customer	The Camo Hut-Fireworks Stand	Location	4570 US Hwy 31	Comtd. Svc Date	Aug. 31, 2015	County	SHELBY	Section	33	Township	21S	Range	02W	Estimate No.	A6170-05-AP15	Missall No.	Work Date
Division	Birmingham	District	Metro South-Varnons	Town	Calera	UserID	rtboyd	Created:	6/8/2015	Substation	Longview DS (12kV)	X-	48876	Y-	XA1827	Time Update	

- Notes:
- 1) Customer: Matt Lalley @ 2000W HPS
  - 2) New X'tmr Load: 8 KVA  
Existing X'tmr Load: 7.5 KVA  
Volt. Drop = 2.77%; Flicker = 3.37%
  - 3) Upgrading #4 Duplex to #1/0 Triplex for New, 1Ø, 120/208V, 200Amp Service to Fireworks Stand
  - 4) Billing to Customer: Out of Ratio Charges

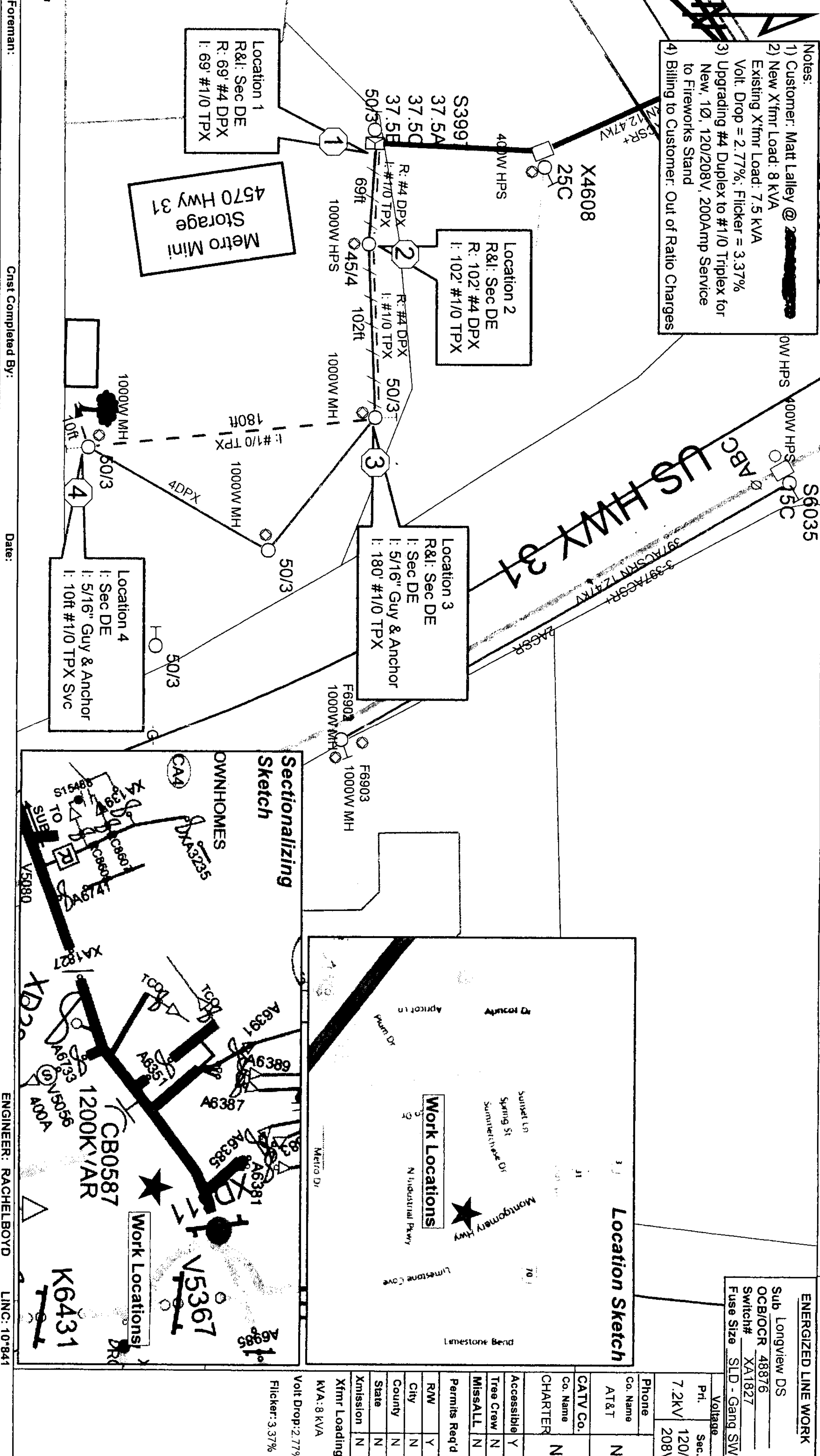

Foreman: \_\_\_\_\_ Date: \_\_\_\_\_ Cnst Completed By: \_\_\_\_\_ ENGINEER: RACHELBOYD LINC: 10-841

