

EASEMENT - DISTRIBUTION FACILITIES

STATE OF ALABAMA

COUNTY OF SHELBY

W.E. No. A6170-06-A315, **A6170-06-A415**

APCO Parcel No. 70224851, **70269974**

Transformer No. S18901

This instrument prepared by:

John Gilmer

Alabama Power Company  
P. O. Box 2641  
Birmingham, Alabama 35291



20150518000163890 1/4 \$23.50  
Shelby Cnty Judge of Probate, AL  
05/18/2015 01:56:40 PM FILED/CERT

KNOW ALL MEN BY THESE PRESENTS, That MAP ALABASTER, LLC as grantor(s), (the "Grantor", whether one or more) for and in consideration of One and No/100 Dollar (\$1.00) and other good and valuable consideration paid to Grantor in hand by Alabama Power Company, a corporation, the receipt and sufficiency of which are hereby acknowledged, does hereby grant to Alabama Power Company, its successors and assigns (the "Company"), the easements, rights and privileges below.

**Overhead and/or Underground.** The right from time to time to construct, install, operate and maintain, upon, over, under and across the Property described below, all poles, towers, wires, conduits, fiber optics, cables, communication lines, trans closures, transformers, anchors, guy wires and other facilities useful or necessary in connection therewith (collectively, "Facilities"), for the overhead and/or underground transmission and distribution of electric power and communications, along a route selected by the Company, as generally shown on the Company's drawing attached hereto and made a part hereof, but which is to be determined by the actual location(s) in which the Company's facilities are installed. The width of the Company's easement will depend on whether the Facilities are underground or overhead: for underground, the easement will extend five (5) feet on each side of said Facilities as and where installed; for overhead Facilities, the easement will extend fifteen (15) feet on each side of the centerline of said Facilities as and where installed. The Company is granted the right to clear, and keep clear, all trees, undergrowth and other obstructions on a strip of land extending five (5) feet from each side of said underground Facilities, and to clear, and keep clear, all trees, undergrowth and other obstructions on a strip of land extending fifteen (15) feet from each side of the centerline of said overhead Facilities and the right in the future to install intermediate poles and facilities on said strip. Further, with respect to overhead Facilities, the Company is also granted the right to trim and cut, and keep trimmed and cut, all dead, weak, leaning or dangerous trees or limbs outside of the thirty (30) foot strip that, in the sole opinion of the Company, may now or hereafter endanger, interfere with, or fall upon any of said overhead Facilities.

Grantor hereby grants to the Company all easements, rights and privileges necessary or convenient for the full enjoyment and use thereof, including without limitation the right of ingress and egress to and from said Facilities, as applicable, and the right to excavate for installation, replacement, repair and removal thereof; and also the right to cut, remove and otherwise keep clear any and all structures, obstructions or obstacles of whatever character, on, under and above said Facilities, as applicable.

The easements, rights and privileges granted hereby shall apply to, and the word "Property" as used in this instrument shall mean, the following described real property situated in Shelby County, Alabama (the "Property"): a parcel of land located in the NW ¼ of the NW ¼ of Section 14, Township 21South, Range 3 West, more particularly described in that certain instrument recorded in instrument numbers 20150206000039550 and 2015000039570, in the office of the Judge of Probate of said County.

In the event it becomes necessary or desirable for the Company from time to time to move any of the Facilities in connection with the construction or improvement of any public road or highway in proximity to the Facilities, Grantor hereby grants to the Company the right to relocate the Facilities and, as to such relocated Facilities, to exercise the rights granted above; provided, however, the Company shall not relocate said Facilities on the Property at a distance greater than ten feet (10') outside the boundary of the right of way of any such public road or highway as established or re-established from time to time. This grant and agreement shall be binding upon and shall inure to the benefit of Grantor, the Company and each of their respective heirs, personal representatives, successors and assigns and the words "Company" and "Grantor" as used in this instrument shall be deemed to include the heirs, personal representatives, successors and assigns of such parties.

TO HAVE AND TO HOLD the same to the Company, its successors and assigns, forever.

IN WITNESS WHEREOF, the said Grantor, has caused this instrument to be executed by MARK A. PEEPLES

its authorized representative, as of the 3 day of April, 2015.

ATTEST (if required) or WITNESS:

By: \_\_\_\_\_

Its: \_\_\_\_\_

MAP ALABASTER, LLC

By: [Signature] (SEAL)

Its: Member  
[indicate: President, General Partner, Member, etc.]

Shelby County, AL 05/18/2015  
State of Alabama  
Deed Tax: \$.50

All facilities on Grantor:   X  

Station to Station: \_\_\_\_\_

CORPORATION/PARTNERSHIP/LLC NOTARY

STATE OF ALABAMA  
COUNTY OF Jefferson

I, Nina J. Wagnon, a Notary Public in and for said County in said State, hereby certify that Mark A. Peeples, whose name as Member of MAP Alabaster, LLC, an Alabama Limited Liability Company, [acting in its capacity as Member of MAP Alabaster, LLC, an Alabama Limited Liability Company] is signed to the foregoing instrument, and who is known to me, acknowledged before me on this day that, being informed of the contents of the instrument, he/she, as such Member and with full authority, executed the same voluntarily, for and as the act of said Member [acting in such capacity as aforesaid].

Given under my hand and official seal this the 3rd day of April, 2015.

Nina J. Wagnon  
Notary Public  
[SEAL] My commission expires: 03/29/2019

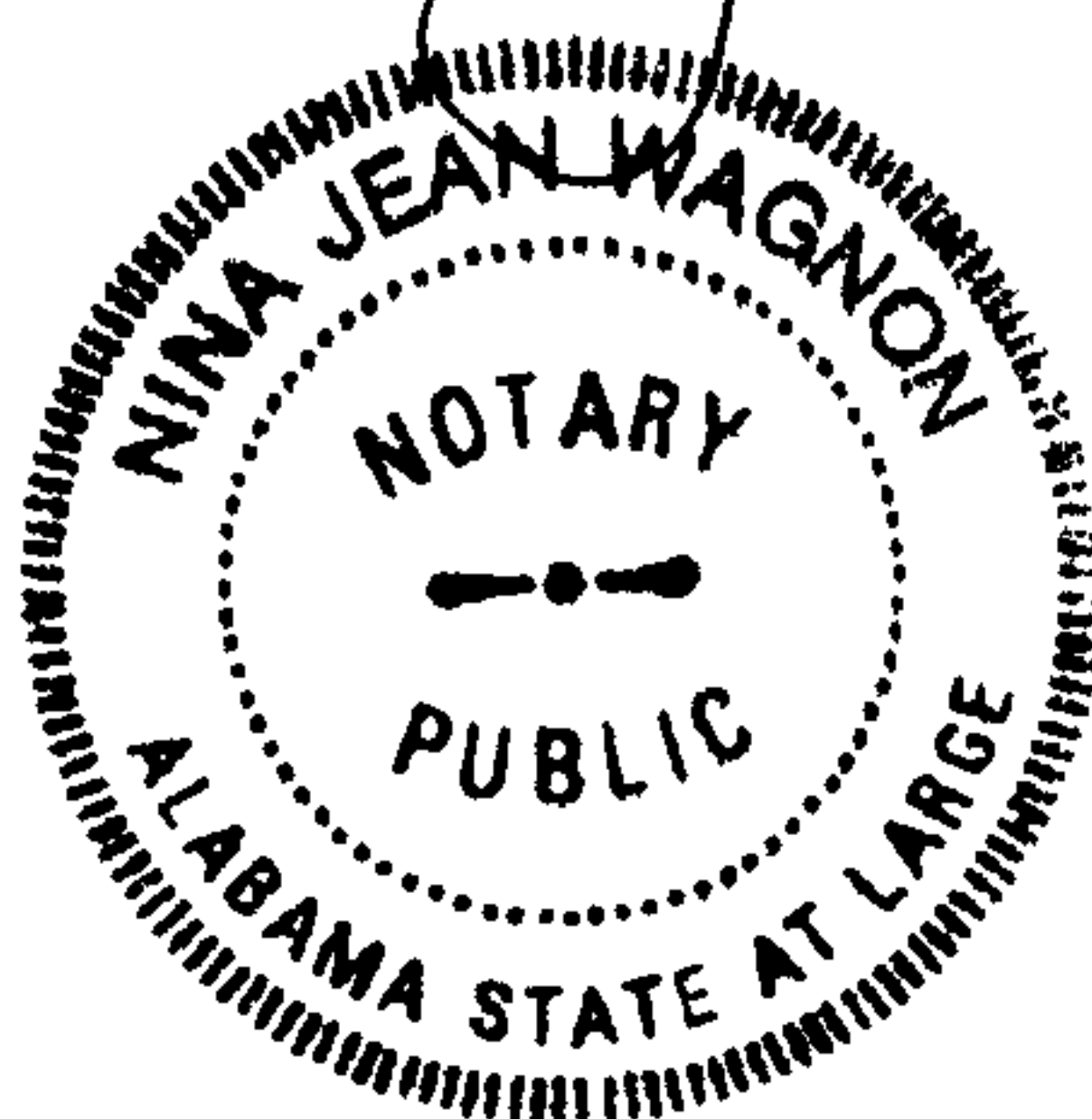

  
20150518000163890 2/4 \$23.50  
Shelby Cnty Judge of Probate, AL  
05/18/2015 01:56:40 PM FILED/CERT



1 inch = 100 feet

33.211241 -86.828608

1692820 12056139

DATE OF PRINT: 05/18/2015 01:56:40 PM FILED/CERT

Customer Walmart Market		Location 9029 Hwy 119		Cmtd. Svc Date		Callback Date		Charge No. A617006A315		Missall No. Date Good Thru Date	
Region PD Birmingham		District Metro South		Town Alabaster		Created: 3/16/2015		UserID: kewright			
County: Shelby		Section 14		Township 21S		Range 03W		Patch Request Req'd YES NO		Voltage Pri. Sec. Co. Name 35 277/480 ATT	
Acquisition Agent Dean Fritz		Date R/W Assigned		Date R/W Cleared		X- Elliottville #2 39896 Y- A6841		Info. EWP Info Brkr: Elliottville #2 39896			

Walmart Neighborhood Market  
Pro. Load: 589 kva  
Cust Main: 1600A  
Metering: 13-Terminal, 3Ø

LOC 1  
1:500kva 277/480V WYENWE DFPM, 34.5kv (#S18901)  
460' #1/0 3Ø total Pri. Down Pole & to Padmount

LOC 2  
1: 50/3 In-line CCA Pole & Enhanced #2 Grnd  
w/ existing 3Ø Pri. Vert Tang on 26" Brackets  
4" Riser for 3Ø #1/0 Pri to Pdmt  
w/ (3) 100A Cutouts & LA's on Bracket  
(Switch #XA3537) w/ 40A QA Fuses

UG 3Ø Pri. to 500kva Padmount Xfmr  
13-Terminal Socket w/ 800:5 Bushing CT's  
Cable Pull: 960  
I load: 708A  
UG Cost +

\*\*Customer to trench & install 2 runs (including the spare)  
5" customer provided conduit w/ 48" coverage,  
APCO inspected, w/ pull string \*\*

ALABAMA POWER  
SOUTHERN COMPANY

Phasing  
Road  
Middle  
Field

Transfer  
Notice Req'd.  
CATV Co.  
Co. Name  
Charter

Transfer  
Notice Req'd.  
Accessible  
Tree Crew  
Permits Req'd  
RW  
City  
County  
State  
Xmission  
Run Service  
YES  
NO

Install  
Remove  
1

Poles

Cutouts  
3

L/A  
3

Wire  
420' #1/0 Pri

Service

Xfmrs  
1 Pdmt  
#S18901

Lights

Reading: \_\_\_\_\_

Mtr. #: \_\_\_\_\_

Charge: \$1,540.75

Tracking No. A617006A315

Const. Completed By: \_\_\_\_\_

CATV Transfer: \_\_\_\_\_ Poles

Contact: Greg Krimm- McWhorter Company  
205-482-7994  
g.krimm@mcwhorterandco.com

Short-Circuit Box  
LLL LLG LL LG LG-R  
4662 4634 4037 4509 783

RW Agent Dean Fritz  
Date Assigned 3-18-15  
Date Cleared 5-8-15  
Parcel # 70224851  
7026 9974



20150518000163890 3/4 \$23.50  
Shelby Cnty Judge of Probate, AL  
05/18/2015 01:56:40 PM FILED/CERT



Customer Walmart Gas Station		Location 9029 Hwy 119		Cmtd. Svc Date		Callback Date		Charge No. A617006A415		Missall No. Date Good Thru Date	
Region PD Birmingham		District Metro South		Town Alabaster		Created: 4/1/2015		UserID: kewright			
County: Shelby		Section 14		Township 21S		Range 03W		Patch Request Req'd YES NO		Voltage Pri. Sec. Co. Name	
Acquisition Agent Dean Fritz		Date R/W Assigned		Date R/W Cleared		X- Elliottsville #2 39896 Y-		Info. EWP Info Brkr: Elliottsville #2 39896		Phone Co. Co. Name	

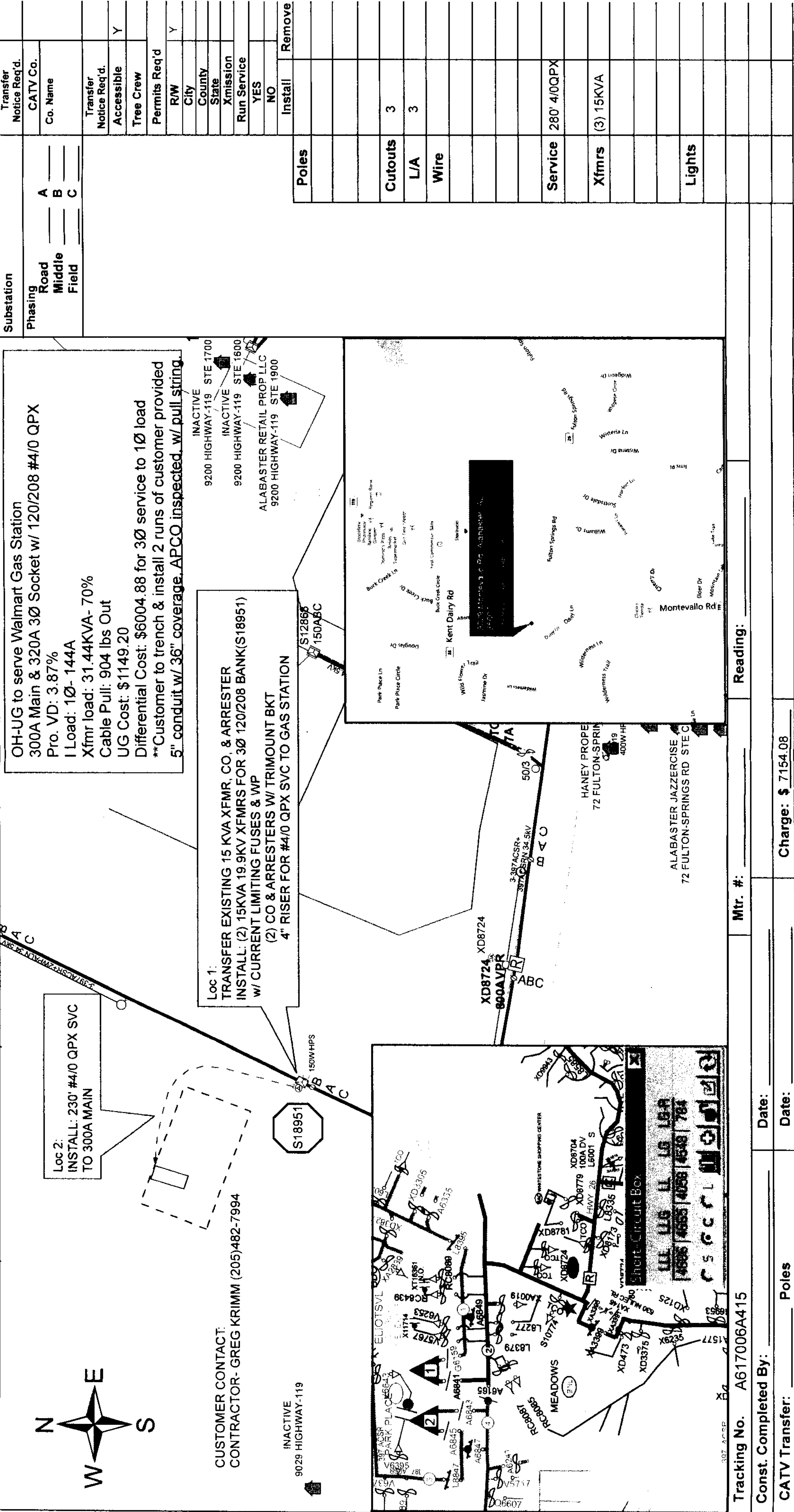

RW Agent Dean Fritz  
Date Assigned 3-18-15  
Date Cleared 5-8-15  
Parcel # 70224851  
70269974

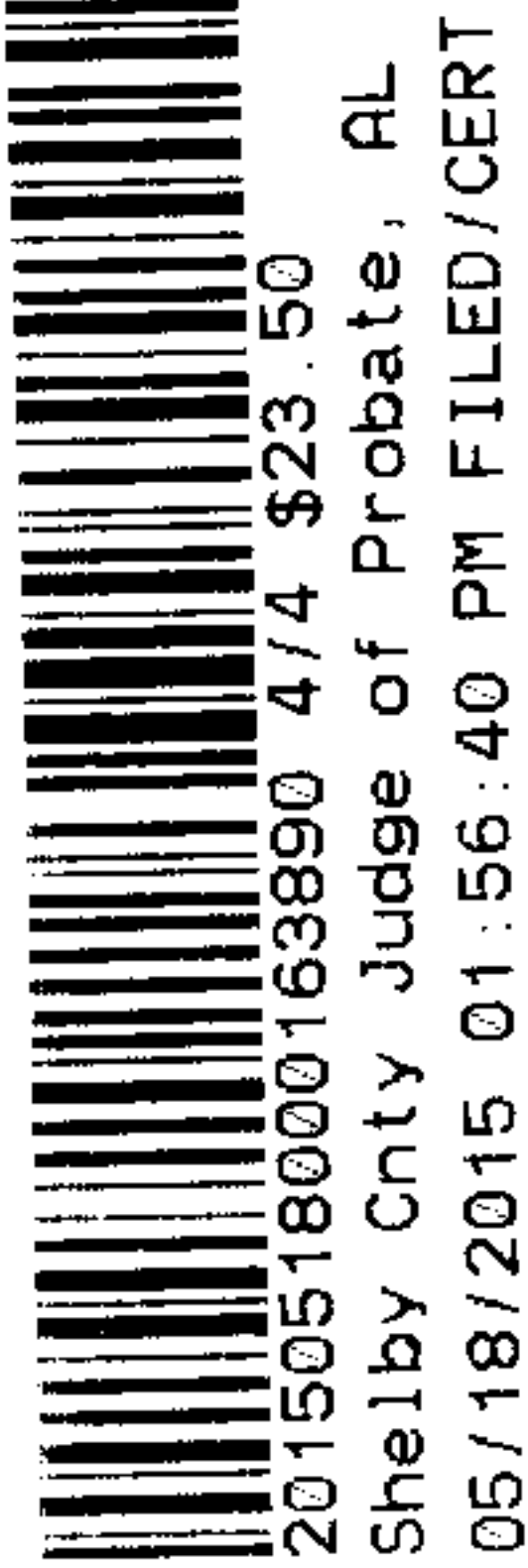

20150518000163890 4/4 \$23.50  
Shelby Cnty Judge of Probate, AL  
05/18/2015 01:56:40 PM FILED/CERT

Tracking No. A617006A415		Mtr. #:		Reading:	
Const. Completed By:		Date:		Charge: \$ 7154.08	
CATV Transfer:		Poles			