

Source of Title:

Instrument #20130816000333850

500.00

EASEMENT - DISTRIBUTION FACILITIES

STATE OF ALABAMA

COUNTY OF SHELBY

W.E. No. A6170-06-AU14

APCO Parcel No. 70265533

Transformer No. S80200

This instrument prepared by: Dean Fritz

KNOW ALL MEN BY THESE PRESENTS, That City of Chelsea, a municipality

as grantor(s), (the "Grantor", whether one or more) for and in consideration of One and No/100 Dollar (\$1.00) and other good and valuable consideration paid to Grantor in hand by Alabama Power Company, a corporation, the receipt and sufficiency of which are hereby acknowledged, does hereby grant to Alabama Power Company, its successors and assigns (the "Company"), the easements, rights and privileges below.

Overhead and/or Underground. The right from time to time to construct, install, operate and maintain, upon, over, under and across the Property described below, all poles, towers, wires, conduits, fiber optics, cables, communication lines, translosures, transformers, anchors, guy wires and other facilities useful or necessary in connection therewith (collectively, "Facilities"), for the overhead and/or underground transmission and distribution of electric power and communications, along a route selected by the Company, as generally shown on the Company's drawing attached hereto and made a part hereof, but which is to be determined by the actual location(s) in which the Company's facilities are installed. The width of the Company's easement will depend on whether the Facilities are underground or overhead: for underground, the easement will extend five (5) feet on each side of said Facilities as and where installed; for overhead Facilities, the easement will extend fifteen (15) feet on each side of the centerline of said Facilities as and where installed. The Company is granted the right to clear, and keep clear, all trees, undergrowth and other obstructions on a strip of land extending five (5) feet from each side of said underground Facilities, and to clear, and keep clear, all trees, undergrowth and other obstructions on a strip of land extending fifteen (15) feet from each side of the centerline of said overhead Facilities and the right in the future to install intermediate poles and facilities on said strip. Further, with respect to overhead Facilities, the Company is also granted the right to trim and cut, and keep trimmed and cut, all dead, weak, leaning or dangerous trees or limbs outside of the thirty (30) foot strip that, in the sole opinion of the Company, may now or hereafter endanger, interfere with, or fall upon any of said overhead Facilities.

Grantor hereby grants to the Company all easements, rights and privileges necessary or convenient for the full enjoyment and use thereof, including without limitation the right of ingress and egress to and from said Facilities, as applicable, and the right to excavate for installation, replacement, repair and removal thereof; and also the right to cut, remove and otherwise keep clear any and all structures, obstructions or obstacles of whatever character, on, under and above said Facilities, as applicable.

The easements, rights and privileges granted hereby shall apply to, and the word "Property" as used in this instrument shall mean, the following described real property situated in Shelby County, Alabama (the "Property"): a parcel of land located in the NW¼ of the SE¼ of Section 34, Township 19 South, Range 1 West, more particularly described in that certain instrument recorded in Instrument #20130816000333850, in the office of the Judge of Probate of said County.

In the event it becomes necessary or desirable for the Company from time to time to move any of the Facilities in connection with the construction or improvement of any public road or highway in proximity to the Facilities, Grantor hereby grants to the Company the right to relocate the Facilities and, as to such relocated Facilities, to exercise the rights granted above; provided, however, the Company shall not relocate said Facilities on the Property at a distance greater than ten feet (10') outside the boundary of the right of way of any such public road or highway as established or re-established from time to time. This grant and agreement shall be binding upon and shall inure to the benefit of Grantor, the Company and each of their respective heirs, personal representatives, successors and assigns and the words "Company" and "Grantor" as used in this instrument shall be deemed to include the heirs, personal representatives, successors and assigns of such parties.

TO HAVE AND TO HOLD the same to the Company, its successors and assigns, forever.

IN WITNESS WHEREOF, the said Grantor, has caused this instrument to be executed by S Earl Nien
its authorized representative, as of the 12th day of March, 20 15

ATTEST (if required) or WITNESS:

City of Chelsea, a municipality
(Grantor - Name of Corporation/Partnership/LLC)

By: _____

By: S Earl Nien (SEAL)

Its: _____

Its: Mayor
[indicate: President, General Partner, Member, etc.]

20150424000133860 1/3 \$20.50
Shelby Cnty Judge of Probate, AL
04/24/2015 12:35:23 PM FILED/CERT

Shelby County, AL 04/24/2015
State of Alabama
Deed Tax: \$.50

All facilities on Grantor: _____

Station to Station: Sta 2+00 to Sta 4+00
Guys at Sta 2+00

CORPORATION NOTARY

STATE OF ALABAMA

COUNTY OF Shelby

I, Bucky C. Sanders, a Notary Public, in and for said County in said State, hereby certify that
A. Carl Dixon, whose name as Mayor of
Chelsia, a corporation, is signed to the foregoing instrument, and who is known to me,

acknowledged before me on this day that, being informed of the contents of this instrument, he/she, as such officer and with full authority, executed the same voluntarily for and as the act of said Corporation.

Given under my hand and official seal, this the 12th day of March, 2015.

[SEAL]

Bucky C. Sanders
Notary Public

My commission expires: _____
NOTARY PUBLIC STATE OF ALABAMA AT LARGE
MY COMMISSION EXPIRES: March 6, 2017
BONDED THRU MERCHANTS BONDING CO. (MUTUAL)

20150424000133860 2/3 \$20.50
Shelby Cnty Judge of Probate, AL
04/24/2015 12:35:23 PM FILED/CERT

ETCH OF PROPOSED WORK - SIMPLIFIED W.E.

Customer: / OF CHELSEA / SEA COMMUNITY CENTER	Location: 11101 CHELSEA RD	Map Center UTM: 1753594 12101220	Map Center Lat/lon: 33.334746 -86.629316	1 inch = 149 feet			ALABAMA POWER
District: SOUTH VARNONS	Town: CHELSEA	County: SHELBY	Section: 34	Township: 19S	Range: 01W	Estimate No. A617006AU14	Missall No. _____
Created: 3/6/2015	Userid: japutt	Substation: CHELSEA DS	X: 34734	Y: XD2362			Work Date _____
							Time _____
							Update _____

1. R: 55/2
R: 3PH SUS
R: 1PH DE
R: 3PH DE
R/T: 3 - 397 ACSR PRI & 2/0 ACSRN
R/T: 3 - 2/0 ACSR PRI & #2 ACSRN
R: 100 HPS
R: 2 - ANCHORS & GUYS
2. I: 60/2 CCA
I: 3 PH DDE
I: 3 PH DE
I: 2 ANCHORS 8" HELIX & 3 - 3/8" GUYS
I/T: 3 - 397 ACSR PRI & 2/0 ACSRN
I/T: 3 - 2/0 ACSR PRI & #2 ACSRN
I: 3 PH PRIMARY RISER "XA3461"
FUSED AT 60A
3. I: 3 - 465' 1/0 XLP UG PRIMARY CABLE
IN CUSTOMER INSTALLED CONDUIT
4. I: 150KVA 3PH 120/208 PAD MOUNT TRANS
I: 400:5 BUSHING MOUNTED CTS

NOTE: CUSTOMER TO TRENCH AND INSTALL 5" CONDUIT
IN 42" TRENCH
CUSTOMER TO OWN AND MAINTAIN SERVICE RUNS

R/W Agent Dean Fritz
Date Assigned 3-6-15
Date Cleared 4-3-15
Parcel # 70265533
70269575

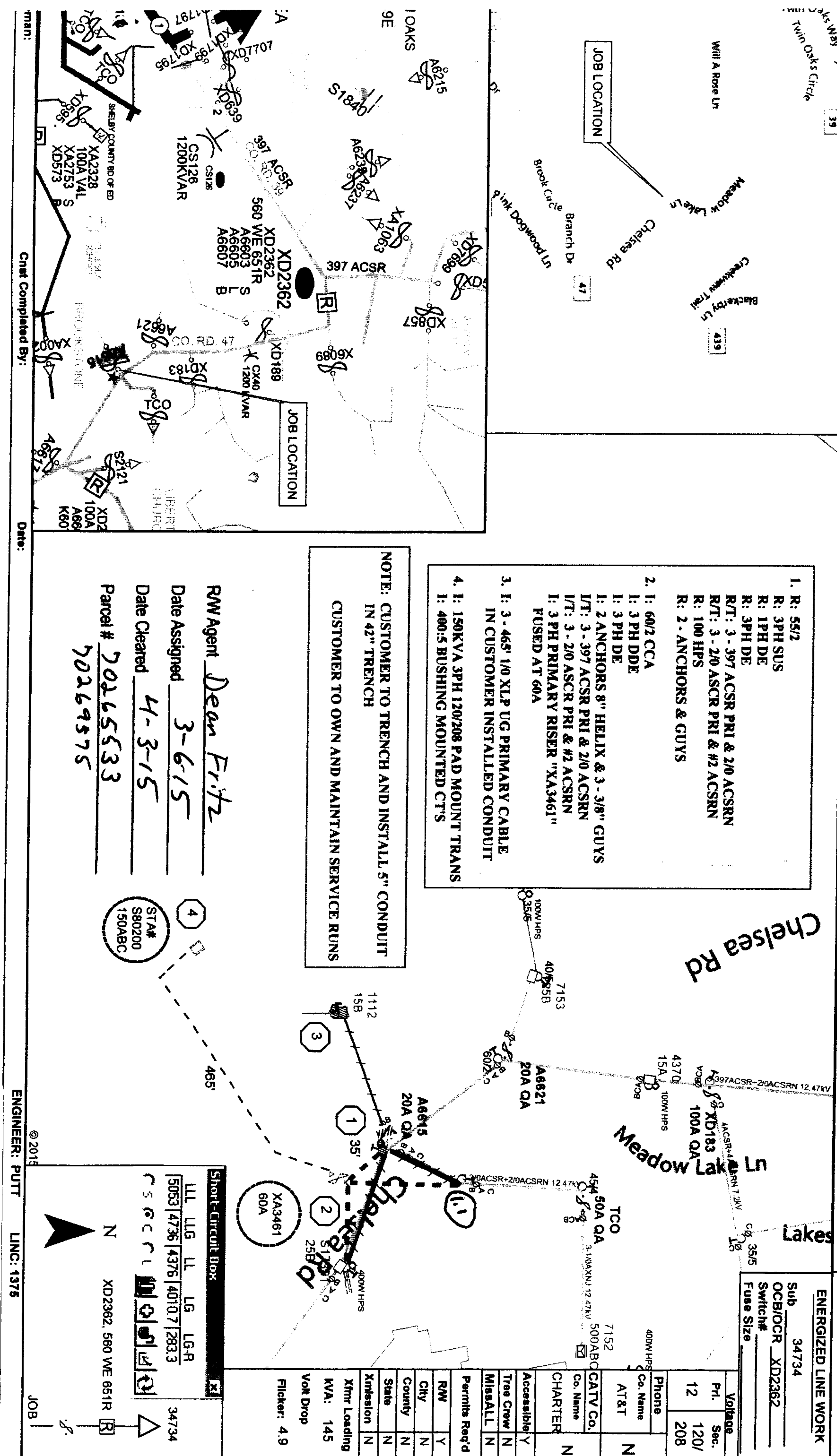

ENGINEER: PUTT LINC: 1375

JOB

STA 1.1 + 20 TO STA 1.1 + 80
80' DEDICATED ROAD

