

500-w

## EASEMENT-SECONDARY VOLTAGE

STATE OF ALABAMA

COUNTY OF SHELBY

WE No A6170-00-EA14

APCO Parcel No. 70267495

Transformer No. S18674

This instrument prepared by: Dean Fritz

Alabama Power Company

P. O. Box 2641

Birmingham, Alabama 35291

KNOW ALL MEN BY THESE PRESENTS, That Jody Johnson and wife, Amiee M Johnson

as grantor(s), (the "Grantor", whether one or more), for and in consideration of One and No/100 Dollars (\$1.00), and other good and valuable consideration, to Grantor in hand paid by Alabama Power Company (the "Company"), a corporation, the receipt of which is hereby acknowledged, do hereby grant to Company, its successors and assigns, the right to construct, install, operate and maintain, along a route to be selected by the grantee, which is generally shown on the Company's drawing, attached hereto and made a part hereof all poles, wires, and other appliances and facilities useful or necessary in connection therewith, for the overhead distribution of secondary voltages not to exceed 600 volts of electric power for overhead service upon, over, under and across the following described real property situated in Shelby County, Alabama (the "Property"):

a parcel of land located in the NW¼ of the NE¼ of Section 3, Township 22 South, Range 2 West, more particularly described in that certain instrument recorded in Instrument #20131001000393320, in the office of the Judge of Probate of said County

In the event it becomes necessary or desirable for said Company to move its lines of poles and appliances in connection with the construction or improvement of any public road or highway in proximity to its said power lines, the said Company is hereby granted the right to relocate its said lines of poles and appliances and as to such relocated lines of poles and appliances, to exercise the rights granted above; provided, however, the said Company shall not relocate its said lines of poles and appliances on the Property at a distance greater than ten feet (10') outside the boundary of the right of way of any such public road or highway as established or re-established from time to time.

Together with all rights and privileges necessary or convenient for the full enjoyment or use thereof, including the right of ingress and egress to and from said lines and also the right to clear a strip ten feet (10') in width extending five feet (5') to each side of the center line of the lines of poles and keep it cleared of all trees undergrowth or other obstructions; to trim and cut and keep trimmed and cut all dead, weak, leaning or dangerous trees or limbs outside of the said ten foot (10') strip which, in the sole opinion of Company, might interfere with or fall upon the poles, lines, or other appliances of Company.

TO HAVE AND TO HOLD the same to the Company, its successors and assigns, forever.

IN WITNESS WHEREOF, the undersigned Grantor(s) has/ have executed this instrument on this the 11 day of December, 2014.

Witness Signature

Print Name

Witness Signature

Print Name

(Grantor)

(Grantor)

(SEAL)

(SEAL)

All on Grantor



20150106000005460 1/2 \$17.50  
Shelby Cnty Judge of Probate, AL  
01/06/2015 11:34:47 AM FILED/CERT



SKETCH OF PROPOSED WORK - SIMPLIFIED W.E.

Map Center UTM: 1721896 12034666  
Map Center Lat/lon: 33.152038 -86.733688

1 inch = 83 feet

ALABAMA POWER

Customer Jody Johnson - OH Service	Location 441 County Hwy 42	Created, Svc Date Dec. 31, 2014	County SHELBY	Section 3	Township 22S	Range 02W	Estimate No. A6170-00-EA14	Missall No. Work Date Time Update
Division Birmingham	District Metro South-Varnons	Town Calera	UserID rtboyd	Created: 11/26/2014	Substation Longview DS	X- 48836 Y- XD1873		

- Notes:
- 1) Customer: Jody Johnson @
  - 2) Xfmr Load: 12.4 KVA  
Volt. Drop: 2.3%; Flicker: 4.67%
  - 3) OH Service to a 1Ø, 120/240V, 200Amp, 3 Ton, 2850 SqFt New Home.
  - 4) Revenue is based on added SQ Footage and the remaining Revenue from Previous Job (A617000BD14)
  - 5) Service, Meter and Socket were issued/Charged on Previous Job (A617000BD14) And not included on Cost Ratio for this Job

R/W Agent Dean Fritz  
Date Assigned 11-26-14  
Date Cleared 12-12-14  
Parcel # 70267495

ENERGIZED LINE WORK  
Sub Longview DS  
OCB/OCR 48836/Q6258  
Switch# XD1873  
Fuse Size Solid

Voltage	Pri.	Sec.
7.2KV	120V	240V

Phone  
Co. Name  
AT&T

CATV Co.  
Co. Name  
N

CHARTER  
Accessible Y  
Tree Crew N  
Missall Y

Permits Req'd  
R/W Y  
City N  
County N  
State N  
Xmission N

Xfmr Loading  
KVA: 12.4 KVA  
Volt Drop: 2.3%  
Flicker: 4.67%

Location Sketch

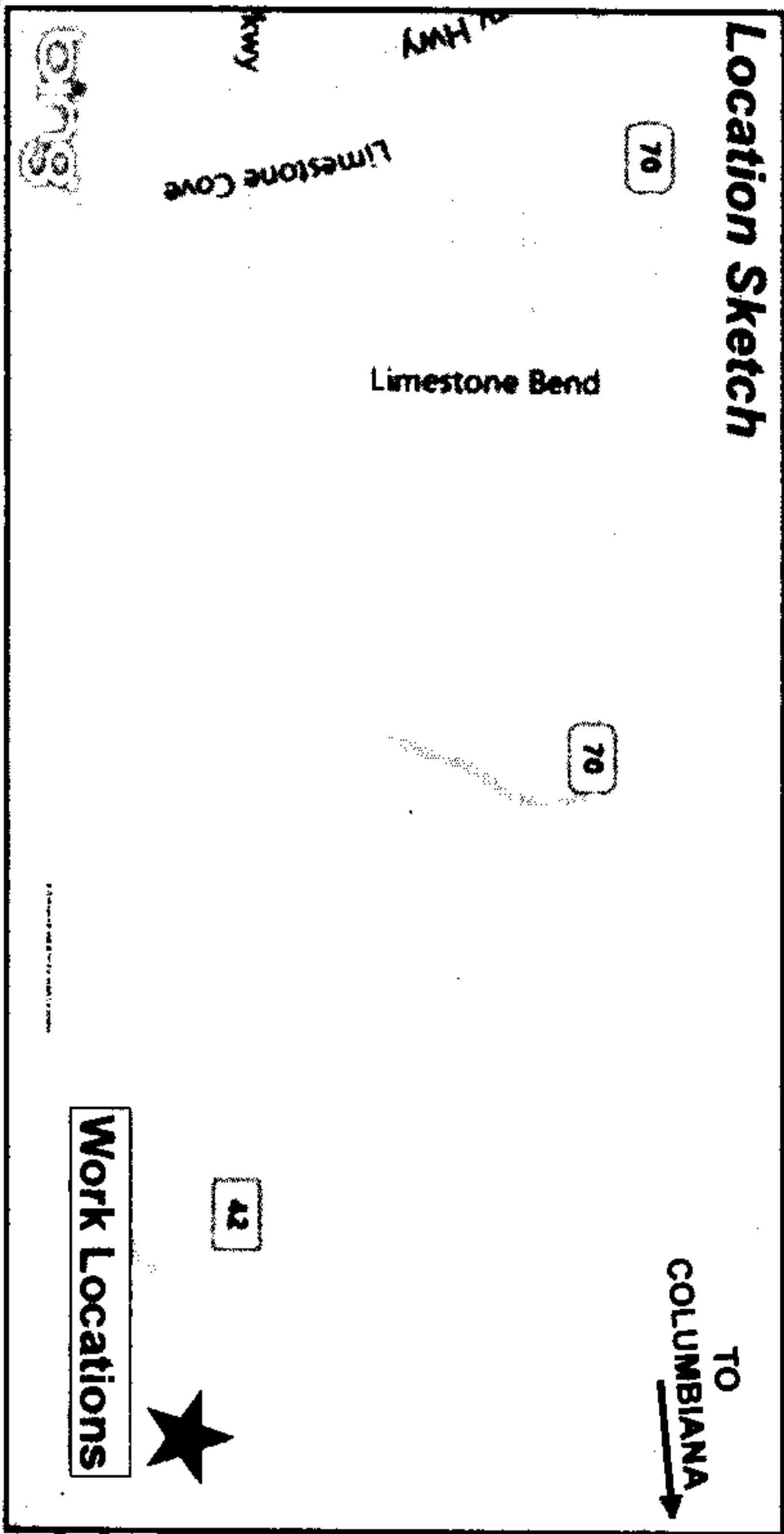

Sectionalizing Sketch

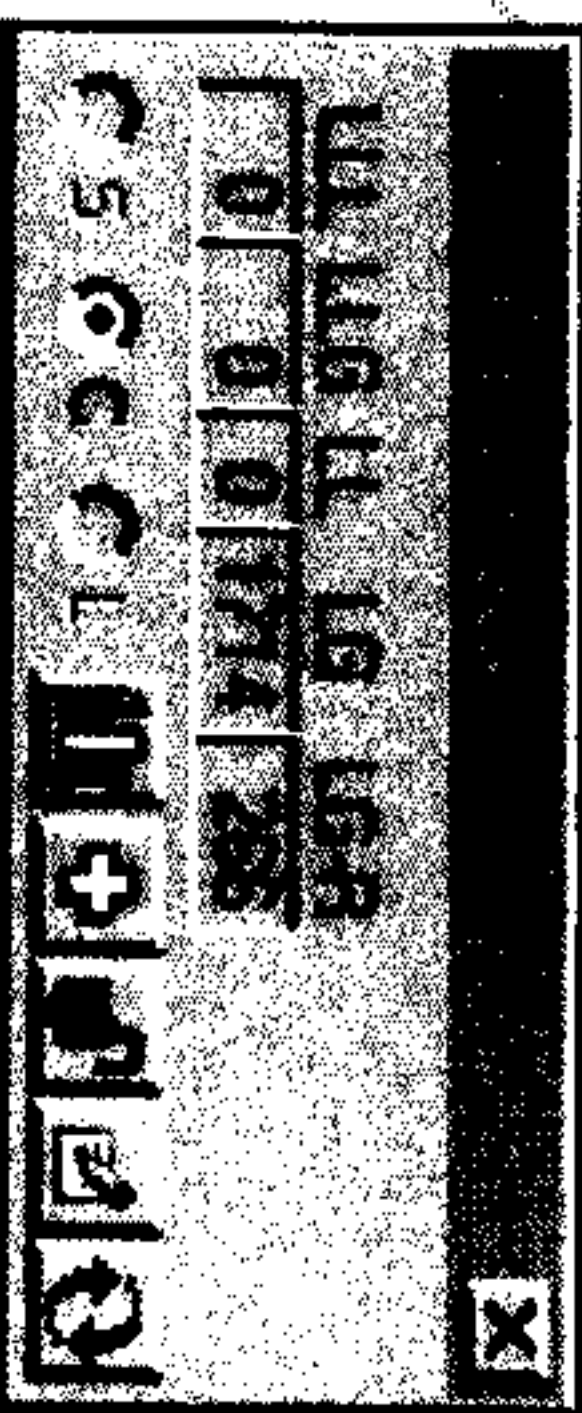
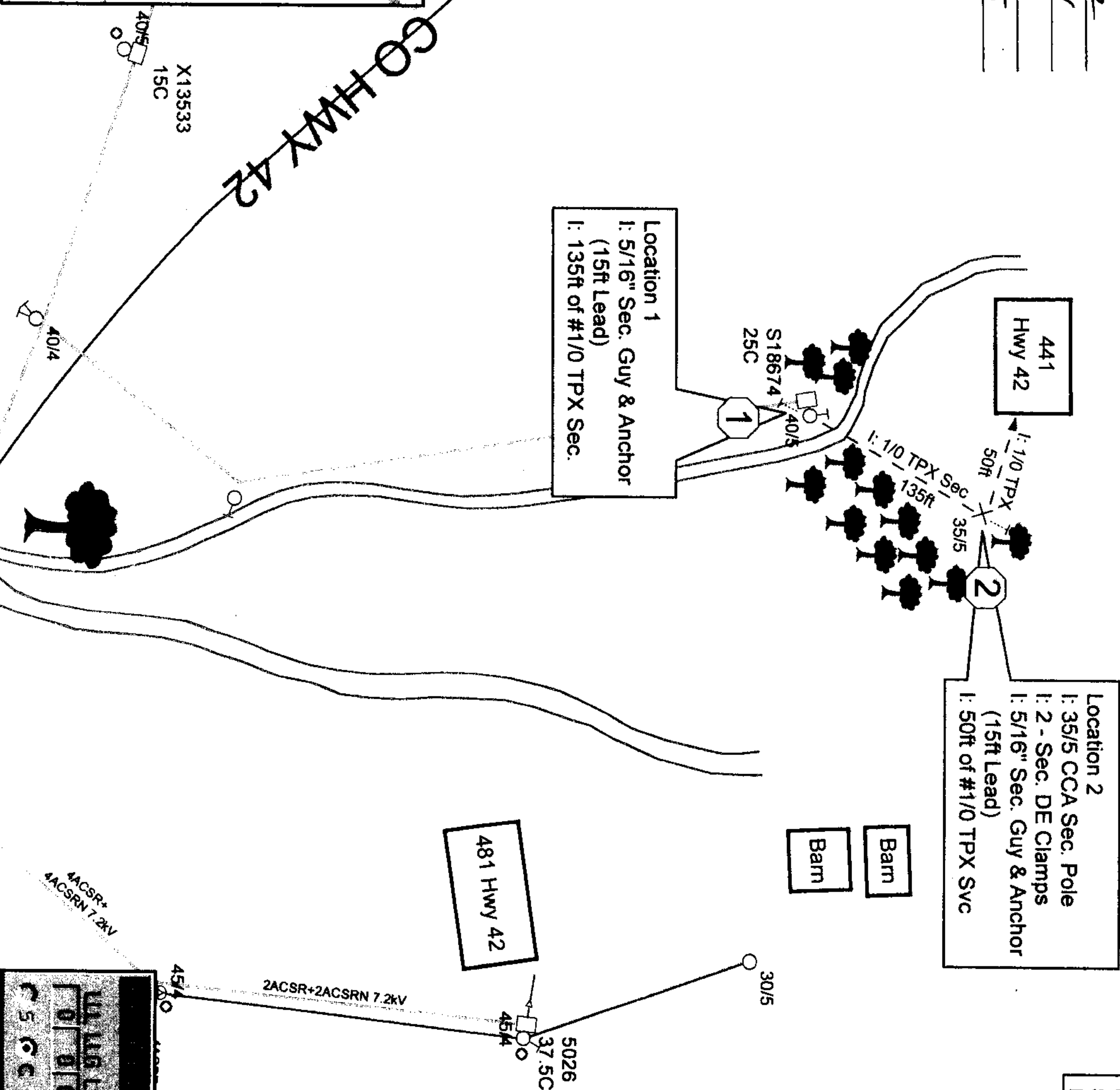
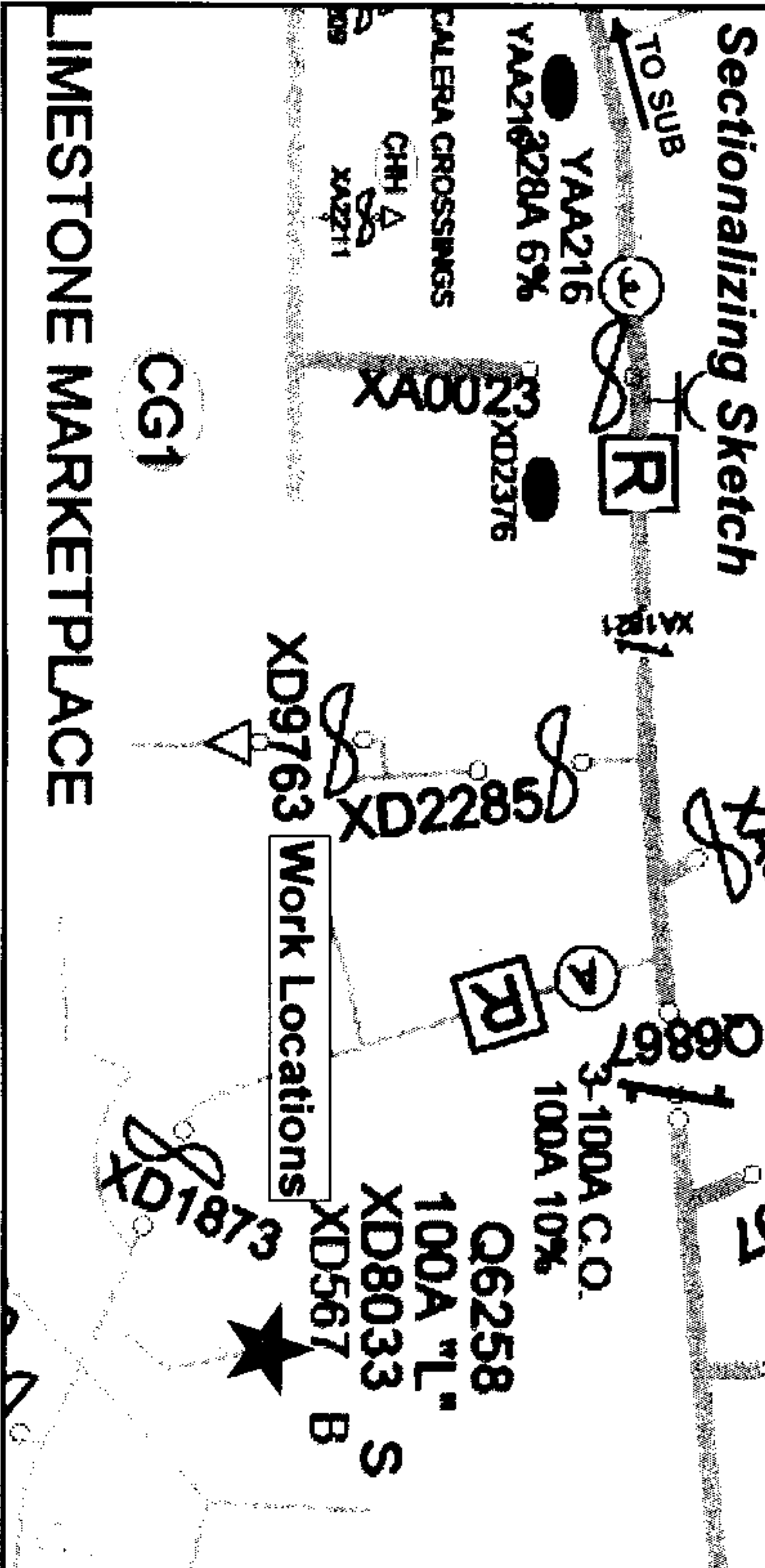

Foreman: Cnst Completed By: Date: ENGINEER: RACHELBOYD LINC: 10\*841

