

500-00

Source of Title:

Instrument #20140418000114410

EASEMENT – DISTRIBUTION FACILITIES

STATE OF ALABAMA

COUNTY OF SHELBY

W.E. No. A6170-06-AL14

APCO Parcel No. 70264612

Transformer No. S18724

This instrument prepared by: Dean Fritz

KNOW ALL MEN BY THESE PRESENTS, That ALDI, Inc.

as grantor(s), (the "Grantor", whether one or more) for and in consideration of One and No/100 Dollar (\$1.00) and other good and valuable consideration paid to Grantor in hand by Alabama Power Company, a corporation, the receipt and sufficiency of which are hereby acknowledged, does hereby grant to Alabama Power Company, its successors and assigns (the "Company"), the easements, rights and privileges below.

Overhead and/or Underground. The right from time to time to construct, install, operate and maintain, upon, over, under and across the Property described below, all poles, towers, wires, conduits, fiber optics, cables, communication lines, translosures, transformers, anchors, guy wires and other facilities useful or necessary in connection therewith (collectively, "Facilities"), for the overhead and/or underground transmission and distribution of electric power and communications, along a route selected by the Company, as generally shown on the Company's drawing attached hereto and made a part hereof, but which is to be determined by the actual location(s) in which the Company's facilities are installed. The width of the Company's easement will depend on whether the Facilities are underground or overhead: for underground, the easement will extend five (5) feet on each side of said Facilities as and where installed; for overhead Facilities, the easement will extend fifteen (15) feet on each side of the centerline of said Facilities as and where installed. The Company is granted the right to clear, and keep clear, all trees, undergrowth and other obstructions on a strip of land extending five (5) feet from each side of said underground Facilities, and to clear, and keep clear, all trees, undergrowth and other obstructions on a strip of land extending fifteen (15) feet from each side of the centerline of said overhead Facilities and the right in the future to install intermediate poles and facilities on said strip. Further, with respect to overhead Facilities, the Company is also granted the right to trim and cut, and keep trimmed and cut, all dead, weak, leaning or dangerous trees or limbs outside of the thirty (30) foot strip that, in the sole opinion of the Company, may now or hereafter endanger, interfere with, or fall upon any of said overhead Facilities.

Grantor hereby grants to the Company all easements, rights and privileges necessary or convenient for the full enjoyment and use thereof, including without limitation the right of ingress and egress to and from said Facilities, as applicable, and the right to excavate for installation, replacement, repair and removal thereof; and also the right to cut, remove and otherwise keep clear any and all structures, obstructions or obstacles of whatever character, on, under and above said Facilities, as applicable.

The easements, rights and privileges granted hereby shall apply to, and the word "Property" as used in this instrument shall mean, the following described real property situated in Shelby County, Alabama (the "Property"): a parcel of land located in the SE¼ of the NE¼ of Section 2, Township 21 South, Range 3 West, more particularly described in that certain instrument recorded in Instrument #20140418000114410, in the office of the Judge of Probate of said County.

In the event it becomes necessary or desirable for the Company from time to time to move any of the Facilities in connection with the construction or improvement of any public road or highway in proximity to the Facilities, Grantor hereby grants to the Company the right to relocate the Facilities and, as to such relocated Facilities, to exercise the rights granted above; provided, however, the Company shall not relocate said Facilities on the Property at a distance greater than ten feet (10') outside the boundary of the right of way of any such public road or highway as established or re-established from time to time. This grant and agreement shall be binding upon and shall inure to the benefit of Grantor, the Company and each of their respective heirs, personal representatives, successors and assigns and the words "Company" and "Grantor" as used in this instrument shall be deemed to include the heirs, personal representatives, successors and assigns of such parties.

TO HAVE AND TO HOLD the same to the Company, its successors and assigns, forever.

IN WITNESS WHEREOF, the said Grantor, has caused this instrument to be executed by Troy Marshall
its authorized representative, as of the 24th day of July, 2014.

ATTEST (if required) or WITNESS:

By: [Signature]
Its: Director of Real Estate

ALDI, Inc.
(Grantor - Name of Corporation/Partnership/LLC)
By: [Signature] (SEAL)
Its: Vice President
[Indicate: President, General Partner, Member, etc.]

20141212000391170 1/3 \$20.50
Shelby Cnty Judge of Probate, AL
12/12/2014 11:39:45 AM FILED/CERT

Shelby County, AL 12/12/2014
State of Alabama
Deed Tax: \$.50

All facilities on Grantor: X

Station to Station: LESS & Except existing ARU R/W

CORPORATION NOTARY

STATE OF ALABAMA TN

COUNTY OF Wilson

I, Darlene Thompson, a Notary Public, in and for said County in said State, hereby certify that
Troy Marshall, whose name as vice President of
Audi, a corporation, is signed to the foregoing instrument, and who is known to me,

acknowledged before me on this day that, being informed of the contents of this instrument, he/she, as such officer and with full authority, executed the same voluntarily for and as the act of said Corporation.

Given under my hand and official seal, this the 25 day of July, 2014.

[SEAL]

Notary Public

My commission expires: 9/30/17

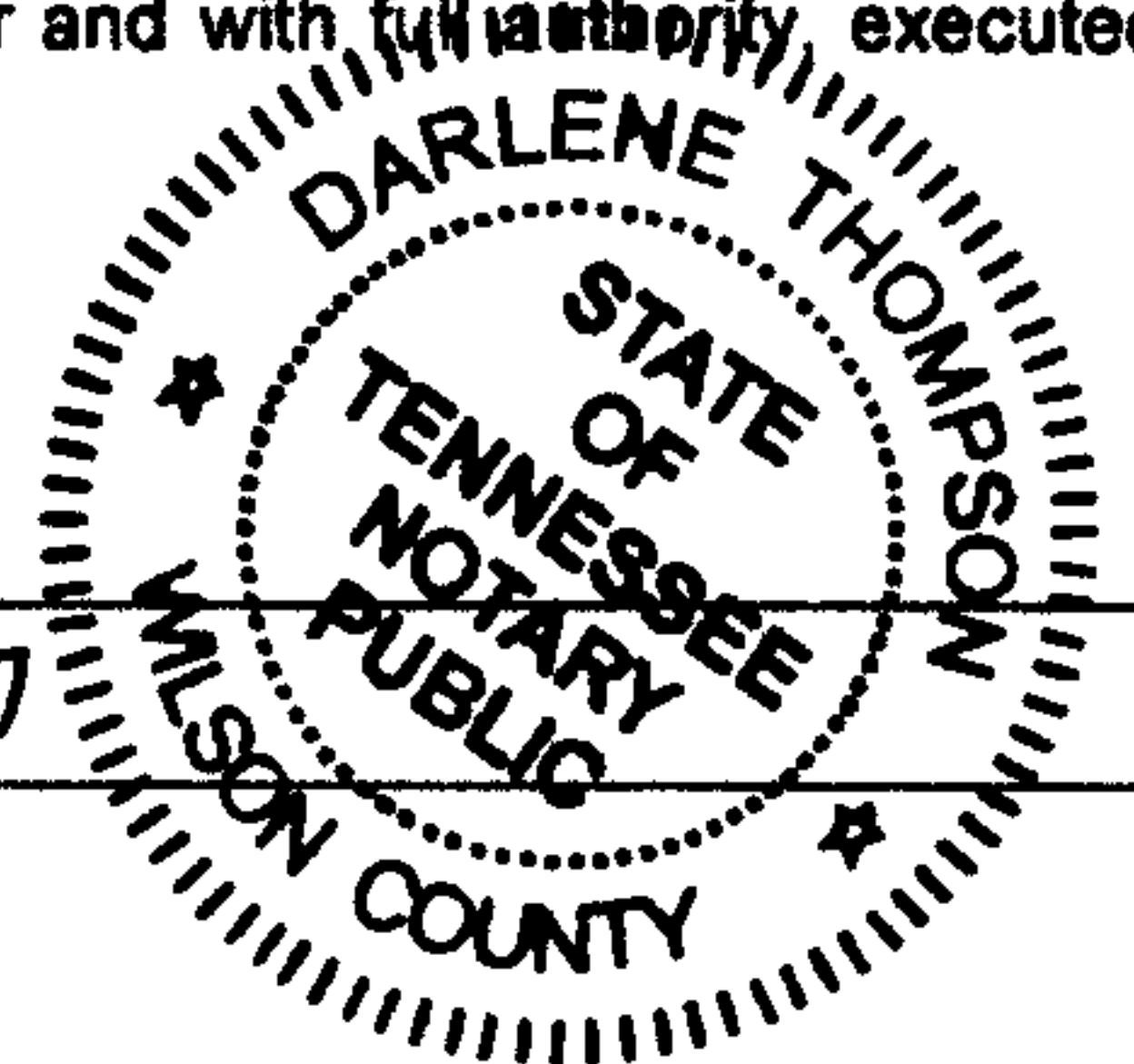

20141212000391170 2/3 \$20.50
Shelby Cnty Judge of Probate, AL
12/12/2014 11:39:45 AM FILED/CERT

Customer	Location	Created Svc Date	County	Section	Township	Range	Add'l Info.	Estimate No.
DEERFIELD CONST INC (ALDI)	275 1ST ST SO	08/08/2014	Shelby	2	21S	03W		A6170-06-AL14
Division	District	Town	UserID	Created:	Substation	X.	Y.	MISSALL#
BIRMINGHAM - SOUTH	METRO SOUTH	ALABASTER	aachand #11507	7/18/2014	ELLIOTTSVILLE D.S.	X- 39886	Y- XD9771	

ENERGIZED WORK PERMIT:	Loc	Transformer Loading
Substation: ELLIOTTSVILLE D S Feeder: #1, 39886 Switch: N/A Fused: N/A OCR: N/A	3	154KVA



Voltage	Pri	Sec
19.9kV 120240V 34.5kV		

Phone Co.	Cable Co.	Accessible	Tree Crew	Rock Hole	Permits	R/W	CITY	COUNTY	STATE	OTHER
Y	Y	Y	N	N		Y				

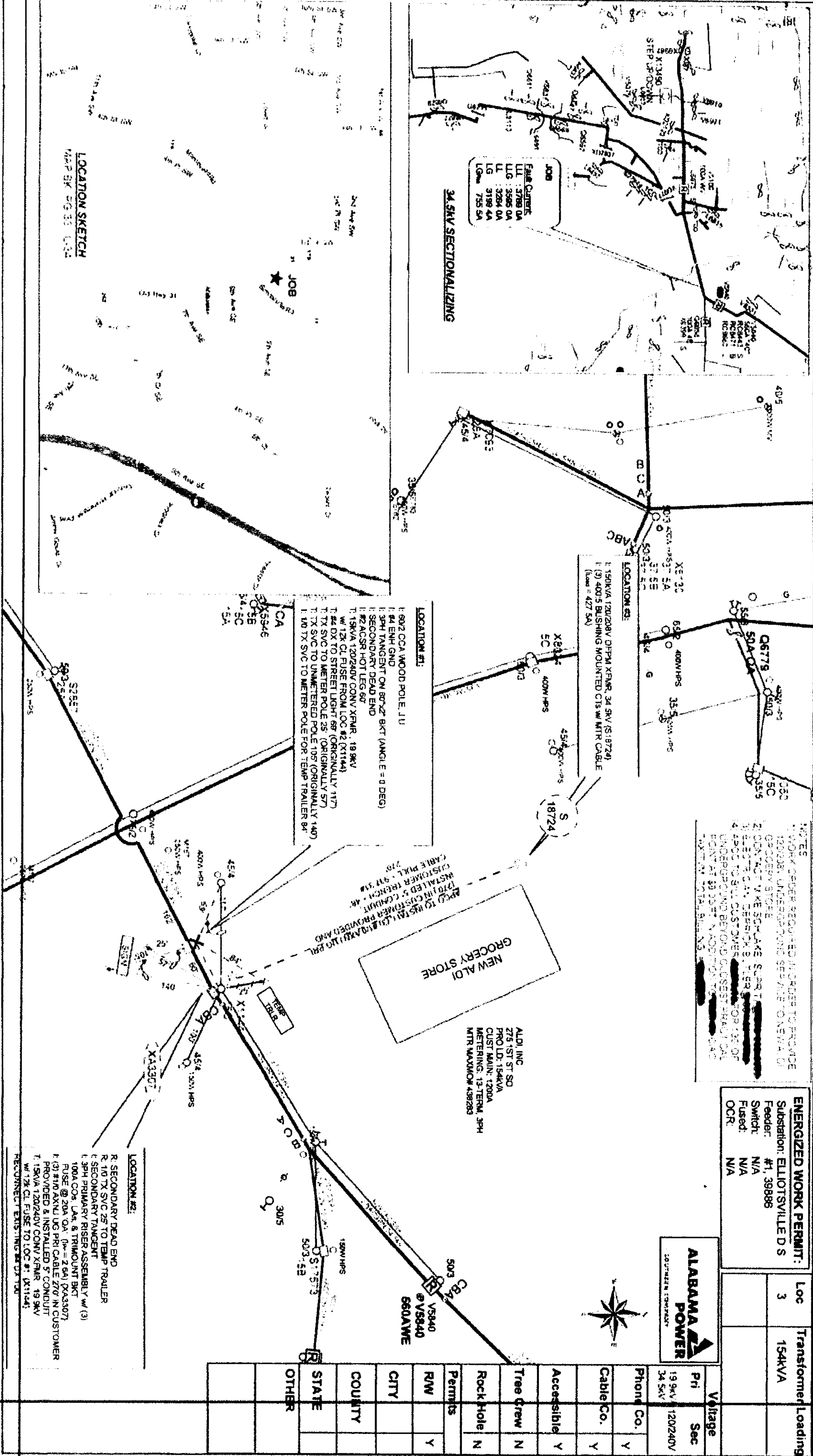

34.5KV SECTIONALIZING

LOCATION SKETCH

LOCATION #1:

1. 60' OCA WOOD POLE, JU
2. 4" EMB GND
3. 3PH TANGENT ON 80'-42' BKT (ANGLE = 0 DEG)
4. SECONDARY DEAD END
5. #2 ACSR HOT LEG 60'
6. 15KVA 120/240V CONV XFN'R, 19.9KV
7. 12" CL FUSE FROM LOC #2 (X1144)
8. 12" CL DX TO STREET LIGHT 68' (ORIGINALLY 117')
9. 1" TX SVC TO METER POLE 25' (ORIGINALLY 57')
10. 1" TX SVC TO UNMETERED POLE 195' (ORIGINALLY 140')
11. 1" TX SVC TO METER POLE FOR TEMP TRAILER 84'

LOCATION #2:

1. SECONDARY DEAD END
2. 10" TX SVC 25' TO TEMP TRAILER
3. SECONDARY TANGENT
4. 3PH PRIMARY RISER ASSEMBLY w/ (3)
5. 100A CO'S, LAG, & TRIMOUNT BKT
6. FUSE @ 20A (OA, 0A = 2.6A) (X43307)
7. (3) #10 AXLN UG PRI CABLE 270' IN CUSTOMER
8. PROVIDED & INSTALLED 5' CONDUIT
9. 15KVA 120/240V CONV XFN'R, 19.9KV
10. 12" CL FUSE TO LOC #1 (X1144)
11. RECONNECT EXISTING 84' TRAILER



20141212000391170 3/3 \$20.50
Shelby Cnty Judge of Probate, AL
12/12/2014 11:39:45 AM FILED/CERT

R/W Agent Dean Fritz
Date Assigned 7-18-14
Date Cleared 7-29-14
Parcel # 70264612