

Source of Title:

Deed Book \_\_\_\_\_, Page \_\_\_\_\_

50000

EASEMENT – DISTRIBUTION FACILITIES

STATE OF ALABAMA

COUNTY OF Shelby

W.E. No. A6272-14-AK14 A6272-14-AN14

APCO Parcel No. 70264822

Transformer No. 2048

This instrument prepared by: Adam Lochamy

Alabama Power Company  
P. O. Box 2641  
Birmingham, Alabama 35291



20141013000322840 1/3 \$20.50  
Shelby Cnty Judge of Probate, AL  
10/13/2014 12:16:37 PM FILED/CERT

Shelby County, AL 10/13/2014  
State of Alabama  
Deed Tax: \$.50

KNOW ALL MEN BY THESE PRESENTS, That Mike Mims and wife, Teresa Mims

as grantor(s), (the "Grantor", whether one or more) for and in consideration of One and No/100 Dollar (\$1.00) and other good and valuable consideration paid to Grantor in hand by Alabama Power Company, a corporation, the receipt and sufficiency of which are hereby acknowledged, hereby grant to Alabama Power Company, its successors and assigns (the "Company"), the easements, rights and privileges below.

**Overhead and/or Underground.** The right from time to time to construct, install, operate and maintain, upon, over, under and across the Property described below, all poles, towers, wires, conduits, fiber optics, cables, communication lines, translosures, transformers, anchors, guy wires and other facilities useful or necessary in connection therewith (collectively, "Facilities"), for the overhead and/or underground transmission and distribution of electric power and communications, along a route selected by the Company, as generally shown on the Company's drawing attached hereto and made a part hereof, but which is to be determined by the actual location(s) in which the Company's facilities are installed. The width of the Company's easement will depend on whether the Facilities are underground or overhead: for underground, the easement will extend five (5) feet on each side of said Facilities as and where installed; for overhead Facilities, the easement will extend fifteen (15) feet on each side of the centerline of said Facilities as and where installed. The Company is granted the right to clear, and keep clear, all trees, undergrowth and other obstructions on a strip of land extending five (5) feet from each side of said underground Facilities, and to clear, and keep clear, all trees, undergrowth and other obstructions on a strip of land extending fifteen (15) feet from each side of the centerline of said overhead Facilities and the right in the future to install intermediate poles and facilities on said strip. Further, with respect to overhead Facilities, the Company is also granted the right to trim and cut, and keep trimmed and cut, all dead, weak, leaning or dangerous trees or limbs outside of the thirty (30) foot strip that, in the sole opinion of the Company, may now or hereafter endanger, interfere with, or fall upon any of said overhead Facilities.

Grantor hereby grants to the Company all easements, rights and privileges necessary or convenient for the full enjoyment and use thereof, including without limitation the right of ingress and egress to and from said Facilities, as applicable, and the right to excavate for installation, replacement, repair and removal thereof; and also the right to cut, remove and otherwise keep clear any and all structures, obstructions or obstacles of whatever character, on, under and above said Facilities, as applicable.

The easements, rights and privileges granted hereby shall apply to, and the word "Property" as used in this instrument shall mean, the following described real property situated in Shelby County, Alabama (the "Property"):

A parcel of land located in the NE 1/4 of the NE 1/4 of Section 20, Township 20 South, Range 2 East, being more particularly described in instrument #'s 20131105000436710 & 1997-29791, as recorded in the Office of the Judge of Probate of Shelby County, Alabama.

In the event it becomes necessary or desirable for the Company from time to time to move any of the Facilities in connection with the construction or improvement of any public road or highway in proximity to the Facilities, Grantor hereby grants to the Company the right to relocate the Facilities and, as to such relocated Facilities, to exercise the rights granted above; provided, however, the Company shall not relocate said Facilities on the Property at a distance greater than ten feet (10') outside the boundary of the right of way of any such public road or highway as established or re-established from time to time. This grant and agreement shall be binding upon and shall inure to the benefit of Grantor, the Company and each of their respective heirs, personal representatives, successors and assigns and the words "Company" and "Grantor" as used in this instrument shall be deemed to include the heirs, personal representatives, successors and assigns of such parties.

TO HAVE AND TO HOLD the same to the Company, its successors and assigns, forever.

IN WITNESS WHEREOF, the undersigned Grantor(s) has/have set his/her/their hand(s) and seal(s) this the 29<sup>th</sup> day of July, 2014.

Brenda Palmer  
Witness

Brenda Palmer  
Witness

Witness

Mike Mims (SEAL)  
(Grantor)

Teresa Mims (SEAL)  
(Grantor)

By: \_\_\_\_\_ (SEAL)

As: \_\_\_\_\_

**For Alabama Power Company Corporate Real Estate Department Use Only**

All facilities on Grantor: ☒ Station to Station: \_\_\_\_\_

Less & except dedicated ROAD ROW



**SKETCH OF PROPOSED WORK - SIMPLIFIED W.E.**

Map Center UIM: 1808174 12082

Map Center LatLon: 33.283161 -86.450

**1 inch = 54 feet**

[illegible]

20141013000322840 2/3 \$20.50  
Shelby Cnty Judge of Probate, AL  
10/13/2014 12:16:37 PM FILED/CERT

Cleared 7/30/14

70264822

Customer APCo 30696 / E5757	Location 12 DUSTY WAY	Cmtd. Svc Date 1807808	County Shelby	Section 20	Township 20S	Range 02E	Add'l Info.	Estimate No. A6272-14-AN14
Division ANNISTON	District OAK GROVE	Town Harpersville	UserID bmjohnso	Created: 7/28/2014	Substation X- 21684	Y- R2432 Recloser	MISSALL# 14291035 Start End Update 7-30-14 8-13-14 8-11-14	
ENERGIZED LINE WORK Sub Haperville#1_21684 OCR R2434 Switch# Fuse Size								Transformer Loading Loc #6400 36.39 kVA

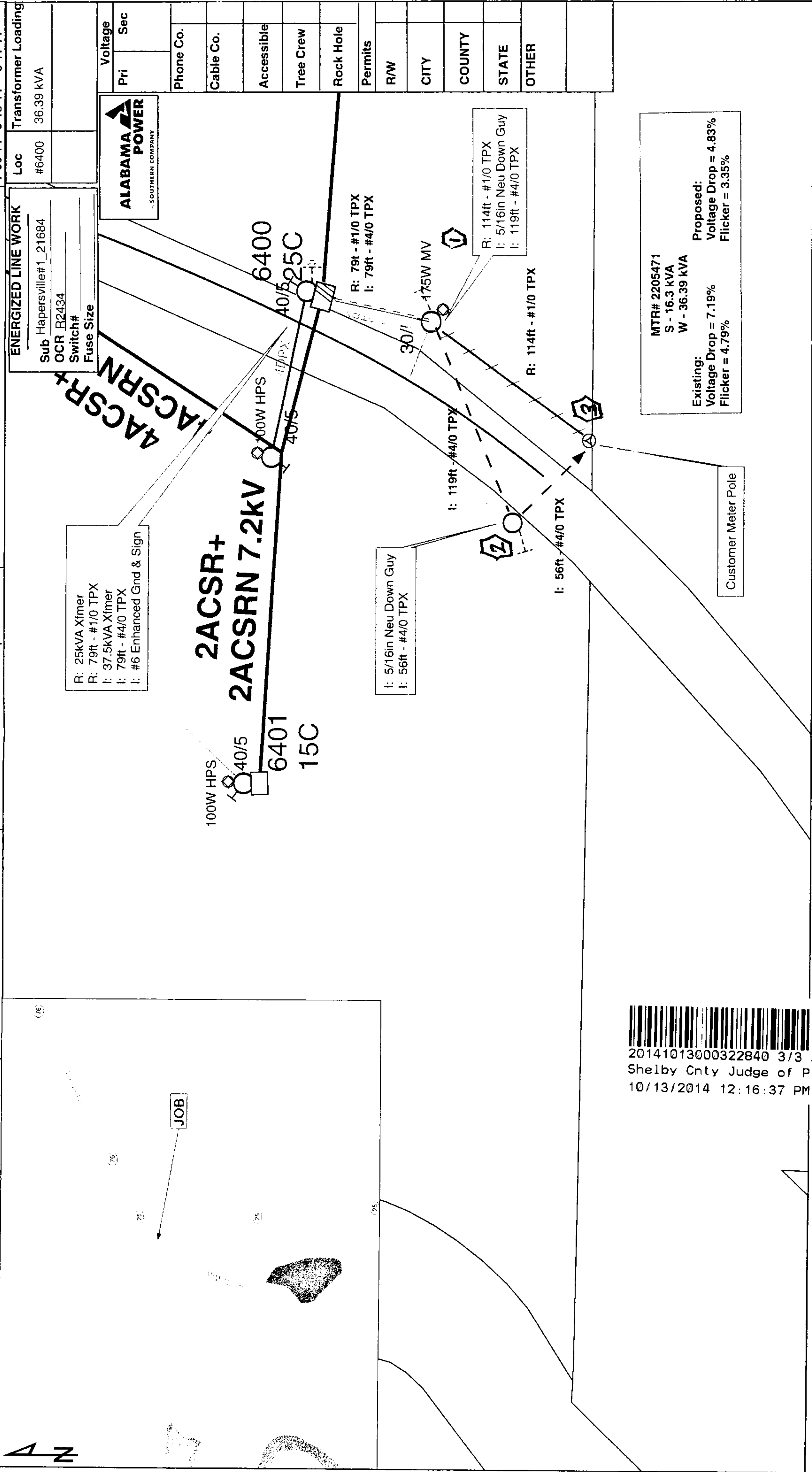

20141013000322840 3/3 \$20.50  
Shelby Cnty Judge of Probate, AL  
10/13/2014 12:16:37 PM FILED/CERT

70264822

Cleared 7/30/14 ROAD ROW: Sta 1+33 to Sta 1+98;  
Sta 2+08 to Sta 3+00