

Lessee Site Name: Greystone  
Lessee Site Number: 267382

Lessor Site Name: BIRMINGHAM OAK MOUNT 11650  
JDE Business Unit: 811274

This Instrument prepared by:  
William M. Lawrence  
Baker Donelson Bearman  
Caldwell & Berkowitz, PC  
420 20th Street North  
Birmingham, AL 35203



20140812000251240 1/6 \$194.50  
Shelby Cnty Judge of Probate, AL  
08/12/2014 09:38:27 AM FILED/CERT

Source(s) of Title: Deed  
recorded as Instrument Number  
19731023000058710 and Site  
Designation Supplement and  
Memorandum of Lease recorded  
as Instrument Number 2002-  
00813 in the Office of the Judge  
of Probate of Shelby County,  
Alabama.

STATE OF ALABAMA

COUNTY OF SHELBY

)  
)  
)  
Shelby County, AL 08/12/2014  
State of Alabama  
Deed Tax: \$165.50

### MEMORANDUM FOR RECORDING

THIS MEMORANDUM FOR RECORDING ("Memorandum"), made this 18th day of July, 2014, between **CROWN CASTLE SOUTH LLC**, a Delaware limited liability company (Crown Castle South Inc., a Delaware corporation, was converted pursuant to Delaware law to Crown Castle South LLC, a Delaware limited liability company, effective December 31, 2001) ("LESSOR"), with an office located at 2000 Corporate Drive, Canonsburg, PA 15317, and **CELLCO PARTNERSHIP**, a Delaware general partnership d/b/a Verizon Wireless, with its principal offices located at One Verizon Way, Mail Stop 4AW100, Basking Ridge, New Jersey 07920 ("LESSEE").

1. LESSOR and LESSEE entered into a Site Supplement (the "Supplement") pursuant to a "Master Lease Agreement" between Crown Communication and Cellco Partnership, dated as of November 30, 2000, as amended. The Supplement has an initial term of ten (10) years, which may be extended for up to three (3) additional five (5) year terms.

2. In consideration of the payments, and subject to the terms and conditions in the "Master Lease Agreement" and the Supplement, LESSOR has leased or subleased to LESSEE space at property located 5332 U.S. Hwy 280 S., Birmingham, Shelby County, Alabama 35242, which property is described as a parcel containing approximately Four Thousand One Hundred Twenty-Five (4,125) square feet, as shown on the Tax Map of Shelby County, Alabama as Parcel Identification Number 03-9-31-0-002-012.000 and is more particularly described in Exhibit "1" attached to, and made a part of, this Memorandum. The lease or sublease includes the non-exclusive appurtenant rights for ingress and egress, seven (7) days per week, twenty-four (24) hours per day, on foot or motor vehicle, including trucks, and for the installation and maintenance of utility wires, poles, cables, conduits and pipes over, under, or along an existing right of way extending from the nearest public right of way.

3. The Supplement commences on June 1, 2014. Copies of the "Master Lease Agreement" and the Supplement are on file in the offices of LESSOR and LESSEE.

4. The terms, covenants and provisions of the "Master Lease Agreement" and the Supplement shall extend to, and be binding upon, the respective administrators, successors, and assigns of LESSOR and LESSEE.

Lessee Site Name: Greystone  
Lessee Site Number: 267382

Lessor Site Name: BIRMINGHAM OAK MOUNT 11650  
JDE Business Unit: 811274

IN WITNESS OF THIS MEMORANDUM, LESSOR and LESSEE have caused this Memorandum to be duly executed on the day and year reflected on its first page.

**LESSOR:**

**Crown Castle South LLC**

Witness: Erin Boyler

By: Gregory Burgman  
Print Name: Gregory Burgman  
Title: Licensing Manager

Execution Date: 7-18, 2014

**LESSEE:**

**Cellco Partnership  
d/b/a Verizon Wireless**

Witness: Kim Ulrich

By: Aparna Khurjekar  
Name: Aparna Khurjekar  
Title: Area Vice President Network

Execution Date: 7.8, 2014

STATE OF Pennsylvania )  
 )  
COUNTY OF Washington )

I, the undersigned authority, a Notary Public in and for the referenced county and state, certify that Eiregory Burgman, whose name as Licensing Manager of **Crown Castle South LLC**, is signed to the foregoing instrument and who is known to me, acknowledged before me on this day that, being informed of the contents of such instrument, he/she as an authorized agent and with full authority, executed such instrument voluntarily for and as the act of such **limited liability company** on the day such instrument bears date.

Given under my hand and seal, this 18<sup>th</sup> day of JULY, 2014.

Amanda L. Barthurst  
Notary Public

Print Name: Amanda L. Barthurst

My Commission Expires: 10/24/17

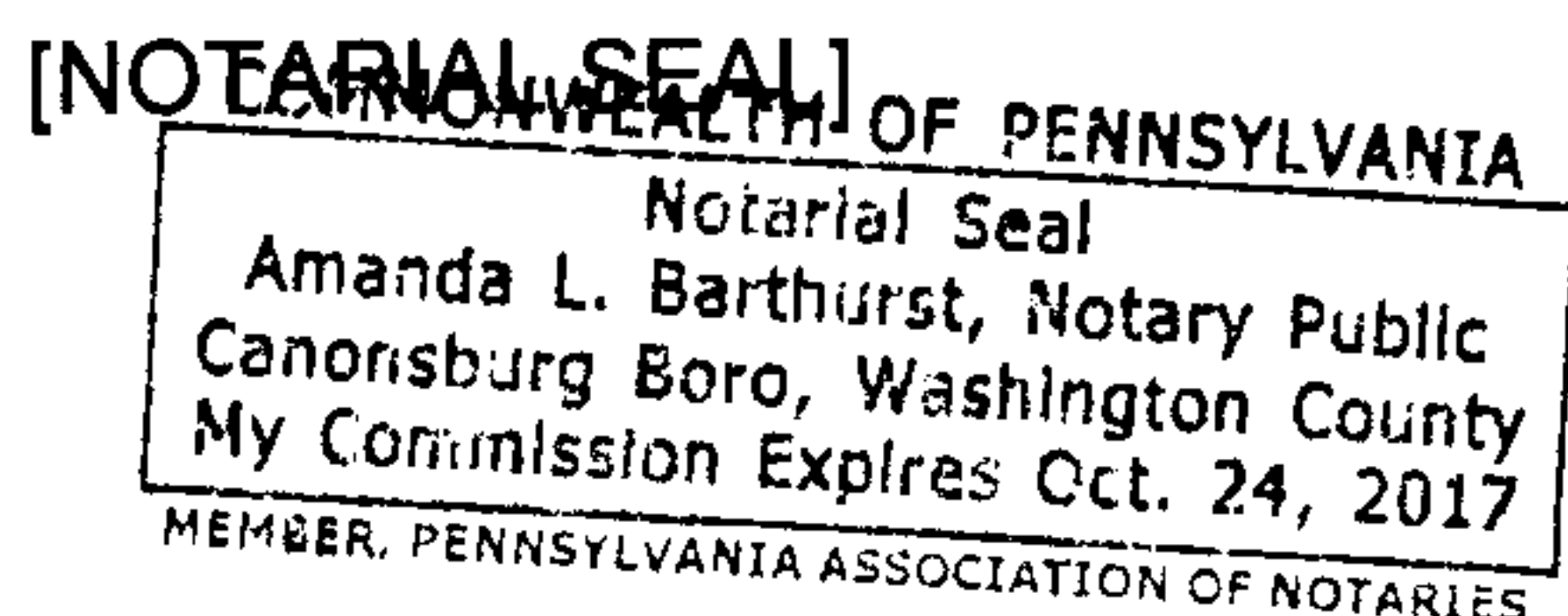

STATE OF NORTH CAROLINA )  
 )  
COUNTY OF MECKLENBURG )

I, the undersigned authority, a Notary Public in and for the referenced county and state, hereby certify that, **Aparna Khurjekar**, whose name as **Area Vice President Network of Celco Partnership d/b/a Verizon Wireless** is signed to the foregoing instrument and who is known to me, acknowledged before me on this day that, being informed of the contents of such instrument, she in her capacity as such officer and with full authority, executed such instrument voluntarily for and as the act of such **partnership** on the day such instrument bears date.

Given under my hand and seal, this 8 day of JULY, 2014.

Margaret A. Kiss  
Notary Public

Print Name: Margaret A. Kiss

My Commission Expires: \_\_\_\_\_

[NOTARIAL SEAL]

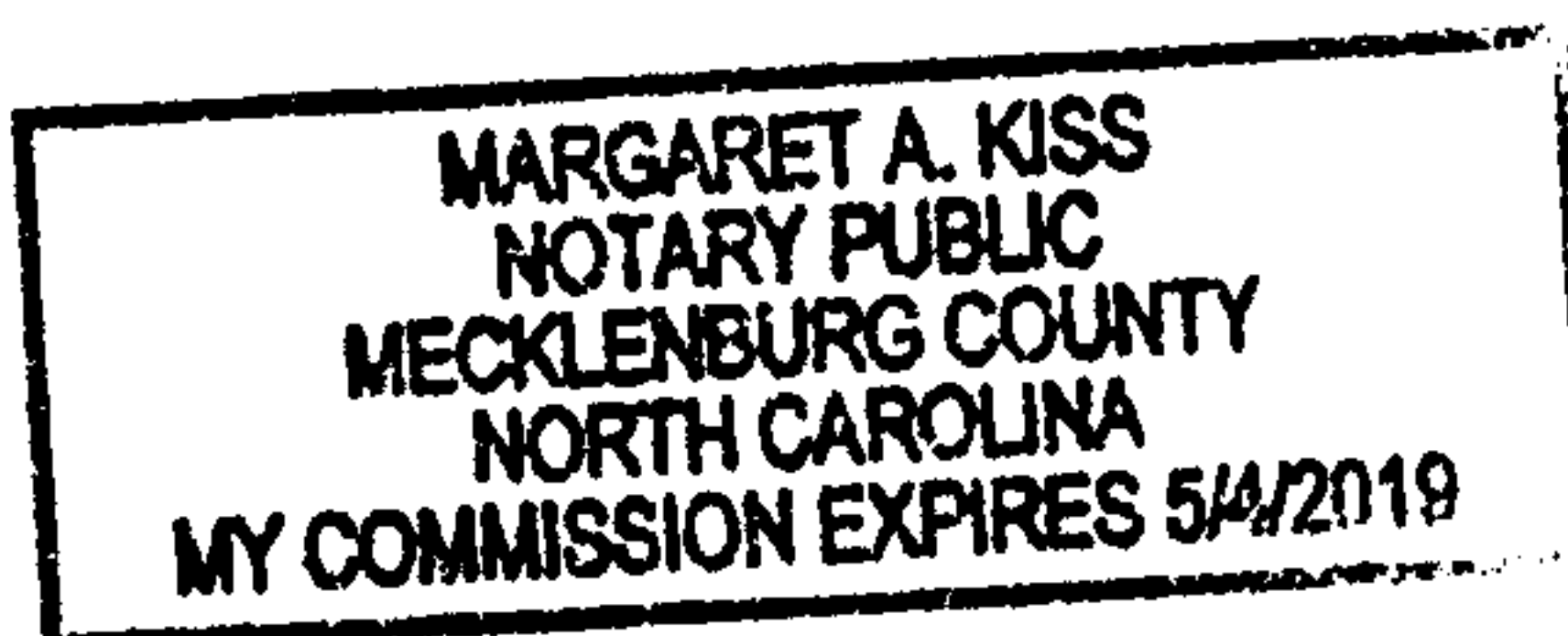



**EXHIBIT "1"**

**LEGAL DESCRIPTIONS OF PARENT TRACT AND ACCESS  
RIGHT-OF-WAY/EASEMENT AND SITE PLAN DRAWING**

**Parent Tract:**

**PARENT TRACT**

To find the POINT OF BEGINNING, commence at the Southeast Corner of the Southeast Quarter of the Southeast Quarter of Section 31, Township 18 South, Range 1 West of the Huntsville Meridian, Shelby County, Alabama; thence run in a Westerly direction along the South line of said Section 31 a distance of 500.00 feet to the POINT OF BEGINNING; thence continue along the South line of Said Section 31 a distance of 300.00 feet; thence run Northerly with an interior angle of 89°23'00" a distance of 1169.87 feet to the South right-of way of U.S. Highway 280; thence run on said right-of-way with an interior angle of 96°58'00" a distance of 102.83 feet to the P.C. (point of curve) of a curve to the right having a radius of 1392.30 feet and a central angle of 8°09'41"; thence continue on said right-of-way with an interior angle of 175°55'10" to the chord of said curve a distance of 198.16 feet; thence run Southerly with an interior angle of 87°06'52" a distance of 1189.09 feet to the POINT OF BEGINNING, and containing 354,971.17 square feet or 8.15 acres, more or less.

**LEASE PARCEL**

To find the POINT OF BEGINNING, commence at the Southeast Corner of the Southeast Quarter of the Southeast Quarter of Section 31, Township 18 South, Range 1 West of the Huntsville Meridian, Shelby County, Alabama; thence run in a Westerly direction along the South line of said Section 31 a distance of 529.04 feet; thence with an angle to the left of 90°00'00" a distance of 226.78 feet to the POINT OF BEGINNING; thence with an angle to the left of 179°35'12" a distance of 75.00 feet to a point; thence with a deflection angle to the left of 90°00'00" a distance of 55.00 feet to a point; thence with a deflection angle to the left of 90°00'00" a distance of 75.00 feet to a point; thence with a deflection angle to the left of 90°00'00" a distance of 55.00 feet to the POINT OF BEGINNING, and containing 4125.00 square feet or 0.09 acres, more or less.

Being a part of the property conveyed to the South Central Bell Telephone Company by deed recorded in Deed Book 283, Page 178, in the Office of the Probate Judge of Shelby County, Alabama.

  
20140812000251240 4/6 \$194.50  
Shelby Cnty Judge of Probate, AL  
08/12/2014 09:38:27 AM FILED/CERT

**Lessor Site Name: BIRMINGHAM OAK MOUNT 11650**  
**JDE Business Unit: 811274**

[illegible]



Lessee Site Name: Greystone  
Lessee Site Number: 267382

Lessor Site Name: BIRMINGHAM OAK MOUNT 11650  
JDE Business Unit: 811274

Site Plan:

Lessee is identified in the attached Site Plan as "Verizon Wireless"

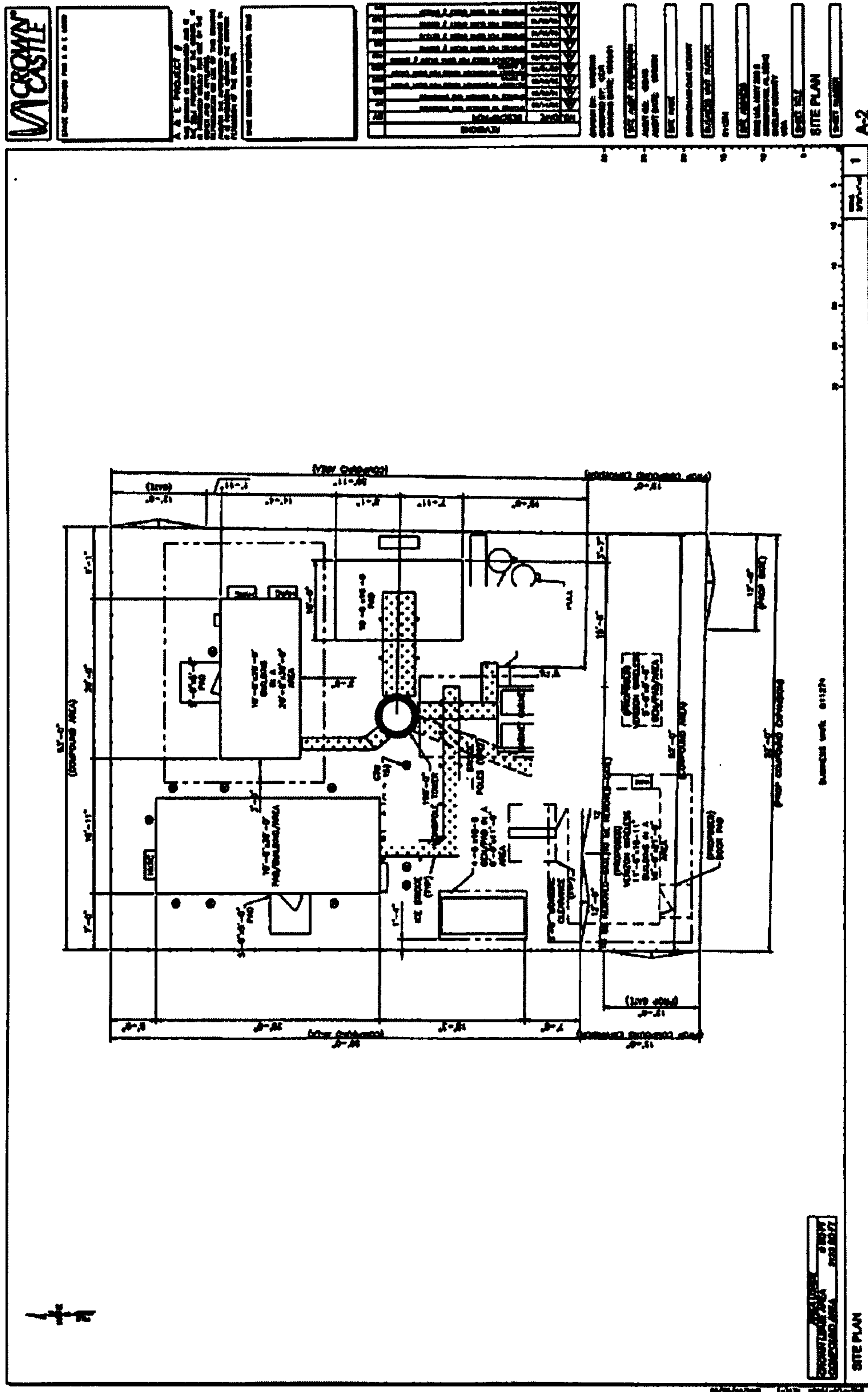

CROWN  
CASTLE