

Instrument # 20080410000145080

500.00

EASEMENT - DISTRIBUTION FACILITIES

STATE OF ALABAMA

COUNTY OF SHELBY

W.E. No. A6170-14-A813

APCO Parcel No. 70253528

Transformer No. S1382

This instrument prepared by: Dean Fritz

Alabama Power Company
P. O. Box 2641
Birmingham, Alabama 35291

20140611000176120 1/2 \$19.50
Shelby Cnty Judge of Probate, AL
06/11/2014 11:20:22 AM FILED/CERT

KNOW ALL MEN BY THESE PRESENTS That Tyler S. Johnston and wife Eileen Potts Johnston
AKA Eileen Johnston
as grantor(s) (the "Grantor", whether one or more) for and in consideration of One and No/100 Dollar (\$1.00) and other good and valuable consideration paid to Grantor in hand by Alabama Power Company, a corporation, the receipt and sufficiency of which are hereby acknowledged, does hereby grant to Alabama Power Company, its successors and assigns (the "Company"), the easements, rights and privileges below.

Overhead and/or Underground. The right from time to time to construct, install, operate and maintain, upon, over, under and across the Property described below, all poles, towers, wires, conduits, fiber optics, cables, communication lines, trans closures, transformers, anchors, guy wires and other facilities useful or necessary in connection therewith (collectively, "Facilities"), for the overhead and/or underground transmission and distribution of electric power and communications, along a route selected by the Company, as generally shown on the Company's drawing attached hereto and made a part hereof, but which is to be determined by the actual location(s) in which the Company's facilities are installed. The width of the Company's easement will depend on whether the Facilities are underground or overhead: for underground, the easement will extend five (5) feet on each side of said Facilities as and where installed; for overhead Facilities, the easement will extend fifteen (15) feet on each side of the centerline of said Facilities as and where installed. The Company is granted the right to clear, and keep clear, all trees, undergrowth and other obstructions on a strip of land extending five (5) feet from each side of said underground Facilities, and to clear, and keep clear, all trees, undergrowth and other obstructions on a strip of land extending fifteen (15) feet from each side of the centerline of said overhead Facilities and the right in the future to install intermediate poles and facilities on said strip. Further, with respect to overhead Facilities, the Company is also granted the right to trim and cut, and keep trimmed and cut, all dead, weak, leaning or dangerous trees or limbs outside of the thirty (30) foot strip that, in the sole opinion of the Company, may now or hereafter endanger, interfere with, or fall upon any of said overhead Facilities.

Grantor hereby grants to the Company all easements, rights and privileges necessary or convenient for the full enjoyment and use thereof, including without limitation the right of ingress and egress to and from said Facilities, as applicable, and the right to excavate for installation, replacement, repair and removal thereof; and also the right to cut, remove and otherwise keep clear any and all structures, obstructions or obstacles of whatever character, on, under and above said Facilities, as applicable.

The easements, rights and privileges granted hereby shall apply to, and the word "Property" as used in this instrument shall mean, the following described real property situated in Shelby County, Alabama (the "Property"): a parcel of land located in the NW¼ of the SE¼ of Section 21, Township 19 South, Range 1 West, more particularly described in that certain instrument recorded in Instrument # 2008041000145080, in the office of the Judge of Probate of said County.

In the event it becomes necessary or desirable for the Company from time to time to move any of the Facilities in connection with the construction or improvement of any public road or highway in proximity to the Facilities, Grantor hereby grants to the Company the right to relocate the Facilities and, as to such relocated Facilities, to exercise the rights granted above; provided, however, the Company shall not relocate said Facilities on the Property at a distance greater than ten feet (10') outside the boundary of the right of way of any such public road or highway as established or re-established from time to time. This grant and agreement shall be binding upon and shall inure to the benefit of Grantor, the Company and each of their respective heirs, personal representatives, successors and assigns and the words "Company" and "Grantor" as used in this instrument shall be deemed to include the heirs, personal representatives, successors and assigns of such parties.

TO HAVE AND TO HOLD the same to the Company, its successors and assigns, forever.

IN WITNESS WHEREOF, the undersigned Grantor has executed this instrument on this 12th day of April, 2013.

Cary Cowart
Witness Signature

CARY COWART
Print Name

Kathy Cowart
Witness Signature

Kathy Cowart
Print Name

(Grantor) (SEAL)

(Grantor) (SEAL)

Station to Station: Sta 1+60 to Sta 2+96 (SW)

Shelby County, AL 06/11/2014
State of Alabama
Deed Tax: \$.50

Customer	CARY COWART	Location	113 FOREST PARKS RD	1748168	12/11/19	33-303602	00-000712
Division	BIRMINGHAM	District	METRO-SOUTH	Cmtd. Svc Date	DEC, 31 2013	County	Shelby
				Town	CHELSEA	UserID	mbryant
						Created:	1/10/2013
						Substation	DOUBLE_OAK_MTN_DS
						Range	01W
						Township	19S
						Section	21
						Estimate No.	A617014A813
						MISSALL#	J

NOTES:
1) TRANSFER SERVICE TO SECONDARY
POLE FOR CLEARANCE

Fault Current Estimate

Device No:	RC8989	Voltage:	151
Feeder:	DOUBLE_OAK_MTN_DS_400V		
Equipment Type:	50_OA		
LL:	0	LG:	3793
LLG:	0	LG-R:	764
LL:	0		

STA 1+00 TO STA 1+60
60' DEDICATED ROAD

R/W Agent Dean Fritz
Date Assigned 1-10-13
Date Cleared 4-15-13
Parcel # 70253527
70253528

Forest Parks Rd.

RC8989
50A QA
140ADV

ALABAMA POWER
A 50 STREET COUNCIL

-Voltage Drop: 3.29 %
-Flicker: 3.25 %
-Current Transformer
Load: 44.5 kVA

LOCATION 1:
I: 35/5 CCA POLE
I: 2 SEC DE
I: 1/0 TPX SEC WIRE
T: 2 SVC RCT

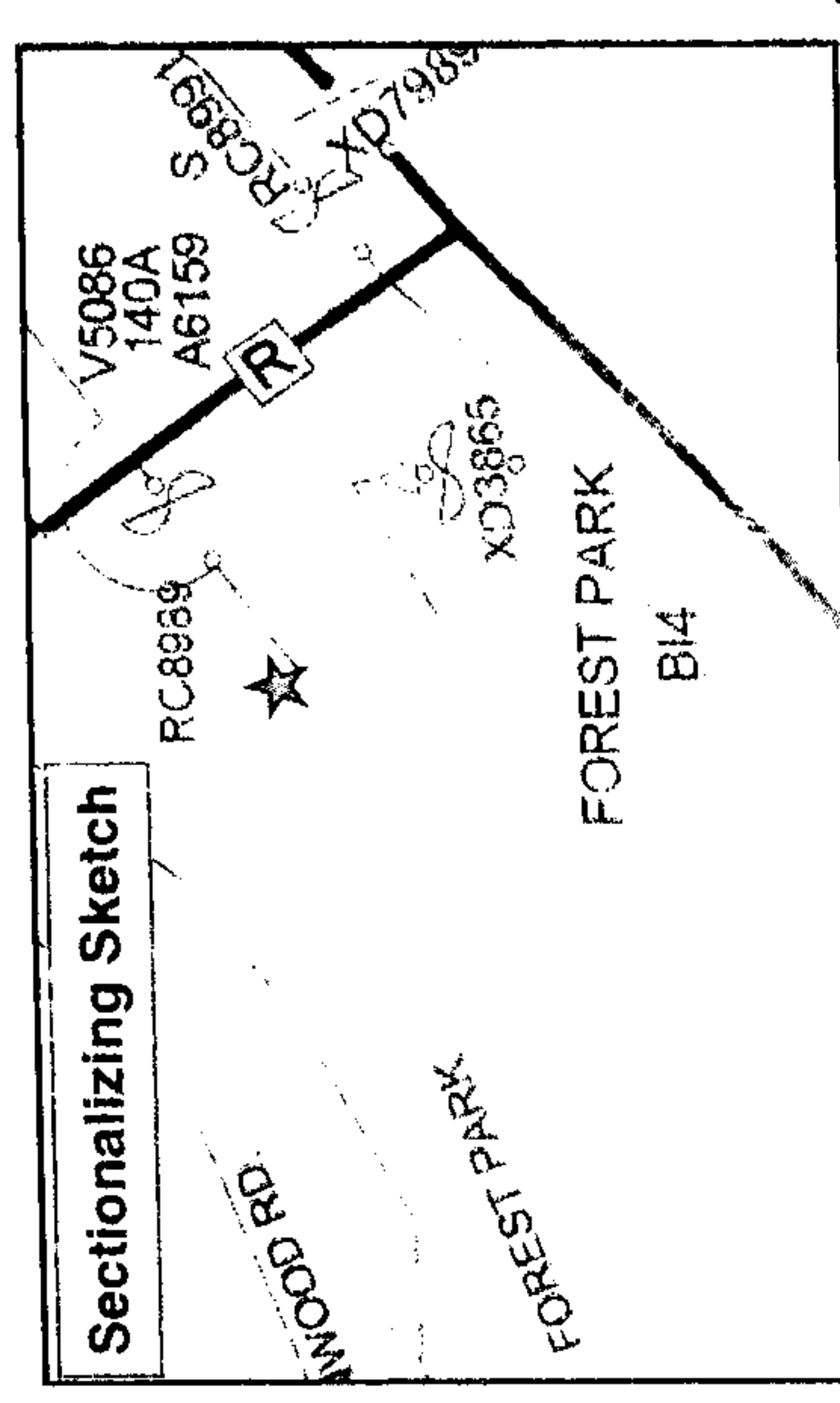

20140611000176120 2/2 \$19.50
Shelby Cnty Judge of Probate, AL
06/11/2014 11:20:22 AM FILED/CERT