

EASEMENT - DISTRIBUTION FACILITIES

STATE OF ALABAMA

COUNTY OF SHELBY

W.E. No. A6170-20-A113

APCO Parcel No. 70258034

Transformer No. XD8155

This instrument prepared by: Dean Fritz

Alabama Power Company
P. O. Box 2641
Birmingham, Alabama 35291

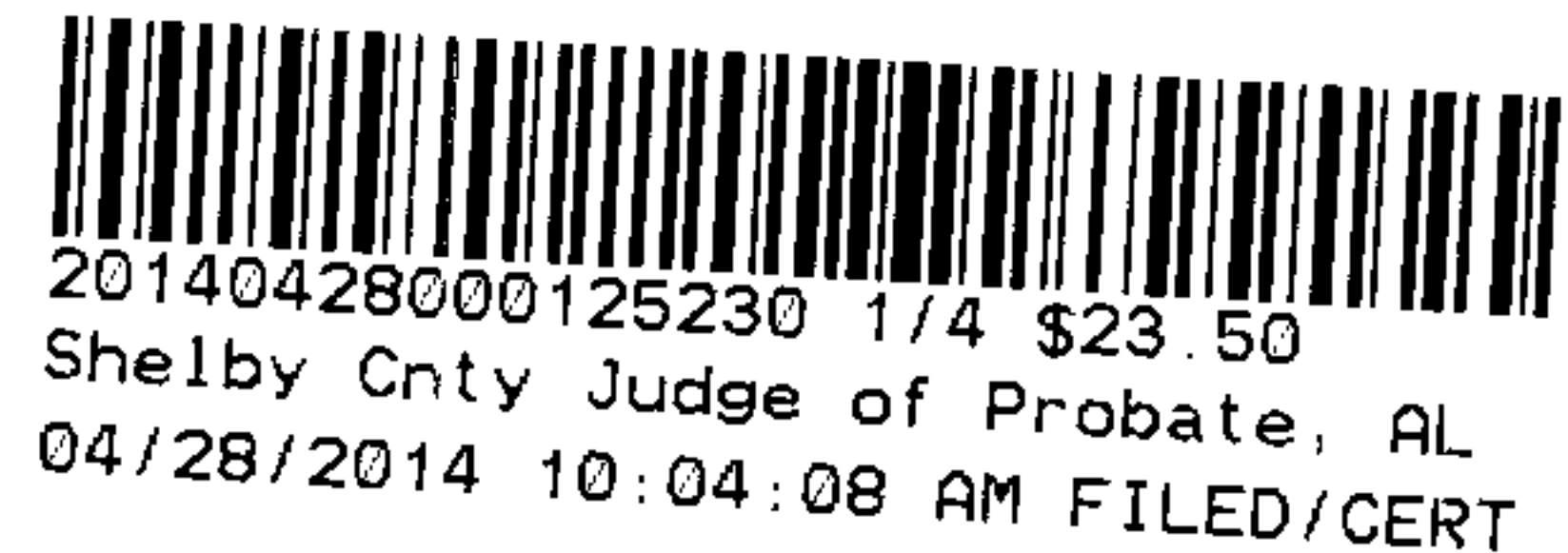

Shelby County, AL 04/28/2014
State of Alabama
Deed Tax: \$.50

KNOW ALL MEN BY THESE PRESENTS, That Wells Fargo Bank, National Association, lessee as grantor(s), (the "Grantor", whether one or more) for and in consideration of One and No/100 Dollar (\$1.00) and other good and valuable consideration paid to Grantor in hand by Alabama Power Company, a corporation, the receipt and sufficiency of which are hereby acknowledged, does hereby grant, to the extent of Grantor's interest in the Property as hereafter defined, to Alabama Power Company, its successors and assigns (the "Company"), the easements, rights and privileges below.

Overhead and/or Underground. The right from time to time to construct, install, operate and maintain, upon, over, under and across the Property described below, all poles, towers, wires, conduits, fiber optics, cables, communication lines, trans closures, transformers, anchors, guy wires and other facilities useful or necessary in connection therewith (collectively, "Facilities"), for the overhead and/or underground transmission and distribution of electric power and communications, along a route selected by the Company, as generally shown on the Company's drawing attached hereto and made a part hereof, but which is to be determined by the actual location(s) in which the Company's facilities are installed. The width of the Company's easement will depend on whether the Facilities are underground or overhead: for underground, the easement will extend five (5) feet on each side of said Facilities as and where installed; for overhead Facilities, the easement will extend fifteen (15) feet on each side of the centerline of said Facilities as and where installed. The Company is granted the right to clear, and keep clear, all trees, undergrowth and other obstructions on a strip of land extending five (5) feet from each side of said underground Facilities, and to clear, and keep clear, all trees, undergrowth and other obstructions on a strip of land extending fifteen (15) feet from each side of the centerline of said overhead Facilities and the right in the future to install intermediate poles and facilities on said strip. Further, with respect to overhead Facilities, the Company is also granted the right to trim and cut, and keep trimmed and cut, all dead, weak, leaning or dangerous trees or limbs outside of the thirty (30) foot strip that, in the sole opinion of the Company, may now or hereafter endanger, interfere with, or fall upon any of said overhead Facilities.

Grantor hereby grants to the Company all easements, rights and privileges necessary or convenient for the full enjoyment and use thereof, including without limitation the right of ingress and egress to and from said Facilities, as applicable, and the right to excavate for installation, replacement, repair and removal thereof; and also the right to cut, remove and otherwise keep clear any and all structures, obstructions or obstacles of whatever character, on, under and above said Facilities, as applicable.

The easements, rights and privileges granted hereby shall apply to, and the word "Property" as used in this instrument shall mean, the following described real property situated in Shelby County, Alabama (the "Property"): a parcel of land located in the SW ¼ of the SW ¼ of Section 32 Township 18 South Range 1 West more particularly described in that certain instrument recorded in deed book 112 page 772 in the office of the Judge of Probate of said County.

In the event it becomes necessary or desirable for the Company from time to time to move any of the Facilities in connection with the construction or improvement of any public road or highway in proximity to the Facilities, Grantor hereby grants to the Company the right to relocate the Facilities and, as to such relocated Facilities, to exercise the rights granted above; provided, however, the Company shall not relocate said Facilities on the Property at a distance greater than ten feet (10') outside the boundary of the right of way of any such public road or highway as established or re-established from time to time. This grant and agreement shall be binding upon and shall inure to the benefit of Grantor, the Company and each of their respective heirs, personal representatives, successors and assigns and the words "Company" and "Grantor" as used in this instrument shall be deemed to include the heirs, personal representatives, successors and assigns of such parties.

TO HAVE AND TO HOLD the same to the Company, its successors and assigns, forever.

IN WITNESS WHEREOF, the said Grantor, has caused this instrument to be executed by DINA FELDMAN

its authorized representative, as of the 26th day of September, 2013.

ATTEST (if required) or WITNESS:

By: Mark A. Laddan

Its: VICE PRESIDENT

Wells Fargo Bank, National Association
(Grantor - Name of Corporation/Partnership/LLC)

By: Dina Feldman (SEAL)

Its: VICE PRESIDENT
[indicate: President, General Partner, Member, etc.]

All facilities on Grantor: _____

Station to Station: _____

CORPORATION NOTARY

STATE OF ALABAMA

COUNTY OF _____

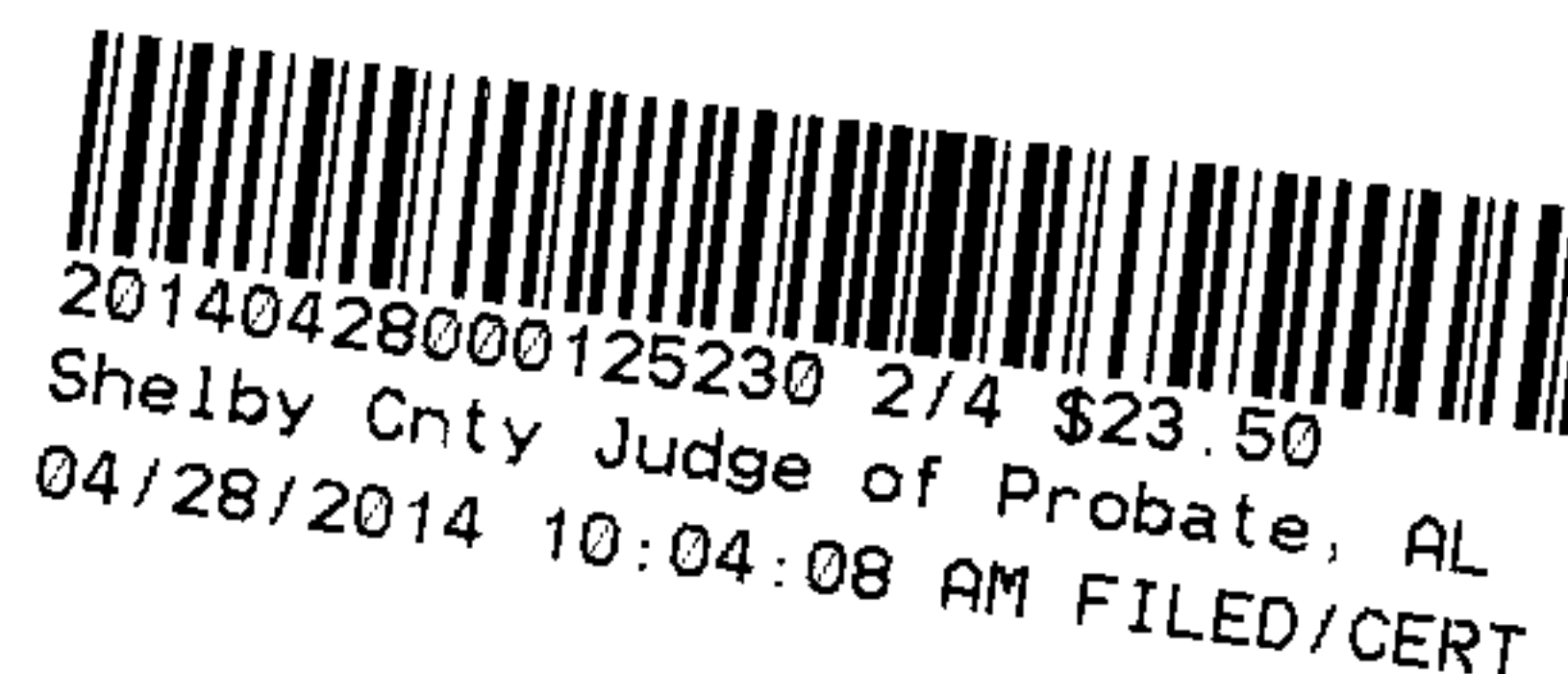

I, _____, a Notary Public, in and for said County in said State, hereby certify that _____, whose name as _____ of _____, a corporation, is signed to the foregoing instrument, and who is known to me, acknowledged before me on this day that, being informed of the contents of this instrument, he/she, as such officer and with full authority, executed the same voluntarily for and as the act of said Corporation.

Given under my hand and official seal, this the _____ day of _____, 20____.

[SEAL]

Notary Public

My commission expires: _____

CORPORATION/PARTNERSHIP/LLC NOTARY

STATE OF ALABAMA

COUNTY OF _____

I, _____, a Notary Public in and for said County in said State, hereby certify that _____, whose name as _____ of _____, a _____, [acting in its capacity as _____ of _____] is signed to the foregoing instrument, and who is known to me, acknowledged before me on this day that, being informed of the contents of the instrument, he/she, as such _____ and with full authority, executed the same voluntarily, for and as the act of said _____ [acting in such capacity as aforesaid].

Given under my hand and official seal this the _____ day of _____, 20____.

[SEAL]

Notary Public

My commission expires: _____

All facilities on Grantor: _____ Station to Station: Sta 4+135 to Sta 5+180

Parcel 70258034

CORPORATION NOTARY

STATE OF ALABAMA

COUNTY OF Tulsa

I, Stephen R. Williams, a Notary Public, in and for said County in said State, hereby certify that
Don Feldman, whose name as Vice President of
Wells Fargo Bank, National Association, a corporation, is signed to the foregoing instrument, and who is known to me,
acknowledged before me on this day that, being informed of the contents of this instrument, he/she, as such officer and with full authority, executed the same
voluntarily for and as the act of said Corporation.

Given under my hand and official seal, this the 20th day of Sept, 2013.

[SEAL] _____
Notary Public
My commission expires: 12-08-2016

CORPORATION/PARTNERSHIP/LLC NOTARY

STATE OF ALABAMA

COUNTY OF _____

I, _____, a Notary Public in and for said County in said State, hereby certify that _____
_____, whose name as _____ of
_____, a _____, [acting in its capacity as
_____ of _____, a _____
_____] is signed to the foregoing instrument, and who is known to me, acknowledged before me on this day that, being
informed of the contents of the instrument, he/she, as such _____ and with full authority, executed the
same voluntarily, for and as the act of said _____ [acting in such capacity as aforesaid].

Given under my hand and official seal this the _____ day of _____, 20____.

[SEAL] _____
Notary Public
My commission expires: _____

20140428000125230 3/4 \$23.50
Shelby Cnty Judge of Probate, AL
04/28/2014 10:04:08 AM FILED/CERT

1444 Project: Deer Field
Drawn: 4-26-13
Date: 10-31-13
Client: 70258032
Project: 70258032
70258032
70258032
70258032

70258032

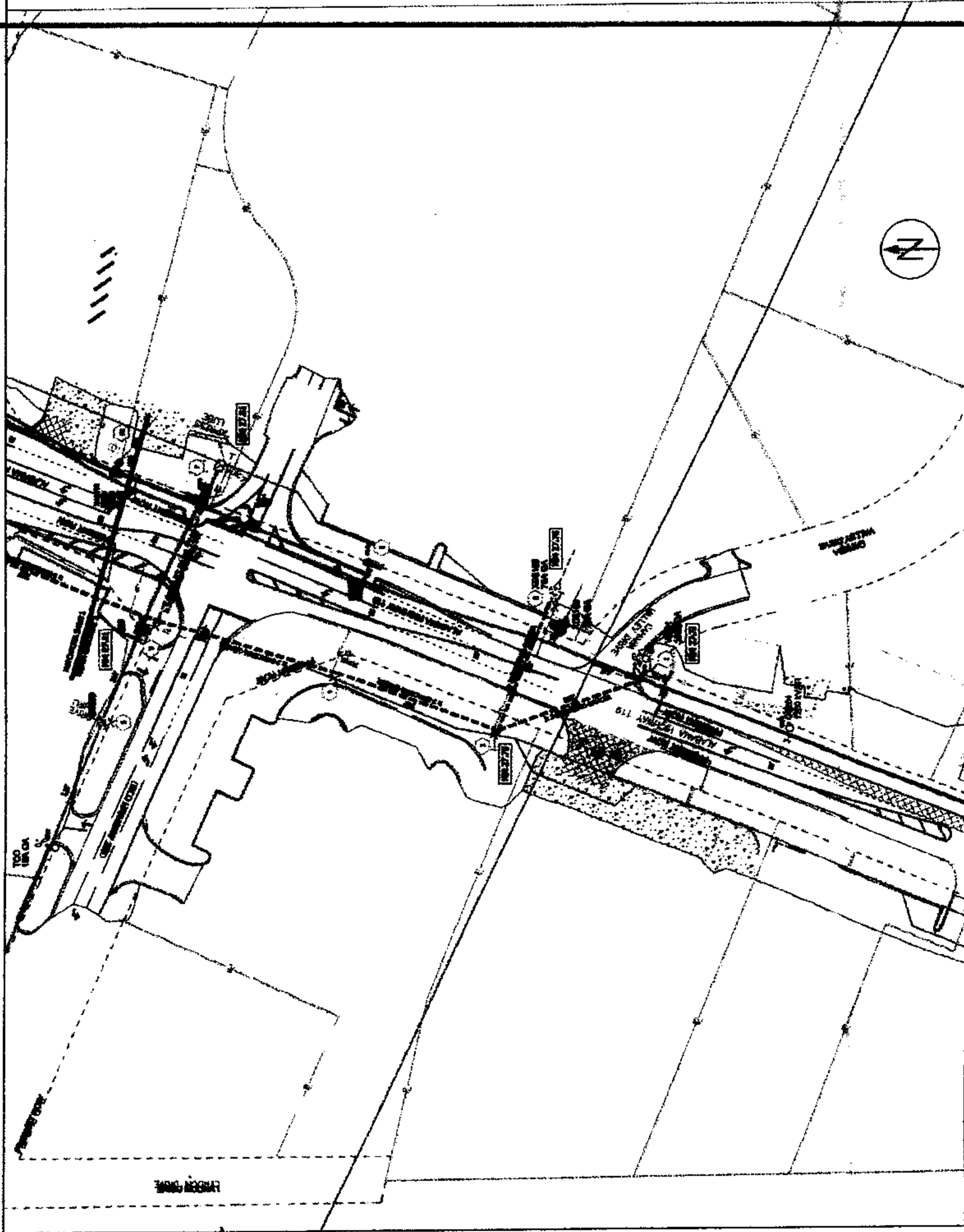

STA 1+10 TO STA 1+130
90' DEDICATED ROAD

STA 3+50 TO STA 4+135
80' DEDICATED ROAD

STA 5+10 TO STA 6+00 (M 1)
700' DEDICATED RIGHT
5.4% at 9+900
10700' at 700'

STA 5+02 TO STA 6+00 (M 1)
80' DEDICATED ROAD

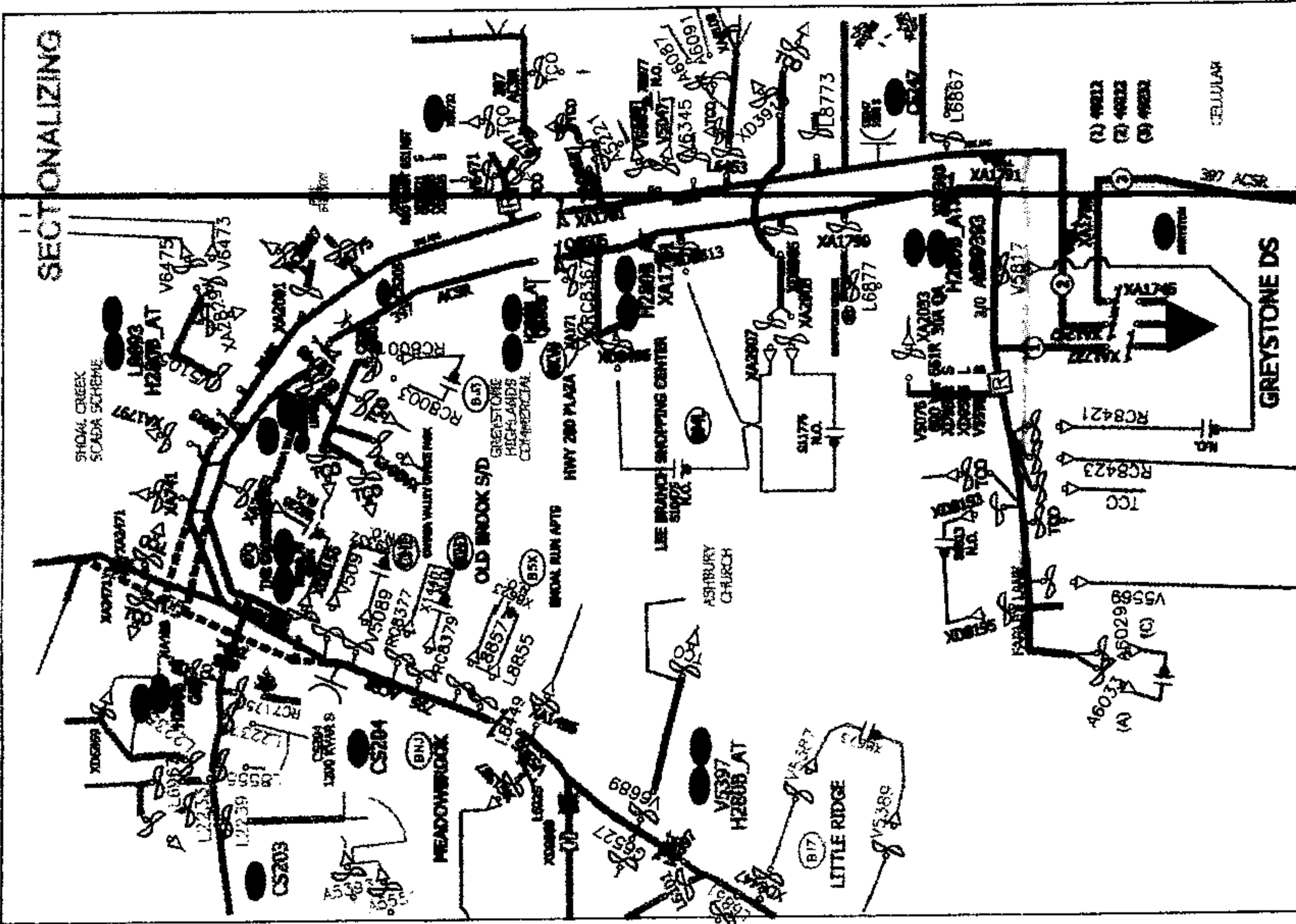

NEW SWITCHING DETAIL LOCATION 6

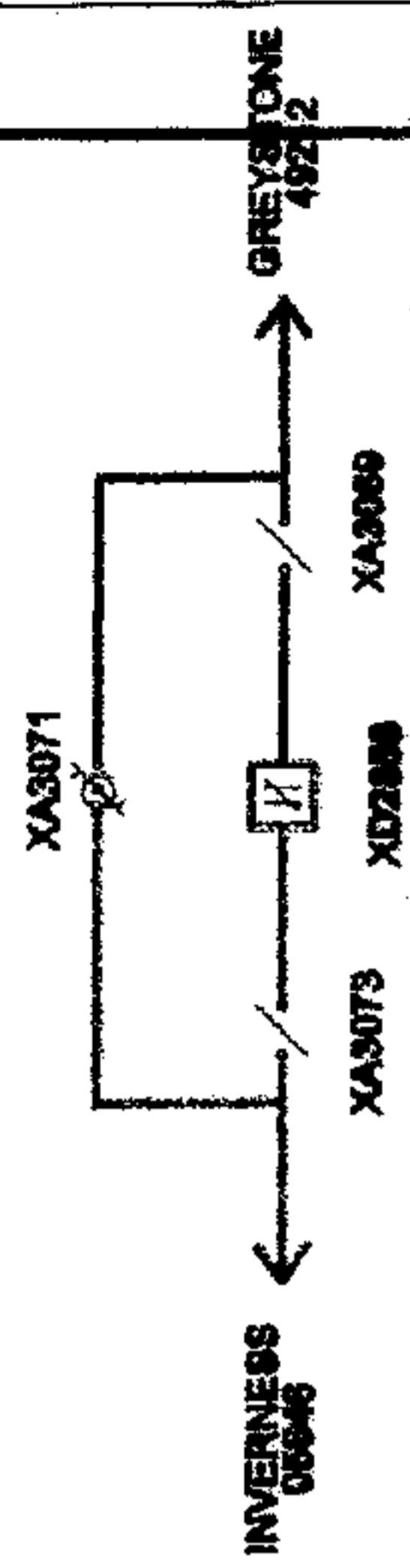

ITEM NO.	DESCRIPTION	QTY	UNIT	PRICE	TOTAL
1	2-3/8" DEE	1	EA		
2	2-ANCHOR, 10" HELIX, 1" ROD	1	EA		
3	3-GUY 3/8" STRAND 18' MIN LEAD	1	EA		
4	3-20" STAND OFFS	1	EA		
5	GUY & ANCHOR	1	EA		
6	55/2 POLE CCA W/44 ENH GRND	1	EA		
7	30 DE	1	EA		
8	30 RISER 384V W/3 JUMPER RING	1	EA		
9	ANCHOR, 10" HELIX, 1" ROD	1	EA		
10	2-GUY 3/8" STRAND 18' MIN LEAD	1	EA		
11	55/2 POLE	1	EA		
12	30 TANG VERT	1	EA		
13	30 RISER	1	EA		
14	55/2 POLE CCA W/GRND	1	EA		
15	30 DE	1	EA		
16	2-ANCHOR, 10" HELIX, 1" ROD	1	EA		
17	3-GUY 3/8" STRAND 18' MIN LEAD	1	EA		
18	3-20" STAND OFFS	1	EA		
19	55/2 POLE CCA W/GRND	1	EA		
20	30 DE	1	EA		
21	3-20" STAND OFFS	1	EA		
22	55/2 POLE CCA W/GRND	1	EA		
23	30 DE	1	EA		
24	2-ANCHOR, 10" HELIX, 1" ROD	1	EA		
25	3-GUY 3/8" STRAND 18' MIN LEAD	1	EA		
26	3-20" STAND OFFS	1	EA		
27	55/2 POLE CCA W/GRND	1	EA		
28	30 DE	1	EA		
29	2-ANCHOR, 10" HELIX, 1" ROD	1	EA		
30	3-GUY 3/8" STRAND 18' MIN LEAD	1	EA		
31	3-20" STAND OFFS	1	EA		
32	55/2 POLE CCA W/GRND	1	EA		
33	30 DE	1	EA		
34	2-ANCHOR, 10" HELIX, 1" ROD	1	EA		
35	3-GUY 3/8" STRAND 18' MIN LEAD	1	EA		
36	3-20" STAND OFFS	1	EA		
37	55/2 POLE CCA W/GRND	1	EA		
38	30 DE	1	EA		
39	2-ANCHOR, 10" HELIX, 1" ROD	1	EA		
40	3-GUY 3/8" STRAND 18' MIN LEAD	1	EA		
41	3-20" STAND OFFS	1	EA		
42	55/2 POLE CCA W/GRND	1	EA		
43	30 DE	1	EA		
44	2-ANCHOR, 10" HELIX, 1" ROD	1	EA		
45	3-GUY 3/8" STRAND 18' MIN LEAD	1	EA		
46	3-20" STAND OFFS	1	EA		
47	55/2 POLE CCA W/GRND	1	EA		
48	30 DE	1	EA		
49	2-ANCHOR, 10" HELIX, 1" ROD	1	EA		
50	3-GUY 3/8" STRAND 18' MIN LEAD	1	EA		
51	3-20" STAND OFFS	1	EA		
52	55/2 POLE CCA W/GRND	1	EA		
53	30 DE	1	EA		
54	2-ANCHOR, 10" HELIX, 1" ROD	1	EA		
55	3-GUY 3/8" STRAND 18' MIN LEAD	1	EA		
56	3-20" STAND OFFS	1	EA		
57	55/2 POLE CCA W/GRND	1	EA		
58	30 DE	1	EA		
59	2-ANCHOR, 10" HELIX, 1" ROD	1	EA		
60	3-GUY 3/8" STRAND 18' MIN LEAD	1	EA		
61	3-20" STAND OFFS	1	EA		
62	55/2 POLE CCA W/GRND	1	EA		
63	30 DE	1	EA		
64	2-ANCHOR, 10" HELIX, 1" ROD	1	EA		
65	3-GUY 3/8" STRAND 18' MIN LEAD	1	EA		
66	3-20" STAND OFFS	1	EA		
67	55/2 POLE CCA W/GRND	1	EA		
68	30 DE	1	EA		
69	2-ANCHOR, 10" HELIX, 1" ROD	1	EA		
70	3-GUY 3/8" STRAND 18' MIN LEAD	1	EA		
71	3-20" STAND OFFS	1	EA		
72	55/2 POLE CCA W/GRND	1	EA		
73	30 DE	1	EA		
74	2-ANCHOR, 10" HELIX, 1" ROD	1	EA		
75	3-GUY 3/8" STRAND 18' MIN LEAD	1	EA		
76	3-20" STAND OFFS	1	EA		
77	55/2 POLE CCA W/GRND	1	EA		
78	30 DE	1	EA		
79	2-ANCHOR, 10" HELIX, 1" ROD	1	EA		
80	3-GUY 3/8" STRAND 18' MIN LEAD	1	EA		
81	3-20" STAND OFFS	1	EA		
82	55/2 POLE CCA W/GRND	1	EA		
83	30 DE	1	EA		
84	2-ANCHOR, 10" HELIX, 1" ROD	1	EA		
85	3-GUY 3/8" STRAND 18' MIN LEAD	1	EA		
86	3-20" STAND OFFS	1	EA		
87	55/2 POLE CCA W/GRND	1	EA		
88	30 DE	1	EA		
89	2-ANCHOR, 10" HELIX, 1" ROD	1	EA		
90	3-GUY 3/8" STRAND 18' MIN LEAD	1	EA		
91	3-20" STAND OFFS	1	EA		
92	55/2 POLE CCA W/GRND	1	EA		
93	30 DE	1	EA		
94	2-ANCHOR, 10" HELIX, 1" ROD	1	EA		
95	3-GUY 3/8" STRAND 18' MIN LEAD	1	EA		
96	3-20" STAND OFFS	1	EA		
97	55/2 POLE CCA W/GRND	1	EA		
98	30 DE	1	EA		
99	2-ANCHOR, 10" HELIX, 1" ROD	1	EA		
100	3-GUY 3/8" STRAND 18' MIN LEAD	1	EA		
101	3-20" STAND OFFS	1	EA		
102	55/2 POLE CCA W/GRND	1	EA		
103	30 DE	1	EA		
104	2-ANCHOR, 10" HELIX, 1" ROD	1	EA		
105	3-GUY 3/8" STRAND 18' MIN LEAD	1	EA		
106	3-20" STAND OFFS	1	EA		
107	55/2 POLE CCA W/GRND	1	EA		
108	30 DE	1	EA		
109	2-ANCHOR, 10" HELIX, 1" ROD	1	EA		
110	3-GUY 3/8" STRAND 18' MIN LEAD	1	EA		
111	3-20" STAND OFFS	1	EA		
112	55/2 POLE CCA W/GRND	1	EA		
113	30 DE	1	EA		
114	2-ANCHOR, 10" HELIX, 1" ROD	1	EA		
115	3-GUY 3/8" STRAND 18' MIN LEAD	1	EA		
116	3-20" STAND OFFS	1	EA		
117	55/2 POLE CCA W/GRND	1	EA		
118	30 DE	1	EA		
119	2-ANCHOR, 10" HELIX, 1" ROD	1	EA		
120	3-GUY 3/8" STRAND 18' MIN LEAD	1	EA		
121	3-20" STAND OFFS	1	EA		
122	55/2 POLE CCA W/GRND	1	EA		
123	30 DE	1	EA		
124	2-ANCHOR, 10" HELIX, 1" ROD	1	EA		
125	3-GUY 3/8" STRAND 18' MIN LEAD	1	EA		
126	3-20" STAND OFFS	1	EA		
127	55/2 POLE CCA W/GRND	1	EA		
128	30 DE	1	EA		
129	2-ANCHOR, 10" HELIX, 1" ROD	1	EA		
130	3-GUY 3/8" STRAND 18' MIN LEAD	1	EA		
131	3-20" STAND OFFS	1	EA		
132	55/2 POLE CCA W/GRND	1	EA		
133	30 DE	1	EA		
134	2-ANCHOR, 10" HELIX, 1" ROD	1	EA		
135	3-GUY 3/8" STRAND 18' MIN LEAD	1	EA		
136	3-20" STAND OFFS	1	EA		
137	55/2 POLE CCA W/GRND	1	EA		
138	30 DE	1	EA		
139	2-ANCHOR, 10" HELIX, 1" ROD	1	EA		
140	3-GUY 3/8" STRAND 18' MIN LEAD	1	EA		
141	3-20" STAND OFFS	1	EA		
142	55/2 POLE CCA W/GRND	1	EA		
143	30 DE	1	EA		
144	2-ANCHOR, 10" HELIX, 1" ROD	1	EA		
145	3-GUY 3/8" STRAND 18' MIN LEAD	1	EA		
146	3-20" STAND OFFS	1	EA		
147	55/2 POLE CCA W/GRND	1	EA		
148	30 DE	1	EA		
149	2-ANCHOR, 10" HELIX, 1" ROD	1	EA		
150	3-GUY 3/8" STRAND 18' MIN LEAD	1	EA		
151	3-20" STAND OFFS	1	EA		
152	55/2 POLE CCA W/GRND	1	EA		
153	30 DE	1	EA		
154	2-ANCHOR, 10" HELIX, 1" ROD	1	EA		
155	3-GUY 3/8" STRAND 18' MIN LEAD	1	EA		
156	3-20" STAND OFFS	1	EA		
157	55/2 POLE CCA W/GRND	1	EA		
158	30 DE	1	EA		
159	2-ANCHOR, 10" HELIX, 1" ROD	1	EA		
160	3-GUY 3/8" STRAND 18' MIN LEAD	1	EA		
161	3-20" STAND OFFS	1	EA		
162	55/2 POLE CCA W/GRND	1	EA		
163	30 DE	1	EA		
164	2-ANCHOR, 10" HELIX, 1" ROD	1	EA		
165	3-GUY 3/8" STRAND 18' MIN LEAD	1	EA		
166	3-20" STAND OFFS	1	EA		
167	55/2 POLE CCA W/GRND	1	EA		
168	30 DE	1	EA		
169	2-ANCHOR, 10" HELIX, 1" ROD	1	EA		
170	3-GUY 3/8" STRAND 18' MIN LEAD	1	EA		
171	3-20" STAND OFFS	1	EA		
172	55/2 POLE CCA W/GRND	1	EA		
173	30 DE	1	EA		
174	2-ANCHOR, 10" HELIX, 1" ROD	1	EA		
175	3-GUY 3/8" STRAND 18' MIN LEAD	1	EA		
176	3-20" STAND OFFS	1	EA		
177	55/2 POLE CCA W/GRND	1	EA		
178	30 DE	1	EA		
179	2-ANCHOR, 10" HELIX, 1" ROD	1	EA		
180	3-GUY 3/8" STRAND 18' MIN LEAD	1	EA		
181	3-20" STAND OFFS	1	EA		
182	55/2 POLE CCA W/GRND	1	EA		
183	30 DE	1	EA		
184	2-ANCHOR, 10" HELIX, 1" ROD	1	EA		
185	3-GUY 3/8" STRAND 18' MIN LEAD	1	EA		
186	3-20" STAND OFFS	1	EA		
187	55/2 POLE CCA W/GRND	1	EA		
188	30 DE	1	EA		
189	2-ANCHOR, 10" HELIX, 1" ROD	1	EA		
190	3-GUY 3/8" STRAND 18' MIN LEAD	1	EA		
191	3-20" STAND OFFS	1	EA		
192	55/2 POLE CCA W/GRND	1	EA		
193	30 DE	1	EA		
194	2-ANCHOR, 10" HELIX, 1" ROD	1	EA		
195	3-GUY 3/8" STRAND 18' MIN LEAD	1	EA		
196	3-20" STAND OFFS	1	EA		
197	55/2 POLE CCA W/GRND	1	EA		
198	30 DE	1	EA		
199	2-ANCHOR, 10" HELIX, 1" ROD	1	EA		
200	3-GUY 3/8" STRAND 18' MIN LEAD	1	EA		
201	3-20" STAND OFFS	1	EA		
202	55/2 POLE CCA W/GRND	1	EA		
203	30 DE	1	EA		
204	2-ANCHOR, 10" HELIX, 1" ROD	1	EA		
205	3-GUY 3/8" STRAND 18' MIN LEAD	1	EA		
206	3-20" STAND OFFS	1	EA		
207	55/2 POLE CCA W/GRND	1	EA		
208	30 DE	1	EA		
209	2-ANCHOR, 10" HELIX, 1" ROD	1	EA		
210	3-GUY 3/8" STRAND 18' MIN LEAD	1	EA		
211	3-20" STAND OFFS	1	EA		
212	55/2 POLE CCA W/GRND	1	EA		
213	30 DE	1	EA		
214	2-ANCHOR, 10" HELIX, 1" ROD	1	EA		
215	3-GUY 3/8" STRAND 18' MIN LEAD	1	EA		
216	3-20" STAND OFFS	1	EA		
217	55/2 POLE CCA W/GRND	1	EA		
218	30 DE	1	EA		
219	2-ANCHOR, 10" HELIX, 1" ROD	1	EA		
220	3-GUY 3/8" STRAND 18' MIN LEAD	1	EA		
221	3-20" STAND OFFS	1	EA		
222	55/2 POLE CCA W/GRND	1	EA		
223	30 DE	1	EA		
224	2-ANCHOR, 10" HELIX, 1" ROD	1	EA		
225	3-GUY 3/8" STRAND 18' MIN LEAD	1	EA		
226	3-20" STAND OFFS	1	EA		
227	55/2 POLE CCA W/GRND	1	EA		
228	30 DE	1	EA		
229	2-ANCHOR, 10" HELIX, 1" ROD	1	EA		
230	3-GUY 3/8" STRAND 18' MIN LEAD	1	EA		
231	3-20" STAND OFFS	1	EA		
232	55/2 POLE CCA W/GRND	1	EA		
233	30 DE	1	EA		
234	2-ANCHOR, 10" HELIX, 1" ROD	1	EA		
235	3-GUY 3/8" STRAND 18' MIN LEAD	1	EA		
236	3-20" STAND OFFS	1	EA		
237	55/2 POLE CCA W/GRND	1	EA		
238	30 DE	1	EA		
239	2-ANCHOR, 10" HELIX, 1" ROD	1	EA		
240	3-GUY 3/8" STRAND 18' MIN LEAD	1	EA		
241	3-20" STAND OFFS	1	EA		
242	55/2 POLE CCA W/GRND	1	EA		
243	30 DE	1	EA		
244	2-ANCHOR, 10" HELIX, 1" ROD	1	EA		
245	3-GUY 3/8" STRAND 18' MIN LEAD	1	EA		
246	3-20" STAND OFFS	1	EA		
247	55/2 POLE CCA W/GRND	1	EA		
248	30 DE	1	EA		
249	2-ANCHOR, 10" HELIX, 1" ROD	1	EA		
250	3-GUY 3/8" STRAND 18' MIN LEAD	1	EA		
251	3-20" STAND OFFS	1	EA		
252	55/2 POLE CCA W/GRND	1	EA		
253	30 DE	1	EA		
254	2-ANCHOR, 10" HELIX, 1" ROD	1	EA		
255	3-GUY 3/8" STRAND 18' MIN LEAD	1	EA		
256	3-20" STAND OFFS	1	EA		
257	55/2 POLE CCA W/GRND	1	EA		
258	30 DE	1	EA		
259	2-ANCHOR, 10" HELIX, 1" ROD	1			