

500

EASEMENT - DISTRIBUTION FACILITIES

STATE OF ALABAMA
COUNTY OF SHELBY
W.E. No. A6170-08-A713
APCO Parcel No. 70256208
Transformer No. S18401
This instrument prepared by: Dean Fritz
Alabama Power Company
P. O. Box 2641
Birmingham, Alabama 35291

20131002000395770 1/4 \$23.50
Shelby Cnty Judge of Probate, AL
10/02/2013 02:39:14 PM FILED/CERT

J Steven Mobley

KNOW ALL MEN BY THESE PRESENTS, That Steven J Mobley, a married man

as grantor(s), (the "Grantor", whether one or more) for and in consideration of One and No/100 Dollar (\$1.00) and other good and valuable consideration paid to Grantor in hand by Alabama Power Company, a corporation, the receipt and sufficiency of which are hereby acknowledged, does hereby grant to Alabama Power Company, its successors and assigns (the "Company"), the easements, rights and privileges below.

Overhead and/or Underground. The right from time to time to construct, install, operate and maintain, upon, over, under and across the Property described below, all poles, towers, wires, conduits, fiber optics, cables, communication lines, translosures, transformers, anchors, guy wires and other facilities useful or necessary in connection therewith (collectively, "Facilities"), for the overhead and/or underground transmission and distribution of electric power and communications, along a route selected by the Company, as generally shown on the Company's drawing attached hereto and made a part hereof, but which is to be determined by the actual location(s) in which the Company's facilities are installed. The width of the Company's easement will depend on whether the Facilities are underground or overhead: for underground, the easement will extend five (5) feet on each side of said Facilities as and where installed; for overhead Facilities, the easement will extend fifteen (15) feet on each side of the centerline of said Facilities as and where installed. The Company is granted the right to clear, and keep clear, all trees, undergrowth and other obstructions on a strip of land extending five (5) feet from each side of said underground Facilities, and to clear, and keep clear, all trees, undergrowth and other obstructions on a strip of land extending fifteen (15) feet from each side of the centerline of said overhead Facilities and the right in the future to install intermediate poles and facilities on said strip. Further, with respect to overhead Facilities, the Company is also granted the right to trim and cut, and keep trimmed and cut, all dead, weak, leaning or dangerous trees or limbs outside of the thirty (30) foot strip that, in the sole opinion of the Company, may now or hereafter endanger, interfere with, or fall upon any of said overhead Facilities.

Grantor hereby grants to the Company all easements, rights and privileges necessary or convenient for the full enjoyment and use thereof, including without limitation the right of ingress and egress to and from said Facilities, as applicable, and the right to excavate for installation, replacement, repair and removal thereof; and also the right to cut, remove and otherwise keep clear any and all structures, obstructions or obstacles of whatever character, on, under and above said Facilities, as applicable.

The easements, rights and privileges granted hereby shall apply to, and the word "Property" as used in this instrument shall mean, the following described real property situated in Shelby County, Alabama (the "Property"): See Exhibit "A" attached hereto and made a part hereof.

In the event it becomes necessary or desirable for the Company from time to time to move any of the Facilities in connection with the construction or improvement of any public road or highway in proximity to the Facilities, Grantor hereby grants to the Company the right to relocate the Facilities and, as to such relocated Facilities, to exercise the rights granted above; provided, however, the Company shall not relocate said Facilities on the Property at a distance greater than ten feet (10') outside the boundary of the right of way of any such public road or highway as established or re-established from time to time. This grant and agreement shall be binding upon and shall inure to the benefit of Grantor, the Company and each of their respective heirs, personal representatives, successors and assigns and the words "Company" and "Grantor" as used in this instrument shall be deemed to include the heirs, personal representatives, successors and assigns of such parties.

TO HAVE AND TO HOLD the same to the Company, its successors and assigns, forever.

IN WITNESS WHEREOF, the undersigned Grantor has executed this instrument on this 16th day of June, 2013.

Linda W. Roberts
Witness Signature
Linda W. Roberts
Print Name

Witness Signature

Print Name

J Steven Mobley
(Grantor)
J. Steven Mobley
Print Name

(Grantor)

Print Name

All facilities on Grantor: X

Shelby County, AL 10/02/2013
State of Alabama
Deed Tax: \$.50

WE # A6170-08-A713
Parcel # 20256208

EXHIBIT "A"

Glen Iris, Phase 1

A Parcel of land situated in the E 1/2 of Section 28, Township 20 South, Range 2 West, Shelby County, Alabama and being more particularly described as follows:

Commence at the SE Corner of the NE 1/4 of Section 28, Township 20 South, Range 2 West; thence N 00°16'16" E along the East line of said 1/4 section a distance of 129.48'; thence N 89°43'44" W a distance of 177.84'; thence S 28°17'37" W a distance of 71.22'; thence S 69°55'17" W a distance of 70.88'; thence S 37°39'37" W a distance of 134.79'; thence S 29°38'28" W a distance of 284.48'; thence S 40°34'33" W a distance of 180.65'; thence S 09°43'46" E a distance of 253.41'; thence S 16°27'22" W a distance of 91.58'; thence S 07°33'39" W a distance of 52.99'; thence S 08°05'08" E a distance of 191.23'; thence S 69°24'32" W a distance of 51.13'; thence N 29°48'30" W a distance of 170.09'; thence N 38°42'58" W a distance of 154.96'; thence N 09°00'26" E a distance of 50.62'; thence N 06°26'32" W a distance of 73.65'; thence N 56°36'01" W a distance of 151.27'; thence N 28°53'34" W a distance of 86.75'; thence N 41°50'23" W a distance of 170.68'; thence N 58°50'42" W a distance of 64.85'; thence N 72°34'37" W a distance of 70.39'; thence S 56°40'34" W a distance of 55.68'; thence N 43°36'16" W a distance of 106.43' to the Point of Beginning; thence continue N 43°36'16" W a distance of 17.76'; thence N 80°25'33" W a distance of 140.67'; thence N 09°26'48" E a distance of 119.94'; thence with a curve turning to the right with a radius of 25.00', a delta angle of 90°07'40", and subtended by a chord which bears N 54°30'37" E, a chord distance of 35.39'; ; thence along said curve an arc distance of 39.33'; ; thence N 09°19'10" E a distance of 50.00'; thence with a curve turning to the right with a radius of 25.00', a delta angle of 89°52'21", and subtended by a chord which bears N 35°29'22" W, a chord distance of 35.32'; ; thence along said curve an arc distance of 39.21'; ; thence N 80°33'06" W a distance of 50.00'; thence S 09°26'48" W a distance of 5.66'; thence N 80°33'12" W a distance of 207.53'; thence N 69°33'11" W a distance of 120.52'; thence N 25°54'15" E a distance of 59.44'; thence N 31°30'20" E a distance of 107.90'; thence N 15°29'06" E a distance of 100.56'; thence N 18°12'52" E a distance of 101.18'; thence N 21°20'59" E a distance of 81.76'; thence N 28°12'12" E a distance of 113.39'; thence N 32°28'05" E a distance of 81.78'; thence N 23°06'49" E a distance of 82.30'; thence N 41°01'10" E a distance of 89.37'; thence N 13°27'29" E a distance of 47.27'; thence S 74°28'05" E a distance of 169.49' to the point of a non tangent curve turning to the left with a radius of 970.00', a delta angle of



20131002000395770 2/4 \$23.50
Shelby Cnty Judge of Probate, AL
10/02/2013 02:39:14 PM FILED/CERT

70250208

00°41'47" and subtended by a chord which bears N 15°11'02" E, a chord distance of 11.79'; thence along said curve an arc distance of 11.79'; thence S 75°09'52" E a distance of 221.30'; thence S 13°32'54" W a distance of 10.70'; thence S 16°35'53" W a distance of 100.01'; thence S 23°41'30" W a distance of 185.51'; thence S 21°22'54" W a distance of 153.44'; thence S 48°27'31" E a distance of 22.33'; thence S 09°50'19" W a distance of 106.55'; thence S 26°48'03" W a distance of 83.82'; thence S 09°27'56" W a distance of 405.90' to the Point of Beginning.



20131002000395770 3/4 \$23.50
Shelby Cnty Judge of Probate, AL
10/02/2013 02:39:14 PM FILED/CERT

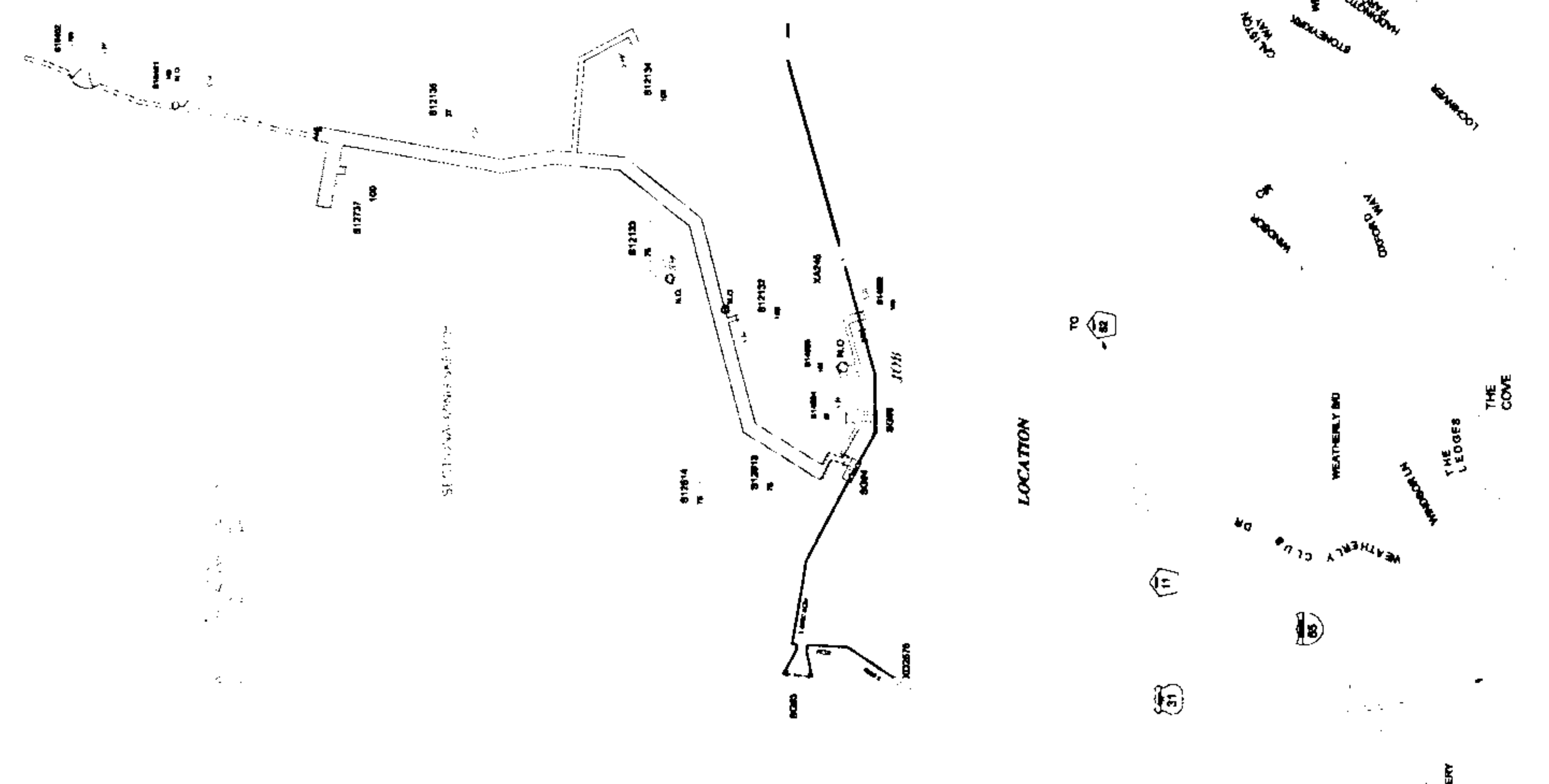
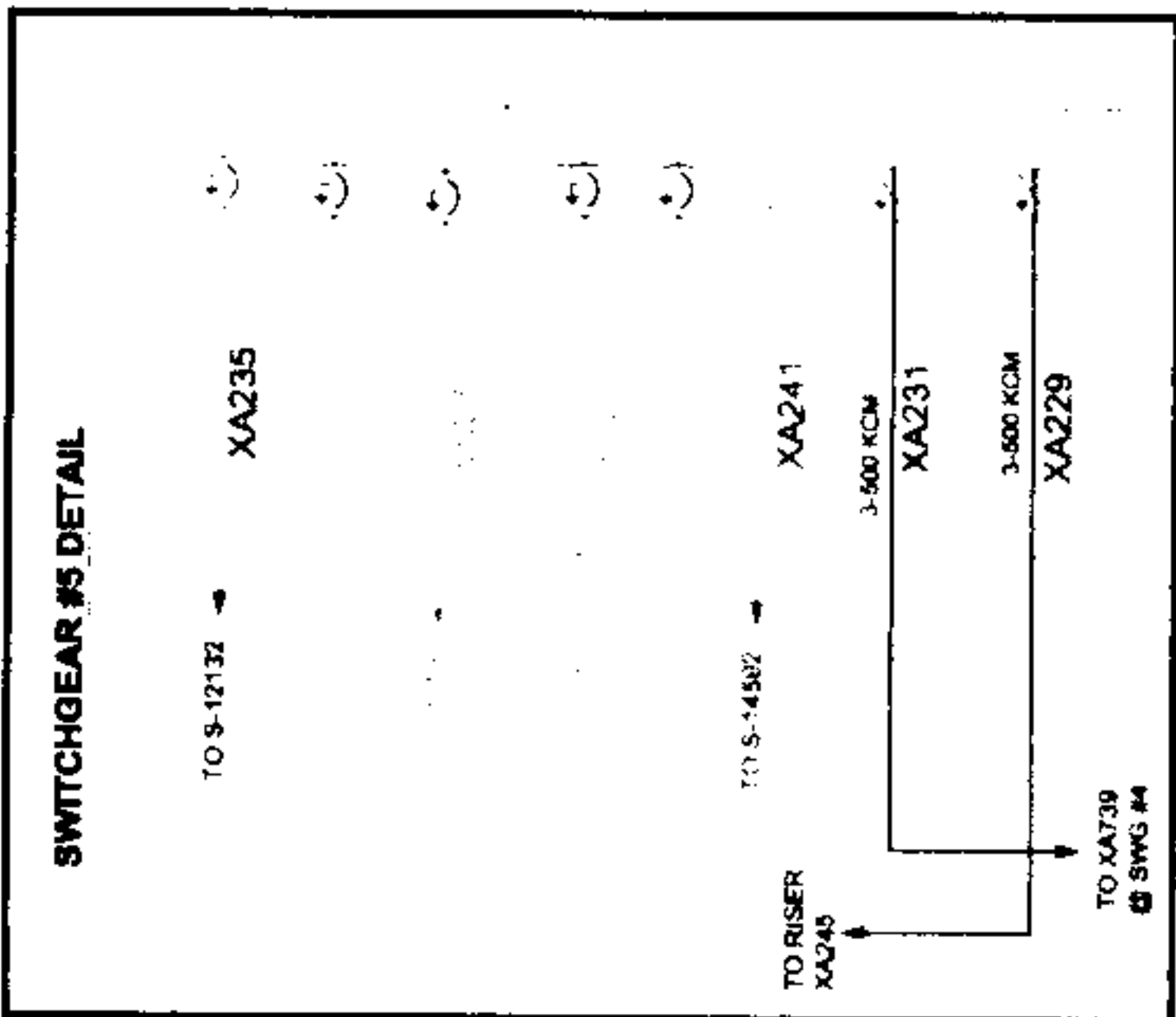
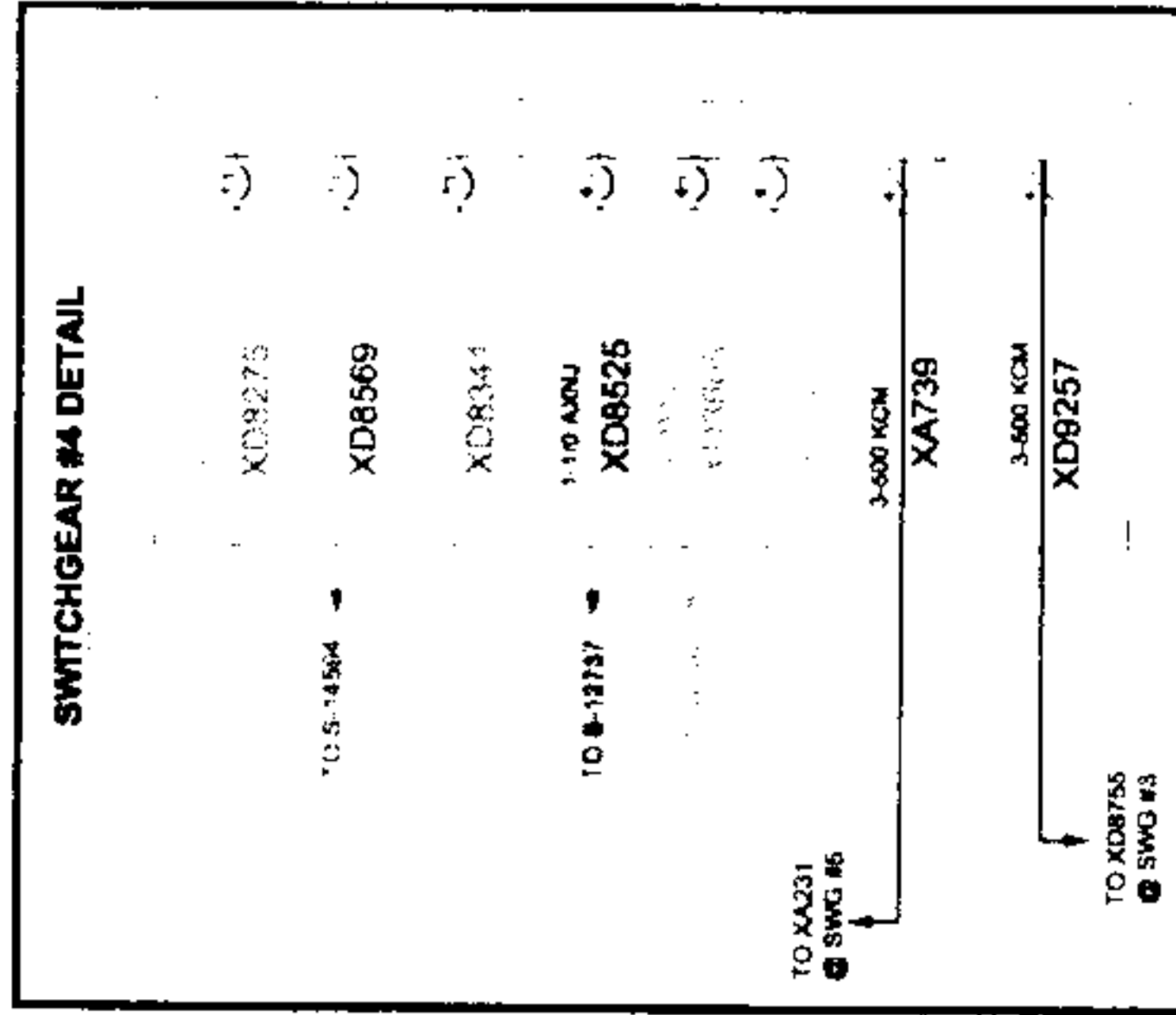
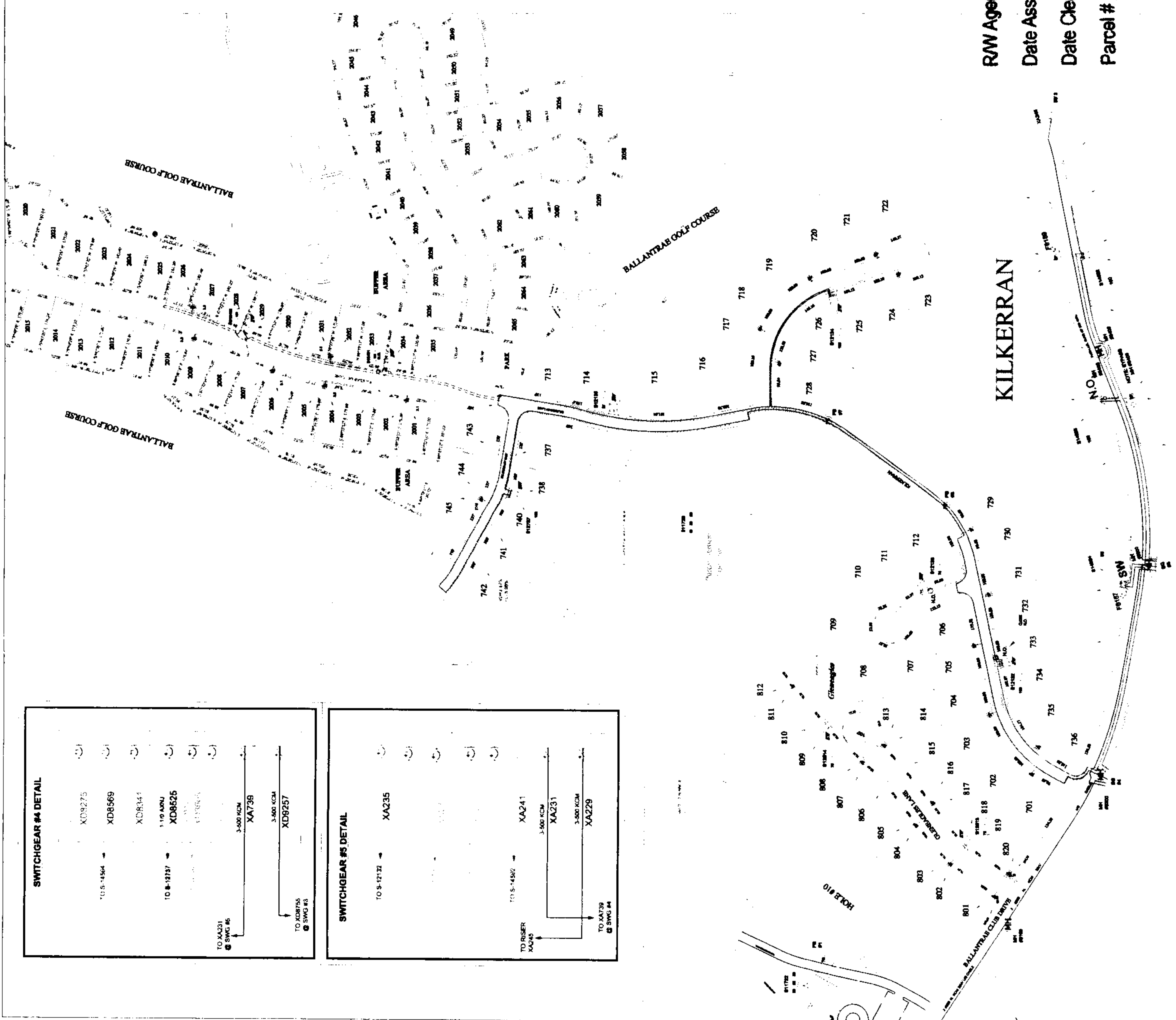
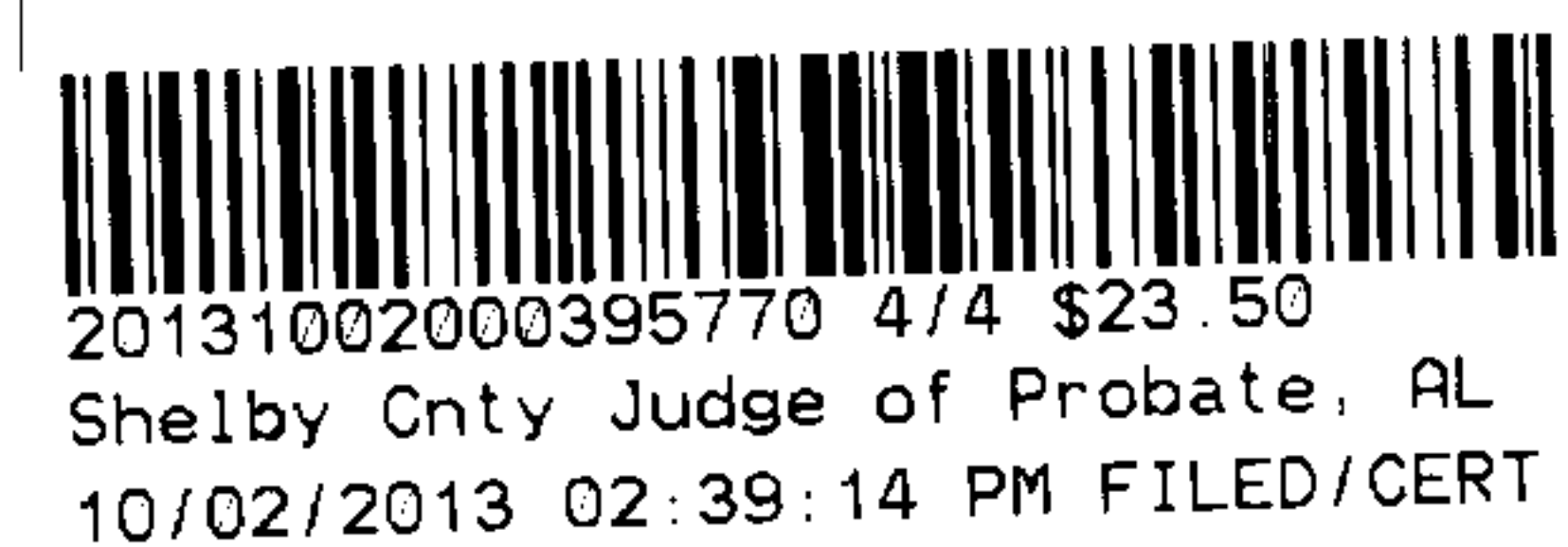

NOTES

1. CUSTOMER TO [REDACTED] UNDERGROUND SERVICE.
2. ALL SECONDARY WIRE IS #250 UTA BURIED 3" BELOW GRADE.
3. ALL SERVICE WIRE IS #10 UTA BURIED 3" BELOW GRADE.
4. PRIMARY CABLE TO BE #10 AVMX 34"V BURIED 42" BELOW GRADE.
5. DEVELOPER TO INSTALL 11.3" SCH 40 CONDUITS.
6. VOLTAGE DROP AND FLICKER CALCULATED BASED ON 3030-4000 SO FT HOMES WITH 5-TON HP ASE.

RAW Agent Dean Fritz
Date Assigned 5-23-13
Date Cleared 6-3-13

UNCLASSIFIED DRAFTING - MAKE NO MANUAL REVISIONS

ALABAMA POWER COMPANY	
POWER DELIVERY, BIRMINGHAM SOUTH	
OFFICE, BALANTINE	
GLENN RIFE	
SCALE 1" = 100'	
PLOT NO. 0400713	
SHEET 1 OF 1 SHEETS	
B = ASSEMBLY	

MAP REF: TN-20-28-4 SEC 28-4, TP. 208, R. 7W

OWNER: NNC FROM: BAYER DATE: 04/04/13

APPROVED: DATE:

APPROVED: DATE:

PLAN SCALE

0 100 200

Shelby Co.