

\$500

Source of Title:
Instrument # 20130311000101390

EASEMENT - DISTRIBUTION FACILITIES

STATE OF ALABAMA
COUNTY OF SHELBY
W.E. No. A6170-08-AB13

APCO Parcel No. 70257024

Transformer No. S80120

This instrument prepared by: Dean Fritz

Alabama Power Company
P. O. Box 2641
Birmingham, Alabama 35291



20131002000395660 1/2 \$17.50
Shelby Cnty Judge of Probate, AL
10/02/2013 02:39:03 PM FILED/CERT

KNOW ALL MEN BY THESE PRESENTS, That Ray D Gibbons and wife, Elizabeth A Gibbons as grantor(s), (the "Grantor", whether one or more) for and in consideration of One and No/100 Dollar (\$1.00) and other good and valuable consideration paid to Grantor in hand by Alabama Power Company, a corporation, the receipt and sufficiency of which are hereby acknowledged, does hereby grant to Alabama Power Company, its successors and assigns (the "Company"), the easements, rights and privileges below.

Overhead and/or Underground. The right from time to time to construct, install, operate and maintain, upon, over, under and across the Property described below, all poles, towers, wires, conduits, fiber optics, cables, communication lines, translosures, transformers, anchors, guy wires and other facilities useful or necessary in connection therewith (collectively, "Facilities"), for the overhead and/or underground transmission and distribution of electric power and communications, along a route selected by the Company, as generally shown on the Company's drawing attached hereto and made a part hereof, but which is to be determined by the actual location(s) in which the Company's facilities are installed. The width of the Company's easement will depend on whether the Facilities are underground or overhead: for underground, the easement will extend five (5) feet on each side of said Facilities as and where installed; for overhead Facilities, the easement will extend fifteen (15) feet on each side of the centerline of said Facilities as and where installed. The Company is granted the right to clear, and keep clear, all trees, undergrowth and other obstructions on a strip of land extending five (5) feet from each side of said underground Facilities, and to clear, and keep clear, all trees, undergrowth and other obstructions on a strip of land extending fifteen (15) feet from each side of the centerline of said overhead Facilities and the right in the future to install intermediate poles and facilities on said strip. Further, with respect to overhead Facilities, the Company is also granted the right to trim and cut, and keep trimmed and cut, all dead, weak, leaning or dangerous trees or limbs outside of the thirty (30) foot strip that, in the sole opinion of the Company, may now or hereafter endanger, interfere with, or fall upon any of said overhead Facilities.

Grantor hereby grants to the Company all easements, rights and privileges necessary or convenient for the full enjoyment and use thereof, including without limitation the right of ingress and egress to and from said Facilities, as applicable, and the right to excavate for installation, replacement, repair and removal thereof; and also the right to cut, remove and otherwise keep clear any and all structures, obstructions or obstacles of whatever character, on, under and above said Facilities, as applicable.

POA The easements, rights and privileges granted hereby shall apply to, and the word "Property" as used in this instrument shall mean, the following described real property situated in Shelby County, Alabama (the "Property"): a parcel of land located in the NW¼ of the SW¼ of Section 25, Township 18 South, Range 1 West, more particularly described in that certain instrument recorded in Instrument # 20130311000101390, in the office of the Judge of Probate of said County.

In the event it becomes necessary or desirable for the Company from time to time to move any of the Facilities in connection with the construction or improvement of any public road or highway in proximity to the Facilities, Grantor hereby grants to the Company the right to relocate the Facilities and, as to such relocated Facilities, to exercise the rights granted above; provided, however, the Company shall not relocate said Facilities on the Property at a distance greater than ten feet (10') outside the boundary of the right of way of any such public road or highway as established or re-established from time to time. This grant and agreement shall be binding upon and shall inure to the benefit of Grantor, the Company and each of their respective heirs, personal representatives, successors and assigns and the words "Company" and "Grantor" as used in this instrument shall be deemed to include the heirs, personal representatives, successors and assigns of such parties.

TO HAVE AND TO HOLD the same to the Company, its successors and assigns, forever.

IN WITNESS WHEREOF, the undersigned Grantor has executed this instrument on this the 23 day of July, 2013.

L. Jane Dillingham
Witness Signature
L. JANE DILLINGHAM
Print Name
L. Jane Dillingham
Witness Signature
L. JANE DILLINGHAM
Print Name

Ray D. Gibbons
(Grantor)
RAY D. GIBBONS
Print Name
Elizabeth A. Gibbons
(Grantor)
Elizabeth A. Gibbons
Print Name

All facilities on Grantor : X

Shelby County, AL 10/02/2013
State of Alabama
Deed Tax: \$.50

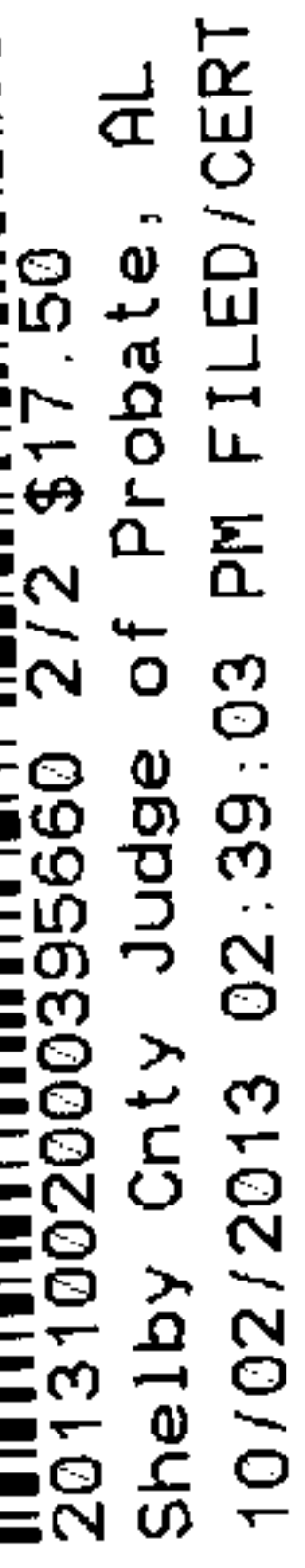

RAW Agent Dean Fritz
Date Assigned 7-11-13
Date Cleared 7-23-13
Parcel # 70257024

SKETCH OF PROPOSED WORK - SIMPLIFIED W.E.

Map Center LatLon: 33.437214 -86.60346

Customer	Location	Cmtd. Svc Date	County	Section	Township	Range	Add'l Info.	Estimate No.
LOUIS COLE	6 CHERRY HILLS DR	9/30/12	Shelby	25	18S	01W		A6170-08-AB13
Division	District	Town	UserID	Created:	Substation	X-	Y-	MISSALL#
BIRMINGHAM	METRO SOUTH	BIRMINGHAM	hbayer	7/11/2013		48116	L6227	

CONTACT: LOUIS COLE
[REDACTED]

ENERGIZED LINE WORK

Sub DOUBLE OAK MTN

OCB/OCR 48116/V5072

Switch# L6227

Fuse Size 60A



	Pri	Sec	Voltage
	7.2	120 240	
Phone Co.			
Cable Co.			
Accessible		Y	
Tree Crew			
Rock Hole			
Permits			
R/W		Y	
CITY			
COUNTY			
STATE			
OTHER			

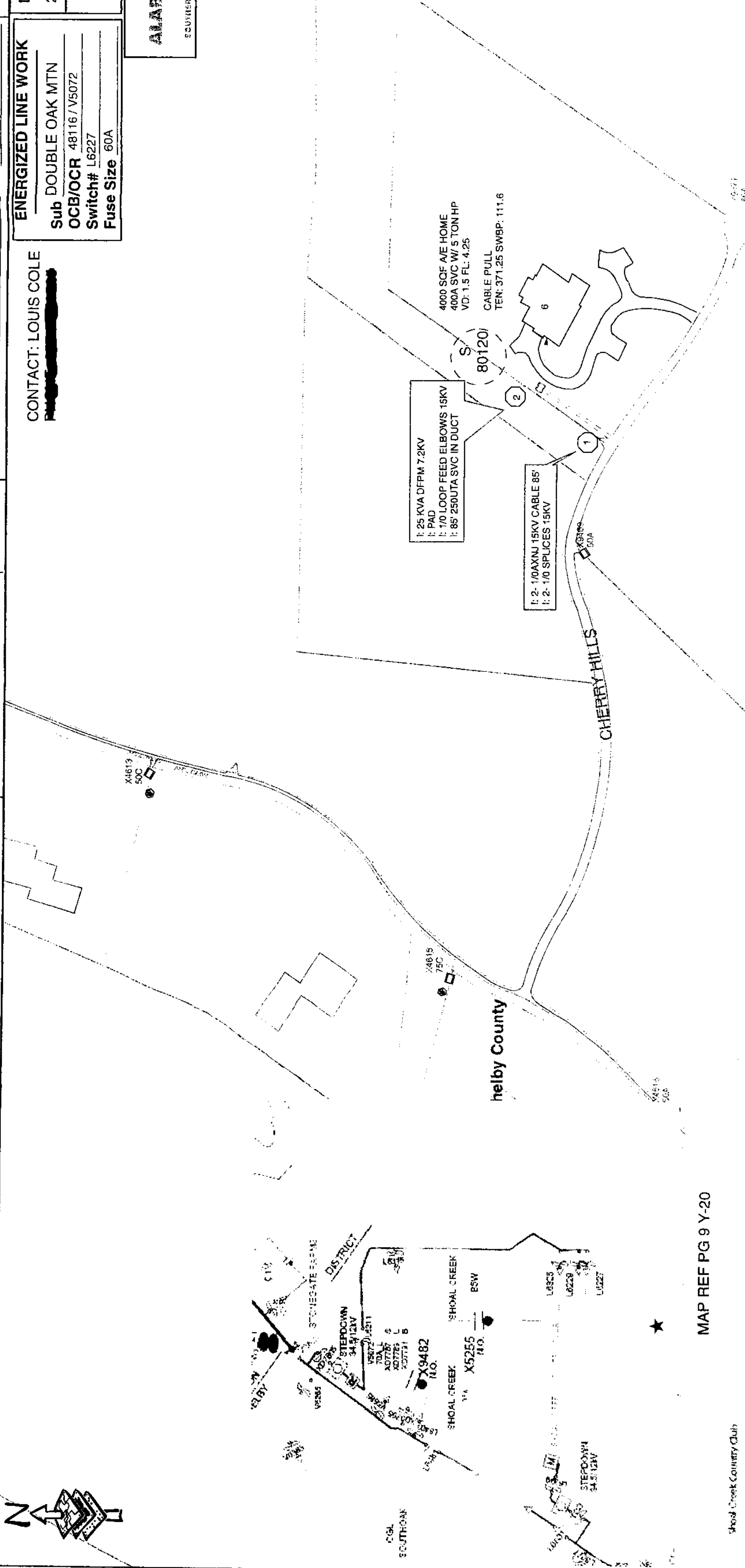

Device No: U0000 Voltage: 12V

ATTENTION: JEP

Equipment Type: 60_04

6 2777	1945
--------	------

LLG: 0 LG-R: 25:

25

MAP REF PG 9 Y-20

★ Cherry Hill

ទំនាក់ទំនង

Deerwood

சென்னை