

Source of Title:
Deed Book 278, Page 195

EASEMENT - DISTRIBUTION FACILITIES

STATE OF ALABAMA

COUNTY OF SHELBY

W.E. No. A6170-05-AJ13

APCO Parcel No. 70254730

Transformer No. S18369

This instrument prepared by: Dean Fritz

Alabama Power Company
P. O. Box 2641
Birmingham, Alabama 35291



20130812000328100 1/3 \$21.00
Shelby Cnty Judge of Probate, AL
08/12/2013 01:37:27 PM FILED/CERT

KNOW ALL MEN BY THESE PRESENTS, That State of Alabama/Shelby County Board of Education

as grantor(s), (the "Grantor", whether one or more) for and in consideration of One and No/100 Dollar (\$1.00) and other good and valuable consideration paid to Grantor in hand by Alabama Power Company, a corporation, the receipt and sufficiency of which are hereby acknowledged, does hereby grant to Alabama Power Company, its successors and assigns (the "Company"), the easements, rights and privileges below.

Overhead and/or Underground. The right from time to time to construct, install, operate and maintain, upon, over, under and across the Property described below, all poles, towers, wires, conduits, fiber optics, cables, communication lines, translosures, transformers, anchors, guy wires and other facilities useful or necessary in connection therewith (collectively, "Facilities"), for the overhead and/or underground transmission and distribution of electric power and communications, along a route selected by the Company, as generally shown on the Company's drawing attached hereto and made a part hereof, but which is to be determined by the actual location(s) in which the Company's facilities are installed. The width of the Company's easement will depend on whether the Facilities are underground or overhead: for underground, the easement will extend five (5) feet on each side of said Facilities as and where installed; for overhead Facilities, the easement will extend fifteen (15) feet on each side of the centerline of said Facilities as and where installed. The Company is granted the right to clear, and keep clear, all trees, undergrowth and other obstructions on a strip of land extending five (5) feet from each side of said underground Facilities, and to clear, and keep clear, all trees, undergrowth and other obstructions on a strip of land extending fifteen (15) feet from each side of the centerline of said overhead Facilities and the right in the future to install intermediate poles and facilities on said strip. Further, with respect to overhead Facilities, the Company is also granted the right to trim and cut, and keep trimmed and cut, all dead, weak, leaning or dangerous trees or limbs outside of the thirty (30) foot strip that, in the sole opinion of the Company, may now or hereafter endanger, interfere with, or fall upon any of said overhead Facilities.

Grantor hereby grants to the Company all easements, rights and privileges necessary or convenient for the full enjoyment and use thereof, including without limitation the right of ingress and egress to and from said Facilities, as applicable, and the right to excavate for installation, replacement, repair and removal thereof; and also the right to cut, remove and otherwise keep clear any and all structures, obstructions or obstacles of whatever character, on, under and above said Facilities, as applicable.

The easements, rights and privileges granted hereby shall apply to, and the word "Property" as used in this instrument shall mean, the following described real property situated in Shelby County, Alabama (the "Property"): a parcel of land located in the SW ¼ of the NE¼ of Section 11, Township 20 South, Range 3 West, more particularly described in that certain instrument recorded in deed book 278, page 195, in the office of the Judge of Probate of said County.

In the event it becomes necessary or desirable for the Company from time to time to move any of the Facilities in connection with the construction or improvement of any public road or highway in proximity to the Facilities, Grantor hereby grants to the Company the right to relocate the Facilities and, as to such relocated Facilities, to exercise the rights granted above; provided, however, the Company shall not relocate said Facilities on the Property at a distance greater than ten feet (10') outside the boundary of the right of way of any such public road or highway as established or re-established from time to time. This grant and agreement shall be binding upon and shall inure to the benefit of Grantor, the Company and each of their respective heirs, personal representatives, successors and assigns and the words "Company" and "Grantor" as used in this instrument shall be deemed to include the heirs, personal representatives, successors and assigns of such parties.

TO HAVE AND TO HOLD the same to the Company, its successors and assigns, forever.

IN WITNESS WHEREOF, the said Grantor, has caused this instrument to be executed by Thomas D. Ferguson

its authorized representative, as of the 25th day of March, 2013.

ATTEST (if required) or WITNESS:

By: _____

Its: _____

State of Alabama/Shelby County Board of Education
(Grantor - Name of Corporation/Partnership/LLC)

By: [Signature] (SEAL)

Its: Deputy Superintendent
[indicate: President, General Partner, Member, etc.]

All facilities on Grantor: X

Station to Station: _____

CORPORATION NOTARY

STATE OF ALABAMA

COUNTY OF Shelby

I, Larry D. Grovitt, a Notary Public, in and for said County in said State, hereby certify that Thomas D. Ferguson, whose name as Deputy Superintendent of State of Alabama / Shelby County Board of Education, a corporation, is signed to the foregoing instrument, and who is known to me, acknowledged before me on this day that, being informed of the contents of this instrument, he/she, as such officer and with full authority, executed the same voluntarily for and as the act of said Corporation.

Given under my hand and official seal, this the 25th day of March, 2013.

[SEAL]

Larry D. Grovitt
Notary Public
My commission expires: 2-5-2014

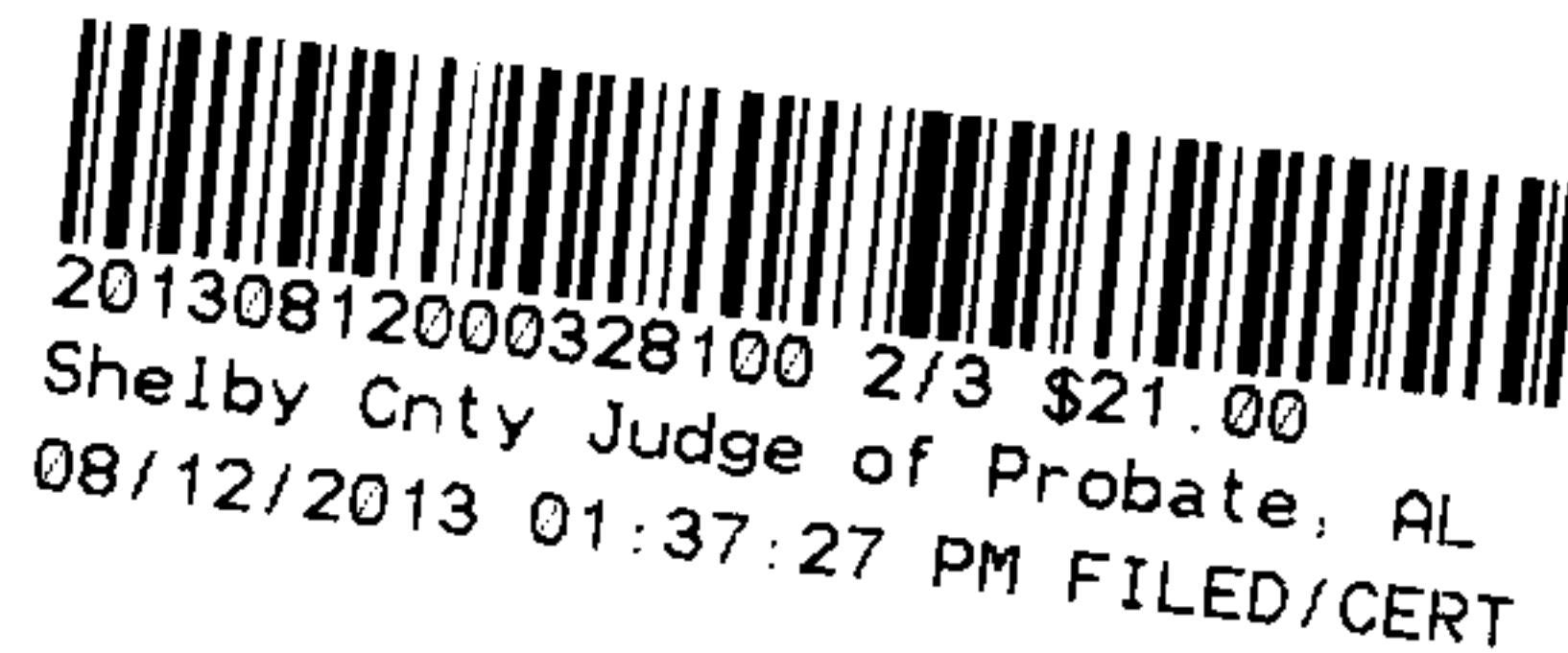

CORPORATION/PARTNERSHIP/LLC NOTARY

STATE OF ALABAMA

COUNTY OF _____

I, _____, a Notary Public in and for said County in said State, hereby certify that _____, whose name as _____ of _____, a _____, [acting in its capacity as _____ of _____] is signed to the foregoing instrument, and who is known to me, acknowledged before me on this day that, being informed of the contents of the instrument, he/she, as such _____ and with full authority, executed the same voluntarily, for and as the act of said _____ [acting in such capacity as aforesaid].

Given under my hand and official seal this the _____ day of _____, 20____.

[SEAL]

Notary Public
My commission expires: _____

SKETCH OF PROPOSED WORK SIMPLIFIED W.E.

Map Center UTM
1694610 12092703

7025 4730

Map Center LatLon
33.311756 -86.82255



Customer PELHAM HIGH SCHOOL			Location 2500 PANTHER CIR			Agreed Serv. Date 12-31-2013			Estimate No. A6170-05AJ13			
Region BHAM/SOUTH			Oper. Cntr. METRO SOUTH		Town/City PELHAM		UserID ermbrash		Created: 3/12/2013			
County Shelby		Section 11	Township 20S	Range 03W	Add'l Info							
Acquisition Agent DEAN FRITZ			Date R/W Assigned 03/12/2013		Date R/W Cleared 3/25/13		Spatial Reference		LOC 1	Transformer Loading 29 KVA		
Voltage 19.9 KV	Phone Co N	CATV Co N	Accessible Y	Tree Crew N	Rock Hole N	Permits	R/W Y	City N	County N	State N	Miss All Y	Other

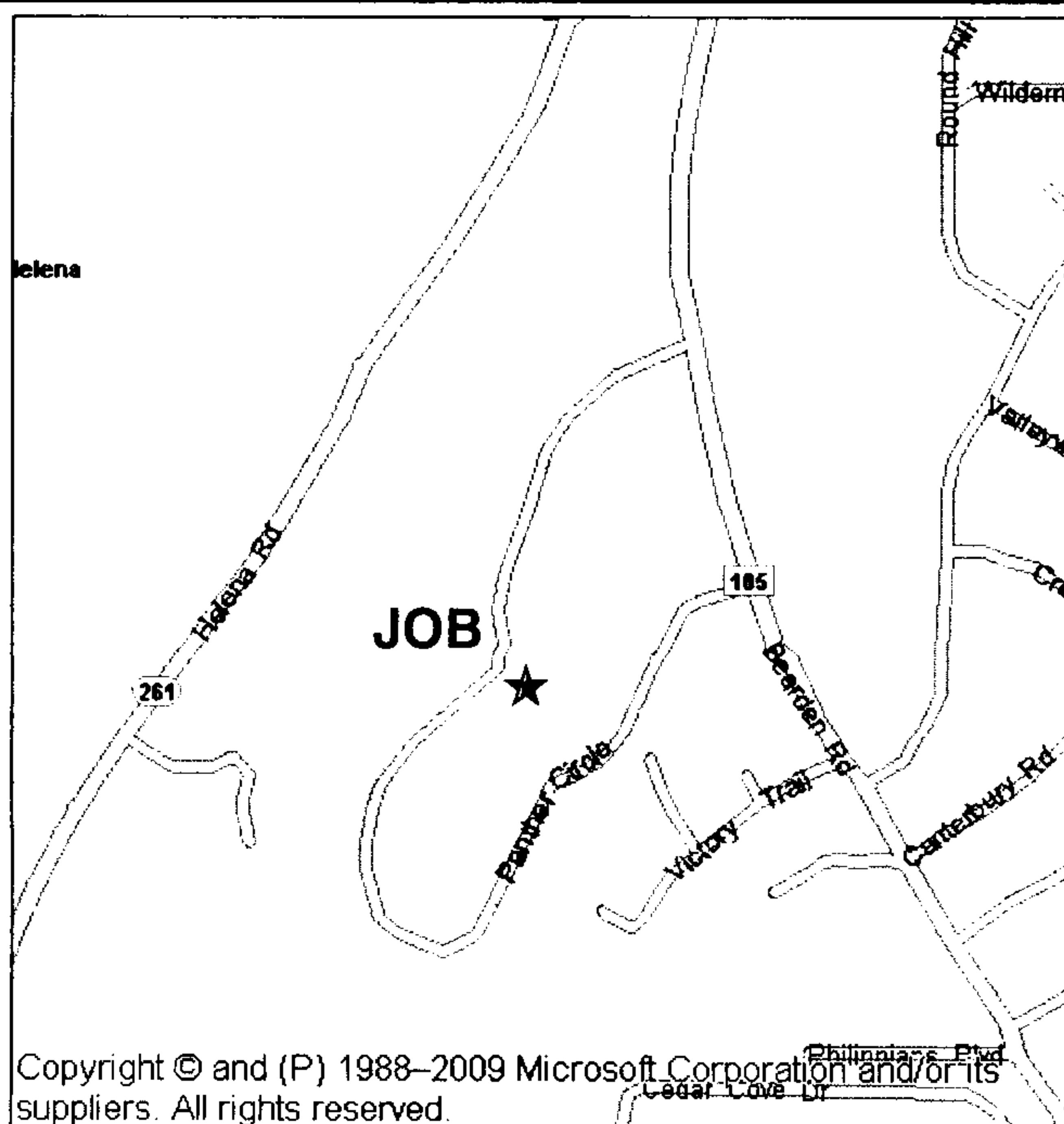

Obtain Hotline Work Permit @
Q6781 50A
V5090 800 AMP VIPER
Substation: VALLEYDALE D.S.
Feeder # 2 Breaker #293316

20130812000328100 3/3 \$21.00
Shelby Cnty Judge of Probate, AL
08/12/2013 01:37:27 PM FILED/CERT

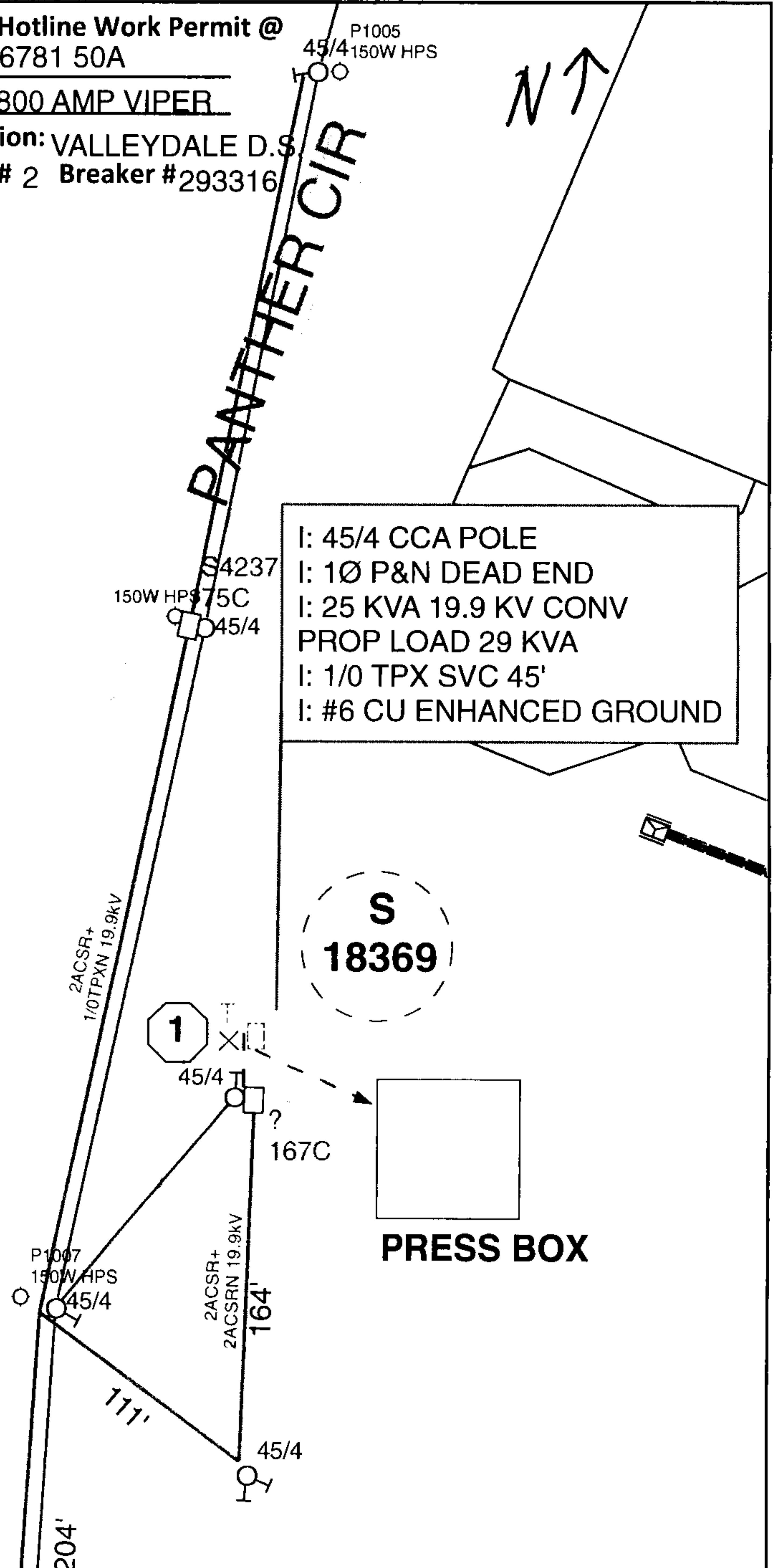
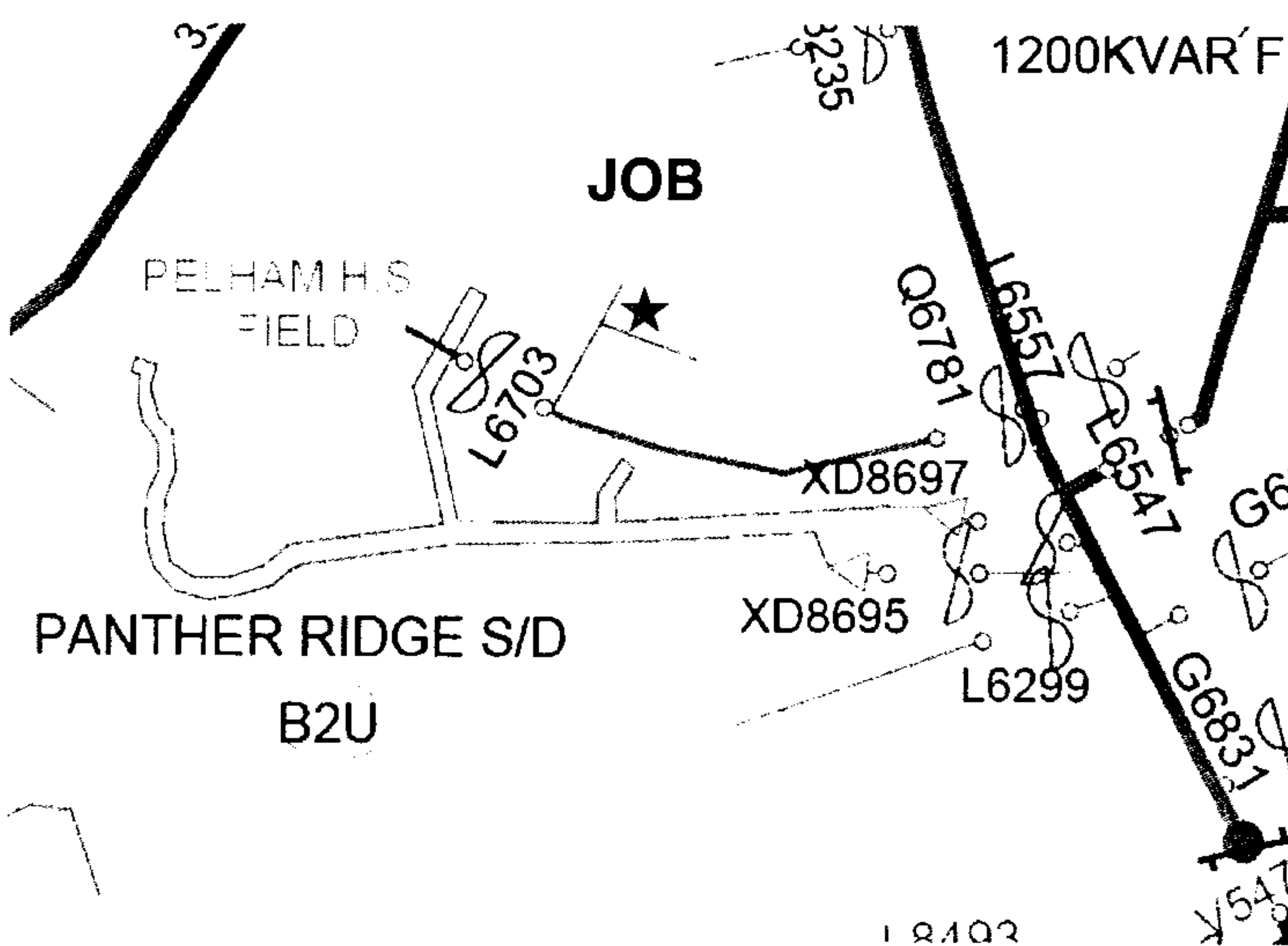

Cnst Completed By:

Date:

Scale: 1 inch = 100 feet