

STATE OF ALABAMA )  
COUNTIES OF JEFFERSON AND SHELBY )

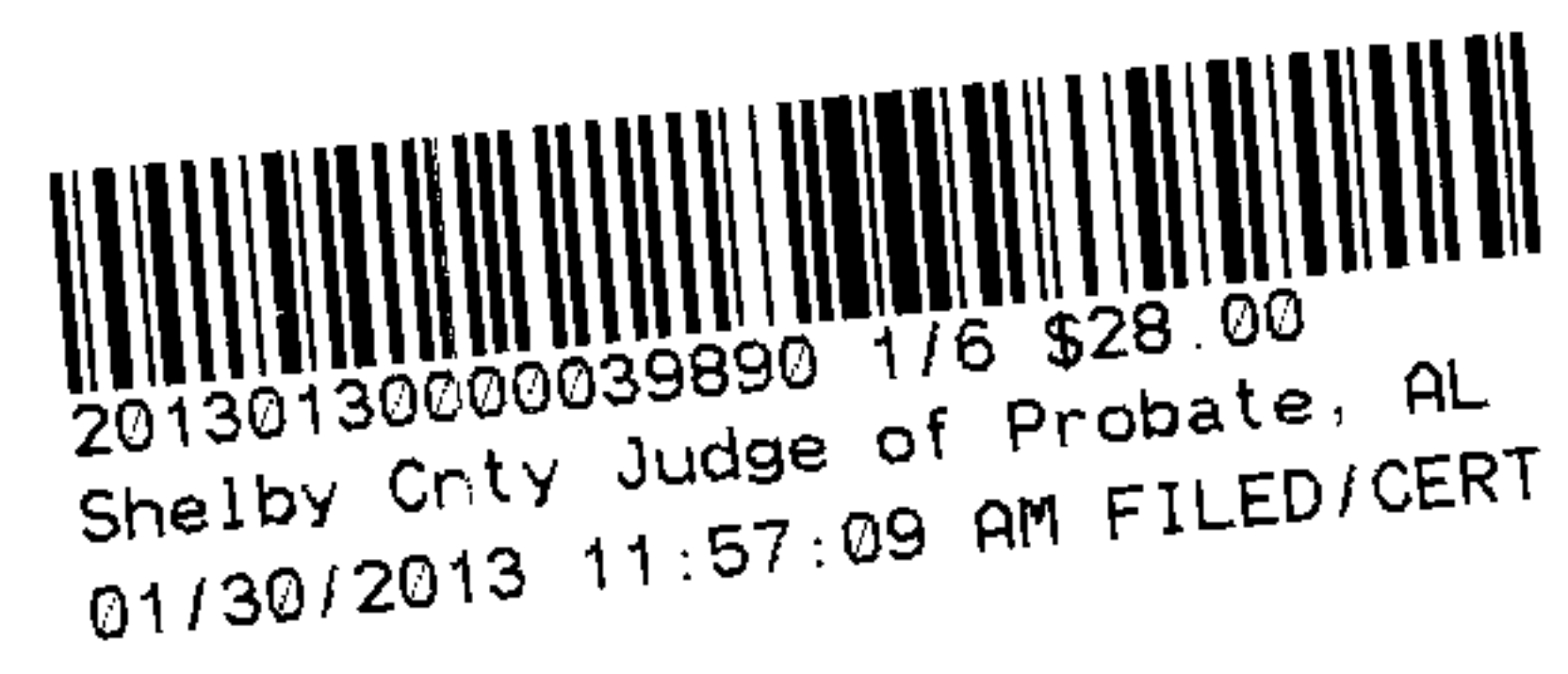

5. To the extent that the Little Cahaba River is deemed to be "navigable waters", any portion of the property lying below the normal high water mark of the Little Cahaba River.

No part of the subject property is the homestead of any Grantor or any Grantor's spouse.

It is the intent of this deed to convey only that portion of property owned by Grantors lying southeasterly of the Little Cahaba River, which property comprises 55 acres, more or less.

**The purpose of this deed is to correct the legal description in the deed previously recorded on 12/28/2012, bearing instrument number 20121228000496420.**

TO HAVE AND TO HOLD to the said Grantee, its successors and assigns, forever.

IN WITNESS WHEREOF, the undersigned Grantors have caused this instrument to be executed on this 16<sup>th</sup> day of January, 2013.

  
\_\_\_\_\_  
Alexander W. Jones, Jr.

  
\_\_\_\_\_  
Jones Investment Company, by  
Alexander W. Jones, Jr.

**ACKNOWLEDGMENT**

STATE OF ALABAMA                    )  
  )  
COUNTY OF JEFFERSON            )

  
20130130000039890 2/6 \$28.00  
Shelby Cnty Judge of Probate, AL  
01/30/2013 11:57:09 AM FILED/CERT

I, the undersigned authority, a Notary Public in and for said County, in said State, hereby certify that, Alexander W. Jones, whose name is signed to the foregoing Warranty Deed, and who is known to me, acknowledged before me on this day, that being informed of the contents of the foregoing conveyance, he, in his capacity, executed the same voluntarily on the day the same bears date.

Given under my hand this the 16<sup>th</sup> day of January, 2013

  
\_\_\_\_\_  
Notary Public

My Commission Expires: 5/15/2013

**THIS INSTRUMENT PREPARED BY:**

Pritchard, McCall & Jones, L.L.C.

505 North 20th Street

800 Financial Center

Birmingham, Alabama 35203

Phone: (205) 328-9190

Fax: (205) 458-0035



20130130000039890 3/6 \$28.00  
Shelby Cnty Judge of Probate, AL  
01/30/2013 11:57:09 AM FILED/CERT

EXHIBIT A

That portion of the following described tract lying southeasterly of the center line of the Little Cahaba River, consisting of 55 acres, more or less:

NE-1/4 of SE-1/4 and all that part of SE-1/4 of SE-1/4 lying East of the Little Cahaba River, all in Section 24, Township 18, Range 2 West. Also 5 acres in the NE corner of NE-1/4 of NE-1/4, Section 25, Township 18, Range 2 West, described as follows: Beginning at the NE corner of said section, thence run in a Southerly direction along the East boundary of said Section 250.34 feet; thence run west parallel with the North boundary of said Section 870 feet; thence North parallel with the East boundary of said Section 250.34 feet to the North boundary of said Section and run thence along said North boundary 870 feet to the point of beginning.

ALSO:

A strip of land situated in the NE ¼ of the NE ¼ of the NE ¼ of the SE ¼ of Section 24, Township 18, Range 2 West, Jefferson County, Alabama lying south of Sicard Hollow Road and north of the center line of the Little Cahaba River, said strip of land being more particularly shown as being the property outlined in red on the attached Exhibit A which is incorporated herein as if set out in full.



20130130000039890 4/6 \$28.00  
Shelby Cnty Judge of Probate, AL  
01/30/2013 11:57:09 AM FILED/CERT





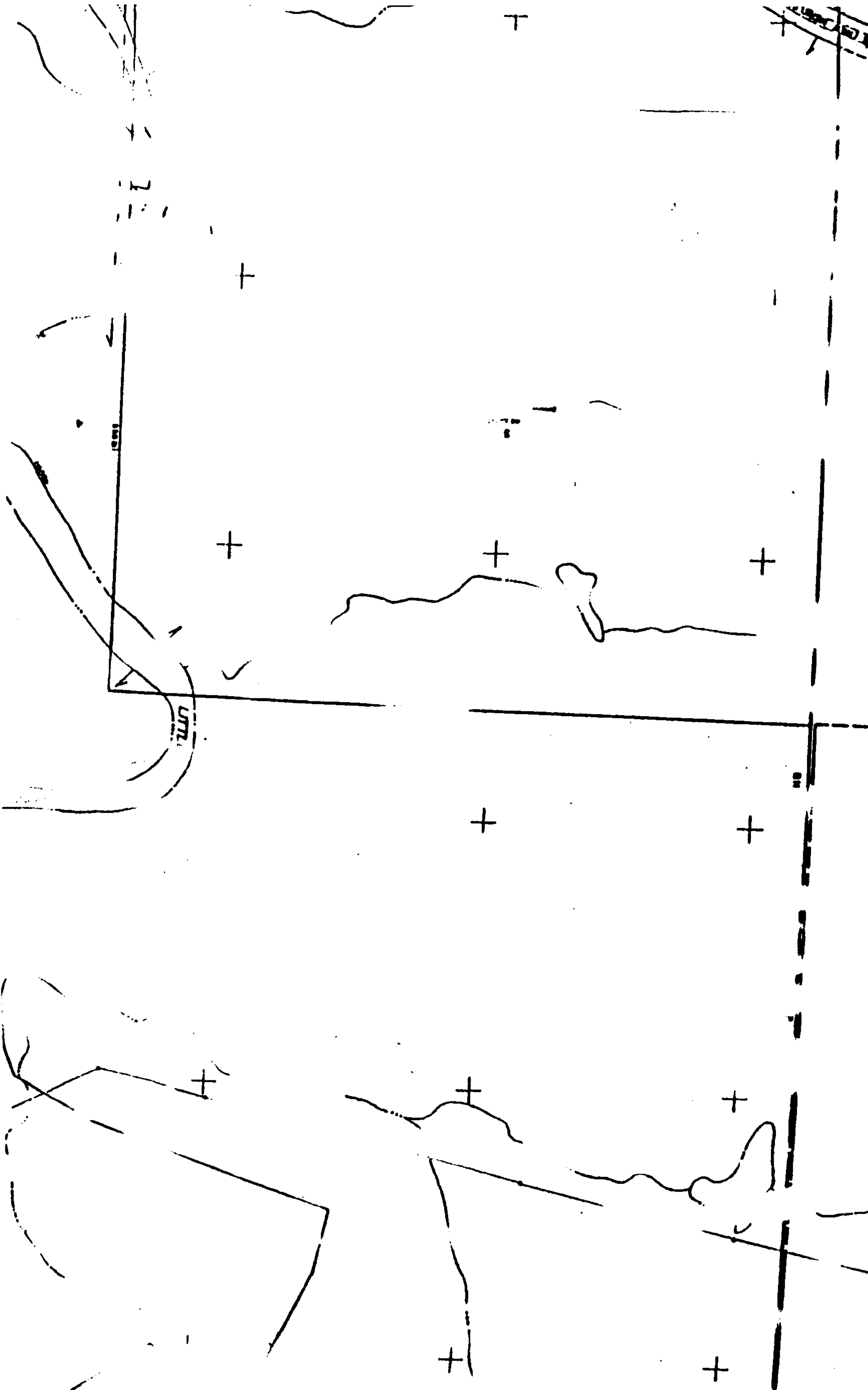

STATE OF ALABAMA - JEFFERSON COUNTY  
I hereby certify that no mortgage tax or deed tax  
has been collected on this instrument.

*Alan J. King* Judge of Probate

"NO TAX COLLECTED"

20130124000070680 6/6  
Bk: LR201310 Pg:18072  
Jefferson County, Alabama  
01/24/2013 02:25:14 PM D  
Fee - \$32.00

Total of Fees and Taxes-\$32.00  
LYNN



20130130000039890 6/6 \$28.00  
Shelby Cnty Judge of Probate, AL  
01/30/2013 11:57:09 AM FILED/CERT