

ORDINANCE NUMBER 788-10A

  
20120305000075990 1/5 \$24.00  
Shelby Cnty Judge of Probate, AL  
03/05/2012 09:43:09 AM FILED/CERT

**AN ORDINANCE TO ALTER, REARRANGE AND EXTEND THE CORPORATE LIMITS OF THE CITY OF HELENA, ALABAMA, SO AS TO EMBRACE AND INCLUDE WITHIN THE CORPORATE AREA OF SAID CITY ALL TERRITORY NOW WITHIN SUCH CORPORATE LIMITS AND ALSO CERTAIN OTHER TERRITORY CONTIGUOUS TO SAID CITY.**

**WHEREAS**, a petition signed by Albert E & Virginia K Willard the owner(s) of all of the land within the territory therein described and proposed to be annexed to the City, together with a map of said territory showing its relationship to the corporate limits of the City, has been filed with the City Clerk of the City of Helena; and

**WHEREAS**, this Council has determined and found that the matters set forth and alleged in said petition are true, and that it is in the public interest that said property be annexed to the City of Helena;

**NOW, THEREFORE, BE IT ORDAINED** by the Council of the City of Helena as follows:

**Section 1.** That said Council and the City of Helena hereby assent to the annexation of said territory to the City of Helena, Alabama, the corporate limits of the City to be extended and rearranged pursuant to the provisions of Chapter 42, Article 2, Code of Alabama 1975 (Sections 11-42-20 through 11-42-23, as amended) so as to embrace and include said territory in addition to the territory already within its present corporate limits, within the corporate area of said City, which said territory is not within the corporate limits of another municipality and the new boundary line does not lie at any point more than half the distance between the old city boundary and the corporate boundary of any municipality. Said territory is described as follows:

**Parcel ID Number 12-6-13-0-000-004.010**

**Description 117 Countryside Lane Bessemer, Alabama 35022**

**Section 2.** That the City Clerk shall file a certified copy of this ordinance containing an accurate description of said annexed territory with the Probate Judge of Shelby County, Alabama, and also cause a copy of this ordinance to be posted in three (3) public places in the City of Helena and this ordinance to be sent to the Justice Department for their approval.

**STATE OF ALABAMA**  
**SHELBY COUNTY**

I, Amanda C. Traywick, City Clerk of the City of Helena, do hereby certify that the above is a true correct copy of **Ordinance Number 788-10A** duly adopted by the Council of the City of Helena at its meeting held 12<sup>th</sup> day of July, 2010, and as same appears of record in the ordinance records of said City, and approved by the Mayor and City Council on 12<sup>th</sup> day of July, 2010.

Given under my hand and corporate seal of the City of Helena, this the 12<sup>th</sup> day of July, 2010.

[SEAL]

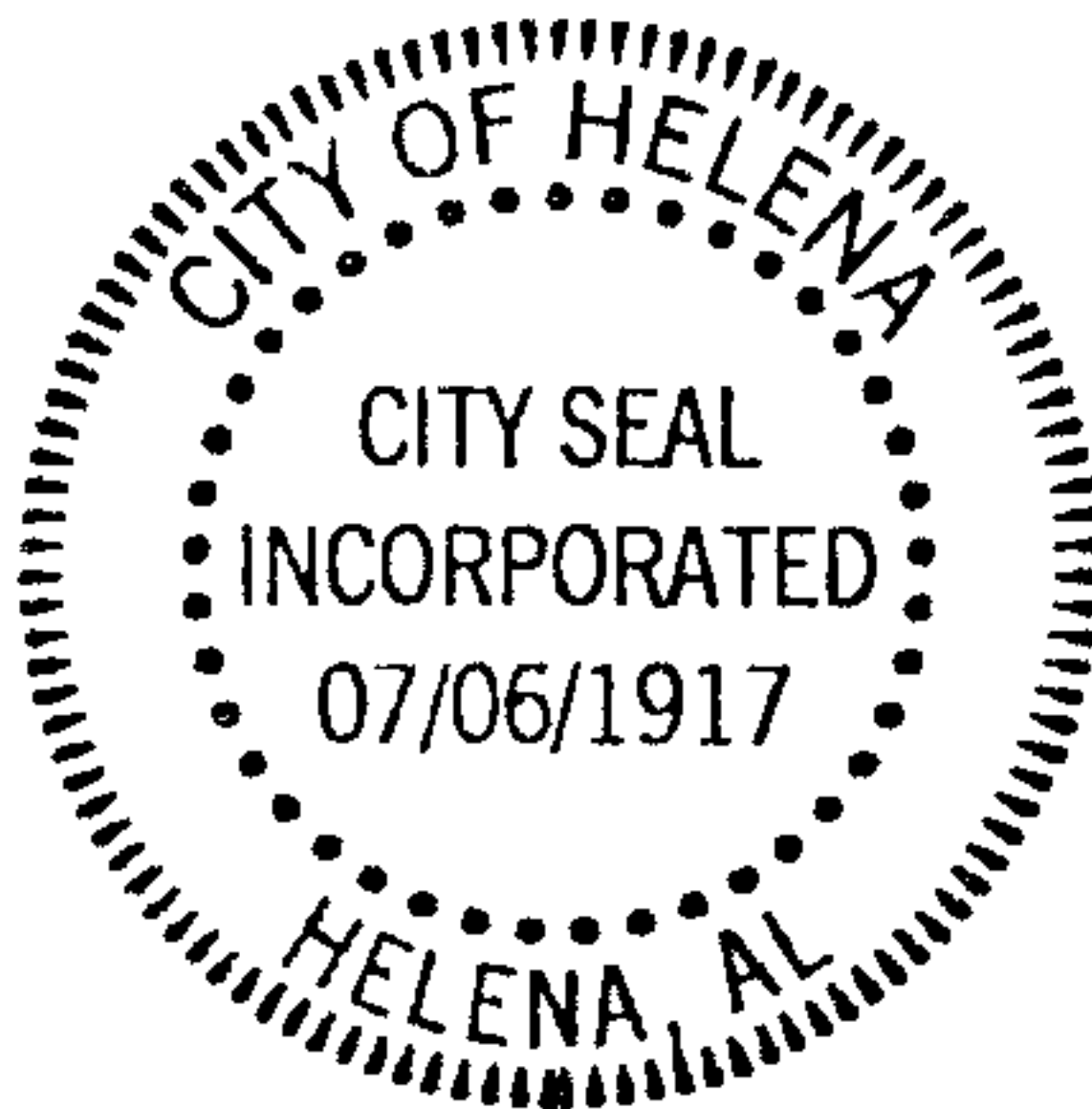

Amanda C. Traywick  
Amanda C. Traywick, City Clerk

20120305000075990 2/5 \$24.00  
Shelby Cnty Judge of Probate, AL  
03/05/2012 09:43:09 AM FILED/CERT

**CERTIFICATION**

I, Amanda C. Traywick, the duly appointed and acting Clerk of the City of Helena, Alabama, do hereby certify that the within Ordinance Number **788-10A** is a true copy as recited in the said City Clerk's Minute Book and posted by me as provided by law in three public places in said City, being on the bulletin board of the City Hall, in the BP Coosa Mart in the City of Helena, and in the Helena Public Library in said City, that said Ordinance shall become a duly lawful Ordinance of said City on the 19th day of July, 2010, five or more days after the posting of the same as provided by law.

July IN WITNESS WHEREOF, I have hereunto set my hand and seal on this the 19th day of July, 2010.

[SEAL]



Amanda C. Traywick  
Amanda C. Traywick, City Clerk



20120305000075990 3/5 \$24.00  
Shelby Cnty Judge of Probate, AL  
03/05/2012 09:43:09 AM FILED/CERT

PETITION

We, Albert E. & Virginia K. Willard the undersigned property owner, being owners of all of the land within the territory described as follows:  
Parcel 126130 00004.010

do hereby petition the City of Helena, County of Shelby, Alabama, to annex the above described property into the city limits of the City of Helena. Attached hereto as Exhibit 'A' and made part and parcel hereof as fully as if set out herein, is a map of said property which we own, showing its relationship to the corporate limits of the City of Helena, Alabama, which said map is herewith filed with the City Clerk of the City of Helena, Alabama.

Dated this 6<sup>th</sup> day of July, 20 10.

Parcel # & Address

Name & Phone

126130000004.010  
117 Countryside Lane  
Bessemer, AL 35022

Albert E Willard  
Virginia K. Willard

Albert E. Willard  
Virginia K. Willard

How many people live on the parcel of land, how many are of voting age, how many are not of voting age and the race of each person.

Two People  
Two Voting Age  
2 Caucasian

Reason for annexation

City Services

  
 20120305000075990 4/5 \$24.00  
 Shelby Cnty Judge of Probate, AL  
 03/05/2012 09:43:09 AM FILED/CERT



788-10A

## Property Information - 12 6 13 0 000 004.010

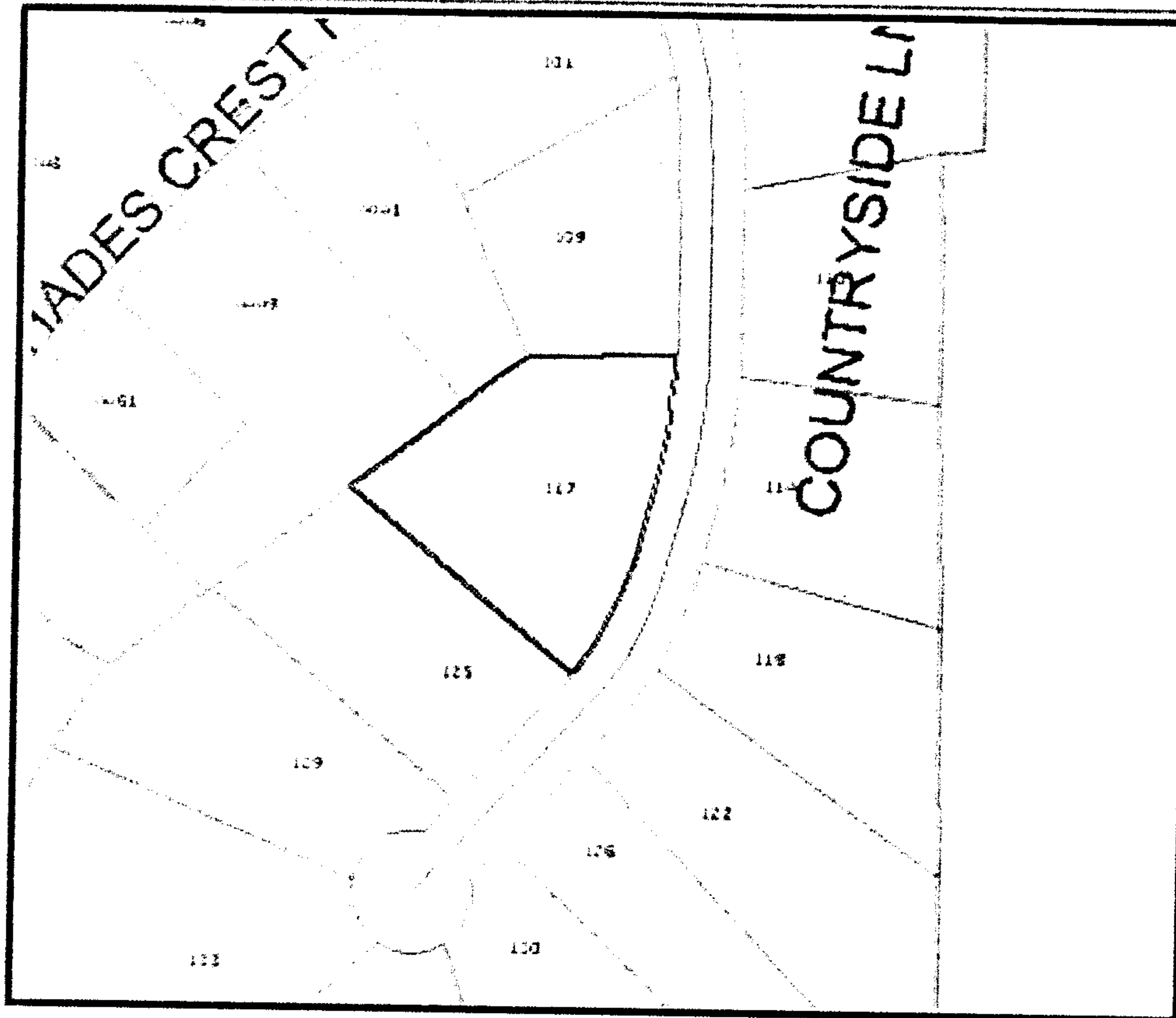

## Owner Information

Name 1	Name2	Address 1	Address 2	City	State	Zip Code
WILLARD ALBERT E & VIRGINIA K		117 COUNTRYSIDE LANE		BESSEMER	AL	35023
Subdivision	Primary Lot	Secondary Lot	Block	Section	Township	Range
COUNTRYSIDE	11		000	13	20S	04W
Map Book	Map Page	Lot Dimension 1	Lot Dimension 2	Number of Acres	Square Feet	
7	19	300.87	266.32999999999998	0	0	

Description

## Document Information

Recorded Date	Recorded Number
19921030	19920003163100000

20120305000075990 5/5 \$24.00  
Shelby Cnty Judge of Probate, AL  
03/05/2012 09:43:09 AM FILED/CERT