

ORDINANCE NUMBER 804-11A

  
20120305000075860 1/5 \$24.00  
Shelby Cnty Judge of Probate, AL  
03/05/2012 09:42:56 AM FILED/CERT

**AN ORDINANCE TO ALTER, REARRANGE AND EXTEND THE CORPORATE LIMITS OF THE CITY OF HELENA, ALABAMA, SO AS TO EMBRACE AND INCLUDE WITHIN THE CORPORATE AREA OF SAID CITY ALL TERRITORY NOW WITHIN SUCH CORPORATE LIMITS AND ALSO CERTAIN OTHER TERRITORY CONTIGUOUS TO SAID CITY.**

**WHEREAS**, a petition signed by Fred A & Theresa Guarino the owner(s) of all of the land within the territory therein described and proposed to be annexed to the City, together with a map of said territory showing its relationship to the corporate limits of the City, has been filed with the City Clerk of the City of Helena; and

**WHEREAS**, this Council has determined and found that the matters set forth and alleged in said petition are true, and that it is in the public interest that said property be annexed to the City of Helena;

**NOW, THEREFORE, BE IT ORDAINED** by the Council of the City of Helena as follows:

**Section 1.** That said Council and the City of Helena hereby assent to the annexation of said territory to the City of Helena, Alabama, the corporate limits of the City to be extended and rearranged pursuant to the provisions of Chapter 42, Article 2, Code of Alabama 1975 (Sections 11-42-20 through 11-42-23, as amended) so as to embrace and include said territory in addition to the territory already within its present corporate limits, within the corporate area of said City, which said territory is not within the corporate limits of another municipality and the new boundary line does not lie at any point more than half the distance between the old city boundary and the corporate boundary of any municipality. Said territory is described as follows:

4468 South Shades Crest Road  
Helena, Alabama 35080  
Parcel ID Number 12 6 13 0 000 003.001  
Description

**Section 2.** That the City Clerk shall file a certified copy of this ordinance containing an accurate description of said annexed territory with the Probate Judge of Shelby County, Alabama, and also cause a copy of this ordinance to be posted in three (3) public places in the City of Helena and this ordinance to be sent to the Justice Department for their approval.

## CERTIFICATION

I, Amanda C. Traywick, the duly appointed and acting Clerk of the City of Helena, Alabama, do hereby certify that the within Ordinance Number **804-11** is a true copy as recited in the said City Clerk's Minute Book and posted by me as provided by law in three public places in said City, being on the bulletin board of the City Hall, in the BP Coosa Mart in the City of Helena, and in the Helena Public Library in said City, that said Ordinance shall become a duly lawful Ordinance of said City on the 24th day of JANUARY, 2011, five or more days after the posting of the same as provided by law.

IN WITNESS WHEREOF, I have hereunto set my hand and seal on this the 24th day of JANUARY, 2011.

[SEAL]

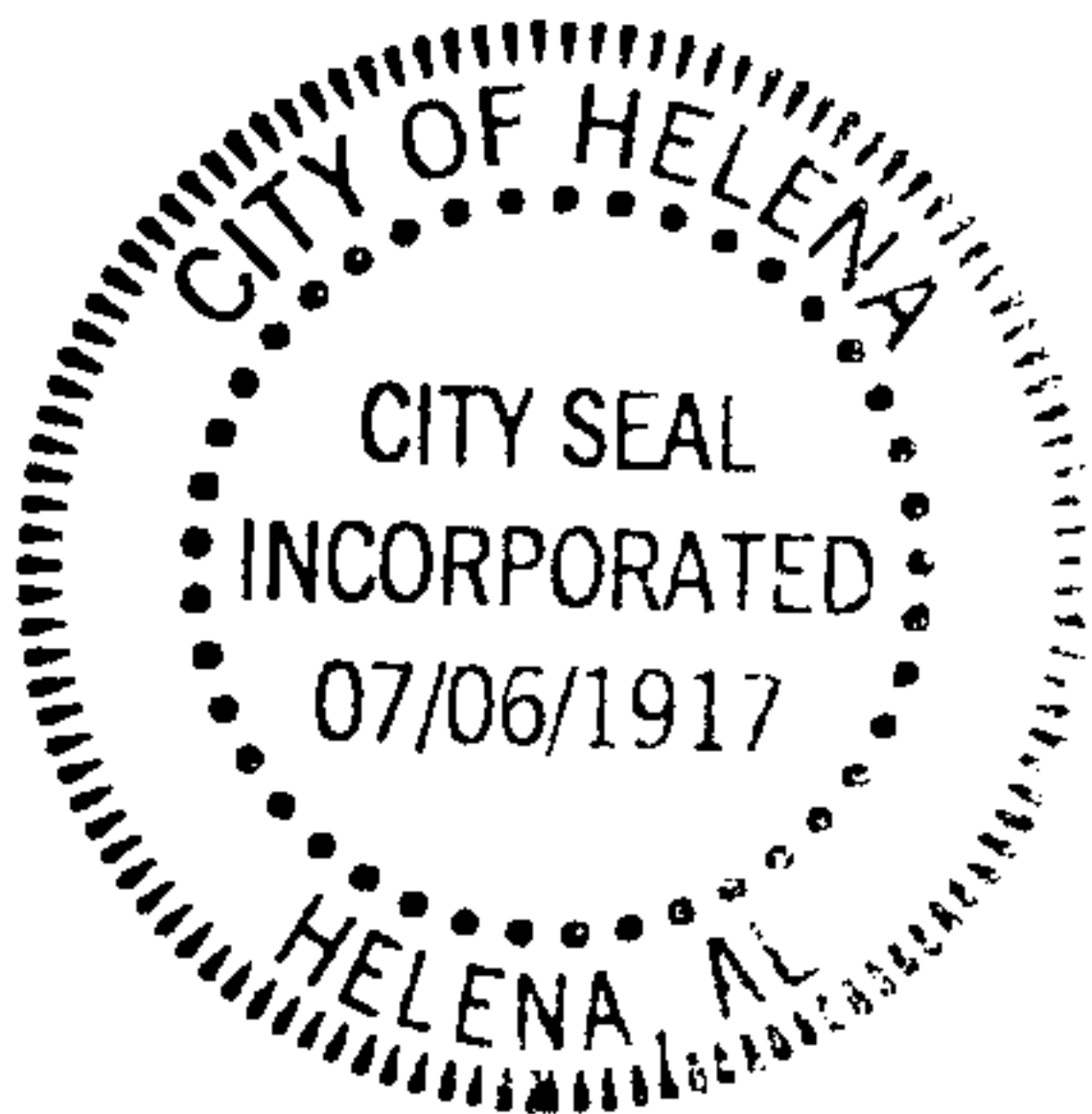

Amanda C Traywick  
Amanda C. Traywick, City Clerk



20120305000075860 2/5 \$24.00  
Shelby Cnty Judge of Probate, AL  
03/05/2012 09:42:56 AM FILED/CERT

**STATE OF ALABAMA**  
**SHELBY COUNTY**

I, Amanda C. Traywick, City Clerk of the City of Helena, do hereby certify that the above is a true correct copy of **Ordinance Number 804-11** duly adopted by the Council of the City of Helena at its meeting held 24<sup>th</sup> day of JANUARY, 2011, and as same appears of record in the ordinance records of said City, and approved by the Mayor and City Council on 24<sup>th</sup> day of JANUARY, 2011.

Given under my hand and corporate seal of the City of Helena, this the 24<sup>th</sup> day of JANUARY, 2011.

[SEAL]



Amanda C Traywick  
Amanda C. Traywick, City Clerk

  
20120305000075860 3/5 \$24.00  
Shelby Cnty Judge of Probate, AL  
03/05/2012 09:42:56 AM FILED/CERT



804-11A

## PETITION FOR ANNEXATION

To the Mayor and members of the City Council of the City of Helena, a municipal corporation of the State of Alabama:

The petition of the undersigned owners of real property hereinafter more particularly described, do hereby present this Petition for Annexation of the said real property into the corporate limits of the City of Helena, Alabama and respectfully represent as follows:

That they are the owners, or owners representative, of the real property in the Territory, lying contiguous to the present corporate limits of City of Helena, Alabama. This petition is accompanied by and has attached hereto as Exhibit "A", a diagram that outlines the geographic boundaries of the property sought to be annexed as depicted on a Shelby County Assessor's parcel map.

Dated this 1<sup>st</sup> day of November, 2010.

Printed Name	Signature	Parcel ID	Telephone
<u>Fred A. Guarino</u>	<u>[Signature]</u>	<u>126130000003.001</u>	
<u>Theresa D. Guarino</u>	<u>[Signature]</u>	<u>126130000003.001</u>	

How many people live on each parcel of land?

4

How many are of voting age?

4

What is the race of each person?

W

What is the reason for annexation?

All services offered

Name of current waterworks.

BWWB

Name of current garbage service.

Veolia

Name of sewer service.

Septic System



20120305000075860 4/5 \$24.00  
Shelby Cnty Judge of Probate, AL  
03/05/2012 09:42:56 AM FILED/CERT

804-11A

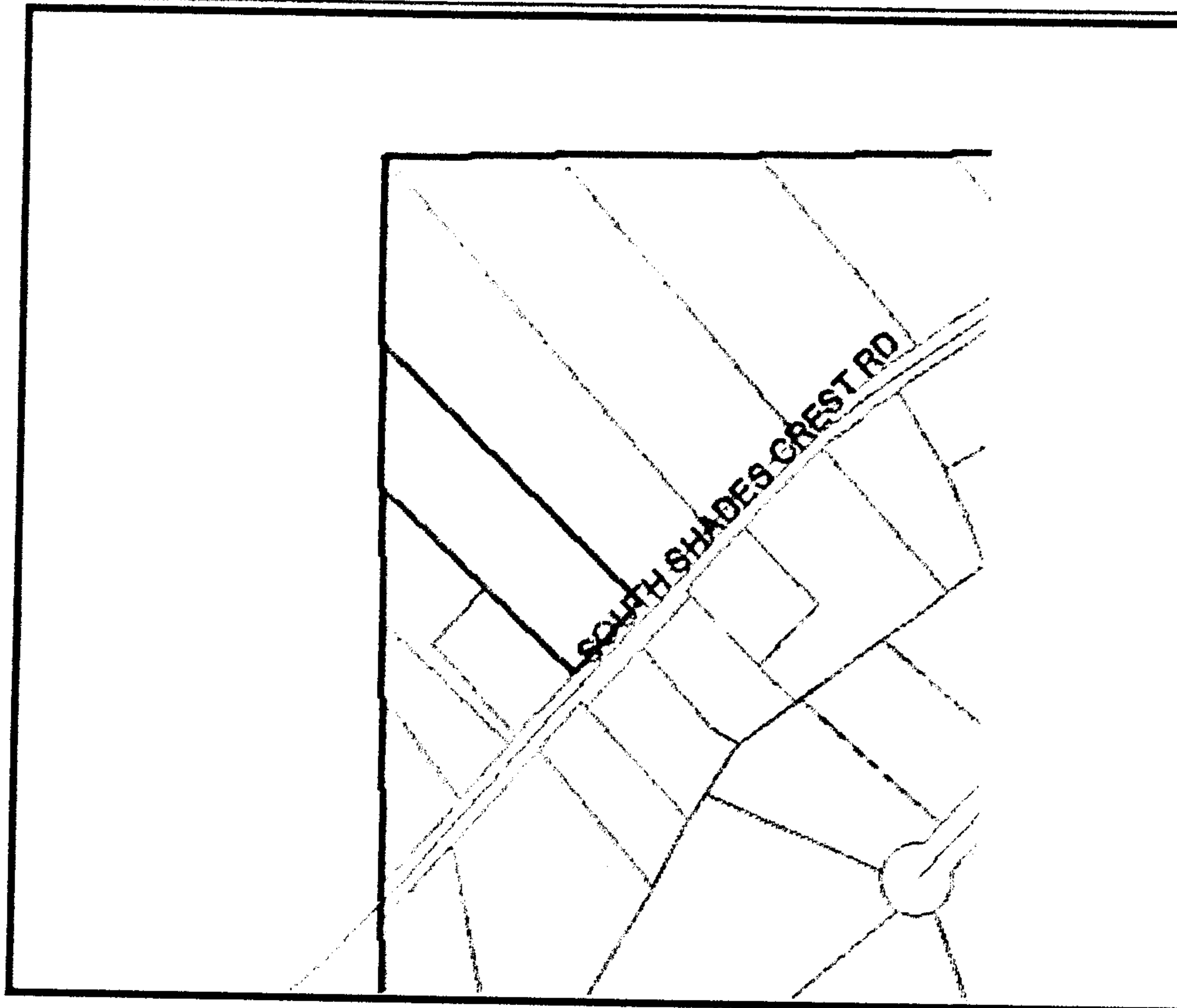
**Property Information - 12 6 13 0 000 003.001****Owner Information**

Name 1	Name2	Address 1	Address 2	City	State	Zip Code
GUARINO FRED A & THERESA		4468 SHADES CREST RD S		BESSEMER	AL	35023

Subdivision	Primary Lot	Secondary Lot	Block	Section	Township	Range
			000	13	20S	04W

Map Book	Map Page	Lot Dimension 1	Lot Dimension 2	Number of Acres	Square Feet
0	0	149.93000000000001	596.14999999999998	0	0

**Description**

COM NW SCOR SEC13 TH S227.13 TO BEG TH CONT S212.94 TH SE448.60 TO N ROW SHAD  
ES CREST RD TH NE ON ROW 149.93 NW596.15 TO POB

**Document Information****Recorded Date****Recorded Number**

20120305000075860 5/5 \$24.00  
Shelby Cnty Judge of Probate, AL  
03/05/2012 09:42:56 AM FILED/CERT