

STATE OF ALABAMA  
SHELBY COUNTY

I HEREBY STATE THAT ALL PARTS OF THIS SURVEY AND DRAWING HAVE BEEN COMPLETED IN ACCORDANCE WITH THE CURRENT REQUIREMENTS OF THE STANDARDS OF PRACTICE FOR SURVEYING IN THE STATE OF ALABAMA, TO THE BEST OF MY KNOWLEDGE, INFORMATION AND BELIEF.

S. M. ALLEN PLS NO 12944  
11-22-11  
DATED

DESCRIPTION

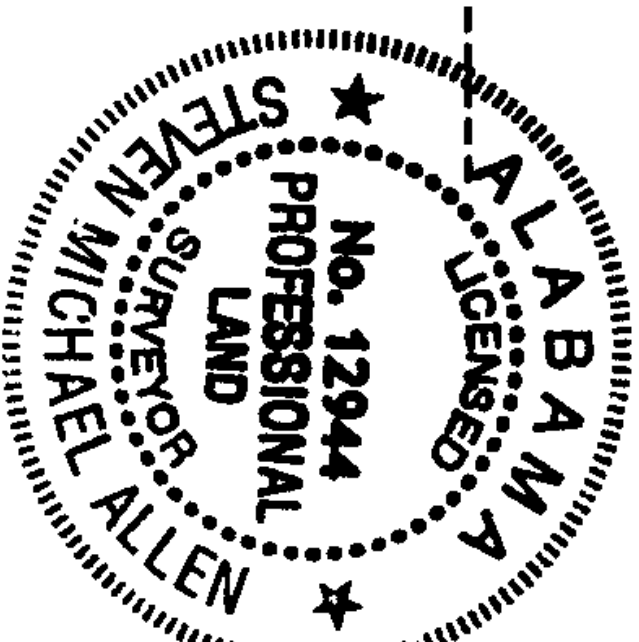
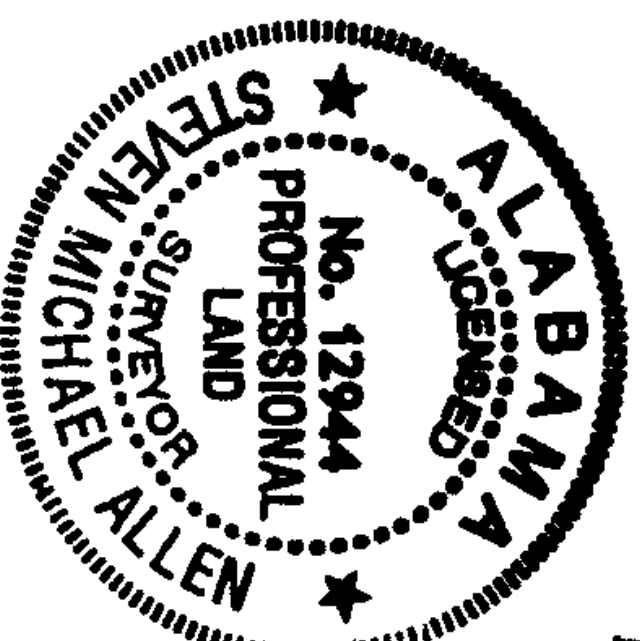

A tract of land situated in the southeast quarter of the Southeast quarter of Section 25, Township 21 South, Range 3 West, Shelby County, Alabama, more particularly described as follows: Commence at a found 1.31' wide and point being the Southeast corner of said Section 25; thence go in a westerly direction along the south line of said section a distance of 267.51 feet to a found 0.31' rebar; thence turn right 68 degrees 07 minutes 57 seconds (closed - 65 degrees 06 minutes 16 seconds) and go in a northwesterly direction a distance of 1485.34 feet to a set rebar, said point being the point of beginning of the tract herein described; thence continue on the same course a distance of 619.00 feet to a found stake on the centerline of a short road known as Bagdadon Road; thence turn right 79 degrees 18 minutes 26 seconds and go short road a distance of 514.49 feet; thence turn right 7 degrees 23 minutes 59 seconds and go in a northwesterly direction along the centerline of said degree 23 minutes 59 seconds and go in a northwesterly direction a distance of 49.53 feet to a set rebar; thence turn right 97 degrees 19 minutes 57 seconds and go in a southwesterly direction a distance of 720.68 feet to a set rebar; thence turn right 90 degrees 00 minutes 00 seconds and go in a southwesterly direction a distance of 450.00 feet to the point of beginning. described tract containing 7.0 acres, more or less. said tract subject to any and all easements of record.

Property Owners:  
Daryl B. Jackson  
Nancy A. Loney

20120105000005970 1/1 \$12.00  
Shelby County Judge of Probate, AL  
01/05/2012 01:49:56 PM FILED/CERT