

EASEMENT - DISTRIBUTION FACILITIES

Source of Title:

STATE OF ALABAMA

Deed Book _____, Page _____

COUNTY OF SHELBY

\$ 500.00

W.E. No. A617314CG11

APCO Parcel No. 70243441

Transformer No.

Shelby County, AL 10/25/2011
State of Alabama
Deed Tax: \$.50

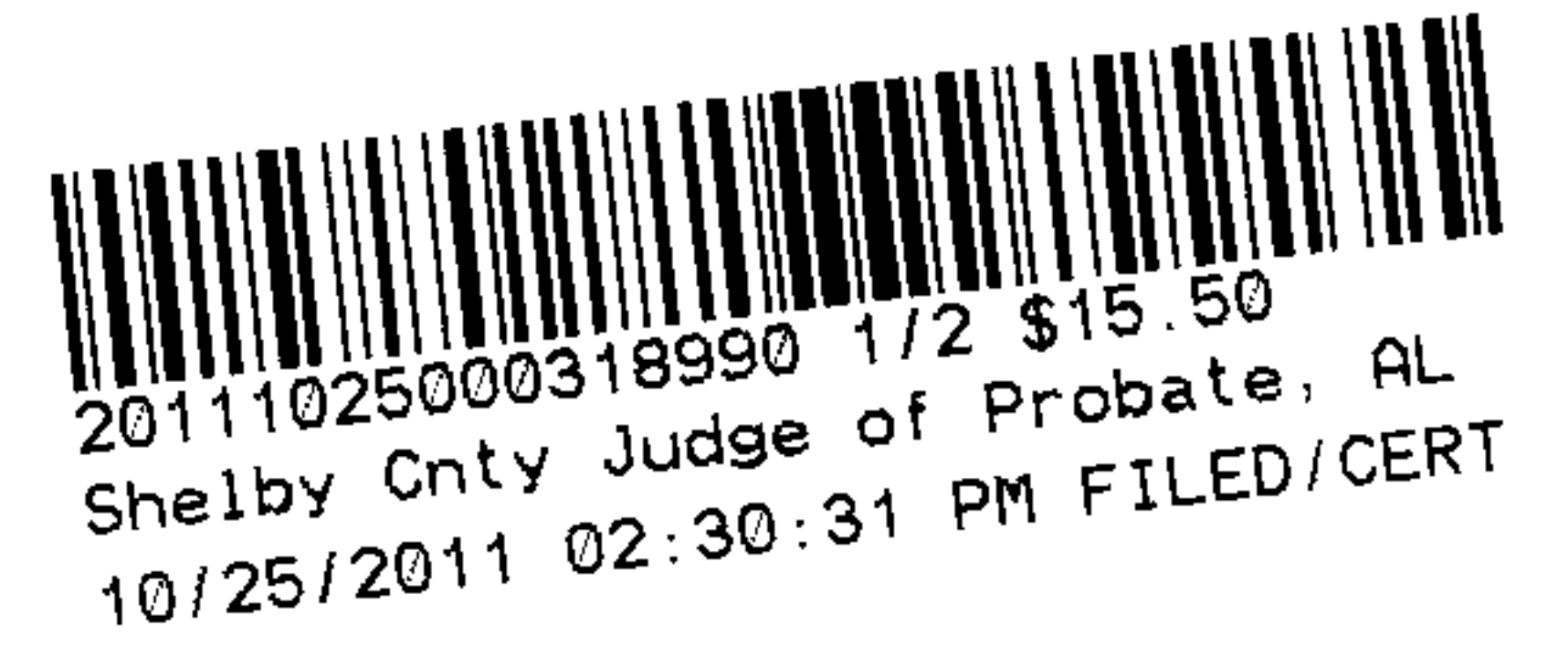

This instrument prepared by: BILL CHILDRESS

Alabama Power Company
P.O. Box 2641
Birmingham, Alabama 35291

KNOW ALL MEN BY THESE PRESENTS, That Stephen C. Allgood and wife Mymlyn F. Allgood

as grantor(s), (the "Grantor", whether one or more) for and in consideration of One and No/100 Dollar (\$1.00) and other good and valuable consideration paid to Grantor in hand by Alabama Power Company, a corporation, the receipt and sufficiency of which are hereby acknowledged, does hereby grant to Alabama Power Company, its successors and assigns (the "Company"), the easements, rights and privileges below.

Overhead and/or Underground

The right from time to time to construct, install, operate and maintain, upon, over, under and across the Property described below, all poles, towers, wires, conduits, fiber optics, cables, communication lines, translosures, transformers, anchors, guy wires and other facilities useful or necessary in connection therewith (collectively, "Facilities"), for the overhead and/or underground transmission and distribution of electric power and communications, along a route selected by the Company, as generally shown on the Company's drawing attached hereto and made a part hereof, but which is to be determined by the actual location(s) in which the Company's facilities are installed. The width of the Company's easement will depend on whether the Facilities are underground or overhead: for underground, the easement will extend five (5) feet on each side of said Facilities as and where installed; for overhead Facilities, the easement will extend fifteen (15) feet on each side of the centerline of said Facilities as and where installed. The Company is granted the right to clear, and keep clear, all trees, undergrowth and other obstructions on a strip of land extending five (5) feet from each side of said underground Facilities, and to clear, and keep clear, all trees, undergrowth and other obstructions on a strip of land extending fifteen (15) feet from each side of the centerline of said overhead Facilities and the right in the future to install intermediate poles and facilities on said strip. Further, with respect to overhead Facilities, the Company is also granted the right to trim and cut, and keep trimmed and cut, all dead, weak, leaning or dangerous trees or limbs outside of the thirty (30) foot strip that, in the sole opinion of the Company, may now or hereafter endanger, interfere with, or fall upon any of said overhead Facilities.

Grantor hereby grants to the Company all easements, rights and privileges necessary or convenient for the full enjoyment and use thereof, including without limitation the right of ingress and egress to and from said Facilities, as applicable, and the right to excavate for installation, replacement, repair and removal thereof; and also the right to cut, remove and otherwise keep clear any and all structures, obstructions or obstacles of whatever character, on, under and above said Facilities, as applicable.

The easements, rights and privileges granted hereby shall apply to, and the word "Property" as used in this instrument shall mean, the following described real property situated in SHELBY County, Alabama (the "Property"):

A parcel of land located in the SE¼ of the NE¼ of Section 15, Township 19 South, Range 2 West, more particularly described in Instrument 1996-18785, dated June 10, 1996, in the office of the Judge of Probate, Shelby County, Alabama.

In the event it becomes necessary or desirable for the Company from time to time to move any of the Facilities in connection with the construction or improvement of any public road or highway in proximity to the Facilities, Grantor hereby grants to the Company the right to relocate the Facilities and, as to such relocated Facilities, to exercise the rights granted above; provided, however, the Company shall not relocate said Facilities on the Property at a distance greater than ten feet (10') outside the boundary of the right of way of any such public road or highway as established or re-established from time to time. This grant and agreement shall be binding upon and shall inure to the benefit of Grantor, the Company and each of their respective heirs, personal representatives, successors and assigns and the words "Company" and "Grantor" as used in this instrument shall be deemed to include the heirs, personal representatives, successors and assigns of such parties.

TO HAVE AND TO HOLD the same to the Company, its successors and assigns, forever.

IN WITNESS WHEREOF, the undersigned Grantor(s) has/have set his/her/their hand(s) and seal(s) this the 14 day of OCT, 2011.

Jean W Baker
Witness
Jean W Baker
Witness

Stephen C Allgood (SEAL)
(Grantor)
Mymlyn F Allgood (SEAL)
(Grantor)

Witness

(Grantor)

Witness

(Grantor)

Witness

By:

As:

SKETCH OF PROPOSED WORK SIMPLIFIED W.E.

Map Center UTM
1723105 12118025

Parcel - 70243441
Map Center LatLon
33.381206 -86.729029

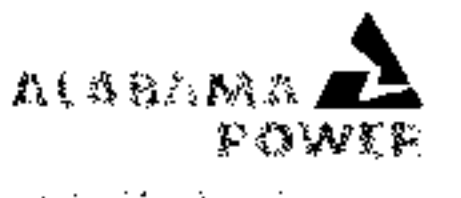

Customer Steve Allgood			Location 4927 Windwood Circle			Agreed Serv. Date 11-30-11		Estimate No. A617314CG11				
Region Birmingham			Oper. Cntr. Metro-South		Town/City Birmingham		UserID dawboyd		Created: 10/7/2011			
County Shelby		Section 15	Township 19S	Range 02W	Add'l Info							
Acquisition Agent Bill Childress			Date R/W Assigned		Date R/W Cleared		Spatial Reference		LOC		Transformer Loading	
Voltage	Phone Co	CATV Co	Accessible	Tree Crew	Rock Hole		R/W	City	County	State	Miss All	Other
19.9kv	AT&T	Charter	No	No			Permits Y	N	N	N	Y	

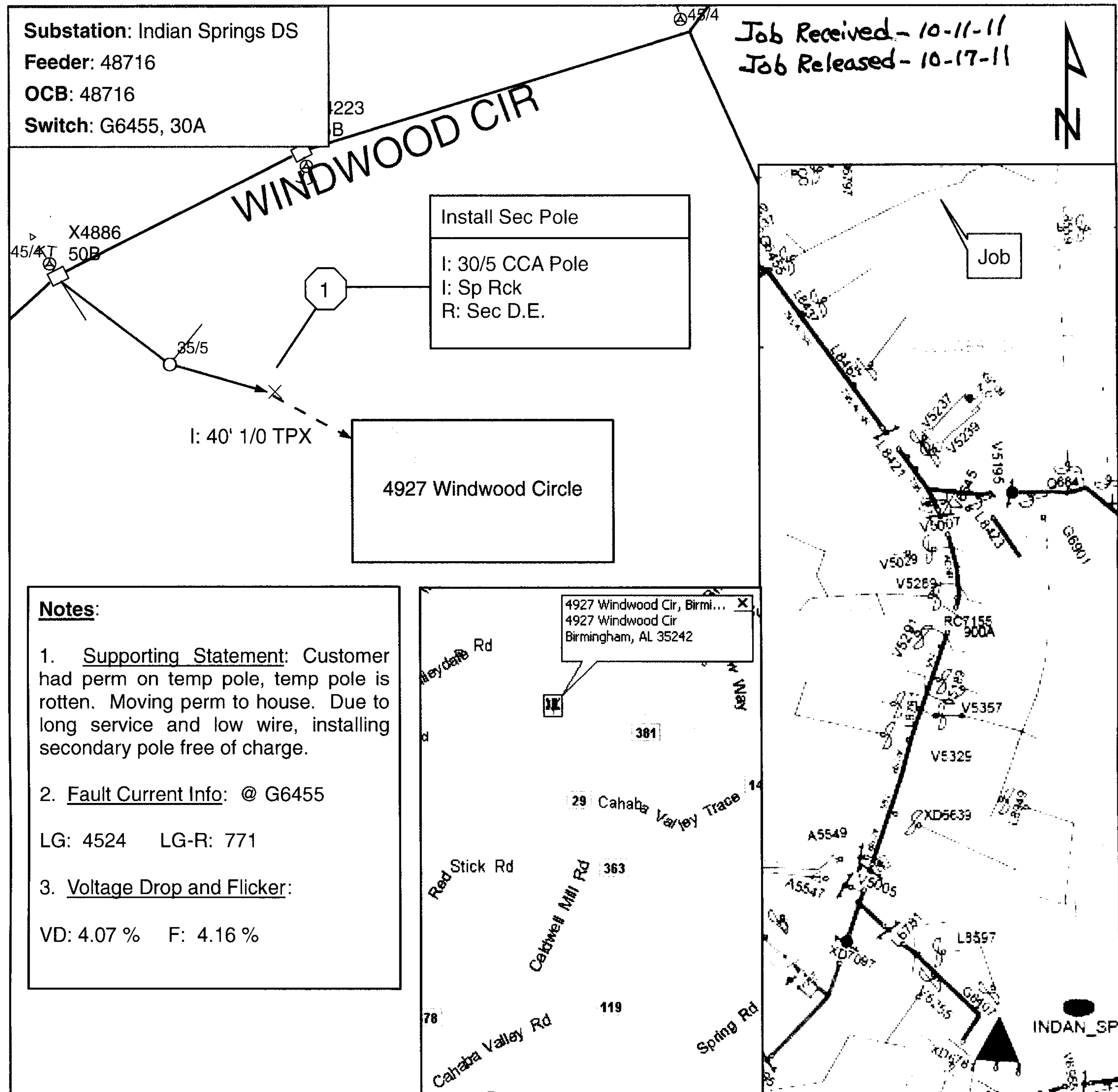

Cnst Completed By:

Date:

Scale: 1 inch = 100 feet



20111025000318990 2/2 \$15.50
Shelby Cnty Judge of Probate, AL
10/25/2011 02:30:31 PM FILED/CERT