

Deed Book \_\_\_\_\_, Page \_\_\_\_\_

Condemnation Case# 32-184

**STATE OF ALABAMA**

COUNTY OF Shelby

W.E. No. A6170-05-AV11

APCO Parcel No. 70243383

Transformer No. s15524

This instrument prepared by: Larry D. Gravitt

Alabama Power Company  
P. O. Box 2641  
Birmingham, Alabama 35291

20111019000311460 1/3 \$18.50  
Shelby Cnty Judge of Probate, AL  
10/19/2011 01:36:20 PM FILED/CERT

KNOW ALL MEN BY THESE PRESENTS, That SHELBY COUNTY, ALABAMA

as grantor(s), (the "Grantor", whether one or more) for and in consideration of One and No/100 Dollar (\$1.00) and other good and valuable consideration paid to Grantor in hand by Alabama Power Company, a corporation, the receipt and sufficiency of which are hereby acknowledged, hereby grant to Alabama Power Company, its successors and assigns (the "Company"), the easements, rights and privileges below.

**Overhead and/or Underground.** The right from time to time to construct, install, operate and maintain, upon, over, under and across the Property described below, all poles, towers, wires, conduits, fiber optics, cables, communication lines, trans closures, transformers, anchors, guy wires and other facilities useful or necessary in connection therewith (collectively, "Facilities"), for the overhead and/or underground transmission and distribution of electric power and communications, along a route selected by the Company, as generally shown on the Company's drawing attached hereto and made a part hereof, but which is to be determined by the actual location(s) in which the Company's facilities are installed. The width of the Company's easement will depend on whether the Facilities are underground or overhead: for underground, the easement will extend five (5) feet on each side of said Facilities as and where installed; for overhead Facilities, the easement will extend fifteen (15) feet on each side of the centerline of said Facilities as and where installed. The Company is granted the right to clear, and keep clear, all trees, undergrowth and other obstructions on a strip of land extending five (5) feet from each side of said underground Facilities, and to clear, and keep clear, all trees, undergrowth and other obstructions on a strip of land extending fifteen (15) feet from each side of the centerline of said overhead Facilities and the right in the future to install intermediate poles and facilities on said strip. Further, with respect to overhead Facilities, the Company is also granted the right to trim and cut, and keep trimmed and cut, all dead, weak, leaning or dangerous trees or limbs outside of the thirty (30) foot strip that, in the sole opinion of the Company, may now or hereafter endanger, interfere with, or fall upon any of said overhead Facilities.

Grantor hereby grants to the Company all easements, rights and privileges necessary or convenient for the full enjoyment and use thereof, including without limitation the right of ingress and egress to and from said Facilities, as applicable, and the right to excavate for installation, replacement, repair and removal thereof; and also the right to cut, remove and otherwise keep clear any and all structures, obstructions or obstacles of whatever character, on, under and above said Facilities, as applicable.

The easements, rights and privileges granted hereby shall apply to, and the word "Property" as used in this instrument shall mean, the following described real property situated in Shelby County, Alabama (the "Property"):

A parcel of land located in the NE1/4 of Section 25 and the SE1/4 of Section 24 all being in Township 21 South, Range 2 West as is recorded in Deed Record 20020001345000000 and Condemnation Case# 32-184 in the office of the Judge of Probate of Shelby County, Alabama.

In the event it becomes necessary or desirable for the Company from time to time to move any of the Facilities in connection with the construction or improvement of any public road or highway in proximity to the Facilities, Grantor hereby grants to the Company the right to relocate the Facilities and, as to such relocated Facilities, to exercise the rights granted above; provided, however, the Company shall not relocate said Facilities on the Property at a distance greater than ten feet (10') outside the boundary of the right of way of any such public road or highway as established or re-established from time to time. This grant and agreement shall be binding upon and shall inure to the benefit of Grantor, the Company and each of their respective heirs, personal representatives, successors and assigns and the words "Company" and "Grantor" as used in this instrument shall be deemed to include the heirs, personal representatives, successors and assigns of such parties.

TO HAVE AND TO HOLD the same to the Company, its successors and assigns, forever.

IN WITNESS WHEREOF, the undersigned Grantor (~~s/he~~) has hereunto set his/her hand(s) and seal(s) this the 3 day of October, 2011

Witness

(Grantor)

Witness \_\_\_\_\_

SHELBY COUNTY, ALABAMA (SEAL)

Witness \_\_\_\_\_

By: Jeff Zuckerman (SEAL)

As: Ch. Wayne County Manager

**For Alabama Power Company Corporate Real Estate Department Use Only**

All facilities on Grantor: ✓

Station to Station:

IN WITNESS WHEREOF, the said Grantor, has caused this instrument to be executed by \_\_\_\_\_, its authorized representative, as of the \_\_\_\_\_ day of \_\_\_\_\_, 20\_\_\_\_.

ATTEST (if required) or WITNESS:

\_\_\_\_\_  
(Grantor - Name of Corporation/Partnership/LLC)

By: \_\_\_\_\_

By: \_\_\_\_\_ (SEAL)

Its: \_\_\_\_\_

Its: \_\_\_\_\_  
[indicate President, General Partner, Member, etc.]

**INDIVIDUAL NOTARIES**

STATE OF ALABAMA }

COUNTY OF \_\_\_\_\_ }

I, \_\_\_\_\_, a Notary Public, in and for said County in said State, hereby certify that \_\_\_\_\_ whose name(s) [as \_\_\_\_\_] is/are signed to the foregoing instrument and who is/are known to me, acknowledged before me on this day that being informed of the contents of the instrument, he/she/they [in such capacity as aforesaid] executed the same voluntarily.

Given under my hand and official seal this the \_\_\_\_\_ day of \_\_\_\_\_, 20\_\_\_\_.

[SEAL]

\_\_\_\_\_  
Notary Public  
My commission expires: \_\_\_\_\_

STATE OF ALABAMA }

COUNTY OF \_\_\_\_\_ }

I, \_\_\_\_\_, a Notary Public, in and for said County in said State, hereby certify that \_\_\_\_\_ whose name(s) [as \_\_\_\_\_] is/are signed to the foregoing instrument and who is/are known to me, acknowledged before me on this day that being informed of the contents of the instrument, he/she/they [in such capacity as aforesaid] executed the same voluntarily.

Given under my hand and official seal this the \_\_\_\_\_ day of \_\_\_\_\_, 20\_\_\_\_.

[SEAL]

\_\_\_\_\_  
Notary Public  
My commission expires: \_\_\_\_\_

**CORPORATION/PARTNERSHIP/LLC NOTARY**

STATE OF ALABAMA }

COUNTY OF Shelby }

I, Kim Reynolds, a Notary Public in and for said County in said State, hereby certify that Alex Dudchock whose name as County Manager of Shelby County, a \_\_\_\_\_, [acting in its capacity as \_\_\_\_\_] is signed to the foregoing instrument, and who is known to me, acknowledged before me on this day that, being informed of the contents of the instrument, he/she, as such Alex Dudchock and with full authority, executed the same voluntarily, for and as the act of said County Manager [acting in such capacity as aforesaid].

Given under my hand and official seal this the 5<sup>th</sup> day of October, 2011.

[SEAL]

Kim Reynolds  
\_\_\_\_\_  
Notary Public  
My commission expires: My Commission Expires October 21, 2012

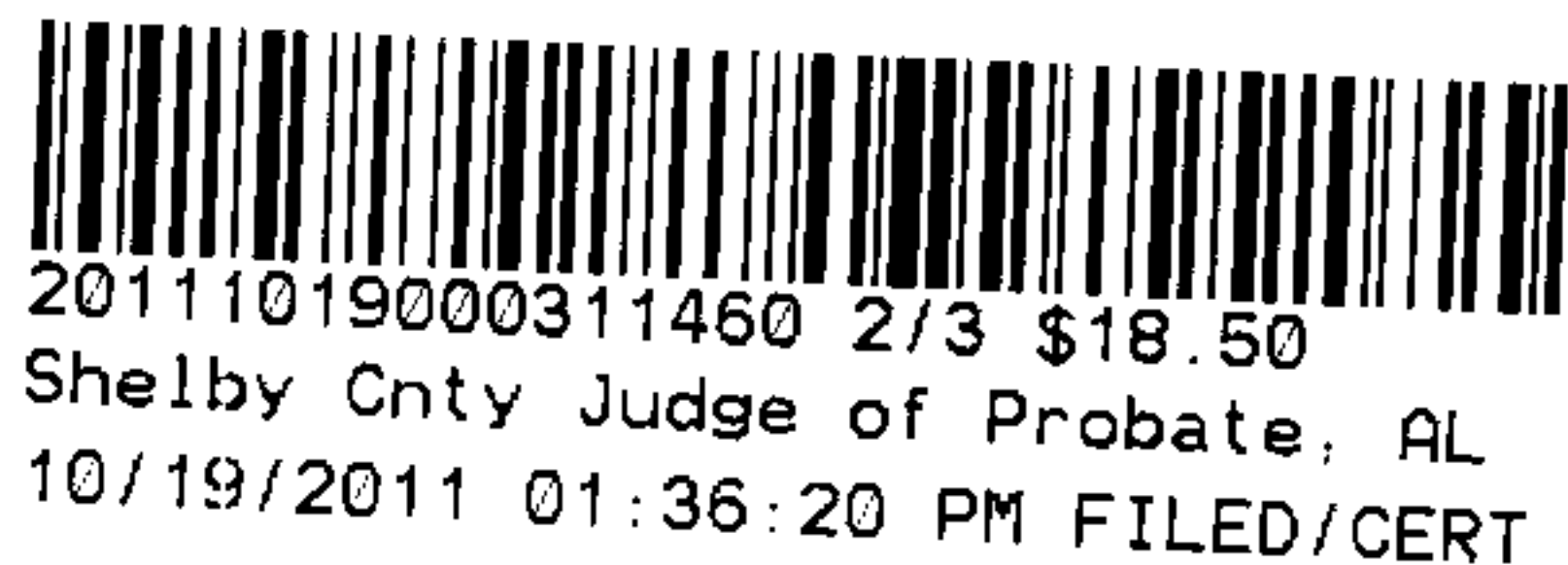



Parcel # 70243383  
Received 9/30/2011  
Released 10/9/2011

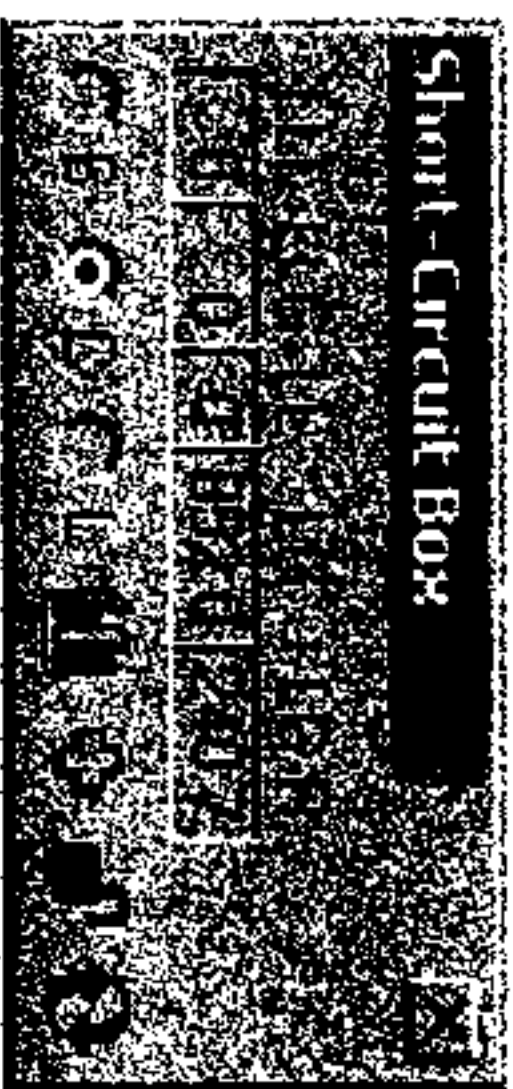

Shelby County, AL 10/19/2011  
State of Alabama  
Deed Tax: \$.50

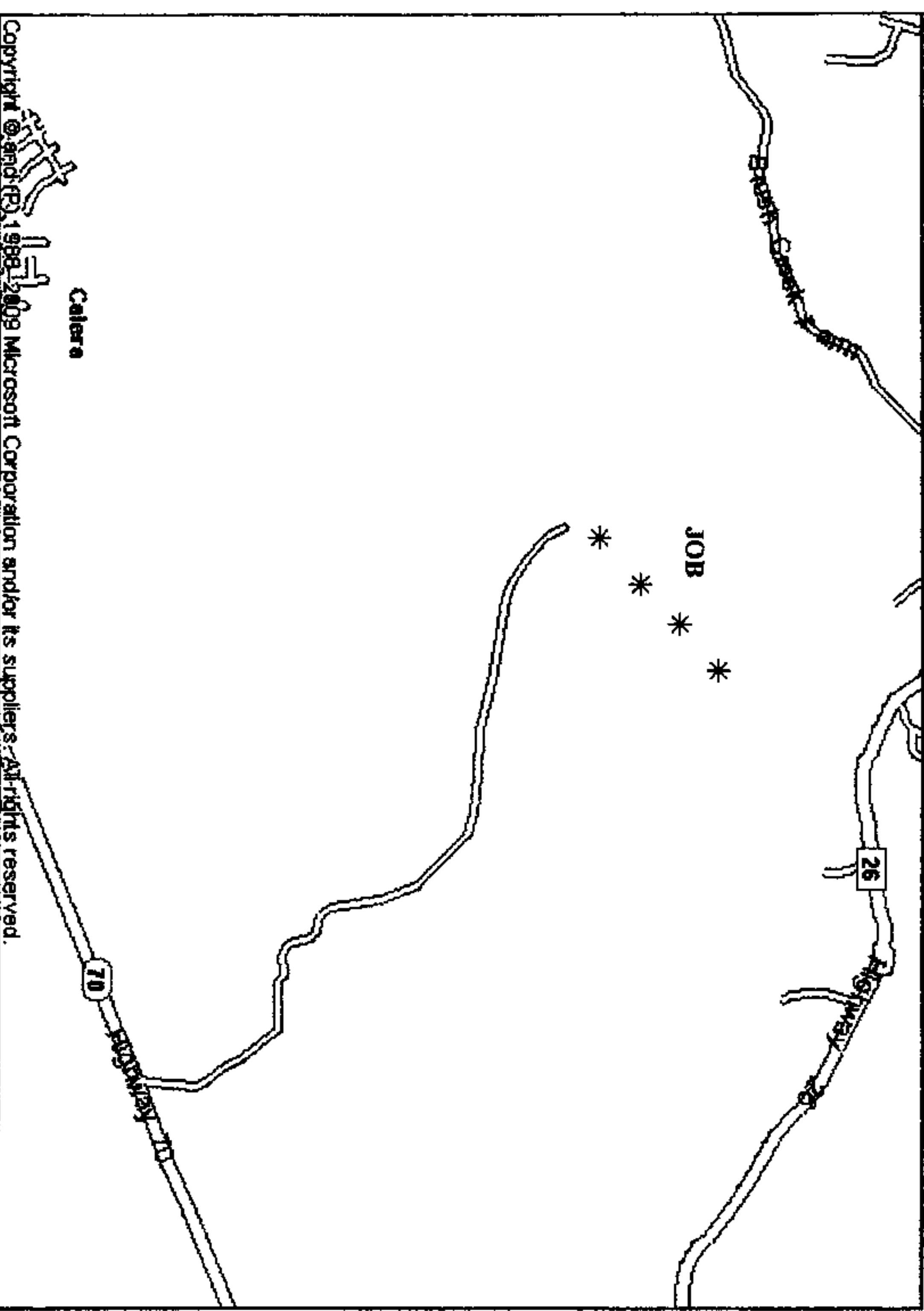

20111019000311460 3/3 \$18.50  
Shelby Cnty Judge of Probate, AL  
10/19/2011 01:36:20 PM FILED/CERT

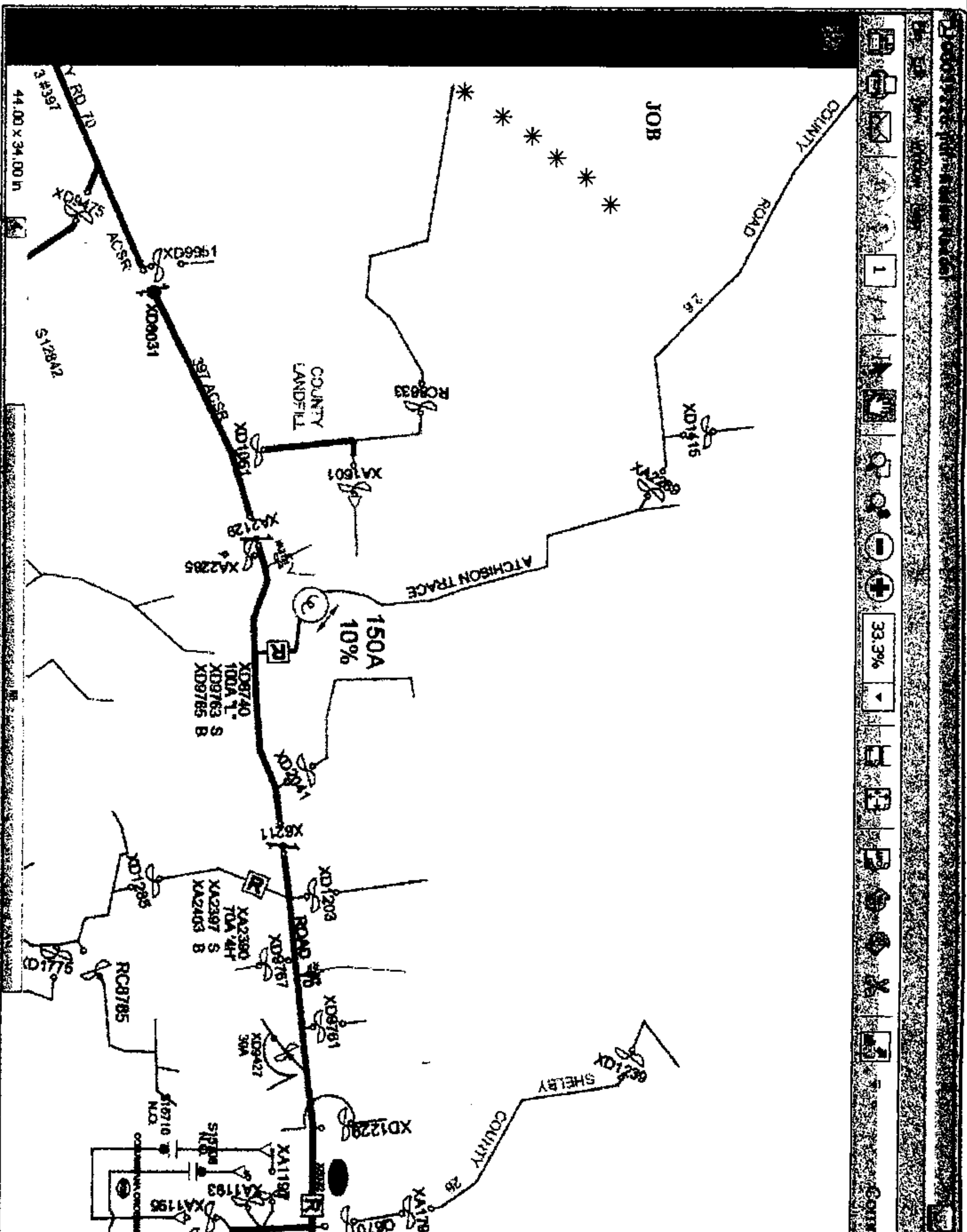
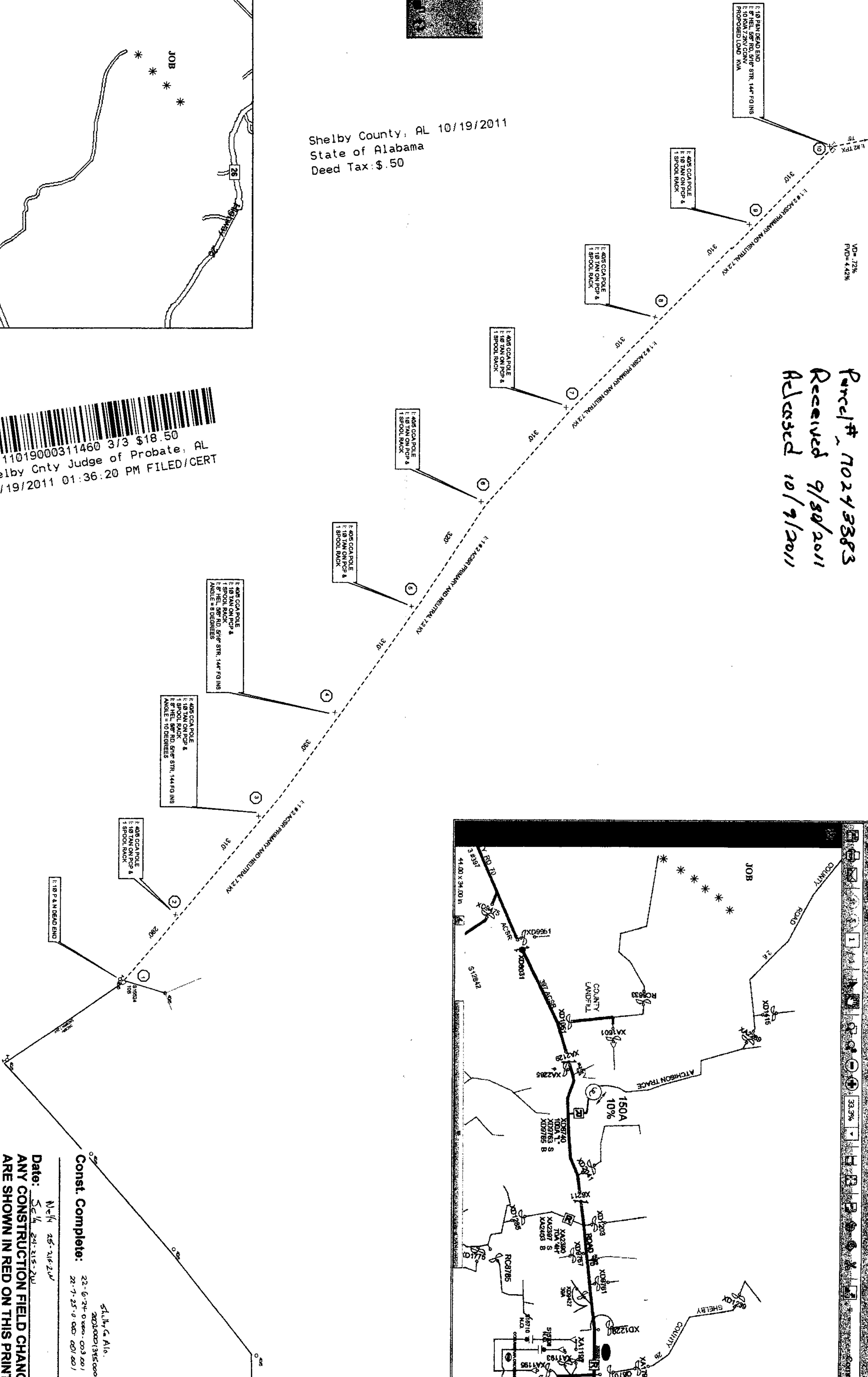

Const. Complete: 22-6-24-0-000-003 001  
22-7-25-0-000-001 001  
Date: 5-14-24-215-20  
N=14 25-215-20  
ANY CONSTRUCTION FIELD CHANG  
ARE SHOWN IN RED ON THIS PRINT

For Energized Line Work	
Obtain Hotline Work Permit @	
X6032 800 A VPER	
K03633 60A	
Substation: WEST COLUMBIANA	
Feeder # 2, Breaker # 39226	
Sheet:	215
Section:	215
Township:	0241
Range:	0241
METRO SOUTH - 12 KV DISTRIBUTION	
Detail: install 9 poles 2000' 10' Primary &	
to provide service to pump at Landfill	
Engineer:	BRASHER
Town:	COLUMBIANA
County:	Shelby
Created/Issued:	9/7/2011