

STATE OF ALABAMA

\$1500.00

COUNTY OF SHELBY

Deed Record 20040415000196470

W.E. No. A617006A811

APCO Parcel No. 70242459

Transformer No.

This instrument prepared by: LARRY GRAVITT

Alabama Power Company
P.O. Box 2641
Birmingham, Alabama 35291

KNOW ALL MEN BY THESE PRESENTS, That Holy Trinity - Holy Cross Greek Orthodox Cathedral

as grantor(s), (the "Grantor", whether one or more) for and in consideration of One and No/100 Dollar (\$1.00) and other good and valuable consideration paid to Grantor in hand by Alabama Power Company, a corporation, the receipt and sufficiency of which are hereby acknowledged, does hereby grant to Alabama Power Company, its successors and assigns (the "Company"), the easements, rights and privileges below.

Overhead and/or Underground

The right from time to time to construct, install, operate and maintain, upon, over, under and across the Property described below, all poles, towers, wires, conduits, fiber optics, cables, communication lines, trans closures, transformers, anchors, guy wires and other facilities useful or necessary in connection therewith (collectively, "Facilities"), for the overhead and/or underground transmission and distribution of electric power and communications, along a route selected by the Company, as generally shown on the Company's drawing attached hereto and made a part hereof, but which is to be determined by the actual location(s) in which the Company's facilities are installed. The width of the Company's easement will depend on whether the Facilities are underground or overhead: for underground, the easement will extend five (5) feet on each side of said Facilities as and where installed; for overhead Facilities, the easement will extend fifteen (15) feet on each side of the centerline of said Facilities as and where installed. The Company is granted the right to clear, and keep clear, all trees, undergrowth and other obstructions on a strip of land extending five (5) feet from each side of said underground Facilities, and to clear, and keep clear, all trees, undergrowth and other obstructions on a strip of land extending fifteen (15) feet from each side of the centerline of said overhead Facilities and the right in the future to install intermediate poles and facilities on said strip. Further, with respect to overhead Facilities, the Company is also granted the right to trim and cut, and keep trimmed and cut, all dead, weak, leaning or dangerous trees or limbs outside of the thirty (30) foot strip that, in the sole opinion of the Company, may now or hereafter endanger, interfere with, or fall upon any of said overhead Facilities.

Grantor hereby grants to the Company all easements, rights and privileges necessary or convenient for the full enjoyment and use thereof, including without limitation the right of ingress and egress to and from said Facilities, as applicable, and the right to excavate for installation, replacement, repair and removal thereof; and also the right to cut, remove and otherwise keep clear any and all structures, obstructions or obstacles of whatever character, on, under and above said Facilities, as applicable.

The easements, rights and privileges granted hereby shall apply to, and the word "Property" as used in this instrument shall mean, the following described real property situated in SHELBY County, Alabama (the "Property"):

A parcel of land located in the NW¼ of the NW¼ of Section 28, Township 20 South, Range 2 East, more particularly described in Deed Record 20040415000196470, as recorded in the office of the Judge of Probate, Shelby County, Alabama.

In the event it becomes necessary or desirable for the Company from time to time to move any of the Facilities in connection with the construction or improvement of any public road or highway in proximity to the Facilities, Grantor hereby grants to the Company the right to relocate the Facilities and, as to such relocated Facilities, to exercise the rights granted above; provided, however, the Company shall not relocate said Facilities on the Property at a distance greater than ten feet (10') outside the boundary of the right of way of any such public road or highway as established or re-established from time to time. This grant and agreement shall be binding upon and shall inure to the benefit of Grantor, the Company and each of their respective heirs, personal representatives, successors and assigns and the words "Company" and "Grantor" as used in this instrument shall be deemed to include the heirs, personal representatives, successors and assigns of such parties.

TO HAVE AND TO HOLD the same to the Company, its successors and assigns, forever.

IN WITNESS WHEREOF, the said Grantor, has caused this instrument to be executed by JAMES J. DIKIS, its authorized representative, as of the 31 day of August, 2011.

ATTEST (if required) or WITNESS:

By: _____

Its: _____

Holy Trinity - Holy Cross Greek Orthodox Cathedral
(Grantor - Name of Corporation/Partnership/LLC)
By: James J. Dikis (SEAL)
Its: PARISH/COUNCIL
[indicate President, General Partner, Member, etc.]

20110920000278470 1/4 \$21.50
Shelby Cnty Judge of Probate, AL
09/20/2011 01:17:35 PM FILED/CERT

Shelby County, AL 09/20/2011
State of Alabama
Deed Tax: \$.50

For Alabama Power Company Corporate Real Estate Department Use Only

All facilities on Grantor: _____

Station to Station: _____

CORPORATION NOTARY

STATE OF ALABAMA

COUNTY OF Shelby

I, Larry D. Gravitt, a Notary Public, in and for said County in said State, hereby certify that James J. Diki's, whose name as Ponsh Council of Holy Trinity-Holy Cross Greek Orthodox Cathedral, a corporation, is signed to the foregoing instrument, and who is known to me, acknowledged before me on this day that, being informed of the contents of this instrument, he/she, as such officer and with full authority, executed the same voluntarily for and as the act of said Corporation.

Given under my hand and official seal this the 31st day of August, 2011.

[SEAL]

Larry D. Gravitt
Notary Public

My commission expires: 2-5-14



20110920000278470 2/4 \$21.50
Shelby Cnty Judge of Probate, AL
09/20/2011 01:17:35 PM FILED/CERT

CORPORATION/PARTNERSHIP/LLC NOTARY

STATE OF ALABAMA

COUNTY OF _____

I, _____, a Notary Public, in and for said County in said State, hereby certify that _____, whose name as _____ of _____, a _____, [acting in its capacity as _____ of _____] is signed to the foregoing instrument, and who is known to me, acknowledged before me on this day that, being informed of the contents of the instrument, he/she, as such _____ and with full authority, executed the same voluntarily, for and as the act of said _____ [acting in such capacity as aforesaid].

Given under my hand and official seal this the _____ day of _____, 20_____.

[SEAL]

Notary Public

My commission expires: _____

SKETCH OF PROPOSED WORK - SIMPLIFIED W.E.

Map Center UTM: 1808885 12077184

Map Center Latlon: 33.267994 -86.448646

1 inch = 100 feet N.T.S.

Customer CAMP YAKAKES CHURCH PAVILION	Location 33985 AL HWY 25 ACROSS FROM SHELBY CTY FLEA MKT	Cmtd. Svc Date 09/07/2011	County SHELBY	Section 28	Township 20S	Range 02E	Add'l Info.	Estimate No. A6170-06-A811
Division BIRMINGHAM- SOUTH	District VARNONS - COLUMBIANA	Town WILSONVILLE / HARPERSVILLE	UserID #11507 aachand	Created: 8/16/2011	Substation SHELBY D.S.	X- 10336	Y- XD2909	MISSALL#

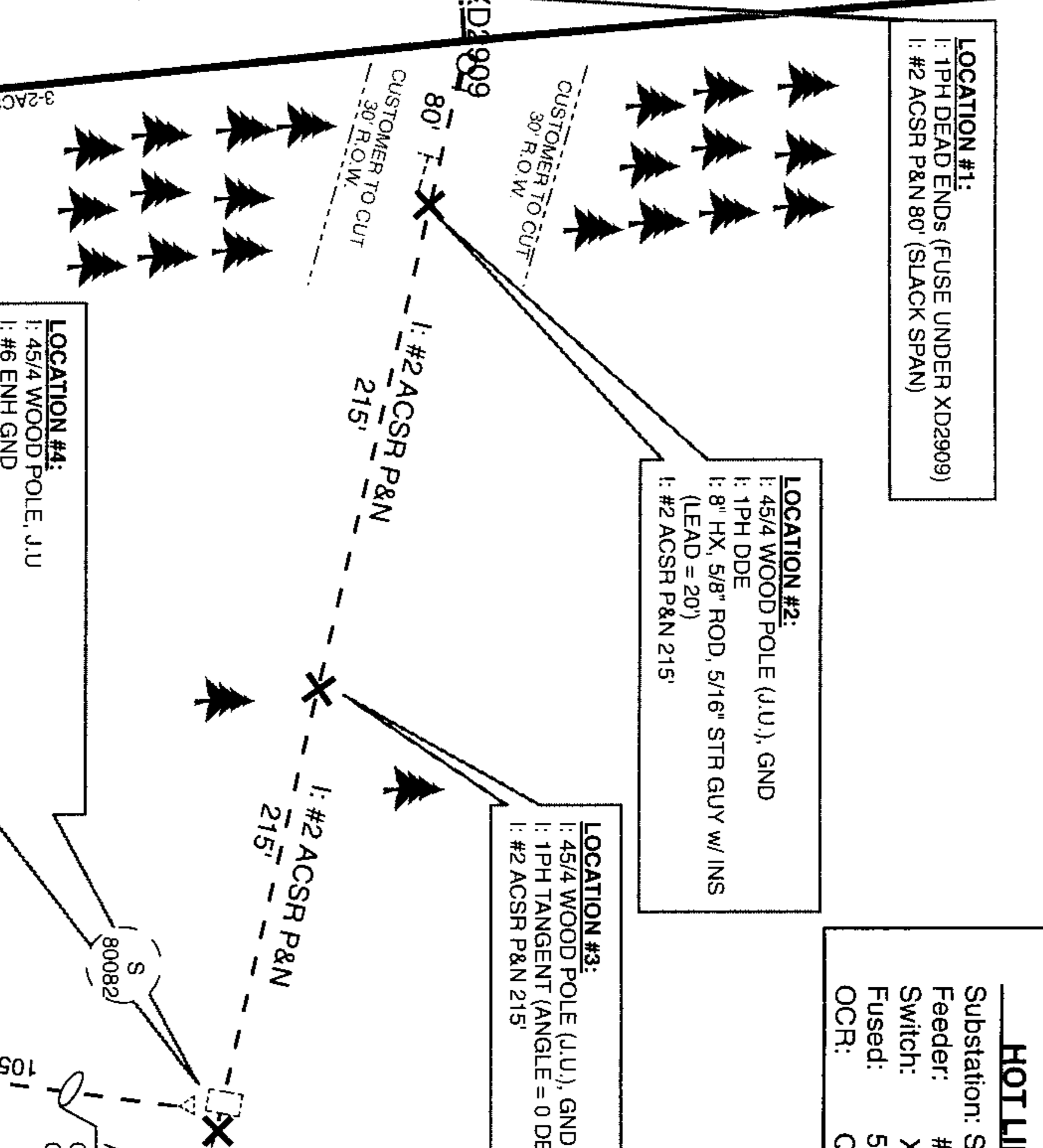
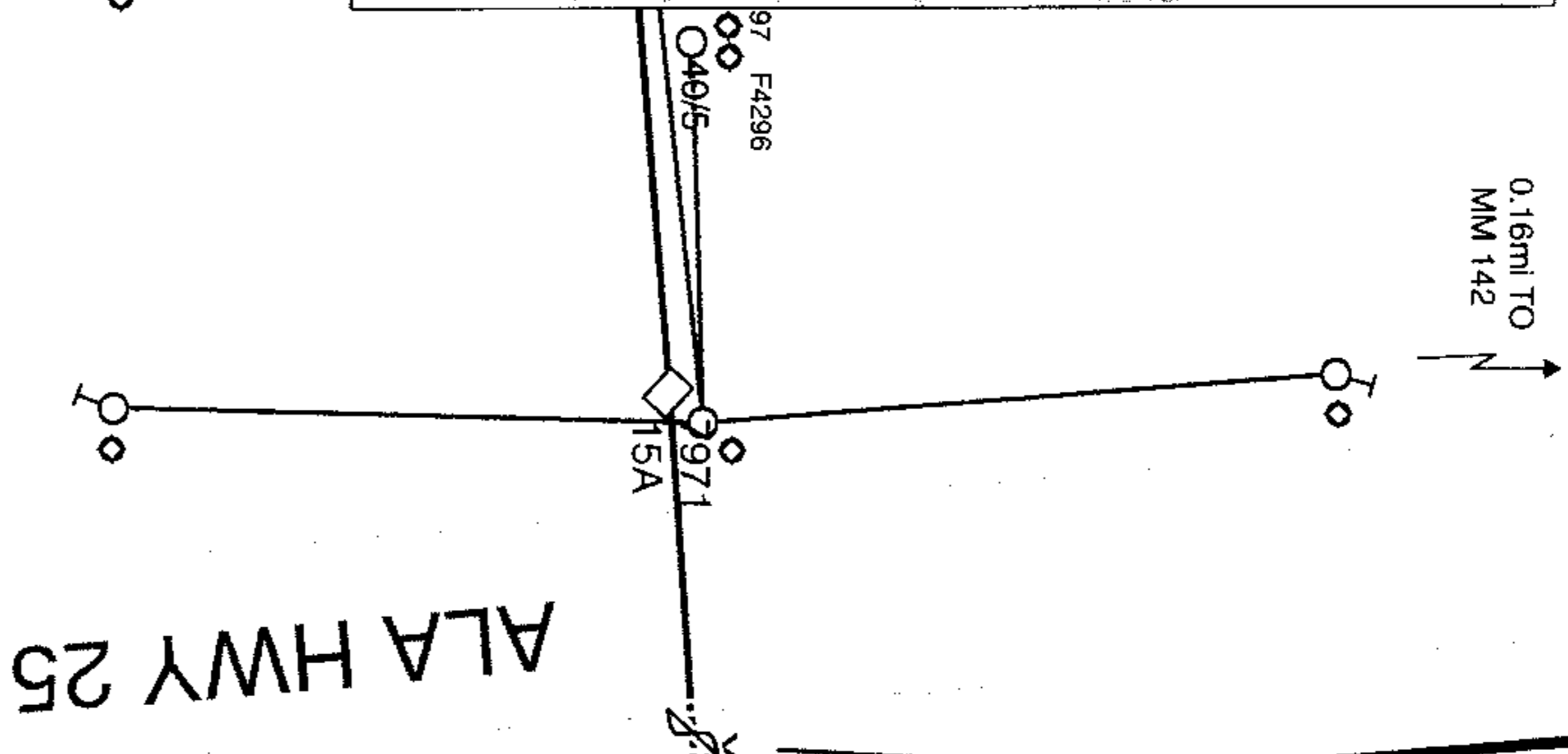
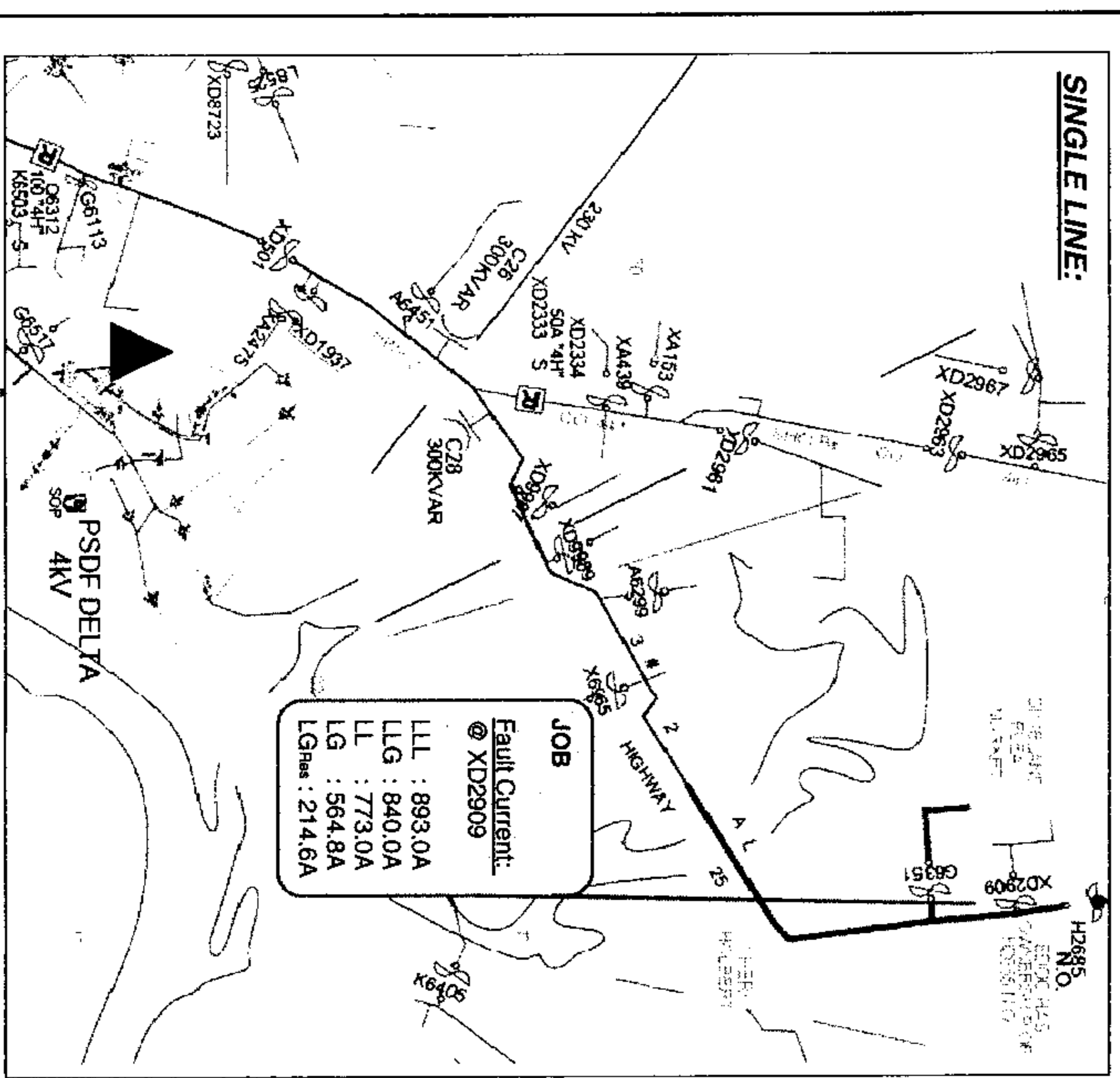
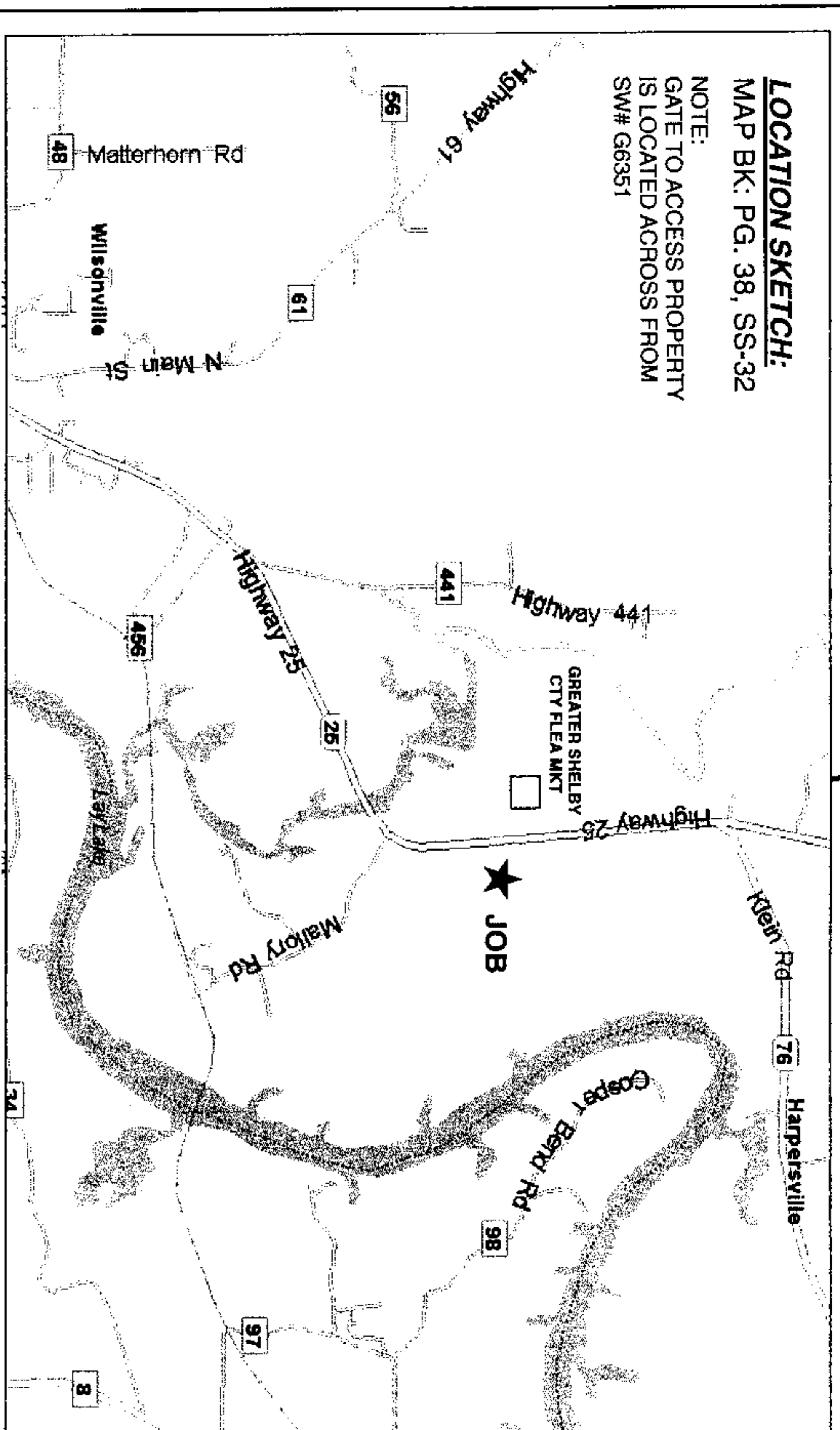

Transformer Loading	Loc 4	16.33kVA
Voltage	Pri 7.2kV	Sec 120/240V
Phone Co.	Y	
Cable Co.	Y	
Accessible	Y	
Tree Crew	N	
Rock Hole	N	
Permits		
RAW	Y	
CITY		
COUNTY		
STATE		
OTHER		

20110920000278470 3/4 \$21.50
Shelby Cnty Judge of Probate, AL
09/20/2011 01:17:35 PM FILED/CERT



3-2ACSR+4ACSRN 12.47KV

66351

NOTES:
1) WORK ORDER REQUIRED IN ORDER TO PROVIDE SINGLE-PHASE OH/UG SERVICE TO NEW CHURCH PAVILION.
2) POLES SIZED FOR FUTURE THREE-PHASE TO CHAPEL. FUTURE PLANS ALSO INCLUDE BALL FIELDS AND AN AMPHITHEATRE IN ADDITION TO A FUTURE HOME.
3) CUSTOMER CONTACT: JIMMY DYKUS @ 205-639-8906
4) MARKETING REP: JEANNE GALLAGHER @ 205-228-1041
5) APCO TO BILL CUSTOMER \$3508.00 FOR UNDERGROUND AND OUT-OF-RATIO CHARGES.
6) PER LEGISLATION, NO CHACTVM CHARGED DUE TO WORK BEING COMPLETED IN THE YEAR 2011.

CAMP YAKAKES CHURCH PAVILION
ACROSS FROM 33985 HWY 25
PRO. LD. 163KVA
PRO. VD. 3.46%
CUST. MAIN 200A 1PH
METERING 200A 1PH
MTR. COM# 97-22003

APCO TO INSTALL #4/0 UTA (105) IN
CUSTOMER INSTALLED 3" CONDUIT:
CUST. TRENCH = 36"

SKETCH OF PROPOSED WORK - SIMPLIFIED W.E.

Map Center UTM: 1808885 12077184

Map Center LatLon: 33.267994 -86.448646

1 inch = 100 feet N.T.S.

Customer CAMP YAKAKES CHURCH PAVILION	Location 33985 AL HWY 25 ACROSS FROM SHELBY CTY FLEA MKT	Cmtd. Svc Date 09/07/2011	County SHELBY	Section 28	Township 20S	Range 02E	Add'l Info.	Estimate No. A6170-06-A811
Division BIRMINGHAM- SOUTH	District VARNONS - COLUMBIANA	Town WILSONVILLE / HARPERSVILLE	UserID aachand #11507	Created: 8/16/2011	Substation SHELBY D.S.	X- 10336	Y- XD2909	MISSALL#

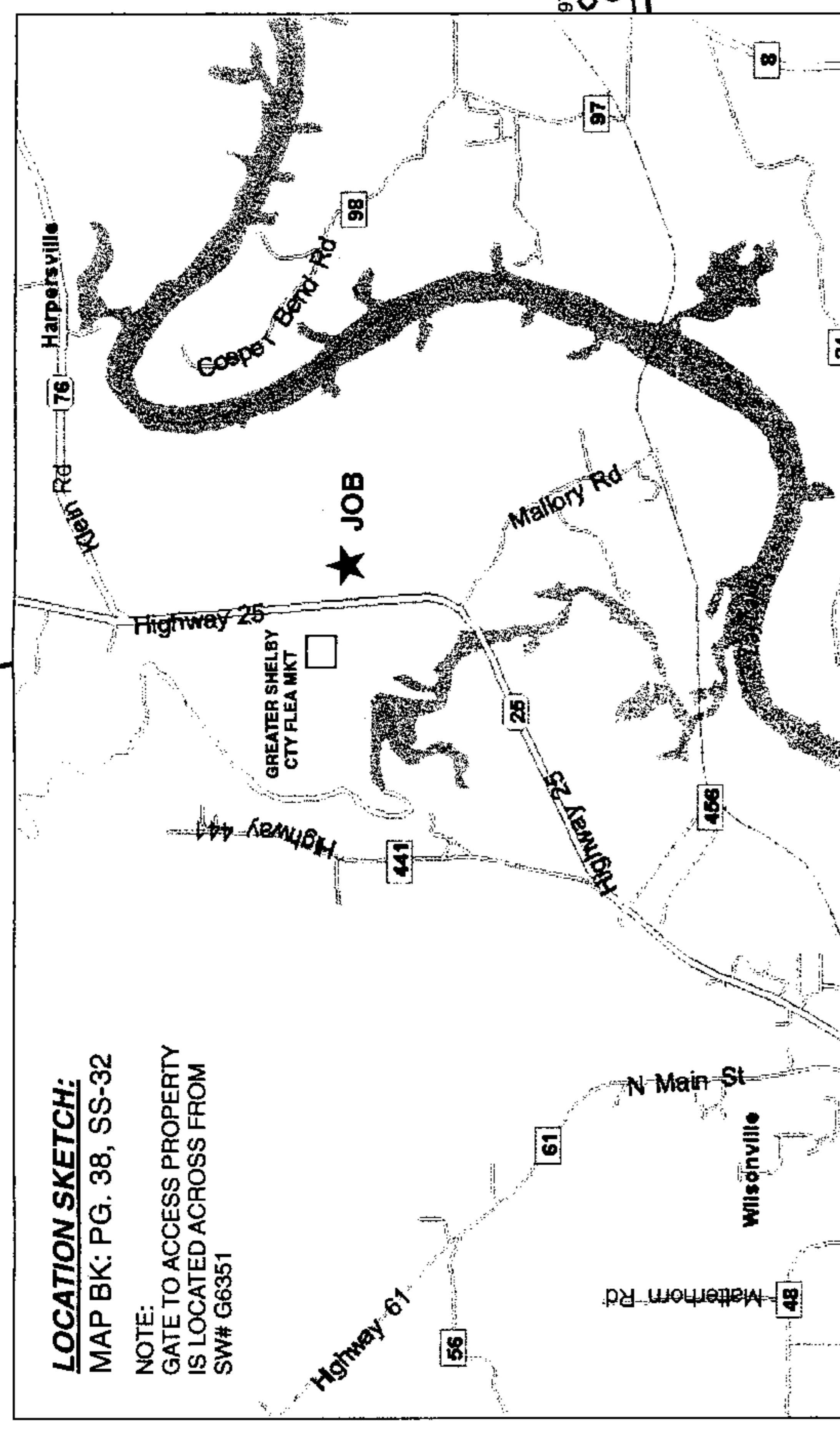

Loc 4	Transformer Loading 16.33kVA
-----------------	----------------------------------------

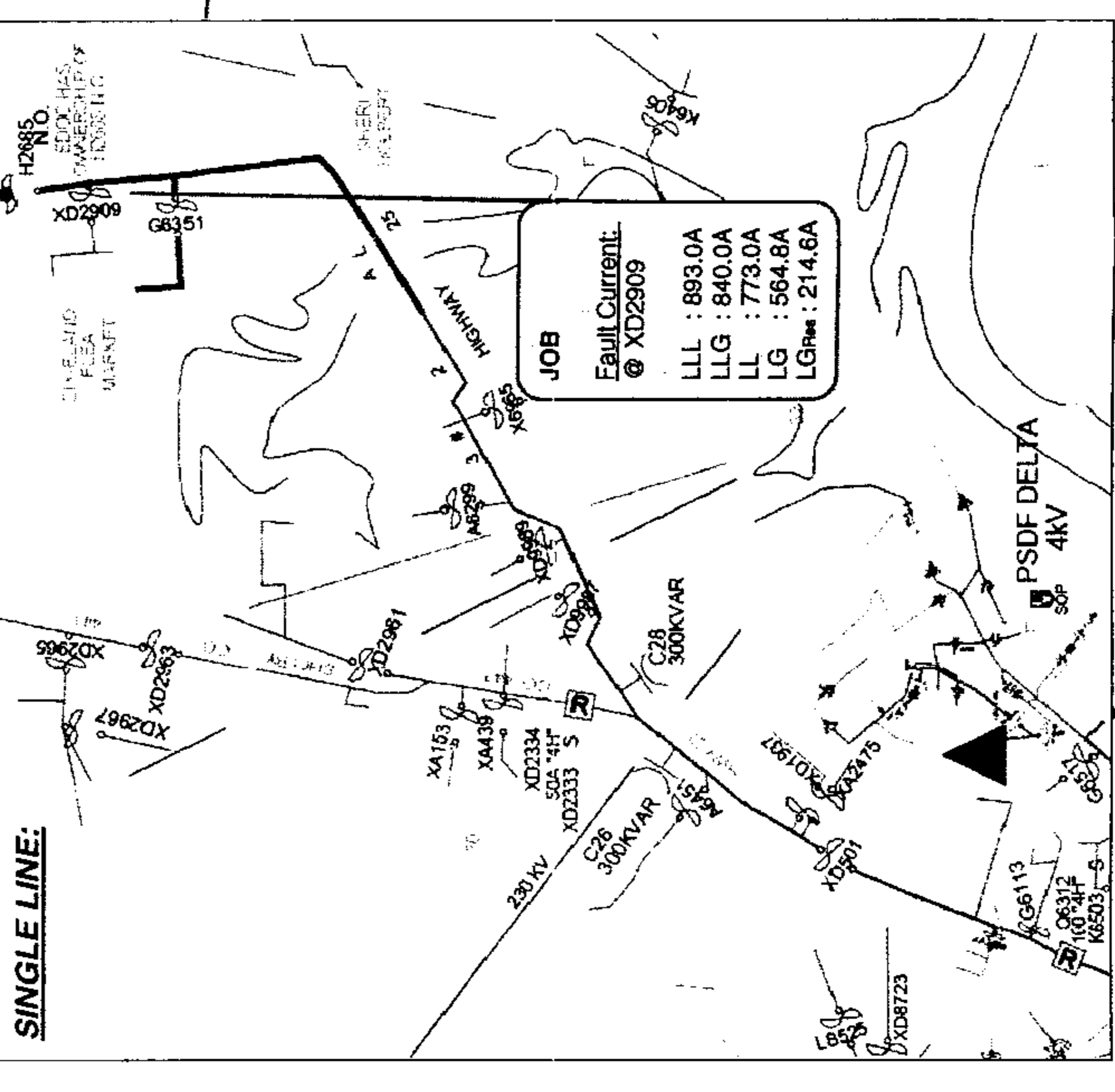
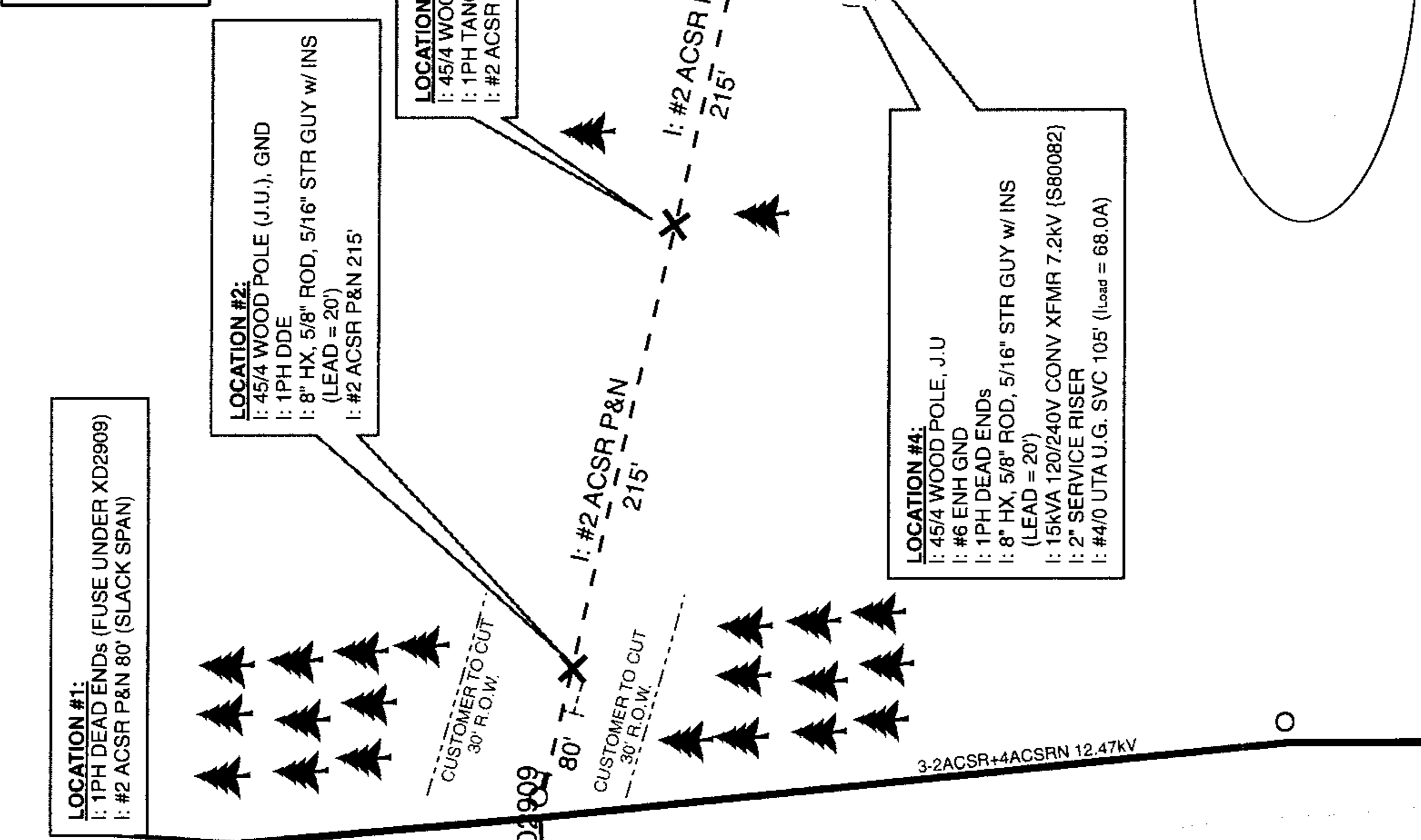

20110920000278470 4/4 \$21.50
Shelby Cnty Judge of Probate, AL
09/20/2011 01:17:35 PM FILED/CERT

- NOTES:**
- 1) WORK ORDER REQUIRED IN ORDER TO PROVIDE SINGLE-PHASE OH/UG SERVICE TO NEW CHURCH PAVILION.
 - 2) POLES SIZED FOR FUTURE THREE-PHASE TO CHAPEL. FUTURE PLANS ALSO INCLUDE BALL FIELDS AND AN AMPHITHEATRE IN ADDITION TO A FUTURE HOME.
 - 3) CUSTOMER CONTACT: JIMMY DYKUS @ 205-639-8906.
 - 4) MARKETING REP: JEANNE GALLAGHER @ 205-226-1041.
 - 5) APCO TO BILL CUSTOMER \$3508.00 FOR UNDERGROUND AND OUT-OF-RATIO CHARGES.
 - 6) PER LEGISLATION, NO CIAC/TVM CHARGED DUE TO WORK BEING COMPLETED IN THE YEAR 2011.