

## EASEMENT - DISTRIBUTION FACILITIES

\$ 500.00

STATE OF ALABAMA }

COUNTY OF Shelby }W.E. No. A6170-00-BV10APCO Parcel No. 70232279

Transformer No. \_\_\_\_\_

This instrument prepared by: Larry D. GravittAlabama Power Company  
P. O. Box 2641  
Birmingham, Alabama 35291

Shelby County, AL 07/19/2010

State of Alabama

Deed Tax : \$.50

20100719000229610 1/3 \$18.50  
Shelby Cnty Judge of Probate, AL  
07/19/2010 03:09:04 PM FILED/CERTA. GRANT KNOW ALL MEN BY THESE PRESENTS, That Douglas Yates and wife Alice Yates

as grantor (s), (the "Grantor", whether one or more) for and in consideration of One and No/100 (\$1.00) and other good and valuable consideration, to Grantor in hand paid by Alabama Power Company, a corporation, the receipt and sufficiency of which are hereby acknowledged, does hereby grant to Alabama Power Company, its successors and assigns (the "Company"), the easements, rights and privileges described and designated in Section B below.

B. RIGHTS The easements, rights and privileges granted hereby are as follows:

1. **Overhead and/or Underground.** The right from time to time to construct, install, operate and maintain, upon, over, under and across the Property described in Section C below, along a route selected by the Company which is generally shown on the Company's drawing, attached hereto and made a part hereof, (which shows the general location of underground Facilities, if any, by indicating an area not greater than ten feet (10') in width), all poles, towers, wires, conduits, fiber optics, cables, communication lines, translosures, transformers, anchors, guy wires and other Facilities useful or necessary in connection therewith (collectively, "Facilities"), for the overhead and/or underground transmission and distribution of electric power, and communication, and also the right to clear and keep clear a strip of land extending five feet (5') to each side of the center line of underground Facilities and fifteen feet (15') to each side of the center line of overhead Facilities; further, the right in the future to install and utilize intermediate poles in line for overhead Facilities and the right to trim and cut and keep trimmed and cut all dead, weak, leaning or dangerous trees or limbs outside of the thirty foot (30') strip for overhead Facilities that, in the sole opinion of the Company, might now or may hereafter endanger, interfere with or fall upon any of the overhead Facilities.

2. **Line Clearing.** The right to trim and cut and keep trimmed and cut all dead, weak, leaning or dangerous trees or limbs that, in the sole opinion of the Company, might now or may hereafter endanger, interfere with or fall upon the electric transmission or distribution lines, poles, towers or other Facilities now or hereafter located adjacent to the Property described in Section C below along said route as selected by the Company generally shown on said drawing, and also the right to clear and keep clear all trees, undergrowth, and other obstructions on property in which Grantor has an interest within fifteen feet (15') of the center line of the lines of such poles, towers or other Facilities.

3. **Guy Wires and Anchors.** The right to implant, install and maintain anchor(s) of concrete, metal or other material on and under the Property described in Section C below, and to construct, extend and maintain guy wires from such anchor(s) to structures now or hereafter erected adjacent to such Property or property adjacent thereto (collectively, "Guy Wire Facilities") along said route selected by the Company generally shown on said drawing; and also the right to trim and cut and keep trimmed and cut all dead, weak, leaning or dangerous trees or limbs that, in the sole opinion of the Company, might now or may hereafter endanger, interfere with or fall upon any of the Guy Wire Facilities.

Grantor hereby grants to the Company all easements, rights and privileges necessary or convenient for the full enjoyment and use thereof, including without limitation the right of ingress and egress to and from the Facilities and Guy Wire Facilities, as applicable, and the right to excavate for installation, replacement, repair and removal thereof; and also the right to cut, remove and otherwise keep clear any and all structures, obstructions or obstacles of whatever character, on, under and above said Facilities and Guy Wire Facilities, as applicable.

C. PROPERTY DESCRIPTION. The easements, rights and privileges granted hereby shall apply to, and the word "Property" as used in this instrument shall mean, the following described real property situated in Shelby County, Alabama (the "Property"):A parcel of land in the West 1/2 of the NE 1/4 of Section 5,Township 21 South, Range 3 West as is recorded in Deed Record20070919000438740 in the office of the Judge of Probate ofShelby County, Alabama. Lot #4 of Survey of Fox Valley HighlandsMap Book 39, Pages 14A-14B, Judge of Probate Shelby County, Ala.

D. ADDITIONAL PROVISIONS. In the event it becomes necessary or desirable for the Company to move any of the Facilities in connection with the construction or improvement of any public road or highway in proximity to the Facilities, Grantor hereby grants to the Company the right to relocate the Facilities and, as to such relocated Facilities, to exercise the rights granted above; provided, however, the Company shall not relocate the Facilities on the Property at a distance greater than ten feet (10') outside the boundary of the right of way of any such public road or highway as established or re-established from time to time. This grant and agreement shall be binding upon and shall inure to the benefit of Grantor, the Company and each of their respective heirs, personal representatives, successors and assigns and the words "Company" and "Grantor" as used in this instrument shall be deemed to include the heirs, personal representatives, successors and assigns of such parties.

TO HAVE AND TO HOLD the same to the Company, its successors and assigns, forever.

IN WITNESS WHEREOF, the undersigned Grantor(s) ~~has~~ have set ~~his~~ their hand(s) and seal(s) this the 6-21-10 day of June, 2010.

Shelita Renee Nedrick  
Witness

Shelita Renee Nedrick  
Witness

\_\_\_\_\_  
Witness

Douglas W. Yates (SEAL)  
(Grantor)

Alice Yates (SEAL)  
(Grantor)

By: \_\_\_\_\_ (SEAL)  
As: \_\_\_\_\_

**For Alabama Power Company Corporate Real Estate Department Use Only**All facilities on Grantor: X

Station to Station: \_\_\_\_\_

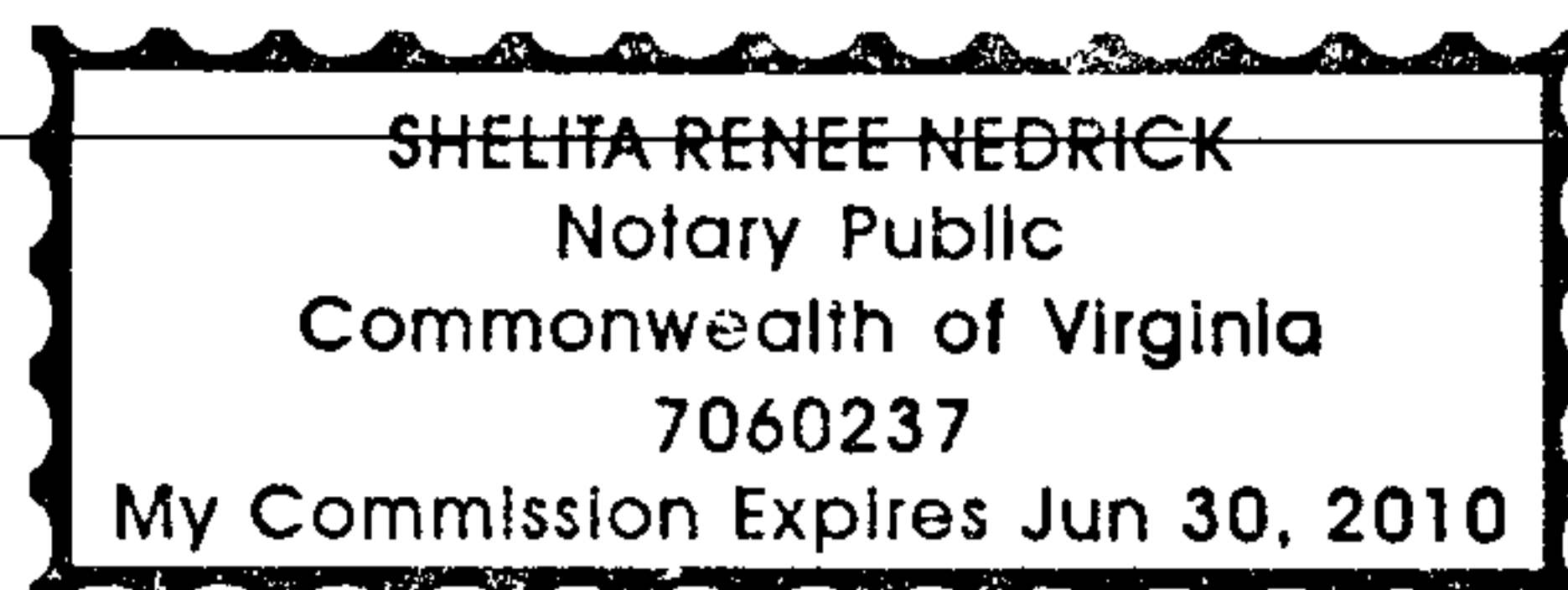



IN WITNESS WHEREOF, the said Grantor, has caused this instrument to be executed by \_\_\_\_\_ its authorized representative, as of the \_\_\_\_\_ day of \_\_\_\_\_, 20\_\_\_\_.

ATTEST (if corporation) or WITNESS:

\_\_\_\_\_  
(Grantor - Name of Corporation/Partnership/LLC)

By: \_\_\_\_\_  
Its: \_\_\_\_\_

By: \_\_\_\_\_(SEAL)  
Its: \_\_\_\_\_

[indicate President, General Partner, Member, etc.]

**INDIVIDUAL NOTARIES**

STATE OF ALABAMA }  
COUNTY OF \_\_\_\_\_ }

I, the undersigned, a Notary Public, in and for said County in said State, hereby certify that \_\_\_\_\_ whose name(s) is/are signed to the foregoing instrument and who is/are known to me, acknowledged before me on this day that being informed of the contents of the instrument, he/she/they executed the same voluntarily, on the day the same bears date.

Given under my hand and official seal this the \_\_\_\_\_ day of \_\_\_\_\_, 20\_\_\_\_.

[SEAL]

\_\_\_\_\_  
Notary Public  
My commission expires: \_\_\_\_\_

STATE OF ALABAMA }  
COUNTY OF \_\_\_\_\_ }

I, the undersigned, a Notary Public, in and for said County in said State, hereby certify that \_\_\_\_\_ whose name(s) is/are signed to the foregoing instrument and who is/are known to me, acknowledged before me on this day that being informed of the contents of the instrument, he/she/they executed the same voluntarily, on the day the same bears date.

Given under my hand and official seal this the \_\_\_\_\_ day of \_\_\_\_\_, 20\_\_\_\_.

[SEAL]

\_\_\_\_\_  
Notary Public  
My commission expires: \_\_\_\_\_

**TRUSTEE/CORPORATION/PARTNERSHIP/LLC NOTARY**

STATE OF ALABAMA }  
COUNTY OF \_\_\_\_\_ }

I, the undersigned, a Notary Public, in and for said County in said State, hereby certify that \_\_\_\_\_, whose name as \_\_\_\_\_ of \_\_\_\_\_ a \_\_\_\_\_, is signed to the foregoing instrument, and who is known to me, acknowledged before me on this day that being informed of the contents of the instrument, he/she, as such \_\_\_\_\_ and with full authority, executed the same voluntarily for and as the act of said \_\_\_\_\_ [acting in such capacity as aforesaid].

Given under my hand and official seal, this the \_\_\_\_\_ day of \_\_\_\_\_, 20\_\_\_\_.

[SEAL]

\_\_\_\_\_  
Notary Public  
My commission expires: \_\_\_\_\_

Customer	Division	Location	Agreed Serv. Date	County	Section	Township	Range	Add'l Info	Estimate No.
DOUG VETTES	313 FOX VALLEY HIGHLAND DR	7-14-10	SHENLEY	5	315	03W	X	X093A3	AL17D - 00BV1D
Division	Operation	Town	Engineer	LINC#	Date	Substation	X	Y	LOC
313 FOX VALLEY HIGHLAND DR	Operation - SOUTH	ALABASTER	R. PHILLIPS	17064	6-15-10	ELLIOTTSVILLE #3	48476	X093A3	Transformer Loading
NJUNS Ticket #									

SHEET 1 OF 2

\*APPROXIMATE TO TRENCH  
48" DEEP END INSTALL  
CONDUCTOR.

SHORT CIRCUITS	
30 - G=	
0 - G= 8014	
0 - G Res= 659	
ENERGIZED LINE WORK	
SUB ELLIOTTSVILLE #2	
OCB/OCR# 06038	
SWITCH# X093A3	
FUSE SIZE 50 A	

"MISS-ALL" # 1-800-292-8525	
DATE CALLED	
LOCATION REQUEST #	
WATER WORKS	
DATE CALLED	
TRANSFER OF ATTACHMENTS	
OTHER	YES NO
KNOWLEDGE	
CHARTER	
OTHER	
ACCESSIBLE Heavy Traffic SW Amp	
TREE CREW	
PERMITS REQD	
R/W	
CITY	
COUNTY	
STATE	
OTHER	

target  
**ZERO**  
ONE DAY AT A TIME  
PERFORM  
JSA

SCALE	NTS
Ft. Per Inch	

20100719000229610 3/3 \$18.50  
Shelby Cnty Judge of Probate, AL  
07/19/2010 03:09:04 PM FILED/CERT

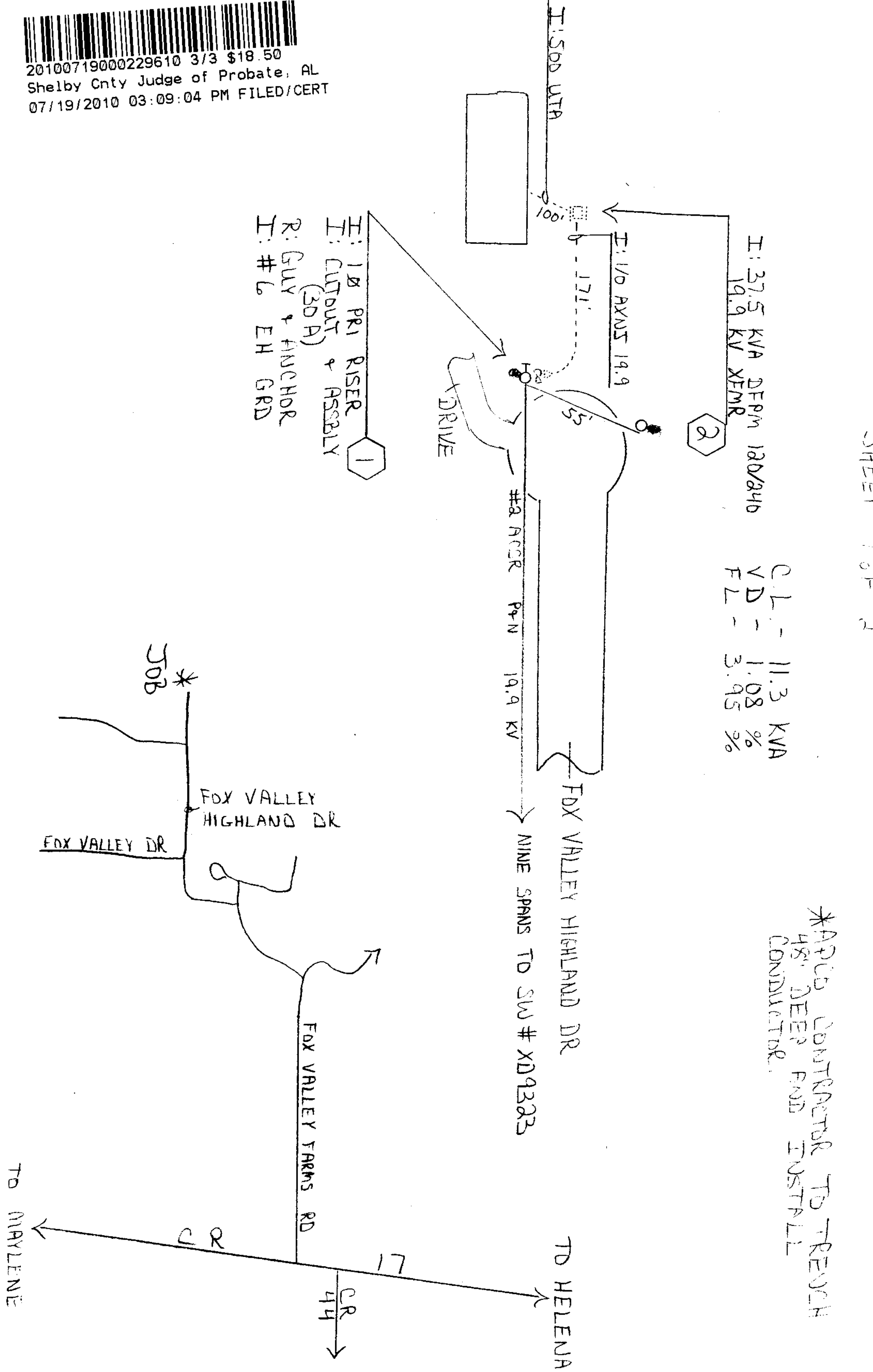

Cnst. Completed By

Date