

ORDINANCE NO. 2009-10-06-164

WHEREAS, on the 6th day of October, 2009, Jordy's Developments, LLC, filed a petition with the Town of Westover, Alabama, as required by §§ 11-42-20 and 11-42-21, Code of Alabama 1975, as amended, petitioning and requesting that the property hereinafter described be annexed to the municipality of the Town of Westover, Alabama, which petition contained an accurate description of the property proposed to be annexed together with a map of the said property showing its relationship to the corporate limits of the Town of Westover, Alabama, and the signatures of the owners of the property described were signed thereto;

NOW, THEREFORE, BE IT ORDAINED BY THE TOWN COUNCIL OF THE TOWN OF WESTOVER, ALABAMA, AS FOLLOWS:

1. That the Town of Westover, Alabama, does adopt this Ordinance assenting to the annexation of the following described property to the municipality of the Town of Westover:

Lots 1 through 4, 6 through 19, and 21 through 23 of Yellow Leaf Farms, as recorded in Map Book 39, Page 134, in the Probate Office of Shelby County, Alabama

2. That the corporate limits of the Town of Westover, Alabama, be extended and rearranged so as to embrace and include such property, and such property shall become a part of the corporate area of such municipality upon the date of publication or posting of this Ordinance, as provided for in the Code of Alabama as cited above.

3. That the Town Clerk be and he is hereby authorized and directed to file a copy of this Ordinance, including an accurate description of the property being annexed, together with a map of the said property showing its relationship to the corporate limits of the Town of Westover, Alabama, to which said property is being annexed, in the office of the Judge of Probate of Shelby County, Alabama.

4. That the Zoning Map of the Town of Westover, Alabama, and any other official maps or surveys of the Town shall be amended to reflect the annexation of the above-described property, and that a copy of this Ordinance be transmitted to the Town Planning Commission.

5. That this property is temporarily zoned AP as provided in the Zoning Ordinance of the Town of Westover, Alabama.



20100224000056000 1/7 \$29.00
Shelby Cnty Judge of Probate, AL
02/24/2010 04:03:14 PM FILED/CERT

This ordinance was adopted and passed by the Town Council of the Town of Westover, Alabama, this the 6th day of October, 2009.

Town of Westover, Alabama

by



Mayor

Attest:

Wayne Jones
Clerk



20100224000056000 2/7 \$29.00
Shelby Cnty Judge of Probate, AL
02/24/2010 04:03:14 PM FILED/CERT

STATE OF ALABAMA

COUNTY OF SHELBY

I, Wayne Jones, hereby certify that I am Clerk of the Town of Westover, Alabama; that I have in my possession the books and records of such municipality, including the minute book in which are recorded the minutes of the meetings of the Town Council thereof, and that the foregoing is a true and correct copy of Ordinance No. 2009-10-06-164 of such council and was duly and legally adopted by it on the 6th day of October, 2009, and that such ordinance has been duly recorded in the Ordinance Book kept for that purpose by such municipality.

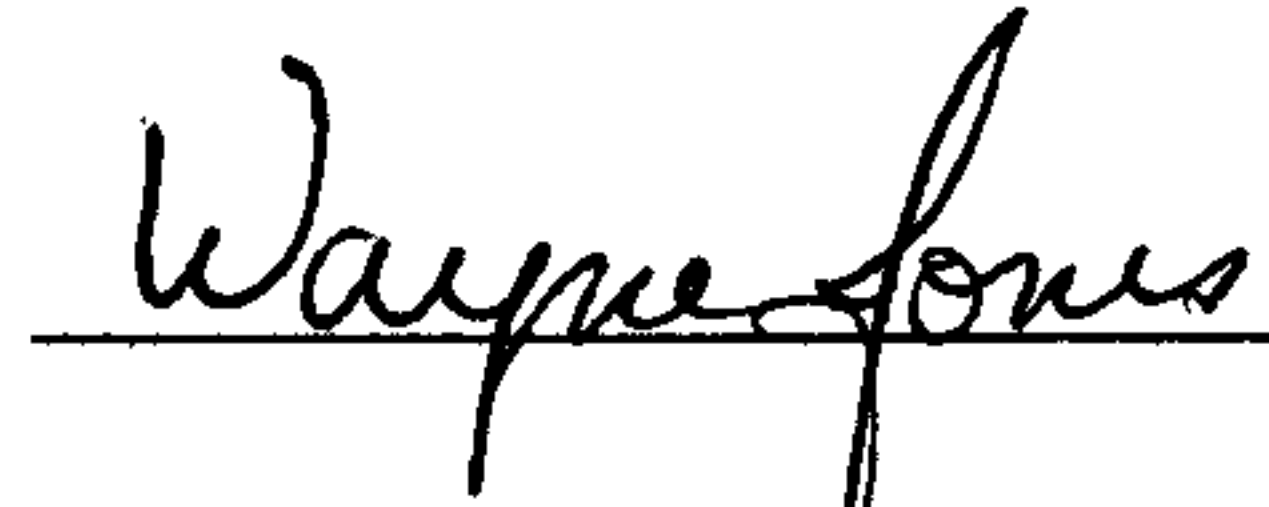
IN WITNESS WHEREOF, I hereunto affix my signature as Clerk of the Town of Westover, Alabama, and the seal thereof, on this the 6th day of October, 2009.

Wayne Jones, Clerk



20100224000056000 3/7 \$29.00
Shelby Cnty Judge of Probate, AL
02/24/2010 04:03:14 PM FILED/CERT

PETITION FOR ANNEXATION TOWN OF WESTOVER, AL.

The undersigned owner(s) of the property described below, which is described in the attached "Exhibit A" and is contiguous to the corporate limits of Westover, Alabama do hereby petition the town of Westover to annex said property into the corporate limits of the municipality.

Name: BRYAN SHANIHAN (Jordy Development)
Property Address: Lots 1,2,3,4,6,7,8,9,10,11,12,13,14,15,16,17,18,19, 21,22,23
City/State/Zip Code: Yellow Leaf Farms, Hwy 51 Wilsonville, AL 35186
Telephone Number: 205-437-2706
Parcel ID Number: See attached
(As listed on property tax notice)
Number of registered voters residing at this Parcel _____

SIGNATURE OF PROPERTY OWNER(S)

(All owners listed on the deed must sign)

Bryan Shanahan

PLEASE RETURN COMPLETED PETITION IMMEDIATELY TO THE PERSON
PROVIDING THE PETITION, OR MAIL TO:
WESTOVER ANNEXATION COMMITTEE • P.O. BOX 356 • WESTOVER, AL
35185 Phone 678-3376



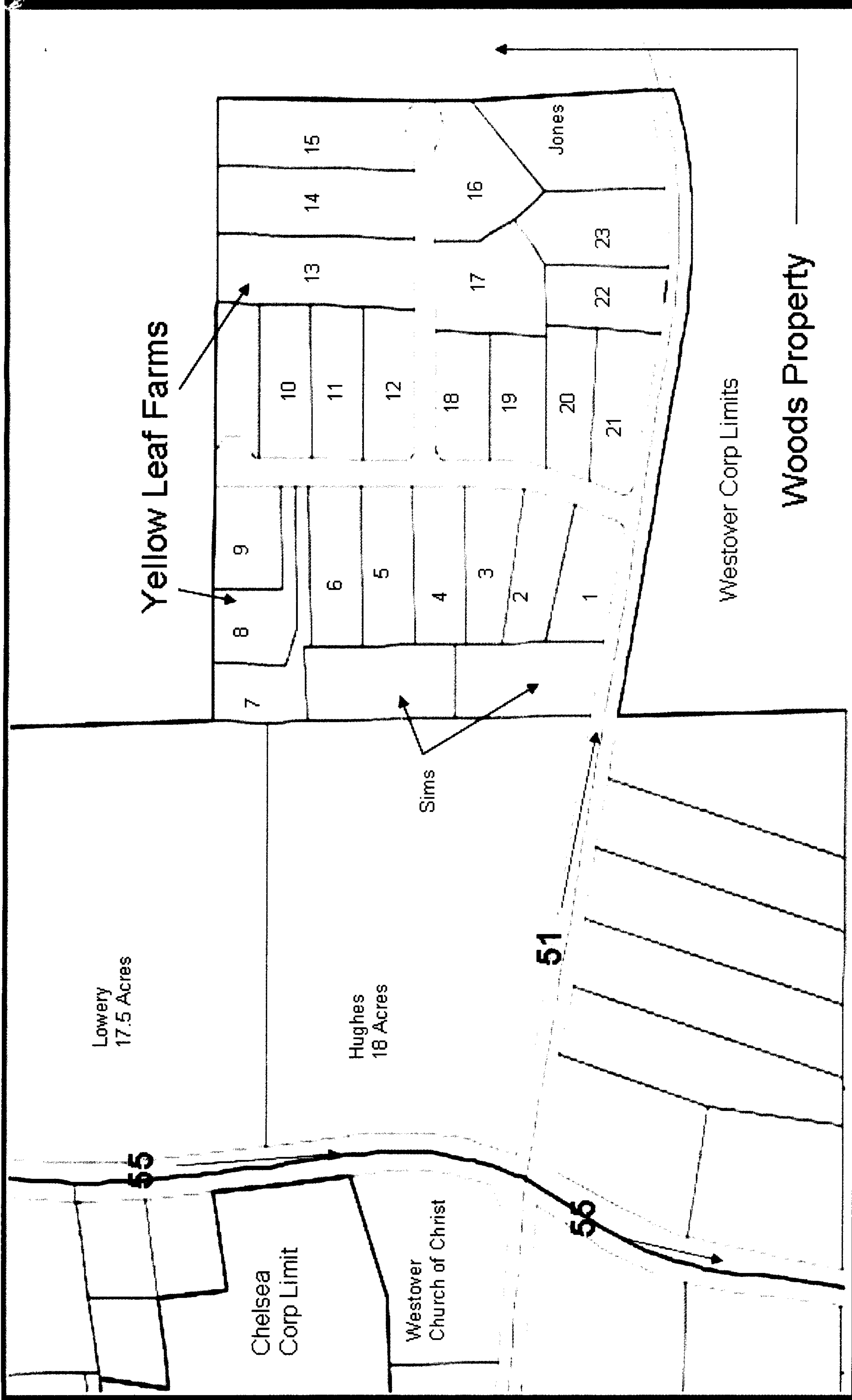

20100224000056000 5/7 \$29.00
Shelby Cnty Judge of Probate, AL
02/24/2010 04:03:14 PM FILED/CERT

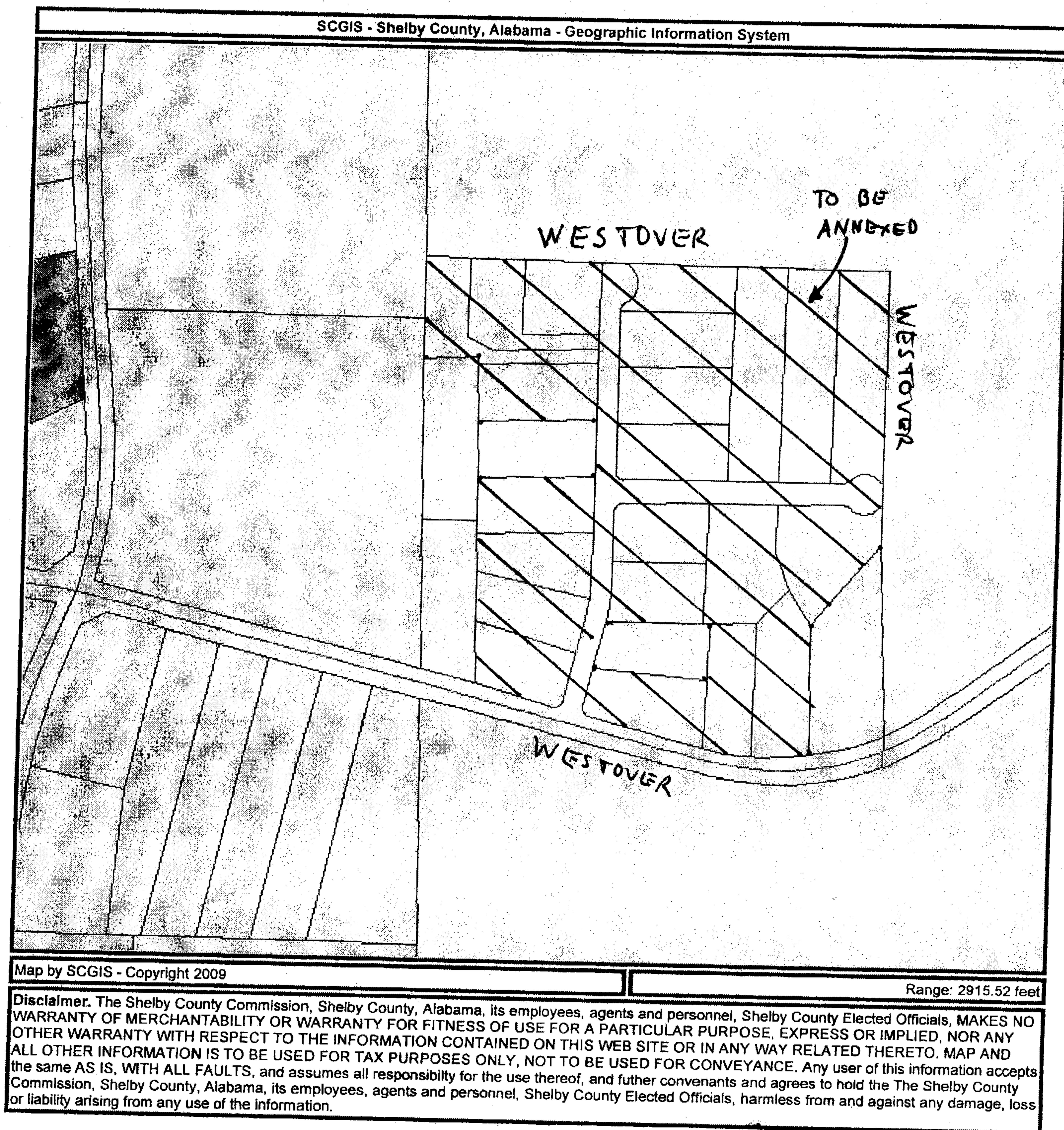

To Be Annexed



20100224000056000 6/7 \$29.00
Shelby Cnty Judge of Probate, AL
02/24/2010 04:03:14 PM FILED/CERT

Yellow Leaf Farms
Jordy's Development LLC

Lot #	Parcel Number
1	16-2-04-0-000-011.000
2	16-2-04-0-000-011.004
3	16-2-04-0-000-011.005
4	16-2-04-0-000-011.006
5	not in annexation
6	16-2-04-0-000-011.008
7	16-2-04-0-000-011.009
8	16-2-04-0-000-011.010
9	16-2-04-0-000-011.011
10	16-2-04-0-000-011.012
11	16-2-04-0-000-011.013
12	16-2-04-0-000-011.014
13	16-2-04-0-000-011.015
14	16-2-04-0-000-011.016
15	16-2-04-0-000-011.017
16	16-2-04-0-000-011.018
17	16-2-04-0-000-011.019
18	16-2-04-0-000-011.020
19	16-2-04-0-000-011.021
20	not in annexation
21	16-2-04-0-000-011.023
22	16-2-04-0-000-011.003
23	16-2-04-0-000-011.002
	16-2-04-0-000-999.999



20100224000056000 7/7 \$29.00
Shelby Cnty Judge of Probate, AL
02/24/2010 04:03:14 PM FILED/CERT