

EASEMENT - DISTRIBUTION FACILITIES

STATE OF ALABAMA }

COUNTY OF SHELBY }

W.E. No. A6170-06-B209

APCO Parcel No. 70227459

Transformer No. S17510

This instrument prepared by: Jeff J. Callicott

Alabama Power Company  
P. O. Box 2641  
Birmingham, Alabama 35291

Shelby County, AL 12/14/2009

State of Alabama

Deed Tax : \$.50



20091214000457740 1/3 \$17.50  
Shelby Cnty Judge of Probate, AL  
12/14/2009 01:21:37 PM FILED/CERT

A. GRANT KNOW ALL MEN BY THESE PRESENTS, That Jones Commercial Properties, LLC

as grantors (s), (the "Grantor", whether one or more) for and in consideration of One and No/100 (\$1.00) and other good and valuable consideration, to Grantor in hand paid by Alabama Power Company, a corporation, the receipt and sufficiency of which are hereby acknowledged, does hereby grant to Alabama Power Company, its successors and assigns (the "Company"), the easements, rights and privileges described and designated in Section B below.

B. RIGHTS The easements, rights and privileges granted hereby are as follows:

1. **Overhead and/or Underground.** The right from time to time to construct, install, operate and maintain, upon, over, under and across the Property described in Section C below, along a route selected by the Company which is generally shown on the Company's drawing, attached hereto and made a part hereof, (which shows the general location of underground Facilities, if any, by indicating an area not greater than ten feet (10') in width), all poles, towers, wires, conduits, fiber optics, cables, trans closures, transformers, anchors, guy wires and other Facilities useful or necessary in connection therewith (collectively, "Facilities"), for the overhead and/or underground transmission and distribution of electric power, and also the right to clear and keep clear a strip of land extending five feet (5') to each side of the center line of underground Facilities and fifteen feet (15') to each side of the center line of overhead Facilities; further, the right in the future to install and utilize intermediate poles in line for overhead Facilities and the right to trim and cut and keep trimmed and cut all dead, weak, leaning or dangerous trees or limbs outside of the thirty foot (30') strip for overhead Facilities that, in the sole opinion of the Company, might now or may hereafter endanger, interfere with or fall upon any of the overhead Facilities.

2. **Line Clearing.** The right to trim and cut and keep trimmed and cut all dead, weak, leaning or dangerous trees or limbs that, in the sole opinion of the Company, might now or may hereafter endanger, interfere with or fall upon the electric transmission or distribution lines, poles, towers or other Facilities now or hereafter located adjacent to the Property described in Section C below along said route as selected by the Company generally shown on said drawing, and also the right to clear and keep clear all trees, undergrowth, and other obstructions on property in which Grantor has an interest within fifteen feet (15') of the center line of the lines of such poles, towers or other Facilities.

3. **Guy Wires and Anchors.** The right to implant, install and maintain anchor(s) of concrete, metal or other material on and under the Property described in Section C below, and to construct, extend and maintain guy wires from such anchor(s) to structures now or hereafter erected adjacent to such Property or property adjacent thereto (collectively, "Guy Wire Facilities") along said route selected by the Company generally shown on said drawing; and also the right to trim and cut and keep trimmed and cut all dead, weak, leaning or dangerous trees or limbs that, in the sole opinion of the Company, might now or may hereafter endanger, interfere with or fall upon any of the Guy Wire Facilities.

Grantor hereby grants to the Company all easements, rights and privileges necessary or convenient for the full enjoyment and use thereof, including without limitation the right of ingress and egress to and from the Facilities and Guy Wire Facilities, as applicable, and the right to excavate for installation, replacement, repair and removal thereof; and also the right to cut, remove and otherwise keep clear any and all structures, obstructions or obstacles of whatever character, on, under and above said Facilities and Guy Wire Facilities, as applicable.

C. **PROPERTY DESCRIPTION.** The easements, rights and privileges granted hereby shall apply to, and the word "Property" as used in this instrument shall mean, the following described real property situated in Shelby County, Alabama (the "Property"):

A parcel of land in the SW1/4 of the SE1/4 of Section 17, Township 19 South, Range 01 West, as recorded in Deed Record 20091012000384690, on October 12, 2009, in the office of the Judge of Probate, Shelby County, Alabama.

Tax ID 09-4-17-0-001-027.000

D. **ADDITIONAL PROVISIONS.** In the event it becomes necessary or desirable for the Company to move any of the Facilities in connection with the construction or improvement of any public road or highway in proximity to the Facilities, Grantor hereby grants to the Company the right to relocate the Facilities and, as to such relocated Facilities, to exercise the rights granted above; provided, however, the Company shall not relocate the Facilities on the Property at a distance greater than ten feet (10') outside the boundary of the right of way of any such public road or highway as established or re-established from time to time. This grant and agreement shall be binding upon and shall inure to the benefit of Grantor, the Company and each of their respective heirs, personal representatives, successors and assigns and the words "Company" and "Grantor" as used in this instrument shall be deemed to include the heirs, personal representatives, successors and assigns of such parties.

TO HAVE AND TO HOLD the same to the Company, its successors and assigns, forever.

IN WITNESS WHEREOF, the undersigned Grantor(s) has/have set his/her/their hand(s) and seal(s) this the \_\_\_\_\_ day of \_\_\_\_\_, 20\_\_\_\_\_.

Witness

Witness

Witness

(Grantor)

(Grantor)

By:

As:

Jones Commercial Properties, LLC

(Grantor)

By:

As:

For Alabama Power Company Corporate Real Estate Department Use Only

All facilities on Grantor: \_\_\_\_\_

Station to Station: STA 4+50 TO STA 5+100 STA 5+100 TO STA 9+00



IN WITNESS WHEREOF, the said Grantor, has caused this instrument to be executed by \_\_\_\_\_ its authorized representative, as of the \_\_\_\_\_ day of \_\_\_\_\_, 20\_\_\_\_\_.

ATTEST (if corporation) or WITNESS:

(Grantor - Name of Corporation/Partnership/LLC)

By: \_\_\_\_\_  
Its: \_\_\_\_\_

By: \_\_\_\_\_ (SEAL)  
Its: \_\_\_\_\_

[indicate President, General Partner, Member, etc.]

INDIVIDUAL NOTARIES

STATE OF ALABAMA }  
COUNTY OF \_\_\_\_\_ }

I, the undersigned, a Notary Public, in and for said County in said State, hereby certify that \_\_\_\_\_ whose name(s) is/are signed to the foregoing instrument and who is/are known to me, acknowledged before me on this day that being informed of the contents of the instrument, he/she/they executed the same voluntarily, on the day the same bears date.

Given under my hand and official seal this the \_\_\_\_\_ day of \_\_\_\_\_, \_\_\_\_\_.

[SEAL]

Notary Public  
My commission expires: \_\_\_\_\_

STATE OF ALABAMA }  
COUNTY OF \_\_\_\_\_ }

I, the undersigned, a Notary Public, in and for said County in said State, hereby certify that \_\_\_\_\_ whose name(s) is/are signed to the foregoing instrument and who is/are known to me, acknowledged before me on this day that being informed of the contents of the instrument, he/she/they executed the same voluntarily, on the day the same bears date.

Given under my hand and official seal this the \_\_\_\_\_ day of \_\_\_\_\_, \_\_\_\_\_.

[SEAL]

Notary Public  
My commission expires: \_\_\_\_\_

TRUSTEE/CORPORATION/PARTNERSHIP/LLC NOTARY

STATE OF ALABAMA }  
COUNTY OF Shelby }

I, the undersigned, a Notary Public, in and for said County in said State, hereby certify that Butch Jones \_\_\_\_\_, whose name as \_\_\_\_\_ of **Jones Commercial Properties, LLC** \_\_\_\_\_ a \_\_\_\_\_, is signed to the foregoing instrument, and who is known to me, acknowledged before me on this day that being informed of the contents of the instrument, he/she, as such \_\_\_\_\_ and with full authority, executed the same voluntarily for and as the act of said \_\_\_\_\_ [acting in such capacity as aforesaid].

Given under my hand and official seal, this the 27 day of November, 2009

[SEAL]

Copel Oakley  
Notary Public  
My commission expires: MY COMMISSION EXPIRES NOVEMBER 15, 2013



20091214000457740 3/3 \$17.50  
Shelby Cnty Judge of Probate, AL  
12/14/2009 01:21:37 PM FILED/CERT

70227A60  
76227A59

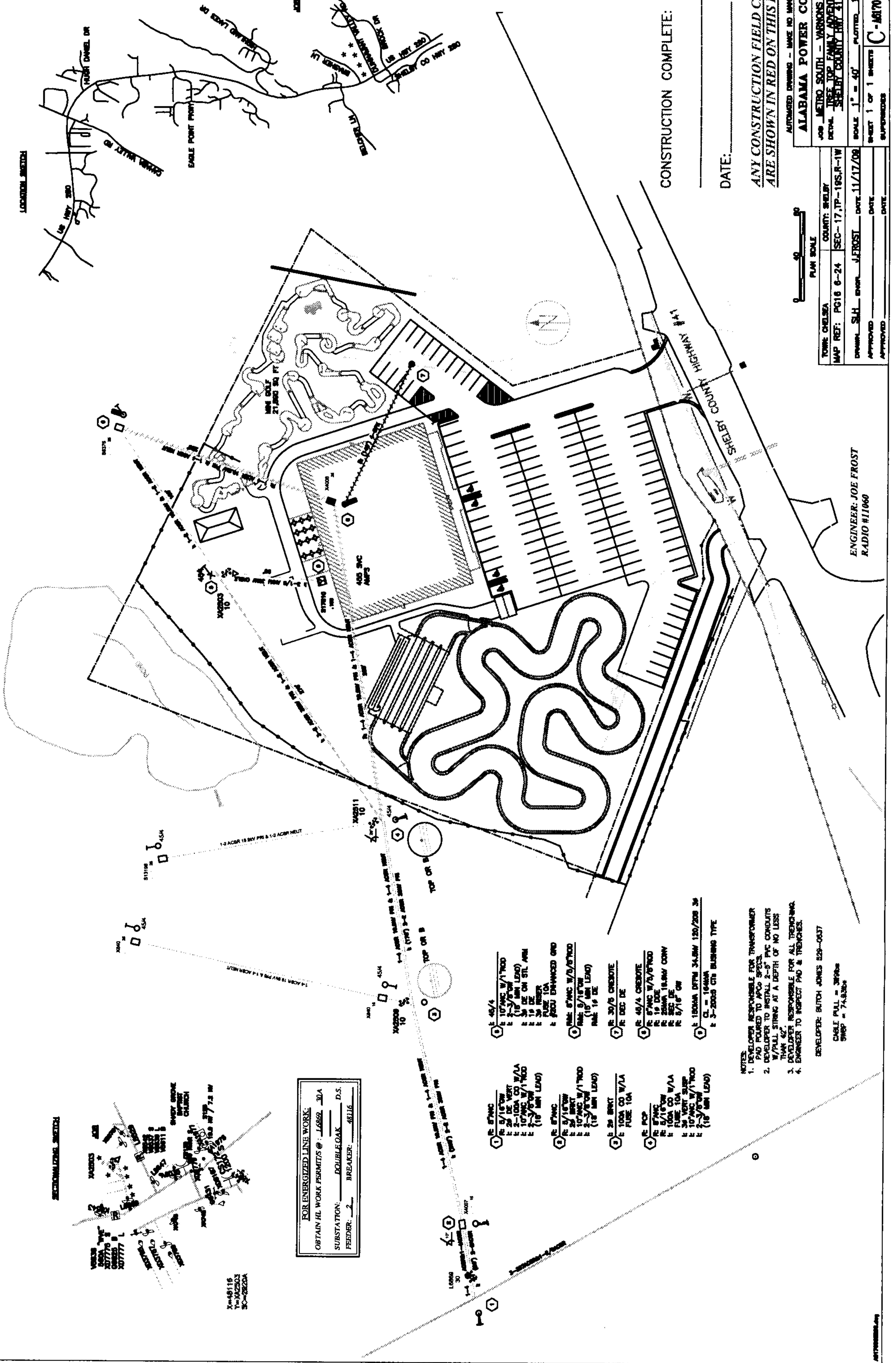

SECTIONAL VIEW SHEET



FOR ENERGIZED LINE WORK:  
OBTAIN HL WORK PERMITS @ L6669 30A  
SUBSTATION: DOUBLE OAK D.S.  
FEEDER: 2 BREAKER: 48116

- 1. DEVELOPER RESPONSIBLE FOR TRANSFORMER PAD POURED TO APD SPEC.
  - 2. DEVELOPER TO INSTALL 2-8" PVC CONDUITS W/PULL STRING AT A DEPTH OF NO LESS THAN 42"
  - 3. DEVELOPER RESPONSIBLE FOR ALL TRENCHING
  - 4. ENGINEER TO INSPECT PAD & TRENCHES
- DEVELOPER: BUTCH JONES 628-0037  
CABLE PULL = 30'00"  
SWAP = 74.8200

CONSTRUCTION COMPLETE:

DATE:

ANY CONSTRUCTION FIELD CHANGES ARE SHOWN IN RED ON THIS PRINT.

PLAN SCALE

ALABAMA POWER COMPANY

TOWN: CHELSEA	COUNTY: SHELBY	JOB: METRO SOUTH - VARNOS
MAP REF: PG18 6-24	SEC-17, TP-19S, R-1W	DETAIL: 10' X 10' PLAN & ELEVATION
DRAWN: SH	DATE: 11/17/09	SCALE: 1" = 40'
APPROVED:	DATE:	SHEET 1 OF 1 SHEETS
		SUPPLEMENT: C-M170-068200

ENGINEER: JOE FROST  
RADIO #11060