

## EASEMENT - DISTRIBUTION FACILITIES

\$ 500.00

STATE OF ALABAMA }

COUNTY OF SHELBY }W.E. No. AG170-05-A209APCO Parcel No. 70222957

Transformer No. \_\_\_\_\_

This instrument prepared by: JEFF CALLICOTTAlabama Power Company  
P. O. Box 2641  
Birmingham, Alabama 35291

Shelby County, AL 07/01/2009

State of Alabama

Deed Tax : \$.50

20090701000253280 1/2 \$14.50  
Shelby Cnty Judge of Probate, AL  
07/01/2009 10:51:27 AM FILED/CERTA. GRANT KNOW ALL MEN BY THESE PRESENTS, That NATHANIEL BRANTLEY, SOLE OWNER,

as grantors (s), (the "Grantor", whether one or more) for and in consideration of One and No/100 (\$1.00) and other good and valuable consideration, to Grantor in hand paid by Alabama Power Company, a corporation, the receipt and sufficiency of which are hereby acknowledged, does hereby grant to Alabama Power Company, its successors and assigns (the "Company"), the easements, rights and privileges described and designated in Section B below.

B. RIGHTS The easements, rights and privileges granted hereby are as follows:

1. **Overhead and/or Underground.** The right from time to time to construct, install, operate and maintain, upon, over, under and across the Property described in Section C below, along a route selected by the Company which is generally shown on the Company's drawing, attached hereto and made a part hereof, (which shows the general location of underground Facilities, if any, by indicating an area not greater than ten feet (10') in width), all poles, towers, wires, conduits, fiber optics, cables, trans closures, transformers, anchors, guy wires and other Facilities useful or necessary in connection therewith (collectively, "Facilities"), for the overhead and/or underground transmission and distribution of electric power, and also the right to clear and keep clear a strip of land extending five feet (5') to each side of the center line of underground Facilities and fifteen feet (15') to each side of the center line of overhead Facilities; further, the right in the future to install and utilize intermediate poles in line for overhead Facilities and the right to trim and cut and keep trimmed and cut all dead, weak, leaning or dangerous trees or limbs outside of the thirty foot (30') strip for overhead Facilities that, in the sole opinion of the Company, might now or may hereafter endanger, interfere with or fall upon any of the overhead Facilities.2. **Line Clearing.** The right to trim and cut and keep trimmed and cut all dead, weak, leaning or dangerous trees or limbs that, in the sole opinion of the Company, might now or may hereafter endanger, interfere with or fall upon the electric transmission or distribution lines, poles, towers or other Facilities now or hereafter located adjacent to the Property described in Section C below along said route as selected by the Company generally shown on said drawing, and also the right to clear and keep clear all trees, undergrowth, and other obstructions on property in which Grantor has an interest within fifteen feet (15') of the center line of the lines of such poles, towers or other Facilities.3. **Guy Wires and Anchors.** The right to implant, install and maintain anchor(s) of concrete, metal or other material on and under the Property described in Section C below, and to construct, extend and maintain guy wires from such anchor(s) to structures now or hereafter erected adjacent to such Property or property adjacent thereto (collectively, "Guy Wire Facilities") along said route selected by the Company generally shown on said drawing; and also the right to trim and cut and keep trimmed and cut all dead, weak, leaning or dangerous trees or limbs that, in the sole opinion of the Company, might now or may hereafter endanger, interfere with or fall upon any of the Guy Wire Facilities.

Grantor hereby grants to the Company all easements, rights and privileges necessary or convenient for the full enjoyment and use thereof, including without limitation the right of ingress and egress to and from the Facilities and Guy Wire Facilities, as applicable, and the right to excavate for installation, replacement, repair and removal thereof; and also the right to cut, remove and otherwise keep clear any and all structures, obstructions or obstacles of whatever character, on, under and above said Facilities and Guy Wire Facilities, as applicable.

C. **PROPERTY DESCRIPTION.** The easements, rights and privileges granted hereby shall apply to, and the word "Property" as used in this instrument shall mean, the following described real property situated in SHELBY County, Alabama (the "Property"):A PARCEL OF LAND LOCATED IN THE SE 1/4 OF THE SE 1/4 OF SEC. 11, TP 20S, R 3W, AND  
RECORDED IN DEED RECORD 20061102000541250, ON JANUARY DEC. 27 2006, IN  
THE OFFICE OF THE JUDGE OF PROBATE, SHELBY CO., ALA.  
TAX ID 13-1-11-4-004-041-003D. **ADDITIONAL PROVISIONS.** In the event it becomes necessary or desirable for the Company to move any of the Facilities in connection with the construction or improvement of any public road or highway in proximity to the Facilities, Grantor hereby grants to the Company the right to relocate the Facilities and, as to such relocated Facilities, to exercise the rights granted above; provided, however, the Company shall not relocate the Facilities on the Property at a distance greater than ten feet (10') outside the boundary of the right of way of any such public road or highway as established or re-established from time to time. This grant and agreement shall be binding upon and shall inure to the benefit of Grantor, the Company and each of their respective heirs, personal representatives, successors and assigns and the words "Company" and "Grantor" as used in this instrument shall be deemed to include the heirs, personal representatives, successors and assigns of such parties.

TO HAVE AND TO HOLD the same to the Company, its successors and assigns, forever.

IN WITNESS WHEREOF, the undersigned Grantor(s) has/have set his/her/their hand(s) and seal(s) this the 3 day of June, 2009.

Witness

(Grantor)

(SEAL)

Witness

(Grantor)

(SEAL)

Witness

By:

(SEAL)

As:

For Alabama Power Company Corporate Real Estate Department Use Only

All facilities on Grantor: \_\_\_\_\_

Station to Station: \_\_\_\_\_

SKETCH OF PROPOSED WORK - SIMPLIFIED W.E.

Map Center UTM: 1696883.1710641812089769.3511021

Map Center LatLong: 33.303681 -86.815123

1 inch = 63 feet

10222451

Customer Riverpoint First Assembly of God	Location 375 Bearden Rd	Cnted. Svc Date	County Shelby	Section 11	Township 20S	Range 03W	Add'l Info.	Estimate No. A6170-05AZ09
Division PD BIRMINGHAM	District METRO SOUTH	Town PELHAM	UserID dpnoah	Created: 6/22/2009	Substation X- 39814			MISSALL# 091700978 CLR: 6-23-09 4:30 PM EXP: 7-07-09 SEWER&WATER

SHORT CIRCUITS  
3 PH = 0A  
PH-G = 2781A  
PH-G RES = 721A



ENERGIZED LINE WORK  
Sub HELENA DS  
OCB/OCR#RC7164 (560A WVE)  
Switch# L6181  
Fuse Size 100A

Loc 1	Transformer Loading
----------	---------------------

Voltage

Pri 34.5  
Sec 120/240  
kV

Phone Co. Y

Cable Co. Y

MISSALL Y

Accessible Y

Tree Crew N

Rock Hole N

Permits

RW Y

CITY N

COUNTY N

STATE N

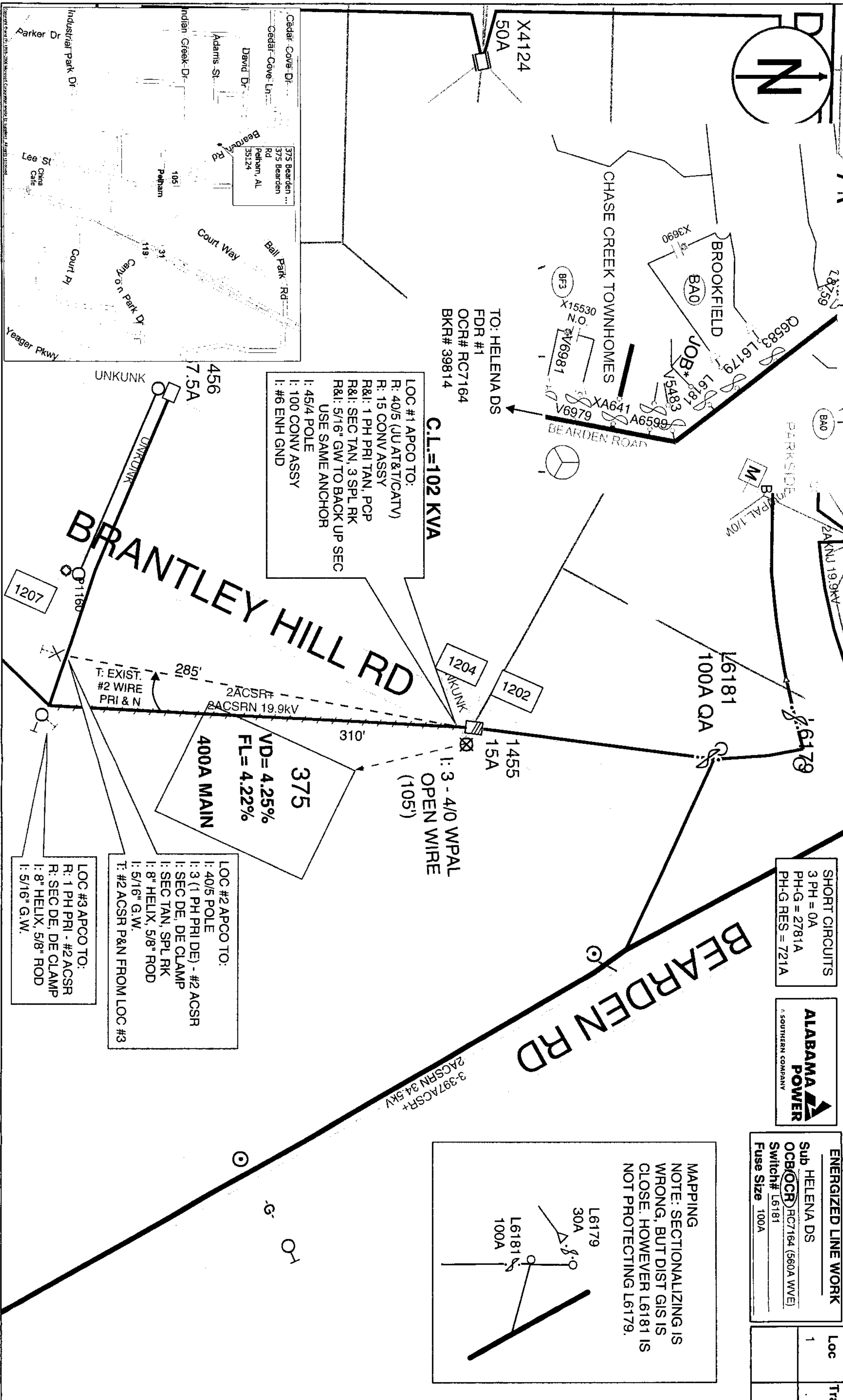
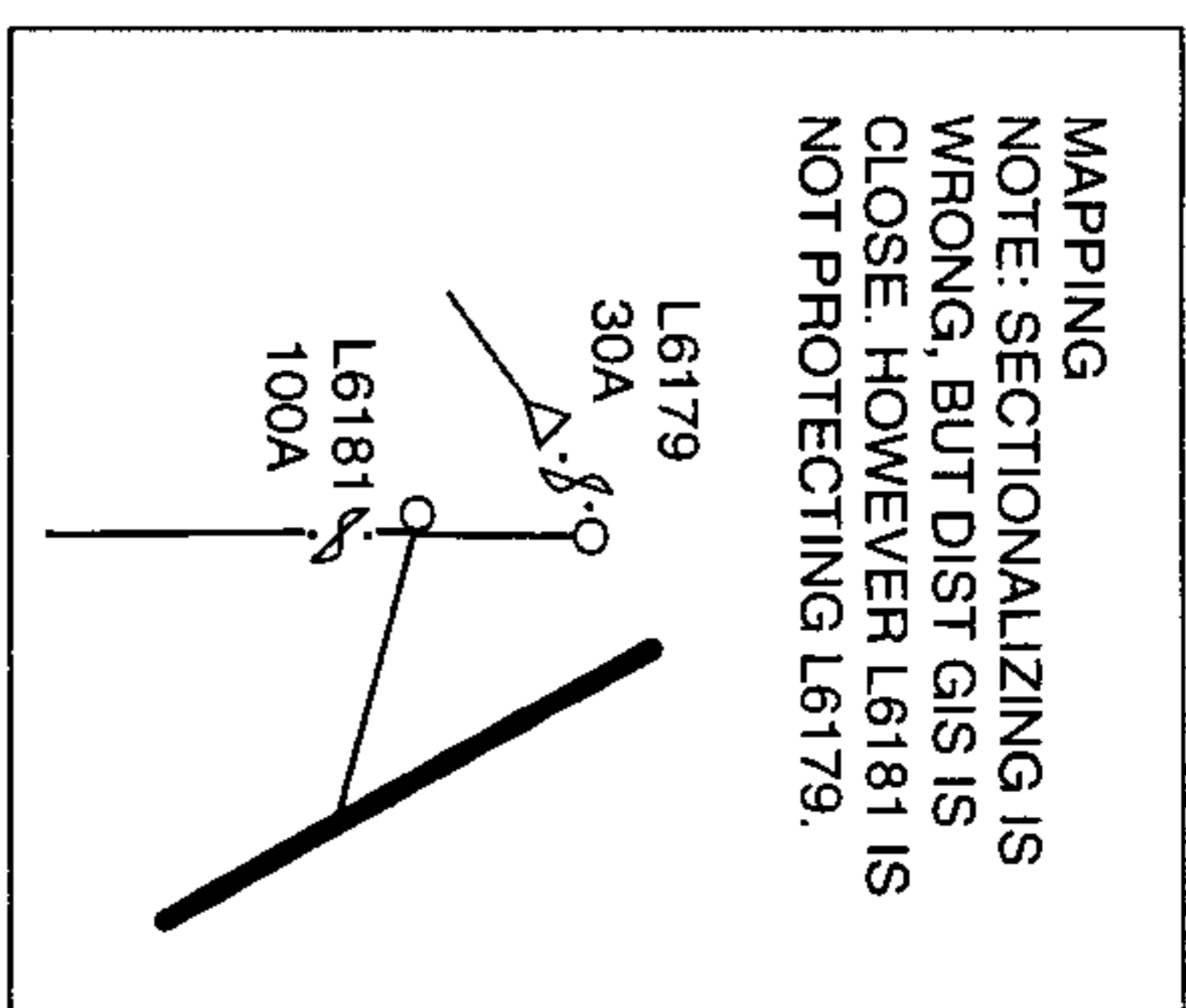

LOC #1 APCO TO:  
R: 40/5 (JUT&TCATV)  
R: 15 CONV ASSY  
R&L: 1 PH PRI TAN, PCP  
R&L: SEC TAN, 3 SPL RK  
R&L: 5/16" GW TO BACK UP SEC  
USE SAME ANCHOR  
I: 45/4 POLE  
I: 100 CONV ASSY  
I: #6 ENH GND

LOC #2 APCO TO:  
I: 40/5 POLE  
I: 3 (1 PH PRI DE) - #2 ACSR  
I: SEC DE, DE CLAMP  
I: SEC TAN, SPL RK  
I: 8" HELIX, 5/8" ROD  
I: 5/16" G.W.  
T: #2 ACSR P&N FROM LOC #3

LOC #3 APCO TO:  
R: 1 PH PRI - #2 ACSR  
R: SEC DE, DE CLAMP  
I: 8" HELIX, 5/8" ROD  
I: 5/16" G.W.

STATE	N
COUNTY	N
CITY	N
RW	Y
Permits	
Rock Hole	N
Tree Crew	N
Accessible	Y
MISSALL	Y
Cable Co.	Y
Phone Co.	Y
Pri	34.5
Sec	120/240
kV	



20090701000253280 2/2 \$14.50  
Shelby Cnty Judge of Probate, AL  
07/01/2009 10:51:27 AM FILED/CERT