

EASEMENT - DISTRIBUTION FACILITIES (Metes and Bounds)

TO BE RECORDED: YES X NO

This instrument prepared by:

STATE OF ALABAMA }
COUNTY OF Shelby }
TAX ID # _____

W.E. No. 61700-00-0401-800
Parcel No. 70217981
Transformer No. _____

Alabama Power Company
P. O. Box 2641
Birmingham, Alabama 35291

A. GRANT KNOW ALL MEN BY THESE PRESENTS, That Chris Solter and wife Hanna Solter

as grantors (s), (the "Grantor", whether one or more) for and in consideration of One and No/100 (\$1.00) and other good and **valuable** consideration, to Grantor in hand paid by Alabama Power Company, a corporation, the receipt and sufficiency of which are hereby acknowledged, does hereby grant to Alabama Power Company, its successors and assigns (the "Company"), the easements, rights and privileges described and designated in Section B below.

B. RIGHTS The easements, rights and privileges granted hereby are as follows:

1. **Overhead and/or Underground.** The right from time to time to construct, install, operate and maintain, upon, over, under and across the Property described in Section C below, along a route to be selected by the Company which is generally shown on the Company's final location drawing (which shows the general location of underground Facilities, if any, by indicating an area not greater than ten feet (10') in width), all poles, towers, wires, conduits, fiber optics, cables, trans closures, transformers, anchors, guy wires and other Facilities useful or necessary in connection therewith (collectively, "Facilities"), for the overhead and/or underground transmission and distribution of electric power, and also the right to clear and keep clear a strip of land extending five feet (5') to either side of the center line of underground Facilities and fifteen feet (15') to either side of the center line of overhead Facilities; further, the right in the future to install and utilize intermediate poles in line for overhead Facilities and the right to trim and cut and keep trimmed and cut all dead, weak, leaning or dangerous trees or limbs outside of the thirty foot (30') strip for overhead Facilities that, in the sole opinion of the Company, might now or may hereafter endanger, interfere with or fall upon any of the overhead Facilities.
2. **Line Clearing.** The right to trim and cut and keep trimmed and cut all dead, weak, leaning or dangerous trees or limbs that, in the sole opinion of the Company, might now or may hereafter endanger, interfere with or fall upon the electric transmission or distribution lines, poles, towers or other Facilities now or hereafter located adjacent to the Property described in Section C below along a route to be selected by the Company generally shown on the Company's final location drawing, and also the right to clear and keep clear all trees, undergrowth, and other obstructions on property in which Grantor has an interest within fifteen feet (15') of the center line of the lines of such poles, towers or other Facilities.
3. **Guy Wires and Anchors.** The right to implant, install and maintain anchor(s) of concrete, metal or other material on and under the Property described in Section C below, and to construct, extend and maintain guy wires from such anchor(s) to structures now or hereafter erected adjacent to such Property or property adjacent thereto (collectively, "Guy Wire Facilities") along a route to be selected by the Company generally shown on the Company's final location drawing; and also the right to trim and cut and keep trimmed and cut all dead, weak, leaning or dangerous trees or limbs that, in the sole opinion of the Company, might now or may hereafter endanger, interfere with or fall upon any of the Guy Wire Facilities.

Grantor hereby grants to the Company all easements, rights and privileges necessary or convenient for the full enjoyment and use thereof, including without limitation the right of ingress and egress to and from the Facilities and Guy Wire Facilities, as applicable, and the right to excavate for installation, replacement, repair and removal thereof; and also the right to cut, remove and otherwise keep clear any and all structures, obstructions or obstacles of whatever character, on, under and above said Facilities and Guy Wire Facilities, as applicable.

C. PROPERTY DESCRIPTION The easements, rights and privileges granted hereby shall apply to, and the word "Property" as used in this instrument shall mean, the following described real property, situated in Shelby County, Alabama (the "Property"):

See EXHIBIT "A" attached hereto and made a part hereof for a legal description of the property involved.

D. ADDITIONAL PROVISIONS. In the event it becomes necessary or desirable for the Company to move any of the Facilities in connection with the construction or improvement of any public road or highway in proximity to the Facilities, Grantor hereby grants to the Company the right to relocate the Facilities and, as to such relocated Facilities, to exercise the rights granted above; provided, however, the Company shall not relocate the Facilities on the Property at a distance greater than ten feet (10') outside the boundary of the right of way of any such public road or highway as established or re-established from time to time. This grant and agreement shall be binding upon and shall inure to the benefit of Grantor, the Company and each of their respective heirs, personal representatives, successors and assigns and the words "Company" and "Grantor" as used in this instrument shall be deemed to include the heirs, personal representatives, successors and assigns of such parties.

TO HAVE AND TO HOLD the same to the Company, its successors and assigns, forever.

IN WITNESS WHEREOF, the undersigned Grantor(s) has/have set his/her/their hand(s) and seal(s) this the 12th day of December, 2008.

Witness

(Grantor)

(SEAL)

Witness

(Grantor)

(SEAL)

Witness

By: _____

As:

(SEAL)



20090127000025820 1/5 \$23.50
Shelby Cnty Judge of Probate,AL
01/27/2009 11:59:49AM FILED/CERT

IN WITNESS WHEREOF, the said Grantor, has caused this instrument to be executed by _____ is authorized
representative, as of the _____ day of _____, 20_____.

ATTEST (if corporation) or WITNESS:

(Grantor - Name of Corporation/Partnership/LLC)
By: _____ (SEAL)
Its: _____
[indicate President, General Partner, Member, etc.]

INDIVIDUAL NOTARIES

STATE OF ALABAMA }
COUNTY OF Shelby }

I, the undersigned, a Notary Public, in and for said County in said State, hereby certify that Chris Salter and wife Hanna Salter
whose name(s) ~~is~~ are signed to the foregoing instrument and who ~~is~~ are known to me, acknowledged before me on
this day that being informed of the contents of the instrument, ~~he~~ ~~she~~ they executed the same voluntarily, on the day the same bears date.
Given under my hand and official seal this the 12th day of December, 2008.

[Signature]
Notary Public
My commission expires: 2-6-10

[SEAL]

STATE OF ALABAMA }
COUNTY OF _____ }

I, the undersigned, a Notary Public, in and for said County in said State, hereby certify that _____
whose name(s) is/are signed to the foregoing instrument and who is/are known to me, acknowledged before me on
this day that being informed of the contents of the instrument, he/she/they executed the same voluntarily, on the day the same bears date.
Given under my hand and official seal this the _____ day of _____, _____.

Notary Public
My commission expires: _____

[SEAL]

TRUSTEE/CORPORATION/PARTNERSHIP/LLC NOTARY

STATE OF ALABAMA }
COUNTY OF _____ }

I, the undersigned, a Notary Public, in and for said County in said State, hereby certify that _____
whose name as _____ of _____
a _____ [as _____]
], is signed to the foregoing instrument, and who is known to me, acknowledged before me on this day that
being informed of the contents of the instrument, he/she, as such _____ and with full authority, executed the same voluntarily for and as the
act of said _____ [acting in such capacity as aforesaid].

Given under my hand and official seal, this the _____ day of _____, _____.

Notary Public
My commission expires: _____

[SEAL]

For Alabama Power Company Corporate Real Estate Department Use Only

All facilities on Grantor: X Station to Station: _____

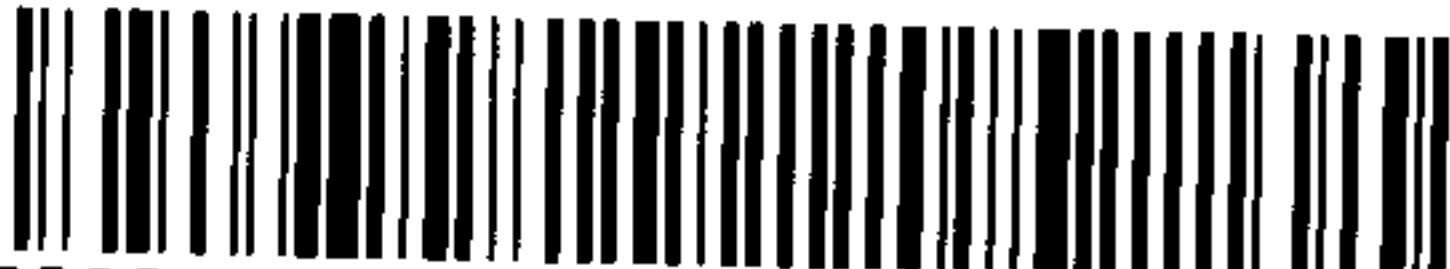

20090127000025820 2/5 \$23.50
Shelby Cnty Judge of Probate, AL
01/27/2009 11:59:49AM FILED/CERT

That part of Lot 5, according to the Survey of Chelsea Estates, as recorded in Map Book 5, Page 61; amended in Map Book 36, Page 57, in the Probate Office of Shelby County, Alabama, more particularly described as follows:

70217981

Commence at the NW corner of the NE quarter of the NW quarter of Section 35, Township 19 South, Range 1 West, Shelby County, Alabama; thence run Easterly along the Northern boundary line of said quarter-quarter section for a distance of 845.90 feet to the Southeast right of way line of the CSX railroad and the point of beginning; thence continue along last said course for a distance of 358.46 feet; thence run an angle of 112 degrees 41 minutes 41 seconds to the right and run a distance of 521.74 feet; thence turn an angle of 44 degrees 19 minutes 39 seconds to the left and run a distance of 244.85 feet to the North right of way line of Yellowleaf Circle and the point of curvature of a tangent curve, concave to the Southeast, having a radius of 45.00 feet, a central angle of 33 degrees 18 minutes 07 seconds, and a chord of 25.80 feet bearing South 82 degrees 47 minutes 01 seconds West; thence Southwesterly along said curve, a distance of 26.17 feet; thence turn an angle from the chord of 89 degrees 58 minutes and 12 seconds to the right and run 114.72 feet; thence turn an angle of 15 degrees 50 minutes 29 seconds to the right and run 99.78 feet; thence turn an angle of 24 degrees 06 minutes 00 seconds to the left and run 74.98 feet; thence turn an angle of 50 degrees 25 minutes 52 seconds to the left and run 84.89 feet; thence turn an angle of 16 degrees 06 minutes 53 seconds to the right and run 90.19 feet; thence turn an angle of 30 degrees 29 minutes 56 seconds to the right and run 205.94 feet; thence turn an angle of 45 degrees 10 minutes 42 seconds to the right and run 215.36 feet to the Southeast right of way line of the CSX Railroad; thence turn an angle of 70 degrees 56 minutes 01 seconds to the right and run 280.98 feet along said railroad right of way line to the point of beginning.

20090127000025820 3/5 \$23.50
Shelby Cnty Judge of Probate, AL
01/27/2009 11:59:49AM FILED/CERT

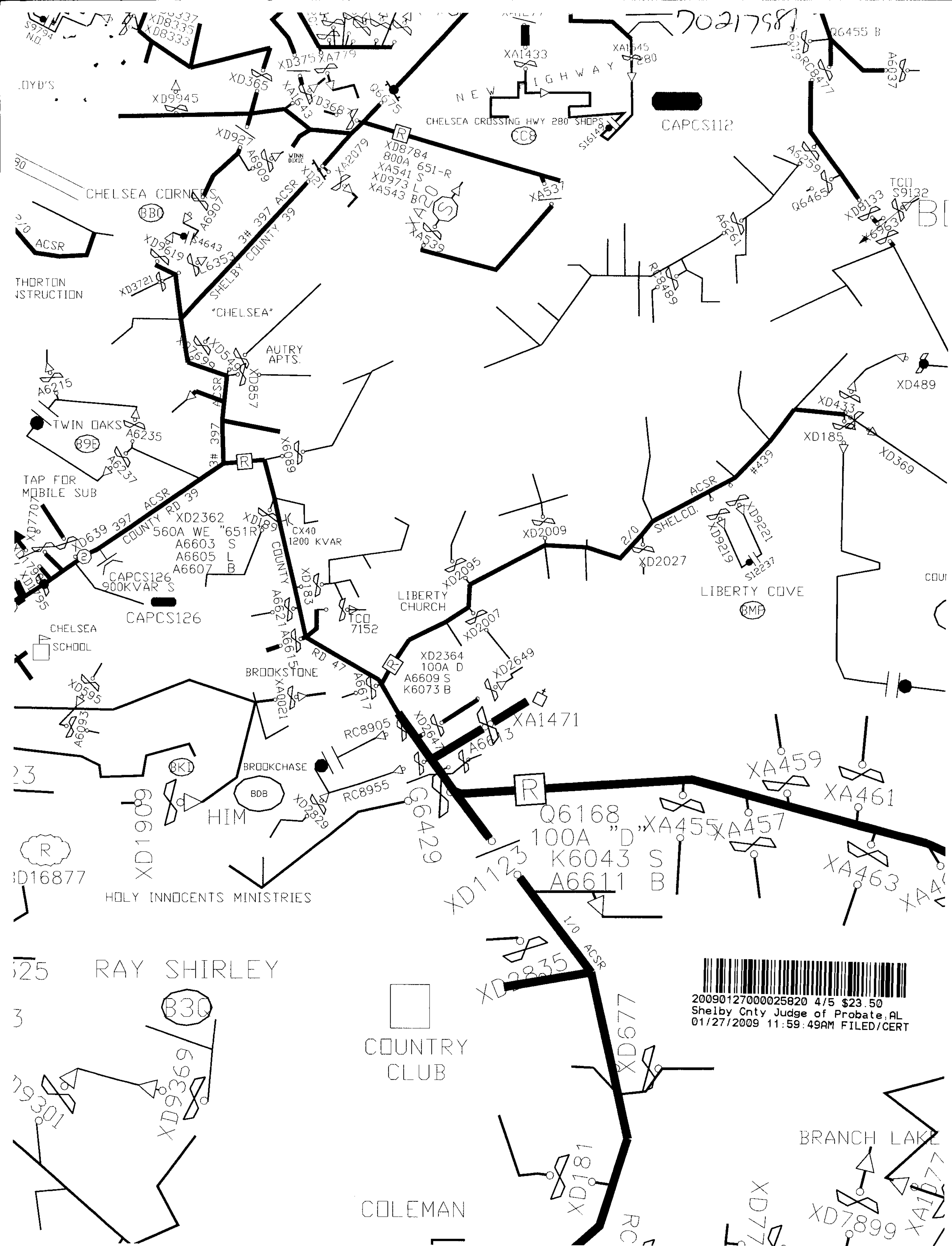

ALABAMA POWER

Customer	CHRIS SALTER		Location		84 YELLOW LEAF CIR		Agreed Serv. Date		County	Section	Township	Range	Add'l Info		Estimate No.	
Division	BIRMINGHAM		Operation		METRO - SOUTH		Engineer		LINC#	Date	Substation	X	Y	NJUNS Ticket #	LDC	Transformer Loading
					CHELSEA		FROST		11060	12-1-08	CHELSEA		X02364			61700-00-04018

APCO CONTRACTOR TO PERFORM ALL TRENCHING
APCO TO BILL CUSTOMER PER CSP

Note: "Customers "Mr & Mrs Salter"
"twice" were asked several times if
the pole was on their property.
They said yes!
DGS 12/2/08 ✓

V.D = 2.95 %
FLICKER = 4.72 %
3.5 TOAD

SHORT CIRCUITS 3Ø - G= Ø - G= Ø - G Res=	ENERGIZED LINE WORK SUB _____ OCB/OCR# _____ SWITCH# _____ FUSE SIZE _____
---	--

"MISS-ALL" # 1-800-292-8525 DATE CALLED _____ LOCATION REQUEST # _____ WATER WORKS DATE CALLED _____	<table border="1" style="width: 100%; border-collapse: collapse;"> <tr> <th colspan="2">Voltage</th> </tr> <tr> <td>Pri</td> <td>Sec.</td> </tr> <tr> <td>7.2</td> <td>120</td> </tr> <tr> <td>KV</td> <td>MVA</td> </tr> </table> <table border="1" style="width: 100%; border-collapse: collapse;"> <tr> <td>PHONE CO.</td> <td></td> </tr> <tr> <td>Co. Name</td> <td></td> </tr> <tr> <td>CATV CO.</td> <td></td> </tr> <tr> <td>Co. Name</td> <td></td> </tr> <tr> <td>Accessible Heavy Traffic SW Amp</td> <td></td> </tr> <tr> <td>TREE CREW</td> <td></td> </tr> <tr> <td></td> <td></td> </tr> <tr> <td>PERMITS REQD</td> <td></td> </tr> <tr> <td>R/W</td> <td></td> </tr> <tr> <td>CITY</td> <td></td> </tr> <tr> <td>COUNTY</td> <td></td> </tr> <tr> <td>STATE</td> <td></td> </tr> <tr> <td>OTHER</td> <td></td> </tr> <tr> <td></td> <td></td> </tr> <tr> <td>SCALE</td> <td>N.T.S.</td> </tr> </table> <p style="text-align: right; margin-top: 0;">Ft. Per Inch</p>	Voltage		Pri	Sec.	7.2	120	KV	MVA	PHONE CO.		Co. Name		CATV CO.		Co. Name		Accessible Heavy Traffic SW Amp		TREE CREW				PERMITS REQD		R/W		CITY		COUNTY		STATE		OTHER				SCALE	N.T.S.
Voltage																																							
Pri	Sec.																																						
7.2	120																																						
KV	MVA																																						
PHONE CO.																																							
Co. Name																																							
CATV CO.																																							
Co. Name																																							
Accessible Heavy Traffic SW Amp																																							
TREE CREW																																							
PERMITS REQD																																							
R/W																																							
CITY																																							
COUNTY																																							
STATE																																							
OTHER																																							
SCALE	N.T.S.																																						



target
ZERO

ONE DAY AT A TIME

PERFORM JSA

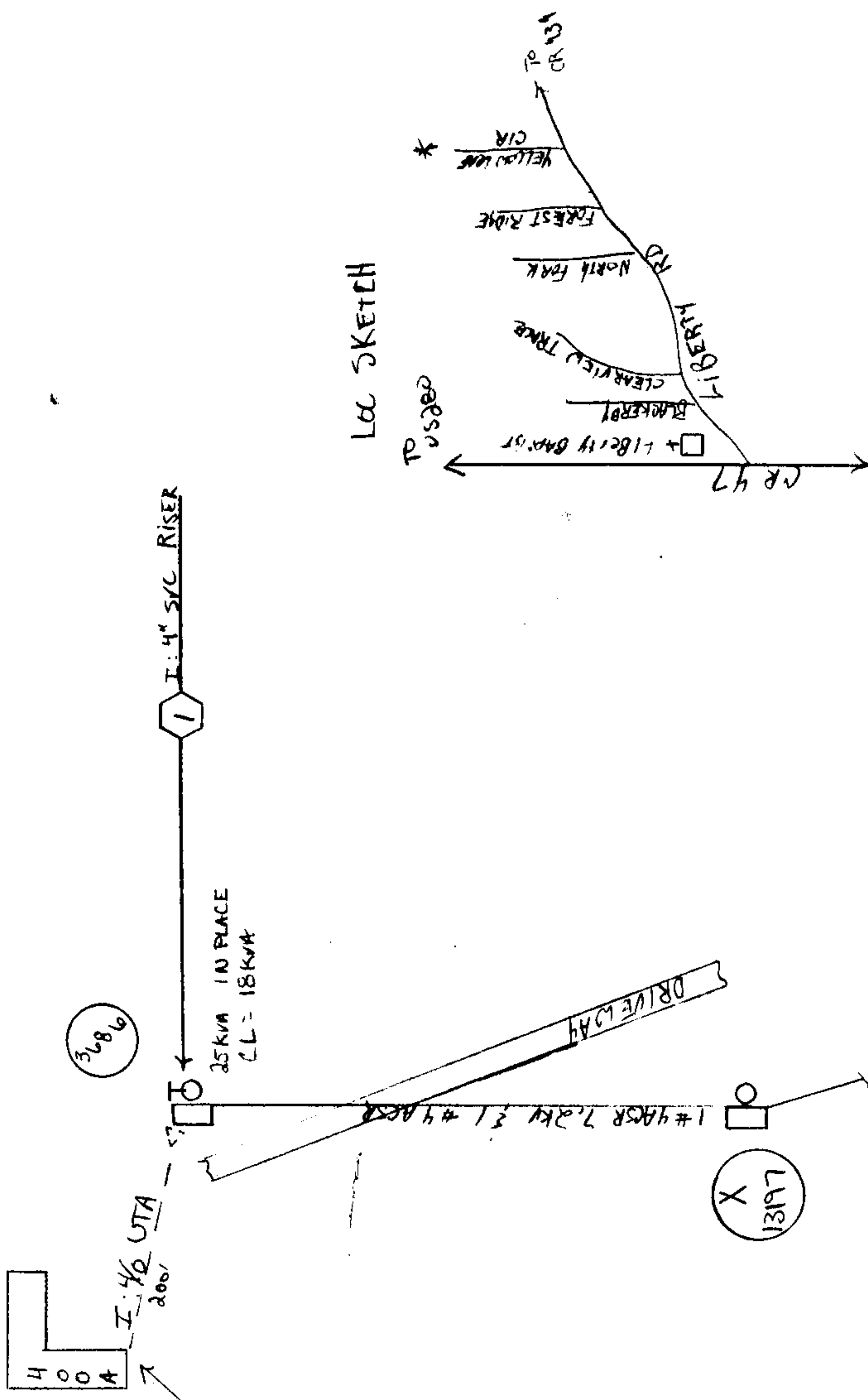

target
ZERO
ONE DAY AT A TIME

PERFORM
JSA

Cnst. Completed By



20090127000025820 5/5 \$23.50
Shelby Cnty Judge of Probate,AL
01/27/2009 11:59:49AM FILED/CERT