

Est. Value #500.00

STATE OF ALABAMA
COUNTY OF Chilton

8416-C-AL
(06-2007)

Preparer's name and address:

Becky Grinder

118 Cedar Cove Dr.

Pelham, AL. 35124

Grantee's Address:

BellSouth Telecommunications, Inc. d/b/a AT&T Alabama

3196 Highway 280

Room 102N

Birmingham, AL. 35243

EASEMENT

For and in consideration of one dollars (\$ 1.00) and other good and valuable consideration, the adequacy and receipt of which is hereby acknowledged, the undersigned owner(s) of the premises described below, (hereinafter referred to as "Grantor"), do(es) hereby grant to **BellSouth Telecommunications, Inc., a Georgia corporation, d/b/a AT&T Alabama**, and its parent and its and its parent's direct and indirect affiliates, subsidiaries, agents, attorneys, employees, officers, directors, servants, insurance carriers, licensees, successors, and assigns (hereinafter referred to as "Grantee"), an easement to construct, operate, maintain, add, and/or remove such systems of communications (including broadcast), facilities, standby generators and associated fuel supply systems as a means of providing uninterrupted service during commercial power outages, and related items as the Grantee may from time to time deem necessary in the conduct of its business upon, over, and under a portion of the lands described in Deed Book _____, page _____, Chilton County, Alabama Records, and, to the fullest extent the Grantor has the power to grant, upon, over, along, and under the roads, streets, or highways adjoining or through said property. The said easement is more particularly described as follows:

All that tract or parcel of land lying in Section 18, Township 24N, Range 13E, St. Stephens Meridian, Chilton County, State of Alabama, consisting of a (☒ strip) (☐ parcel) of land a strip 5 ft either side of buried cable running from Hwy 155 ROW approximately 250 ft. then aerial along APCO power poles throughout development as shown on attached drawings and hereby made a part of this document. (Attachment A 1-6).

The following rights are also granted: the exclusive right to allow any other person, firm, or corporation to attach wires or lay cable or conduit or other appurtenances upon, over, and under said easement for communications (including broadcast) or electric power transmission or distribution; ingress to and egress from said easement at all times; the right, but not the obligation, to clear the easement and keep it cleared of all trees, undergrowth, or other obstructions; the right, but not the obligation, to trim and cut and keep trimmed and cut all dead, weak, leaning, or dangerous trees or limbs outside the easement which might interfere with or fall upon the lines or systems of communication or power transmission or distribution; the right to relocate said facilities, systems of communications, or related services on said lands to conform to any future highway relocation, widening, or improvements, the right to test and maintain generators and associated equipment; and the right to allow any other person, firm, or corporation to provide for fuel/energy distribution to equipment placed on the site.

To have and to hold the above granted easement unto BellSouth Telecommunications, Inc. d/b/a AT&T Alabama, and its parent and its and its parent's direct and indirect affiliates, subsidiaries, agents, attorneys, employees, officers, directors, servants, insurance carriers, licensees, successors, and assigns forever and in perpetuity.

Grantor warrants that Grantor is the true owner of record of the above described land on which the aforesaid easement is granted.

PMT 84686



20080602000220500 2/8 \$35.00
Shelby Cnty Judge of Probate, AL
06/02/2008 09:47:22AM FILED/CERT

8416-I-AL
(06-2007)
Page 2

SPECIAL STIPULATIONS OR COMMENTS:

The following special stipulations shall control in the event of conflict with any of the foregoing easement:

In witness whereof, the undersigned has/have caused this instrument to be executed on the 21st day of May, 2008.

Signed, sealed and delivered in the presence of:

Witness
(Print Name) _____

James R Blackman L.S.
Grantor
(Print Name and Address) James Blackman - owner
25 County Rd
Montevallo, AL 35115

Witness
(Print Name) _____

Grantor
(Print Name and Address) _____

State of Alabama, County of Chilton

I, Rebecca A. Grinder, Notary Public in and for said County in Alabama,
hereby certify that James Blackman
whose name is signed to the foregoing conveyance, and who is known to me, acknowledged before me on this day, that
being informed of the contents of the conveyance, he/she executed the same voluntarily on the day the same bears date.

Witness my hand and official seal in the County and State last aforesaid this 21st day of May, 2008.

Rebecca A. Grinder
Notary Public
(Print Name) Rebecca Grinder

My Commission Expires: 8/22/11

TO BE COMPLETED BY GRANTEE

District	FRC	Wire Center/NXX	Authority
Drawing	Area Number	Plat Number	RWID
Parcel ID	Approval	Title	

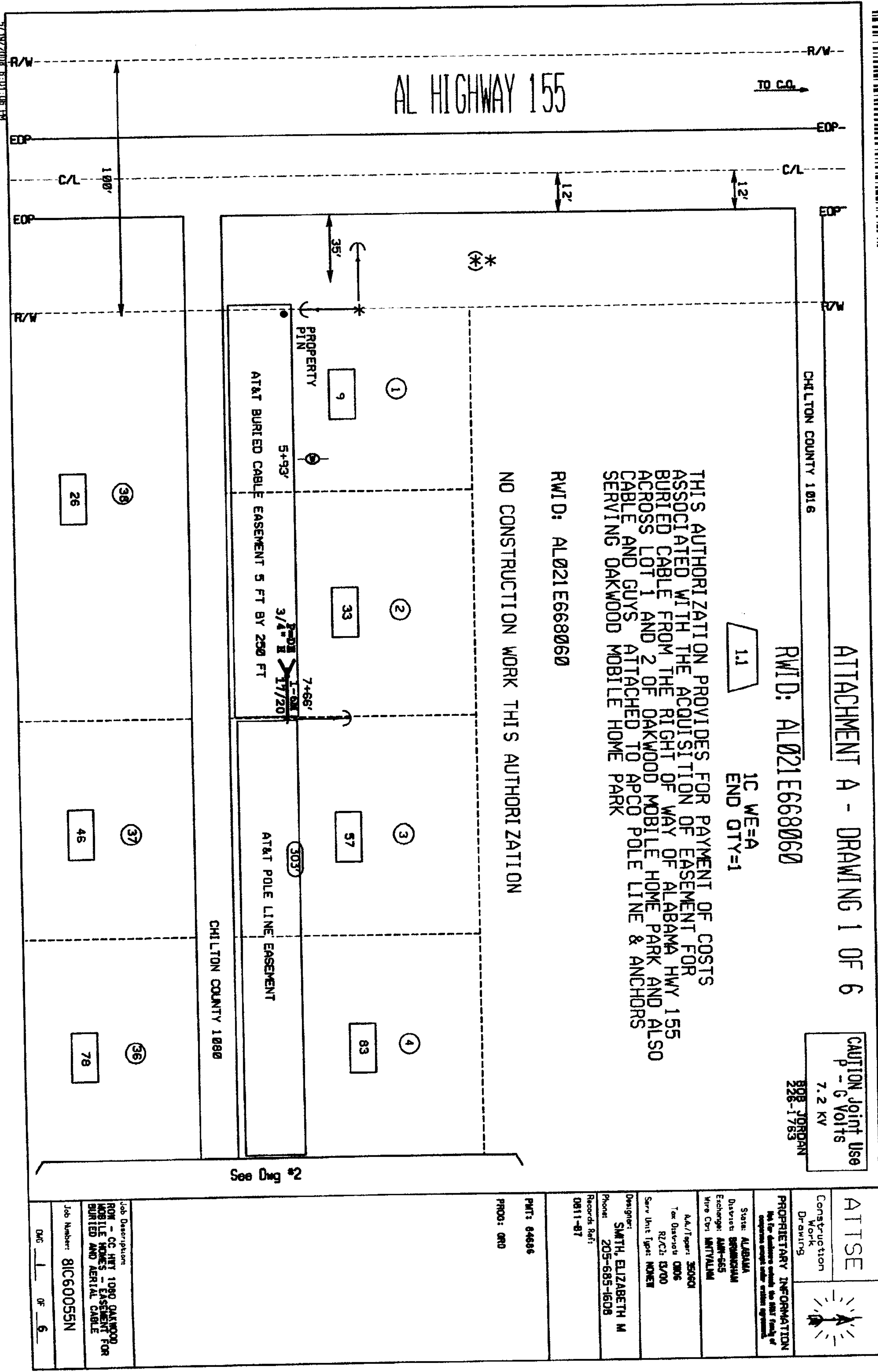

ATTACHMENT A - DRAWING 1 OF 6

RWD: AL021E668060

1.1

1C WE=A
END QTY=1

CAUTION Joint Use
P - 6 Volts
7.2 KV
BOB JORDAN
228-1763

ATTISE

Construction
Work
Drawing

PROPRIETARY INFORMATION
Not for release outside the strict limits of
company except under written approval

System: ALABAMA
District: BIRMINGHAM
Exchange: AMT-665
Wire Ctr: INTVALLUM

Alt./Taper: 35000
Tee District: 0006
R2/C2: 13/00
Saw Unit Type: NONE

Designer:
SMITH, ELIZABETH M
Phone: 205-685-1608
Records Ref: 0811-87

PMT: 64686
PROD: 000

Job Description:
ROW - CC HWY 1090 OAKWOOD
MOBILE HOMES - EASEMENT FOR
BURIED AND AERIAL CABLE
Job Number: 81C60055N
DWG 1 OF 6



20080602000220500 4/8 \$35.00
Shelby Cnty Judge of Probate, AL
06/02/2008 09:47:22AM FILED/CERT

CAUTION Joint Use

7.2 KV

BOB JORDAN
226-1763

NOTE:
LOCATE ALL EXISTING
UTILS BEFORE DIGGING

ATTACHMENT A - DRAWING 2 OF 6

RWID: AL021E668060

ATTSE	
Construction Work Drawing	
PROPRIETARY INFORMATION The drawings are the property of ATTSE and are not to be reproduced or used in any manner without the written approval of ATTSE.	
State: ALABAMA District: BRANCHHAM Exchange: AHH-565 Wire Ctr: MULTIVALM	
AA/Tapers: 350001 Tap Drivers: 0006 R/C's: 13/00 Serv Unit Type: NONE	
Designer: SMITH, ELIZABETH M Phone: 205-685-1608 Records Ref: 0811-87	
PMT: 84806 PROG: GRD	
Job Description: ROW - CC HWY 1040 DAYWOOD MOBILE HOMES - EASEMENT FOR BURIED AND AERIAL CABLE	
Job Number: 81C60055N Dwg: 2 of 6	

See Dwg #1

See Dwg #3

CHILTON COUNTY 1080

TO C.O.

AT&T POLE LINE EASEMENT

4

63

5

111

6

143

7

169

8

199

35

78

35

108

34

136

33

166

32

192



20080602000220500 5/8 \$35.00
Shelby Cnty Judge of Probate, AL
06/02/2008 09:47:22AM FILED/CERT

CAUTION Joint Use
p - 6 Volts
7.2 KV

BOB JORDAN
226-1763

NOTE :
LOCATE ALL EXISTING
UTILS BEFORE DIGGING

ATTACHMENT A - DRAWING 3 OF 6
RWD: AL021E668060

See Dwg #3

CHILTON COUNTY 1000

AT&T POLE LINE EASEMENT

TO CA

See Dwg #5

ATTSE



Construction
Work
Drawing

PROPRIETARY INFORMATION
The fee schedule within the ATTSE family of
products varies with service area.

System ALABAMA
District BRANSHAW
Exchange AMH-505
Wire Ctr: INTVALM

AA/Topper 35060
Tax District 0006
RZ/CZ 13/00
Serv Unit Type NONE

Designer:
SMITH, ELIZABETH M
Phone: 205-685-1608
Records Ref:
0811-87

PMT: 04606

PROG: GR0

Job Description:
ROW - CC HWY 1080 DAKWOOD
MOBILE HOMES - EASEMENT FOR
BURIED AND AERIAL CABLE

Job Number: 81C60055N

DWG 3 OF 6

5/19/2008 6:01:08 PM

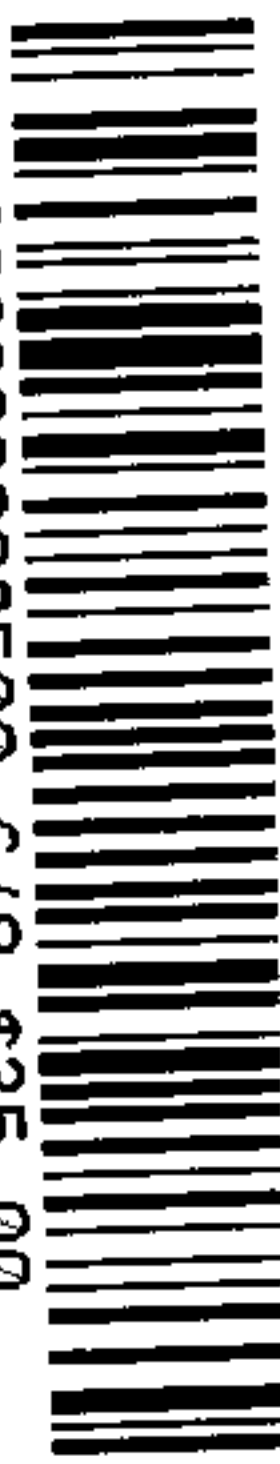

20080602000220500 6/8 \$35.00
Shelby Cnty Judge of Probate, AL
06/02/2008 09:47:22AM FILED/CERT

CAUTION Joint Use

P - 6 Volts
7.2 KV

BOB JOHNSON
226-1763

NOTE :
LOCATE ALL EXISTING
UTILS BEFORE DIGGING

ATTACHMENT A - DRAWING 4 OF 6

RWID: AL021E668060

See Dwg #3

CHILTON COUNTY 1060

AT&T POLE LINE EASEMENT

TO C&A

See Dwg #5

ATTSE

Construction
Work
Drawing



PROPRIETARY INFORMATION
The fee schedule inside the front cover of
this manual applies to all users.

State: ALABAMA
District: BIRMINGHAM
Exchange: AHH-665
Wire Ctr: NATVALLM

AA/Topic: 350601
Tax District: 0006
RZ/CZ: D/00
Serv Unit Type: NONE

Designer:
SMITH, ELIZABETH M
Phone: 205-685-1608
Records Ref:
0811-87

PMT: 84686
PROG: GRD

Job Description:
ROW - CC HWY 1080 DAKWOOD
MOBILE HOMES - EASEMENT FOR
BURIED AND AERIAL CABLE

Job Number: 81C60055N

DWG 4 OF 6

5/19/2008 8:01:08 PM

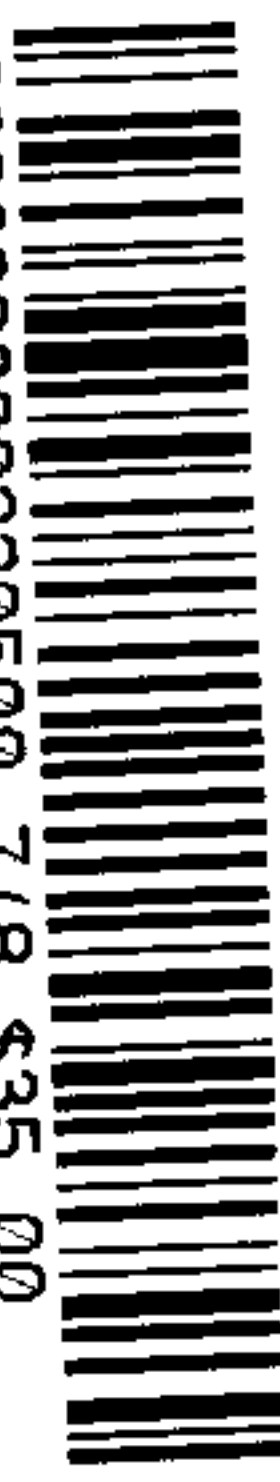

20080602000220500 7/8 \$35.00
Shelby Cnty Judge of Probate, AL
06/02/2008 09:47:22AM FILED/CERT

CAUTION Joint Use
P - 6 Volts
7.2 KV

BOB JOHNSON
226-1763

NOTE :
LOCATE ALL EXISTING
UTILS BEFORE DIGGING

ATTACHMENT A - DRAWING 5 OF 6
RWD: AL021E668060

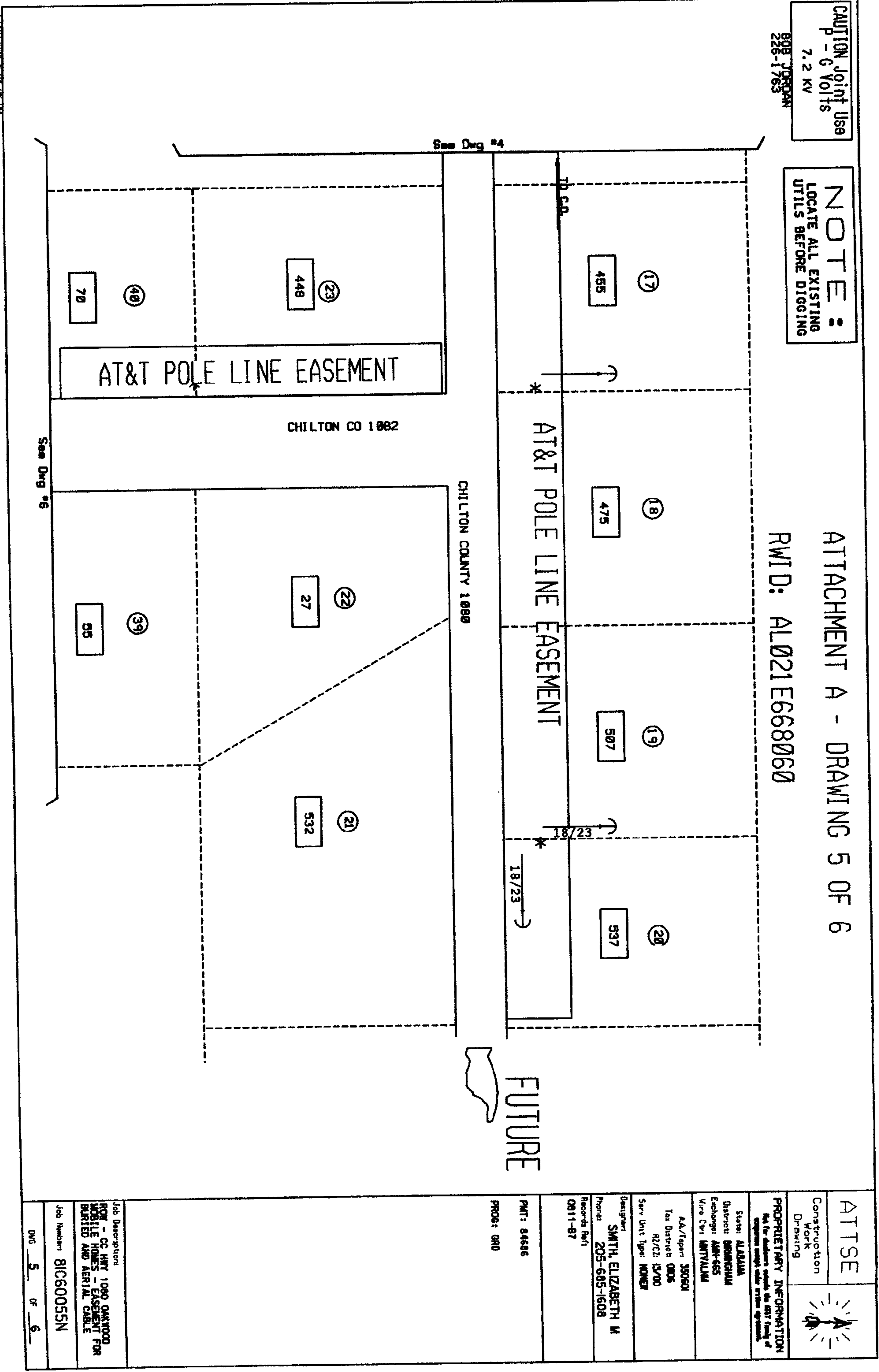

5/19/2008 8:01:06 PM

AT&TSE		
Construction Work Drawing		
PROPRIETARY INFORMATION <small>Not for disclosure outside the AT&T family of companies except under written agreement.</small>		
State: ALABAMA District: BIRMINGHAM Exchange: AHH-665 Wire Ctr: INTVALLAM		
AA/Topic: 350601 Tax District: 0806 RZ/CZ: 13/00 Serv Unit Type: NONE		
Designer: SMITH, ELIZABETH M Phone: 205-685-1608 Records Ref: 0811-87		
PMT: 84686 PROC: 080		
Job Description: ROW - CC HWY 1080 OAKWOOD MOBILE HOMES - EASEMENT FOR BURIED AND AERIAL CABLE		
Job Number: 81C60055N		
DWG 5 OF 6		



20080602000220500 8/8 \$35.00
20080602000220500 8/8 \$35.00
Shelby Cnty Judge of Probate, AL
06/02/2008 09:47:22AM FILED/CERT

CAUTION Joint Use
P - 6 Volts
7.2 KV

BOB JORDAN
226-1763

NOTE:
LOCATE ALL EXISTING
UTILS BEFORE DIGGING

See Dwg #5

ATTACHMENT A DRAWING 6 OF 6
RWD: AL021E668060

POLE LINE EASEMENT

CHILTON CO 1082

PROPOSED ATT 20' 8"

70

40

55

39

41

81

FUTURE



ATTSE

Construction
Work
Drawing

PROPRIETARY INFORMATION
This drawing is the property of
the Alabama Electric Power Company
and is not to be reproduced
without written permission.

State: ALABAMA
District: BIRMINGHAM
Exchange: ALB-565
Wire Ctr: MVTALUM

Alt./Toppers: 350601
Tel. District: 0006
R/C/L: 13/00
Serv. Unit Type: NONE

Designer:
SMITH, ELIZABETH M
Phone: 205-685-1608
Records Ref: 0811-87

PRT: 04686

PROG: GRD

Job Description:
ROW - CC HWY 1080 DANKD
MOBILE HOMES - EASEMENT FOR
BURIED AND AERIAL CABLE

Job Number: 81C60055N

DWG 6 OF 6

5/19/2008 8:01:06 PM