

ORDINANCE NUMBER 769-08A

20080527000213260 1/6 \$26.00
Shelby Cnty Judge of Probate, AL
05/27/2008 11:24:27AM FILED/CERT

AN ORDINANCE TO ALTER, REARRANGE AND EXTEND THE CORPORATE LIMITS OF THE CITY OF HELENA, ALABAMA, SO AS TO EMBRACE AND INCLUDE WITHIN THE CORPORATE AREA OF SAID CITY ALL TERRITORY NOW WITHIN SUCH CORPORATE LIMITS AND ALSO CERTAIN OTHER TERRITORY CONTIGUOUS TO SAID CITY.

WHEREAS, a petition signed by Windy Ann Topazi the owner(s) of all of the land within the territory therein described and proposed to be annexed to the City, together with a map of said territory showing its relationship to the corporate limits of the City, has been filed with the City Clerk of the City of Helena; and

WHEREAS, this Council has determined and found that the matters set forth and alleged in said petition are true, and that it is in the public interest that said property be annexed to the City of Helena;

NOW, THEREFORE, BE IT ORDAINED by the Council of the City of Helena as follows:

Section 1. That said Council and the City of Helena hereby assent to the annexation of said territory to the City of Helena, Alabama, the corporate limits of the City to be extended and rearranged pursuant to the provisions of Chapter 42, Article 2, Code of Alabama 1975 (Sections 11-42-20 through 11-42-23, as amended) so as to embrace and include said territory in addition to the territory already within its present corporate limits, within the corporate area of said City, which said territory is not within the corporate limits of another municipality and the new boundary line does not lie at any point more than half the distance between the old city boundary and the corporate boundary of any municipality. Said territory is described as follows:

Parcel 58-12-7-26-0-000-028.001
188 Honeysuckle Road
Helena AL 35080

Begin at the Northeast corner of the Northeast $\frac{1}{4}$ of the Southeast $\frac{1}{4}$ of Section 26, Township 20 South, Range 4 West; thence run South along East line of said Northeast $\frac{1}{4}$ of Southeast $\frac{1}{4}$ a distance of 665.15 feet for a point of beginning; thence South along said East line a distance of 100.00 feet; thence turn right an angle of 89 degrees 29 minutes 37 seconds a distance of 218.0 feet; turn right an angle of 90 degrees 30 minutes 23 seconds a distance of 100 feet; turn right an angle of 89 degrees 29 minutes 37 seconds a distance of 218.0 feet to point of beginning. Being in the Northeast $\frac{1}{4}$ of the Southeast $\frac{1}{4}$, Section 26, Township 20 South, Range 4 West, Shelby County, Alabama.

Section 2. That the City Clerk shall file a certified copy of this ordinance containing an accurate description of said annexed territory with the Probate Judge of Shelby County, Alabama, and also cause a copy of this ordinance to be posted in three (3) public places in the City of Helena and this ordinance to be sent to the Justice Department for their approval.



20080527000213260 2/6 \$26.00
Shelby Cnty Judge of Probate, AL
05/27/2008 11:24:27AM FILED/CERT

STATE OF ALABAMA
SHELBY COUNTY

I, Peggy C. Dunaway, City Clerk of the City of Helena, do hereby certify that the above is a true correct copy of **Ordinance Number 769-08A** duly adopted by the Council of the City of Helena at its meeting held 5th day of May, 2008, and as same appears of record in the ordinance records of said City, and approved by the Mayor and City Council on 5th day of May, 2008.

May Given under my hand and corporate seal of the City of Helena, this the 5th day of May, 2008.



Peggy C. Dunaway
Peggy C. Dunaway, City Clerk



20080527000213260 3/6 \$26.00
Shelby Cnty Judge of Probate, AL
05/27/2008 11:24:27AM FILED/CERT

CERTIFICATION

I, Peggy C. Dunaway, the duly appointed and acting Clerk of the City of Helena, Alabama, do hereby certify that the within Ordinance Number **769-08A** is a true copy as recited in the said City Clerk's Minute Book and posted by me as provided by law in three public places in said City, being on the bulletin board of the City Hall, in the BP Coosa Mart in the City of Helena, and in the Helena Public Library in said City, that said Ordinance shall become a duly lawful Ordinance of said City on the 12th day of May, 2008, five or more days after the posting of the same as provided by law.

IN WITNESS WHEREOF, I have hereunto set my hand and seal on this the 5th day of May, 2008.



Peggy C. Dunaway
Peggy C. Dunaway, City Clerk

Old #769-08A



20080527000213260 4/6 \$26.00
Shelby Cnty Judge of Probate, AL
05/27/2008 11:24:27AM FILED/CERT

Mayor
Charles W. "Sonny" Penhale

City Clerk / Treasurer
Peggy C. Dunaway

CITY OF HELENA

816 Highway 52 East
P.O. Box 613
Helena, AL 35080-0613
Phone (205) 663-2161
Fax (205) 663-9276

Council Members
Colleen Kelley Lenz
Barbara F. Hyche
Thomas P. Lefebvre
Jerry Deon Pate
Katherine E. Ennis

April 8, 2008

Carl Glenn & Windy Ann Allen
188 Honeysuckle Circle
Helena AL 35080

RE: Annexation of Property
Shelby County, Alabama
Parcel I.D. 58-12-7-26-0-000-028.001

Dear Mr. & Mrs. Allen:

The City of Helena has written you on several occasions in reference to annexing your property at 188 Honeysuckle Circle into the city limits. The property you own is surrounded by our city limits and we would like for you to consider signing a petition to annex your property.

At the present time, you are receiving all the city services, garbage pick-up, water, police and fire protection and have never annexed your property into the city limits of the City of Helena. This may be an oversight on your part or our part, but we do not provide services for property outside the city limits.

Enclosed you will find a petition for annexation that must be handled in the upmost urgency so that we may continue to move forward.

Please complete and return as soon as possible to the address above.

Should you have any questions, please call me at (205) 663-2161.

Thank you,

Peggy C. Dunaway
City Clerk/Treasurer

:pd

Enclosures

PETITION

20080527000213260 5/6 \$26.00
Shelby Cnty Judge of Probate, AL
05/27/2008 11:24:27AM FILED/CERT

I we, Windy Ann Topazi the undersigned property owner(s), being owners of all of the land within the territory described as follows:

do hereby petition the City of Helena, County of Shelby, Alabama, to annex the above described property into the city limits of the City of Helena. Attached hereto as Exhibit 'A' and made part and parcel hereof as fully as if set out herein, is a map of said property which we own, showing its relationship to the corporate limits of the City of Helena, Alabama, which said map is herewith filed with the City Clerk of the City of Helena, Alabama.

Dated this 17th day of April, 2008.

Parcel # & Address

Name & Phone

58-12-7-26-0-000-028.001
188 Honeysuckle Circle
Helena, AL 35080

Windy Ann Topazi 481-3559

How many people live on the parcel of land, how many are of voting age, how many are not of voting age and the race of each person.

1.5 2.3 3.2 4. All 5 are white

Reason for annexation

Because the City of Helena says in this letter, If don't they will Stop my water and Garbage pick-up.

Property Information - 12 7 26 0 000 028.001

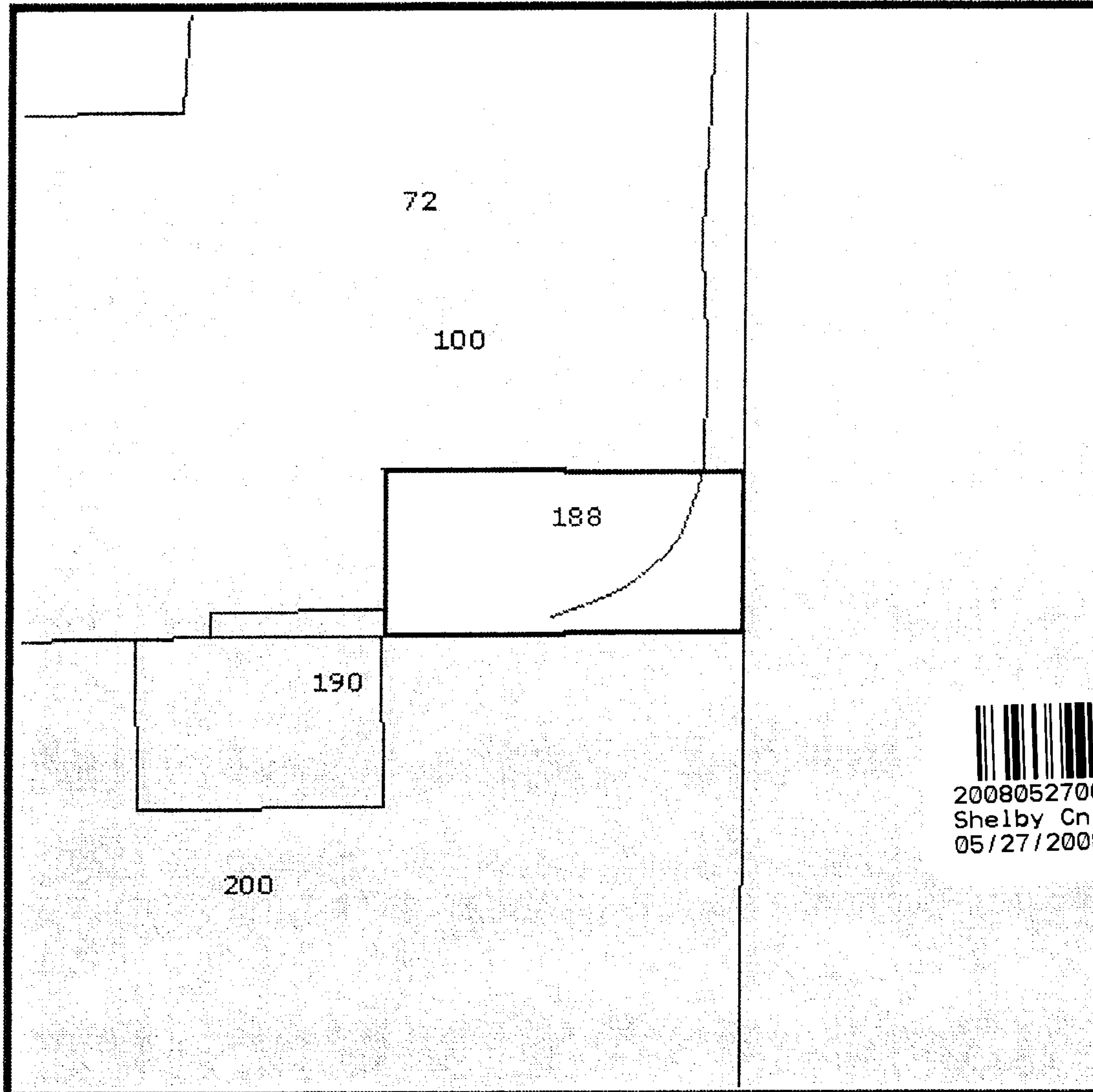

20080527000213260 6/6 \$26.00
Shelby Cnty Judge of Probate, AL
05/27/2008 11:24:27AM FILED/CERT

*Garbage
&
on water
2003*

Owner Information

Name 1	Name2	Address 1	Address 2	City	State	Zip Code
ALLEN CARL GLENN & WINDY ANN		188 HONEYSUCKLE CIRCLE		HELENA	AL	35080

Subdivision	Primary Lot	Secondary Lot	Block	Section	Township	Range
			000	26	20S	04W

Map Book	Map Page	Lot Dimension 1	Lot Dimension 2	Number of Acres	Square Feet
0	0	100	218	0.5	21786

Description

BEG 665.15 S OF NE COR NE1/4 OF SE1/4 S 100 W 218.0 N 100 E 218 TO POB

Document Information

Recorded Date	Recorded Number
20030725	20030050809000000
19970612	19970001888900000
19970612	19970001889000000
19921104	19930003512900000

*unincorporated
Shelby Co.*