

\$ 500.00
28

AN EASEMENT
FOR THE CONSTRUCTION, OPERATION, AND MAINTENANCE
OF PUBLIC UTILITIES BY THE CITY OF CALERA, CALERA, ALABAMA

This EASEMENT, executed this 14th day of January, ²⁰⁰⁸~~2006~~, for the construction, operation, and maintenance of public utilities, with appurtenances by the CITY OF CALERA, across the property of the LANDOWNER, Mr. Eddie Lumpkin, located in Section 4, Township 22S, Range 2W, in Shelby County, Alabama, as shown on the attached sketch, is granted by the LANDOWNER to the CITY OF CALERA for valuable considerations, the receipt and sufficiency of which are acknowledged by the LANDOWNER, for himself, and his heirs, executors, successors, and assigns. The easement is described below:

A permanent easement, 30 feet wide and approximately 1240 feet long, as shown on the sketch attached to and a part of this document, to go with the land, to allow the CITY OF CALERA, its employees and agents to operate, repair and maintain the public utilities, including the right of access by the CITY OF CALERA, its employees, agents, or officials, and necessary related equipment. Included is the right to uncover the utility, with the obligation to leave the LANDOWNER'S property in good repair after completion of any repair to the utility. It is understood that construction of permanent structures, with the exclusion of parking lots, roadways, and driveways on the above-described easement is prohibited.

The above easement is more particularly described as shown on the attached sketch.

Executed the date shown above in four copies.

LANDOWNER:

By: Eddie Lumpkin

WITNESS:

By: Wade Stubbs

For the CITY OF CALERA:

By: George W. Roy
George W. Roy, Mayor

ATTEST:

Linda Steele
Linda Steele, City Clerk

Recorded the _____ day of _____, 2006, in Deed Book _____, Page _____, of the public records of Shelby County, Alabama.

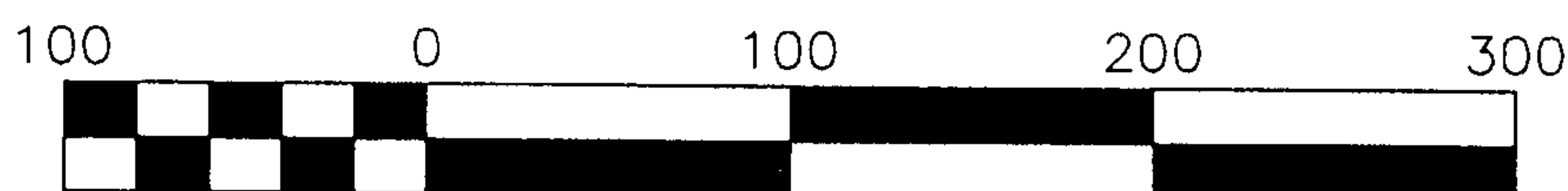
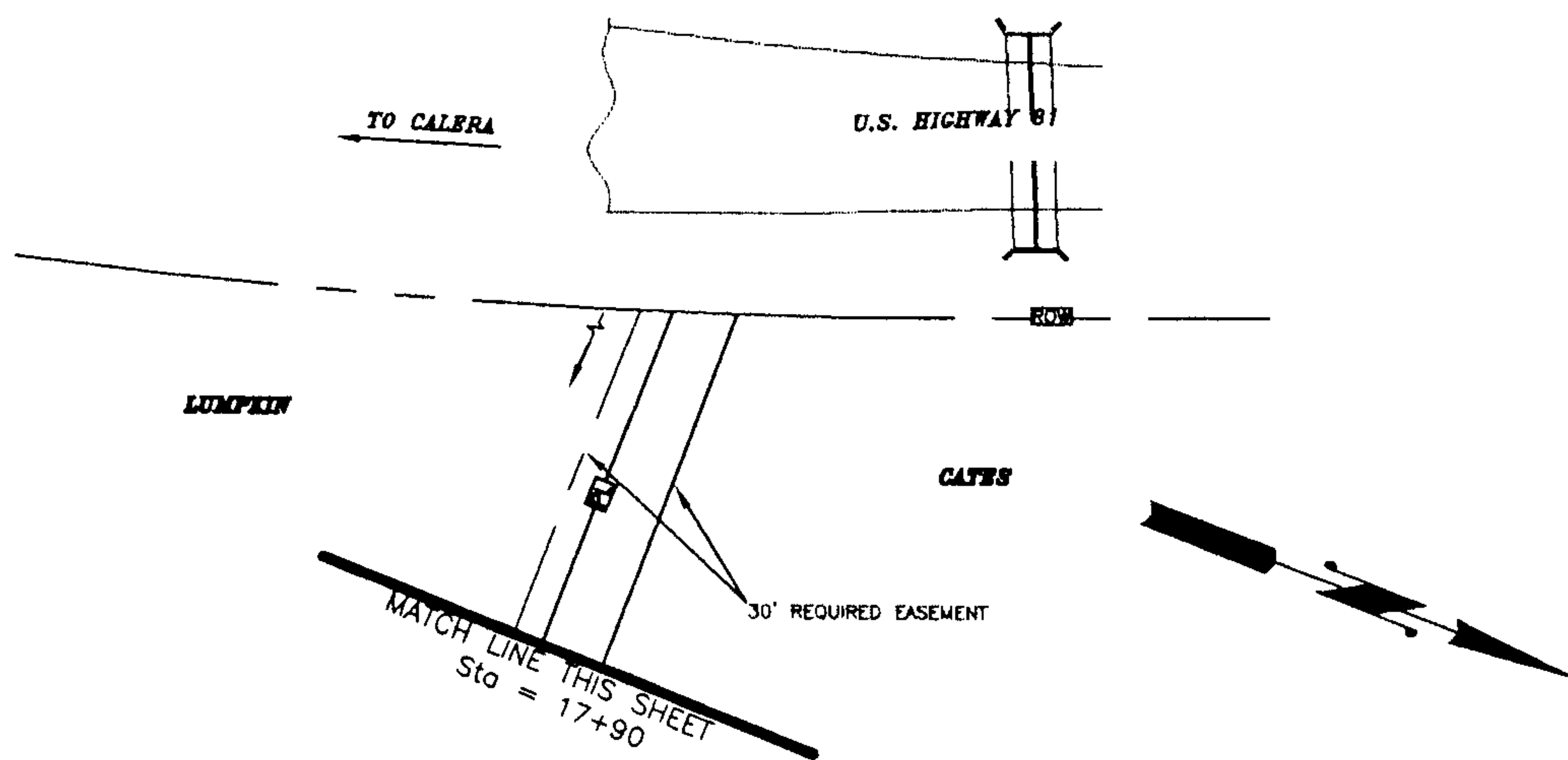
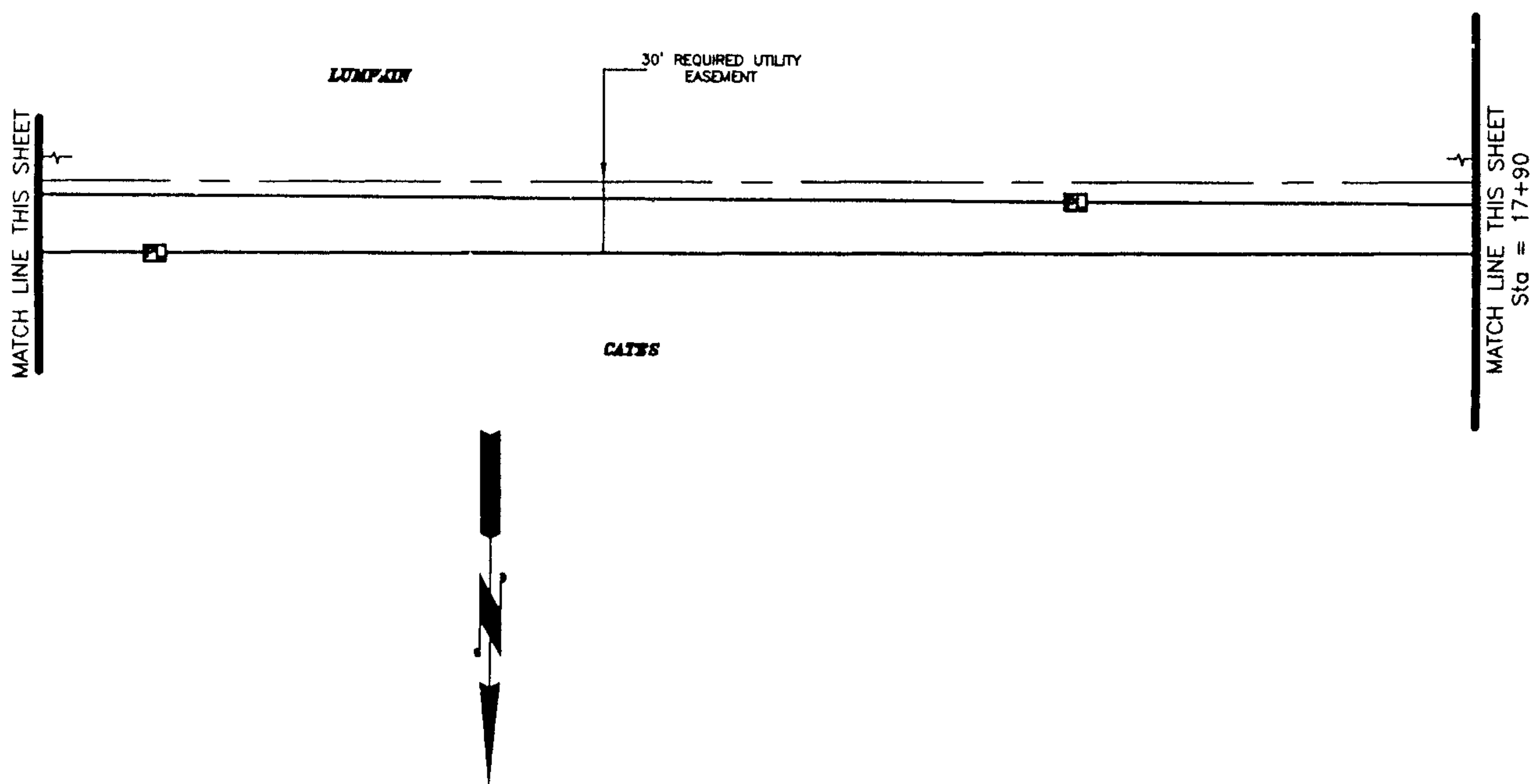
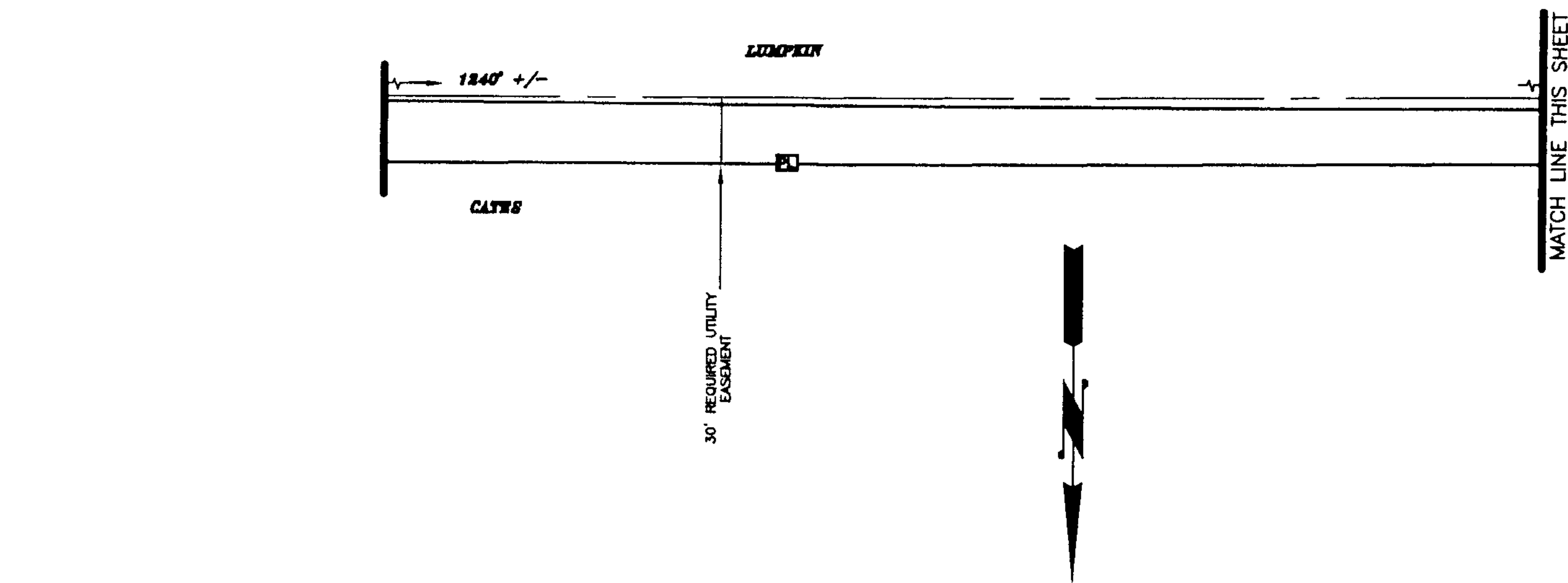

Scale 1" = 100'

20080207000052270 2/2 \$15.00
Shelby Cnty Judge of Probate, AL
02/07/2008 03:26:50PM FILED/CERT



CARR & ASSOCIATES ENGINEERS, INC.

2052 OAK MOUNTAIN DRIVE
PELHAM, ALABAMA 35124

PHONE (205) 664-8498 FAX (205) 664-9685

CIVIL, STRUCTURAL & ENVIRONMENTAL ENGINEERS
AND
LAND SURVEYORS

NOTE: STATIONING REFERS TO CAE PROJECT 50.44

CAE PROJECT NO. 50.45

PROJECT NAME: SHELBY COUNTY ROAD 22 EASEMENT

CADD OPER: ESK

CADD FILE: 50.44LUMPKINEASEMENT.DWG

DATE: 09/12/06

© COPYRIGHT, 2006
NO PART OF THIS DRAWING MAY BE REPRODUCED, COPIED,
DIGITIZED, FAXED, OR TRANSFERRED WITHOUT THE EXPRESS