

\$500.00  
25

AN EASEMENT  
FOR THE CONSTRUCTION, OPERATION, AND MAINTENANCE  
OF UTILITIES BY THE CITY OF CALERA

This EASEMENT, executed this 14 day of Jan, 2006, for the construction, operation, and maintenance of utilities with appurtenances, by The City of Calera, hereinafter called the OWNER across the property of the LANDOWNER, Calera Southeast Inc., as shown on the attached sketch, is granted by the LANDOWNER to the OWNER for valuable considerations, the receipt and sufficiency of which are acknowledged by the LANDOWNER, for himself, and his heirs, executors, successors, and assigns.

One permanent easement, to go with the land to allow the OWNER, its employees and agents to construct, operate, repair, and maintain the OWNER'S utilities including the right of access by the OWNER, its employees and agents, or officials, and necessary related equipment. Included is the right to uncover the utilities, with the obligation to leave the LANDOWNER'S property in good repair after completion of any repair to the utilities.

The easement is described as follows:

Located in the City of Calera, Shelby County, Alabama a 50-foot wide utility easement lying east of and parallel to the east easement line of Alabama Power Company and west of the most easterly line of said property as shown on the attached sketch.

Executed the date above in four copies.

LANDOWNER:

By: Sidney M. Beal  
Representative for  
Calera Southeast Inc.

WITNESS:

By: Mike Kent

For the City of Calera

By: George W. Roy  
George W. Roy, Mayor

WITNESS:

By: Linda Steele  
Linda Steele, City Clerk

Recorded the \_\_\_\_\_ day of \_\_\_\_\_, 2006 in Deed Book \_\_\_\_\_ Page \_\_\_\_\_,  
Of public records of Shelby County, Alabama.

Parcel I.D. No. 28-5-21-1-003-004.000

20080207000052260 1/2 \$15.00  
Shelby Cnty Judge of Probate, AL  
02/07/2008 03:26:49PM FILED/CERT

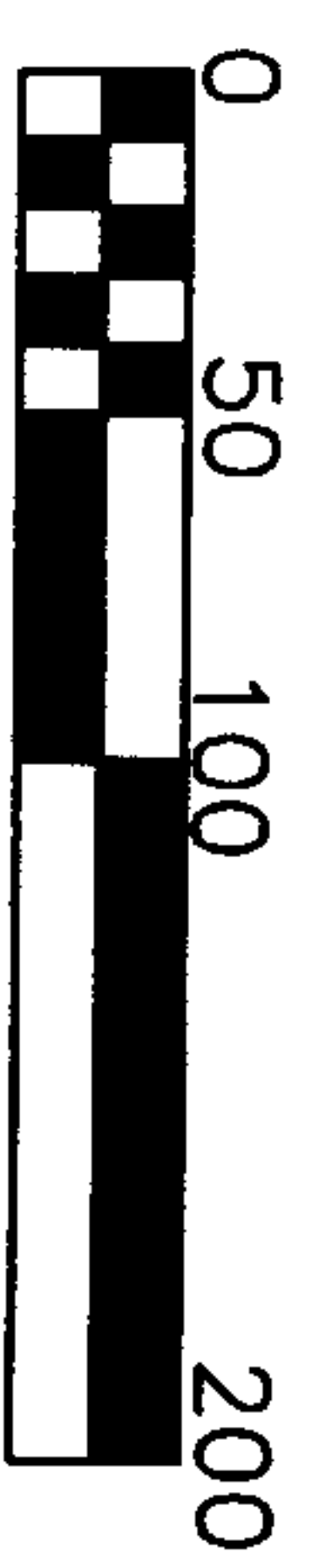
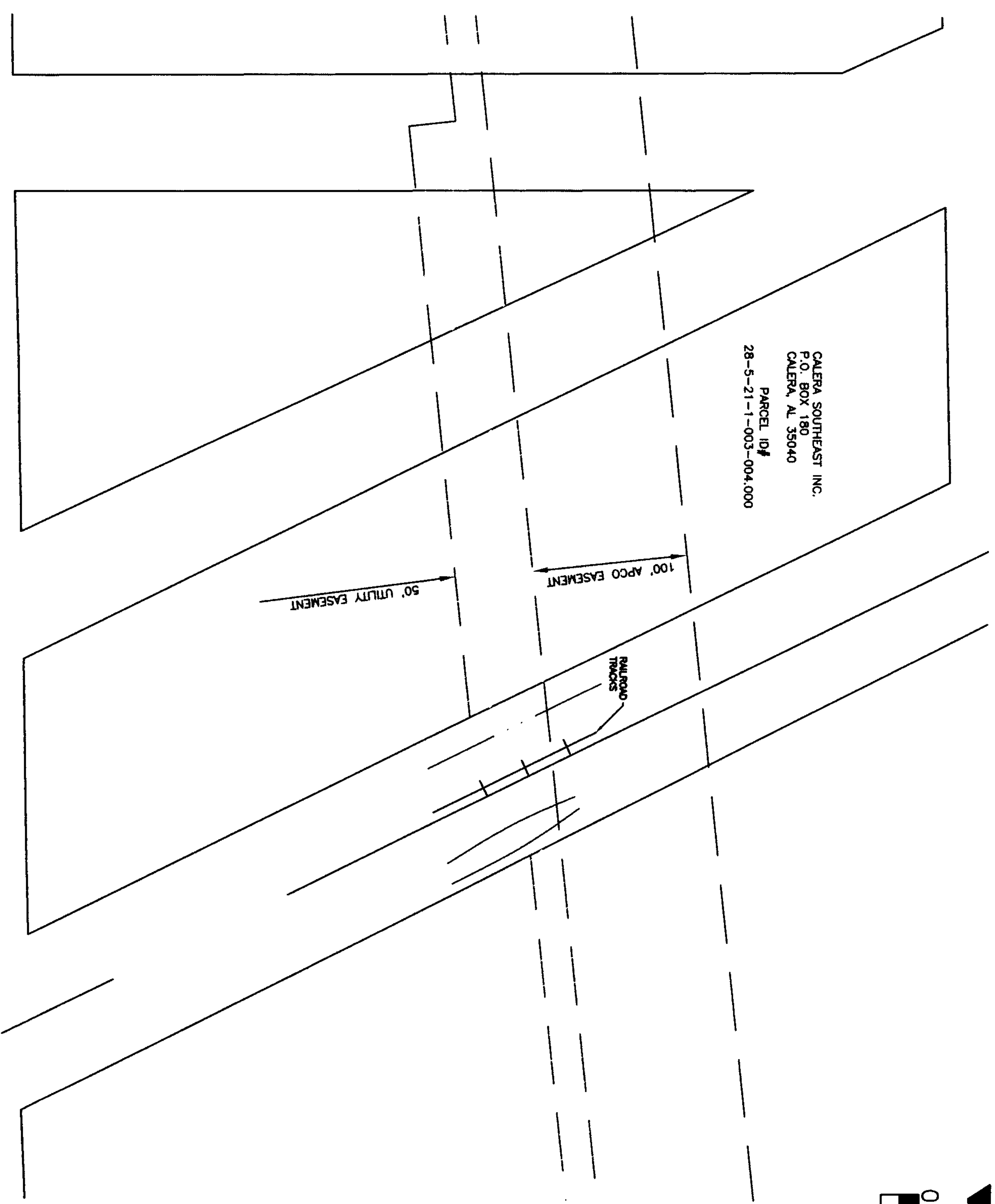

GRAPHIC SCALE  
1"=100'

20080207000052260 2/2 \$15.00  
Shelby Cnty Judge of Probate, AL  
02/07/2008 03:26:49PM FILED/CERT

**CALERA**  
ALABAMA

CITY OF CALERA  
ENGINEERING DEPARTMENT  
1070 10TH STREET  
CALERA, ALABAMA 35040  
PHONE (205) 666-3814 FAX (205) 666-3221