



Marie A. Musfeldt
Director, Contract Development

Lay D.A.M. H.P. - Calera T.S. Tap
(Lay Dam - Bessemer)
(Lock 12 - Bessemer)

Sta 932+01
(A-403999)

23.53

In the NW 1/4 & NE 1/4 of
Section 16, Township
22 South,
Range 2
West,
Shelby County
Alabama

301 West Bay Street, Suite 900
Jacksonville, FL 32202
904.633.1517
Marie_Musfeldt@csx.com

April 25, 2007

70196551
(TL-6-1-20)

Jerry Roberson
Chief Technical Specialist
Alabama Power Company
600 North 18th Street
P.O. Box 2641
Birmingham, Alabama 35473

20071029000498150 1/5 \$23.50
Shelby Cnty Judge of Probate, AL
10/29/2007 12:55:02PM FILED/CERT

Re: CSXT Agreement #: CSX-057553-002

Dear Mr. Roberson:

Thank for your request to install facilities over/across CSX Transportation, Inc.'s property pursuant to General Crossing Agreement dated April 25, 2007 (the "Agreement"), and as noted below:

Location:	Calera, Shelby County, AL	Drawing #:	A-403999
GIS:	20552	Drawing Date:	06/15/05
RR Milepost:	OOO 423.74	Facility:	Wireline
RR Stationing:	22382+43	Request Date:	04/04/2007

This letter will serve as formal authority to make the installation at the location shown on the attached approved print, in accordance with specifications outlined in your application and subject to the terms of said Agreement. This letter shall constitute a Supplement to said Agreement. Please retain it in your file(s) pertaining to the same.

To schedule the work, complete and follow the instructions on the attached Outside Party Number Request Form. No work is to be performed on CSX property without Roadmaster's authorization and all such costs shall be borne by Alabama Power.

Should there be any questions, please feel free to call me at the above referenced number.

Sincerely,

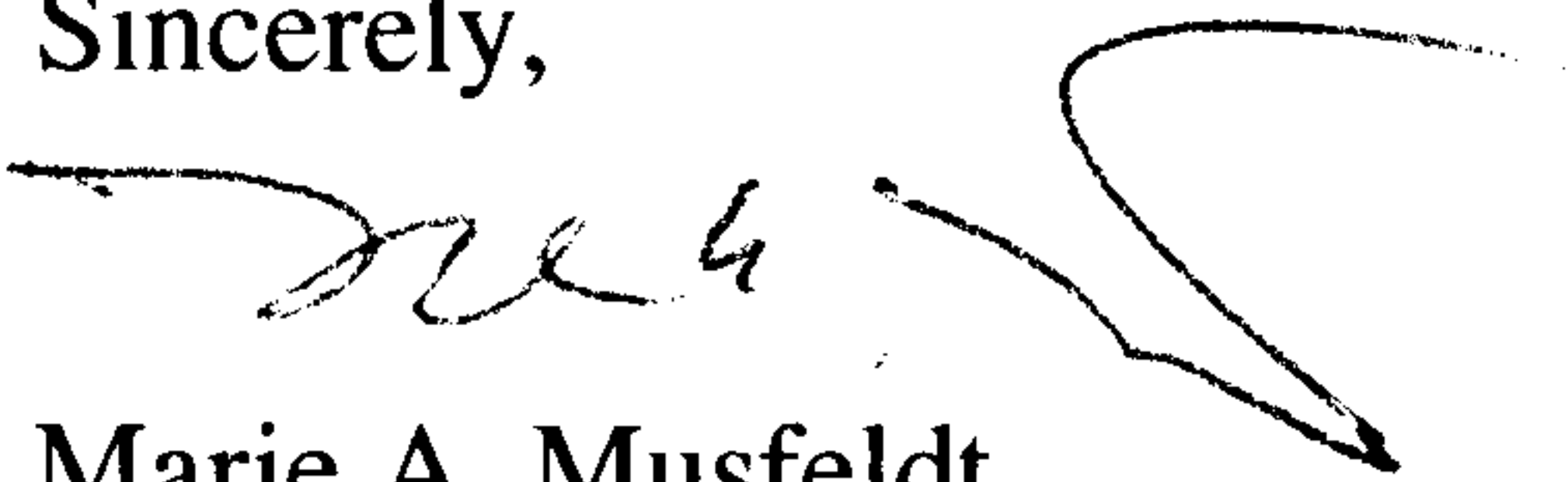

Marie A. Musfeldt



70196551

APPLICATION FOR WIRE OR CABLE LINES
CROSSING OR PARALLELING PROPERTIES AND TRACK

Submit one original and one copy of both the application and drawing along with a \$750.00 nonrefundable Application Fee to CSX Transportation, Property Services J180, 500 Water Street, Jacksonville, FL 32202.

Application and plans must be approved and written authority received from the Railroad before construction is begun. Your proposal and construction must be in accordance with CSXT's Specifications, the National Electrical Safety Code, and any governing laws or regulations. Note: Specifications furnished in the Application Package are to be used as a guideline only. CSXT reserves the right to approve or decline any application.

PLEASE SIGN BEFORE COMPLETING:

I affirm the information I am furnishing in this application will comply with the NESC Standards and accurately reflects the proposed construction plans.

Agreement No.: CSX057553 002Signature: [Signature]Application Date: April 4, 2007**Project Owner Information:**☐ Check here if agreement should be mailed to this address

1. Complete Legal Name of applicant as it would appear in a legal document (inaccurate information will delay your request):
ALABAMA POWER COMPANY
2. Company Contact Name: JERRY ROBERSON
Title: CHIEF TECHNICAL SPECIALIST
3. Telephone: (205) 257-4643 Fax: (205) 257-1220 E-Mail: JROBERSON@SOUTHERNCO.COM
4. Street Address: 600 NORTH 18TH STREET City: BIRMINGHAM State: AL Zip: 35291
5. Type of business: P.O. BOX 2641
☒ Corporation (State of incorporation ALABAMA)
☐ Partnership (Type and State of Partnership _____)
☐ Individual ☐ Developer ☐ Municipality ☐ Other _____

Engineer/Consultant Information:☐ Check here if agreement should be mailed to this address

6. Company Name: _____
7. Company Contact Name: _____ Title: _____
8. Telephone: () _____ Fax: () _____ E-Mail: _____
9. Street Address: _____ City: _____ State: _____ Zip: _____

Project Information:(Note: Metric Information will NOT be accepted.)

10. Is this installation: ☐ New ☐ Revision to existing ☐ Attachment to existing ☐ Upgrade to existing
11. If not a new installation, furnish existing Agreement Number: _____
12. If this installation is to be a supplement to your master (general) agreement, furnish:
Agreement Number: _____ Date: _____
13. Your Reference Number: _____
14. Town Location: CALERA County: SHELBY State/Province: Alabama
15. Type of Crossing: ☒ Electric ☐ CATV ☐ Telephone ☐ Communications
☐ Other (explain): _____
16. Crossing is dedicated to: ☐ Trunk ☐ Distribution ☒ Transmission ☐ Other _____
17. Conductor Material: ☐ Copper ☒ Aluminum ☐ Fiber Optic & Fiber Count _____
18. ☒ AC / ☐ DC : Voltage: 115,000 No. of Phases: 3 Amperes: _____ Hertz: 60
19. Maximum Voltage: 121,000 0-0 Maximum Current: 900
20. Maximum Fault to Ground: 2475
21. AWG Gauge: 3-795 2 1/2 ALCR

Shelby County, AL 10/29/2007
State of Alabama

Deed Tax: \$.50

(Form continued on Page 2)

20071029000498150 2/5 \$23.50
Shelby Cnty Judge of Probate, AL
10/29/2007 12:55:02PM FILED/CERT

Project Information Cont'd:

22. Is this both a Crossing and Parallelism? ☐ Yes ☒ No
23. Number of tracks to be crossed: 1 Angle of crossing 230 ^{EXISTING}
24. Crossing location: 1273 feet NORTH (direction) from Railroad Milepost: 4247
If known: Valuation Station: _____ Valuation Map Number: _____
If known: Latitude/Longitude: _____
If known: Street Address of Crossing/Parallelism: _____
25. Parallelism location: Beginning: _____ feet _____ (direction) from RR Milepost: _____
and Ending: _____ feet _____ (direction) from RR Milepost: _____
26. Total length on Railroad R/W: 150' Length Crossing: 385' Length Paralleling: _____
27. Will line be located entirely within a public road right-of-way? ☐ Yes ☐ No
** If you answered yes, road name, number, and width of public right-of-way are required on drawing
DOT/AAR Crossing Number: _____
28. a) Will this occupancy connect to an existing facility within Railroad corridor? ☐ Yes ☐ No
b) If Yes, name facility owner(s): _____
29. Number of ☐ Manholes ☐ Handholes ☐ Pull boxes ☐ Other (describe) _____
to be located within Railroad corridor. Dimensions of ancillary structures are required on drawing.
30. Distance from manholes/handholes/pull boxes/other to nearest track: _____
31. Number of new poles to be located on Railroad R/W: _____
32. Number of existing poles to be utilized on Railroad R/W: _____
33. Owner of existing poles to be utilized within Railroad R/W: _____
34. Distance from butt of pole utilized to nearest rail of track: 147'
35. Underground facilities: (For the purpose of this application, Conduit or Innerduct shall mean a single duct or pipe suitable for housing cables or wires).
Total buried length on Railroad R/W: _____
Number of Conduit(s): _____ Total Filled Conduit(s): _____ Total Empty Conduit(s): _____
Number of Cables or Lines in each Conduit: _____
Number of Conductors in each Cable or Line: _____
Encasement material: _____ Outside diameter: _____ Wall thickness: _____
Bury depth from base of rail to top of casing: _____ feet
Bury depth on right of way, but not beneath tracks: _____ feet
Bury depth below ditches: _____ feet
36. Aerial facilities:
Total aerial length on Railroad R/W: 71.5'
Total number of CSX pole lines to be crossed: 0
Type of wire supports: CONCRETE Size: 70x75 False dead ends: _____
Height of wires above top of rail at 60°f: 33' feet Sag in Spans at 60°f: 1.37'
Height of wires above Railroad communication and signal wires at 60°f: _____ feet

Supplemental Fiber Optic Information (Must be Completed for Fiber Proposals):

37. Identify each intended user of the conduit/cable: _____
38. Entity performing construction: _____
39. Number of fibers per cable: _____

Railroad Use Only:

Division ATLANTA Subdivision SANDNA SOUTH No. of Crossings: 1
Absolute No.: 20552 Valuation Section/Map No.: V 47/15
Valuation Station: 32382+43
Milepost: 000 433.14

Roadmaster No.: _____ Contr. Type: _____ Fiber? NO

70196551

SHELBY COUNTY
T-22-S, R-2-W
N.W. 1/4 OF N.E. 1/4 SECTION 16

NOTE: THIS IS AN EXISTING CROSSING WITH NEW CONDUCTORS BEING INSTALLED!!

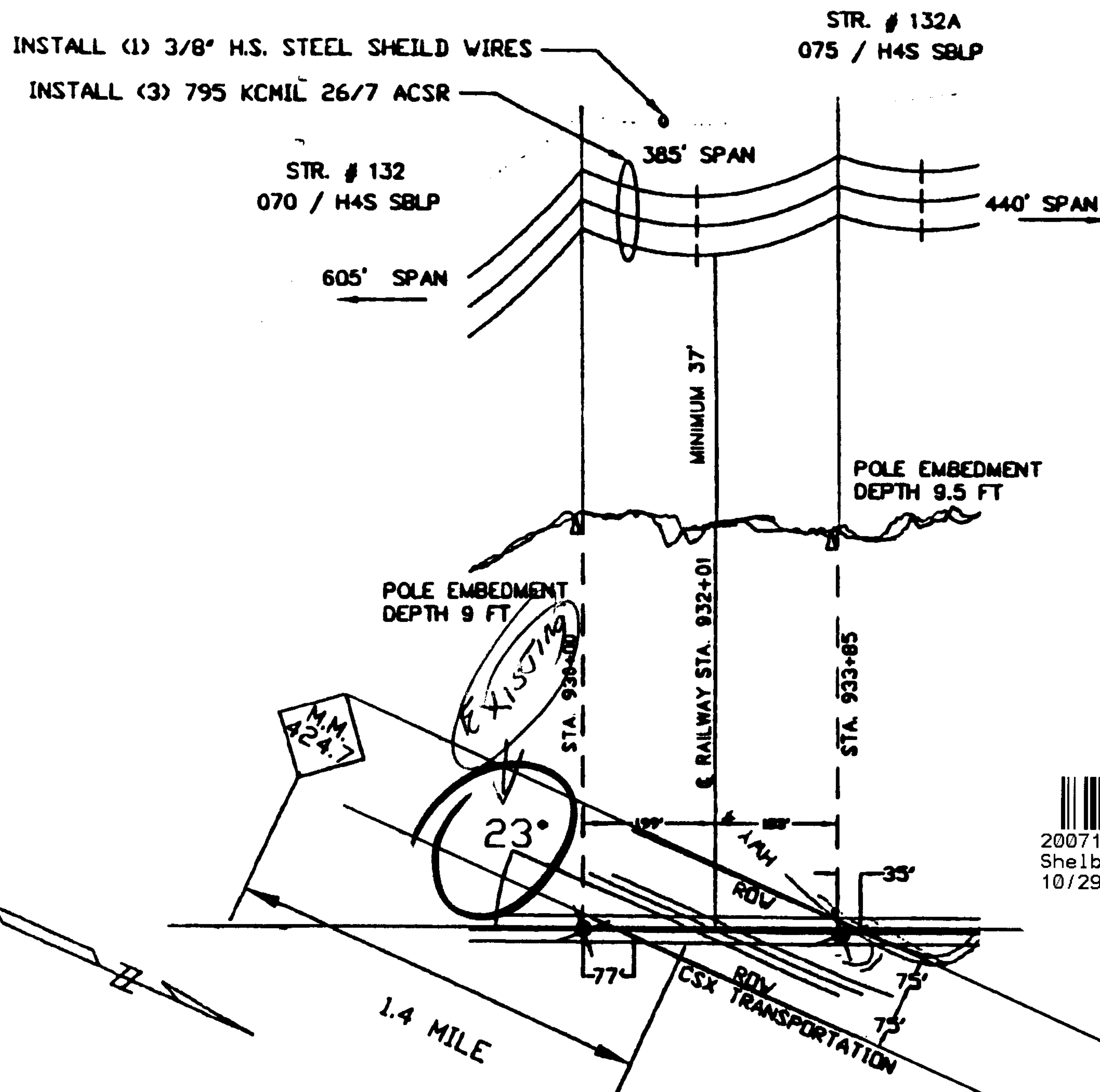

APPROVED FOR CONSTRUCTION

APPROVED BY: *Autofly*

CSX ENGINEERING

DATE: 4/19/07

20071029000498150 4/5 \$23.50
Shelby Cnty Judge of Probate, AL
10/29/2007 12:55:02PM FILED/CERT

COMPUTER PREPARED DRAWING. MAKE
NO MANUAL CHANGES. RETURN TO
POWER DELIVERY TRANSMISSION

SO. DIV. ACC LINE NAME:
SO. DIV. ACC LINE NUMBER:
SO. DIV. DIVISION LINE NAME:
SO. DIV. DIVISION LINE NUMBER:
B'HAM DIV. ACC LINE NAME:
B'HAM DIV. ACC LINE NUMBER:
B'HAM DIV. DIVISION LINE NAME:
B'HAM DIV. DIVISION LINE NUMBER:

CALERA - LAY DAM
202
LAY DAM - BESSEMER STR. #62
125000
CALERA - LAY DAM
202
LAY DAM - BESSEMER 115KV (SOUTHERN SECTION)
1212A0A

LEGEND

- DENOTES POLE TO BE RETIRED
- X DENOTES POLE TO BE INSTALLED
- O DENOTES EXISTING POLE
- DENOTES GUY & ANCHOR TO BE RETIRED
- DENOTES GUY & ANCHOR TO BE INSTALLED

DR	WRP	NO.	DATE	REVISION
DA	6/15/05	01	07/29/05	STR. NO. CHANGE
CK	JRM	02	08/07/05	STR. NO. CHANGE
		03	10/21/05	ADD ROW WIDTHS

ALABAMA POWER COMPANY

SUBJECT LAY DAM H.P.-CALERA T.S. TAP RECONDUCTOR
DETAIL CSX RAILROAD CROSSING BETWEEN
STR. #132 AND STR. #132A

APP
DATE 6/15/05

SUPERSEDES

SCALE H 1" = 300' SH. 01 OF 01 SHEETS

A-403999

A-403999-001-03 P/L 37260AX, AK TYPE 30

CAD
CV
MEDUSA
REV. 14.1



70196551

Form # N-OP

OUTSIDE PARTY NUMBER REQUEST FORM FOR NEW INSTALLATIONS**Outside Party (OP) Number Information: TO BE COMPLETED BY CSXT**

OP Number: _____

Valid Through: _____

Agreement/Project Information: TO BE COMPLETED BY LICENSEE/PROJECT CONTACTCSXT Agreement Number: **CSX-057553-002**Dated: **April 25, 2007**Licensee Name: **Alabama Power Company**Licensee's Ref. Number: **n/a**City: **Calera**County: **Shelby**State: **AL**Railroad Milepost: **000 423.74**Division: **Atlanta**Subdivision: **S and N A South**Project Description: **Aerial Wireline Installation**

*****All information must be TYPED or CLEARLY PRINTED.*****

START DATE: _____

EXPECTED END DATE: _____

Billing Information: *Please provide the Current Billing Information*

Contact Name: _____

Telephone: _____

Company Name: _____

Address: _____

City: _____ State: _____ Zip: _____

Fax: _____ Email Address: _____

Project Contact Information: *Provide Current Project Contact Information if different from Billing Information*

Contact Name: _____

Telephone: _____

Company Name: _____

Address: _____

City: _____ State: _____ Zip: _____

Fax: _____ Email Address: _____

Licensee Contact Information:

Contact Name: _____

Telephone: _____

Company Name: _____

Address: _____

City: _____ State: _____ Zip: _____

Fax: _____ Email Address: _____

1. Complete the Outside Party Number Request Form, and fax it to the CSXT Roadmaster and Signal Manager, at the fax numbers provided below, at least thirty (30) days in advance of the date you desire to commence the project.
2. CSXT Roadmaster and/or the Signal Manager will obtain a CSXT Outside Party Number and arrange date(s) for flagging and/or locating CSXT signal facilities only.
3. If no response is received within one week after faxing this form, follow up by calling the Roadmaster's office at the telephone number provided below (ideally between the hours of 6:30 AM and 8:30 AM).

-----Any questions about the form should be faxed to 904-633-3450. -----

CSXT Contact Information: TO BE COMPLETED BY CSXT

ROADMASTER: _____

FAX: _____

PHONE: (_____) _____

SIGNAL MGR: _____

FAX: _____

PHONE: _____

NOTE: CSXT Roadmasters and/or Signal Managers are to forward a completed Report of Flagging Form (4846F) to the Specialist Field Billing on a weekly basis.20071029000498150 5/5 \$23.50
Shelby Cnty Judge of Probate, AL
10/29/2007 12:55:02PM FILED/CERT