

EASEMENT - DISTRIBUTION FACILITIES
(Metes and Bounds)

TO BE RECORDED: YES X NO _____

This instrument prepared by:

Larry D. Grant

Alabama Power Company

P. O. Box 2641

Birmingham, Alabama 35291

STATE OF ALABAMA }
COUNTY OF Shelby }
TAX ID # _____

W.E. No. 61700-00-0249-700
Parcel No. 70198107
Transformer No. _____

A. GRANT KNOW ALL MEN BY THESE PRESENTS, That Kerry D. Horton and wife Stephanie Horton

as grantors (s), (the "Grantor", whether one or more) for and in consideration of One and No/100 (\$1.00) and other good and valuable consideration, to Grantor in hand paid by Alabama Power Company, a corporation, the receipt and sufficiency of which are hereby acknowledged, does hereby grant to Alabama Power Company, its successors and assigns (the "Company"), the easements, rights and privileges described and designated in Section B below.

B. RIGHTS The easements, rights and privileges granted hereby are as follows:

- Overhead and/or Underground.** The right from time to time to construct, install, operate and maintain, upon, over, under and across the Property described in Section C below, along a route to be selected by the Company which is generally shown on the Company's final location drawing (which shows the general location of underground Facilities, if any, by indicating an area not greater than ten feet (10') in width), all poles, towers, wires, conduits, fiber optics, cables, trans closures, transformers, anchors, guy wires and other Facilities useful or necessary in connection therewith (collectively, "Facilities"), for the overhead and/or underground transmission and distribution of electric power, and also the right to clear and keep clear a strip of land extending five feet (5') to either side of the center line of underground Facilities and fifteen feet (15') to either side of the center line of overhead Facilities; further, the right in the future to install and utilize intermediate poles in line for overhead Facilities and the right to trim and cut and keep trimmed and cut all dead, weak, leaning or dangerous trees or limbs outside of the thirty foot (30') strip for overhead Facilities that, in the sole opinion of the Company, might now or may hereafter endanger, interfere with or fall upon any of the overhead Facilities.
- Line Clearing.** The right to trim and cut and keep trimmed and cut all dead, weak, leaning or dangerous trees or limbs that, in the sole opinion of the Company, might now or may hereafter endanger, interfere with or fall upon the electric transmission or distribution lines, poles, towers or other Facilities now or hereafter located adjacent to the Property described in Section C below along a route to be selected by the Company generally shown on the Company's final location drawing, and also the right to clear and keep clear all trees, undergrowth, and other obstructions on property in which Grantor has an interest within fifteen feet (15') of the center line of the lines of such poles, towers or other Facilities.
- Guy Wires and Anchors.** The right to implant, install and maintain anchor(s) of concrete, metal or other material on and under the Property described in Section C below, and to construct, extend and maintain guy wires from such anchor(s) to structures now or hereafter erected adjacent to such Property or property adjacent thereto (collectively, "Guy Wire Facilities") along a route to be selected by the Company generally shown on the Company's final location drawing; and also the right to trim and cut and keep trimmed and cut all dead, weak, leaning or dangerous trees or limbs that, in the sole opinion of the Company, might now or may hereafter endanger, interfere with or fall upon any of the Guy Wire Facilities.

Grantor hereby grants to the Company all easements, rights and privileges necessary or convenient for the full enjoyment and use thereof, including without limitation the right of ingress and egress to and from the Facilities and Guy Wire Facilities, as applicable, and the right to excavate for installation, replacement, repair and removal thereof; and also the right to cut, remove and otherwise keep clear any and all structures, obstructions or obstacles of whatever character, on, under and above said Facilities and Guy Wire Facilities, as applicable.

C. PROPERTY DESCRIPTION The easements, rights and privileges granted hereby shall apply to, and the word "Property" as used in this instrument shall mean, the following described real property situated in Shelby County, Alabama (the "Property"):

That part of
A parcel of land in the SE1/4 of the SW1/4 of Section 24,
Township 21 South, Range 1 West as is recorded in Deed Record
19920002164100000 in the office of the Judge of Probate of
Shelby County, Alabama, which is more particularly described on Exhibit
"A", attached hereto, and made a part and parcel hereof.

D. ADDITIONAL PROVISIONS. In the event it becomes necessary or desirable for the Company to move any of the Facilities in connection with the construction or improvement of any public road or highway in proximity to the Facilities, Grantor hereby grants to the Company the right to relocate the Facilities and, as to such relocated Facilities, to exercise the rights granted above; provided, however, the Company shall not relocate the Facilities on the Property at a distance greater than ten feet (10') outside the boundary of the right of way of any such public road or highway as established or re-established from time to time. This grant and agreement shall be binding upon and shall inure to the benefit of Grantor, the Company and each of their respective heirs, personal representatives, successors and assigns and the words "Company" and "Grantor" as used in this instrument shall be deemed to include the heirs, personal representatives, successors and assigns of such parties.

TO HAVE AND TO HOLD the same to the Company, its successors and assigns, forever.

IN WITNESS WHEREOF, the undersigned Grantor(s) ~~has~~ have set ~~his~~ their hand(s) and seal(s) this the 22 day of August, 2007.

Witness

Kerry D. Horton (SEAL)
(Grantor)

Witness

Stephanie Horton (SEAL)
(Grantor)

Witness

By: _____ (SEAL)
As:

20071029000497890 1/3 \$17.50
Shelby Cnty Judge of Probate, AL
10/29/2007 11:53:02AM FILED/CERT

IN WITNESS WHEREOF, the said Grantor, has caused this instrument to be executed by _____ its authorized representative, as of the _____ day of _____, 20____.

ATTEST (if corporation) or WITNESS:

(Grantor - Name of Corporation/Partnership/LLC)

By: _____
Its: _____

By: _____ (SEAL)
Its: _____

[indicate President, General Partner, Member, etc.]

INDIVIDUAL NOTARIES

STATE OF ALABAMA }
COUNTY OF Shelby }

I, the undersigned, a Notary Public, in and for said County in said State, hereby certify that Kerry D. Horton whose name(s) is/are signed to the foregoing instrument and who is/are known to me, acknowledged before me on this day that being informed of the contents of the instrument, he/she/they executed the same voluntarily, on the day the same bears date.

Given under my hand and official seal this the 22nd day of August, 2007.

[SEAL]

[Signature]
Notary Public
My commission expires: 9/27/07

STATE OF ALABAMA }
COUNTY OF Shelby }

I, the undersigned, a Notary Public, in and for said County in said State, hereby certify that Stephanie Horton whose name(s) is/are signed to the foregoing instrument and who is/are known to me, acknowledged before me on this day that being informed of the contents of the instrument, he/she/they executed the same voluntarily, on the day the same bears date.

Given under my hand and official seal this the 22nd day of August, 2007.

[SEAL]

[Signature]
Notary Public
My commission expires: 9/27/07

TRUSTEE/CORPORATION/PARTNERSHIP/LLC NOTARY

STATE OF ALABAMA }
COUNTY OF _____ }

I, the undersigned, a Notary Public, in and for said County in said State, hereby certify that _____

_____, whose name as _____ of _____

a _____ [as _____

_____] is signed to the foregoing instrument, and who is known to me, acknowledged before me on this day that being informed of the contents of the instrument, he/she, as such _____ and with full authority, executed the same voluntarily for and as the act of said _____ [acting in such capacity as aforesaid].

Given under my hand and official seal, this the _____ day of _____, _____

[SEAL]

Notary Public
My commission expires: _____

20071029000497890 2/3 \$17.50
Shelby Cnty Judge of Probate, AL
10/29/2007 11:53:02AM FILED/CERT

For Alabama Power Company Corporate Real Estate Department Use Only

All facilities on Grantor:

Station to Station: Sta # 1100 to Sta # 1120 (Curd)

Shelby County, AL 10/29/2007
State of Alabama

Deed Tax: \$.50

Exhibit "A"

70198107

Sketch of Proposed Work - Simplified W. E.



Customer	SCOTT VANSANT	Location	120 PINE HILL CIR	Agreed Serv. Date		County	SHELBY	Section	24	Township	215	Range	1W	Add'l Info		Estimate No.	61700-00-02497
Division	BIRMINGHAM	Operation	METRO-SOUTH	Engineer	FROST	LINC#	11060	Date	6-19-07	Substation	COLUMBIANA	X	19426	Y	RC2243	NJUNS Ticket #	Transformer Loading

NOTE: APCO CONTRACTOR TO PERFORM ALL TRENCHING
APCO TO BILL CUSTOMER PER CSP

SHORT CIRCUITS
3Ø - G= _____
Ø - G= _____
Ø - G Res= _____

ENERGIZED LINE WORK
SUB _____
OCB/OCR# _____
SWITCH# _____
FUSE SIZE _____

"MISS-ALL" # 1-800-292-8525	DATE CALLED _____	LOCATION REQUEST # _____	WATER WORKS DATE CALLED _____	TRANSFER OF ATTACHMENTS YES NO	OTHER _____	KNOLGY _____	CHARTER _____	OTHER _____						
PHONE CO.	Co. Name	CATV CO.	Co. Name	Accessible Heavy Traffic SW Amp	TREE CREW	PERMITS REQD	R/W	CITY	COUNTY	STATE	OTHER	SCALE	NTS	Ft Per Inch
Voltage Pri	7.2	120	KV	240										

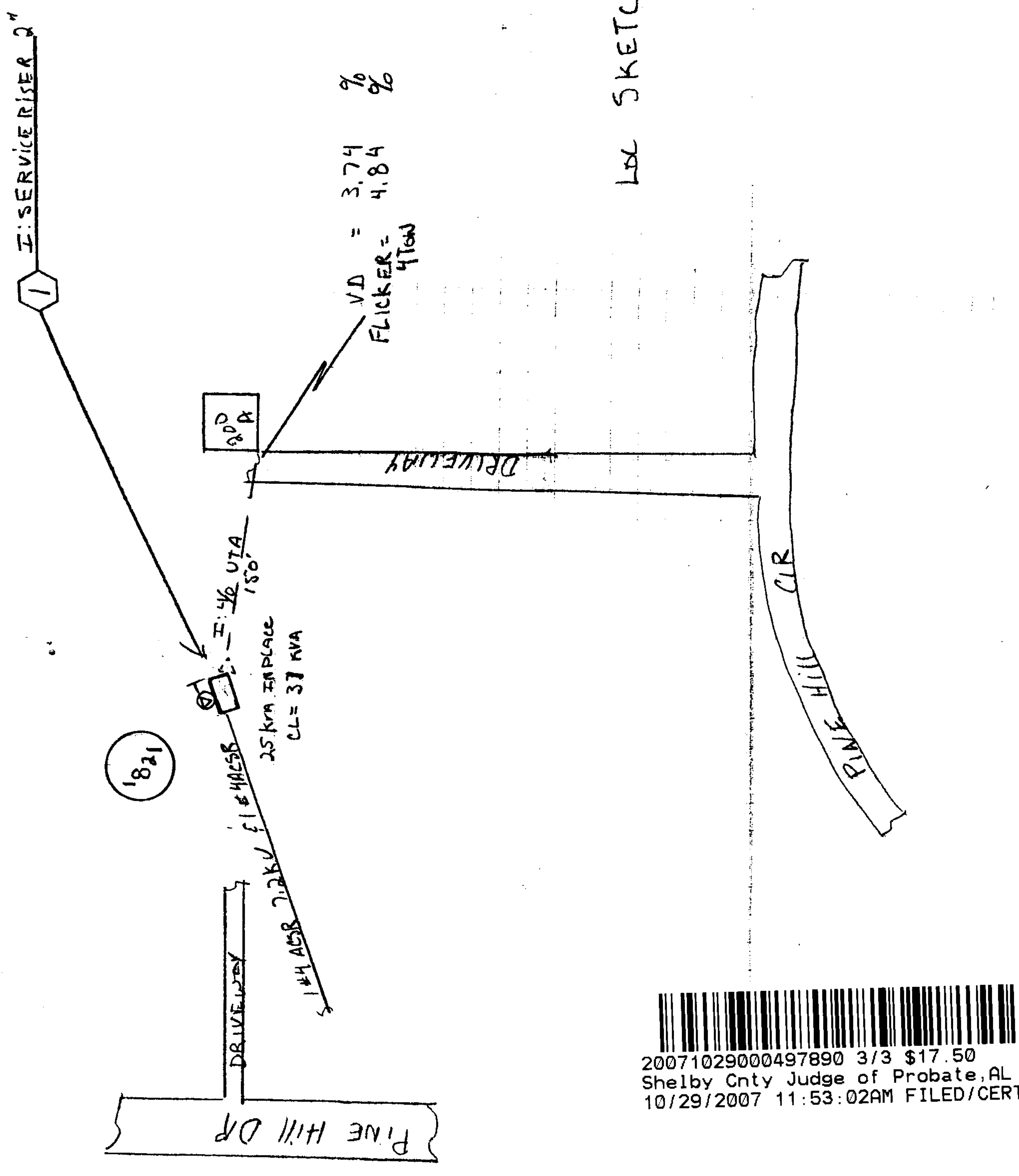

target ZERO ONE DAY AT A TIME

PERFORM JSA

LOC SKETCH

20071029000497890 3/3 \$17.50
Shelby Cnty Judge of Probate, AL
10/29/2007 11:53:02AM FILED/CERT

Cnst. Completed By _____ Date _____