

**This instrument prepared by:**

W.E. No. 61700-00-0351-700  
Parcel No. 70199236  
Transformer No. \_\_\_\_\_

Alabama Power Company  
P. O. Box 2641  
Birmingham, Alabama 35291

**B. RIGHTS** The easements, rights and privileges granted hereby are as follows:

1. **Overhead and/or Underground.** The right from time to time to construct, install, operate and maintain, upon, over, under and across the Property described in Section C below, along a route to be selected by the Company which is generally shown on the Company's final location drawing (which shows the general location of underground Facilities, if any, by indicating an area not greater than ten feet (10') in width), all poles, towers, wires, conduits, fiber optics, cables, trans closures, transformers, anchors, guy wires and other Facilities useful or necessary in connection therewith (collectively, "Facilities"), for the overhead and/or underground transmission and distribution of electric power, and also the right to clear and keep clear a strip of land extending five feet (5') to either side of the center line of underground Facilities and fifteen feet (15') to either side of the center line of overhead Facilities; further, the right in the future to install and utilize intermediate poles in line for overhead Facilities and the right to trim and cut and keep trimmed and cut all dead, weak, leaning or dangerous trees or limbs outside of the thirty foot (30') strip for overhead Facilities that, in the sole opinion of the Company, might now or may hereafter endanger, interfere with or fall upon any of the overhead Facilities.
2. **Line Clearing.** The right to trim and cut and keep trimmed and cut all dead, weak, leaning or dangerous trees or limbs that, in the sole opinion of the Company, might now or may hereafter endanger, interfere with or fall upon the electric transmission or distribution lines, poles, towers or other Facilities now or hereafter located adjacent to the Property described in Section C below along a route to be selected by the Company generally shown on the Company's final location drawing, and also the right to clear and keep clear all trees, undergrowth, and other obstructions on property in which Grantor has an interest within fifteen feet (15') of the center line of the lines of such poles, towers or other Facilities.
3. **Guy Wires and Anchors.** The right to implant, install and maintain anchor(s) of concrete, metal or other material on and under the Property described in Section C below, and to construct, extend and maintain guy wires from such anchor(s) to structures now or hereafter erected adjacent to such Property or property adjacent thereto (collectively, "Guy Wire Facilities") along a route to be selected by the Company generally shown on the Company's final location drawing; and also the right to trim and cut and keep trimmed and cut all dead, weak, leaning or dangerous trees or limbs that, in the sole opinion of the Company, might now or may hereafter endanger, interfere with or fall upon any of the Guy Wire Facilities.

**C. PROPERTY DESCRIPTION** The easements, rights and privileges granted hereby shall apply to, and the word "Property" as used in this instrument shall mean, the following described real property situated in Shelby County, Alabama (the "Property"):

A parcel of land in the NE 1/4 of NW 1/4 of Section 26,  
Township 21 S, Range 3W as recorded in  
DB 269- Pg 147 in the Office of the Judge  
of Probate of Shelby County, Alabama.



20071029000496810 1/4 \$20.50  
Shelby Cnty Judge of Probate, AL  
10/29/2007 09:00:28AM FILED/CERT

**D. ADDITIONAL PROVISIONS.** In the event it becomes necessary or desirable for the Company to move any of the Facilities in connection with the construction or improvement of any public road or highway in proximity to the Facilities, Grantor hereby grants to the Company the right to relocate the Facilities and, as to such relocated Facilities, to exercise the rights granted above; provided, however, the Company shall not relocate the Facilities on the Property at a distance greater than ten feet (10') outside the boundary of the right of way of any such public road or highway as established or re-established from time to time. This grant and agreement shall be binding upon and shall inure to the benefit of Grantor, the Company and each of their respective heirs, personal representatives, successors and assigns and the words "Company" and "Grantor" as used in this instrument shall be deemed to include the heirs, personal representatives, successors and assigns of such parties.

TO HAVE AND TO HOLD the same to the Company, its successors and assigns, forever.

IN WITNESS WHEREOF, the undersigned Grantor(s) has/have set his/her/their hand(s) and seal(s) this the 13<sup>th</sup> day of September, 2007

Southside Baptist Church (Seal)  
(Grantor)

Joe Yates - Trustee (SEAL)  
(Grantor)

By: \_\_\_\_\_ (SEAL)  
As: \_\_\_\_\_

IN WITNESS WHEREOF, the said Grantor, has caused this instrument to be executed by \_\_\_\_\_ its authorized representative, as of the \_\_\_\_\_ day of \_\_\_\_\_, 20\_\_\_\_.

ATTEST (if corporation) or WITNESS:

(Grantor - Name of Corporation/Partnership/LLC)

By: \_\_\_\_\_  
Its: \_\_\_\_\_

By: \_\_\_\_\_ (SEAL)  
Its: \_\_\_\_\_

[indicate President, General Partner, Member, etc.]

**INDIVIDUAL NOTARIES**

STATE OF ALABAMA }  
COUNTY OF Jefferson }

I, the undersigned, a Notary Public, in and for said County in said State, hereby certify that Joe Yates  
\_\_\_\_\_ whose name(s) is/are signed to the foregoing instrument and who is/are known to me, acknowledged before me on this day that being informed of the contents of the instrument, he/she/they executed the same voluntarily, on the day the same bears date.

Given under my hand and official seal this the 13<sup>th</sup> day of September, 2007.

[SEAL]

Sharon C DeRose

Notary Public

My commission expires: Oct. 12, 2010

**MY COMMISSION EXPIRES OCTOBER 12, 2010**

STATE OF ALABAMA }  
COUNTY OF \_\_\_\_\_ }

I, the undersigned, a Notary Public, in and for said County in said State, hereby certify that \_\_\_\_\_  
\_\_\_\_\_ whose name(s) is/are signed to the foregoing instrument and who is/are known to me, acknowledged before me on this day that being informed of the contents of the instrument, he/she/they executed the same voluntarily, on the day the same bears date.

Given under my hand and official seal this the \_\_\_\_\_ day of \_\_\_\_\_, \_\_\_\_\_.

[SEAL]

Notary Public

My commission expires: \_\_\_\_\_

**TRUSTEE/CORPORATION/PARTNERSHIP/LLC NOTARY**

STATE OF ALABAMA }  
COUNTY OF \_\_\_\_\_ }



20071029000496810 2/4 \$20.50  
Shelby Cnty Judge of Probate, AL  
10/29/2007 09:00:28AM FILED/CERT

I, the undersigned, a Notary Public, in and for said County in said State, hereby certify that \_\_\_\_\_

\_\_\_\_\_, whose name as \_\_\_\_\_ of \_\_\_\_\_

\_\_\_\_\_ a \_\_\_\_\_ [as \_\_\_\_\_

\_\_\_\_\_, is signed to the foregoing instrument, and who is known to me, acknowledged before me on this day that being informed of the contents of the instrument, he/she, as such \_\_\_\_\_ and with full authority, executed the same voluntarily for and as the act of said \_\_\_\_\_ [acting in such capacity as aforesaid].

Given under my hand and official seal, this the \_\_\_\_\_ day of \_\_\_\_\_, \_\_\_\_\_.

[SEAL]

Notary Public

My commission expires: \_\_\_\_\_

**For Alabama Power Company Corporate Real Estate Department Use Only**

All facilities on Grantor: X

Station to Station: \_\_\_\_\_

Shelby County, AL 10/29/2007  
State of Alabama

Deed Tax: \$.50

Customer SOUTHSIDE BAPTIST CHURCH				Location HWY 119					Agreed Serv. Date			Estimate No. 61700-00-03517			
Region BIRMINGHAM				Oper. Cntr. METRO SOUTH			Town/City MONTEVALLO			UserID kdmcdani		Created: 9/6/2007			
County Shelby			Section 23		Township 21S		Range 03W		Add'l Info						
Acquisition Agent				Date R/W Assigned			Date R/W Cleared		Spatial Reference		LOC		Transformer Loading		
Voltage	Phone Co	CATV Co	Accessible		Tree Crew		Rock Hole			R/W	City	County	State	Miss All	Other
34.5kV	N	N	YES		N		N		Permits	YES	N	N	N	YES	

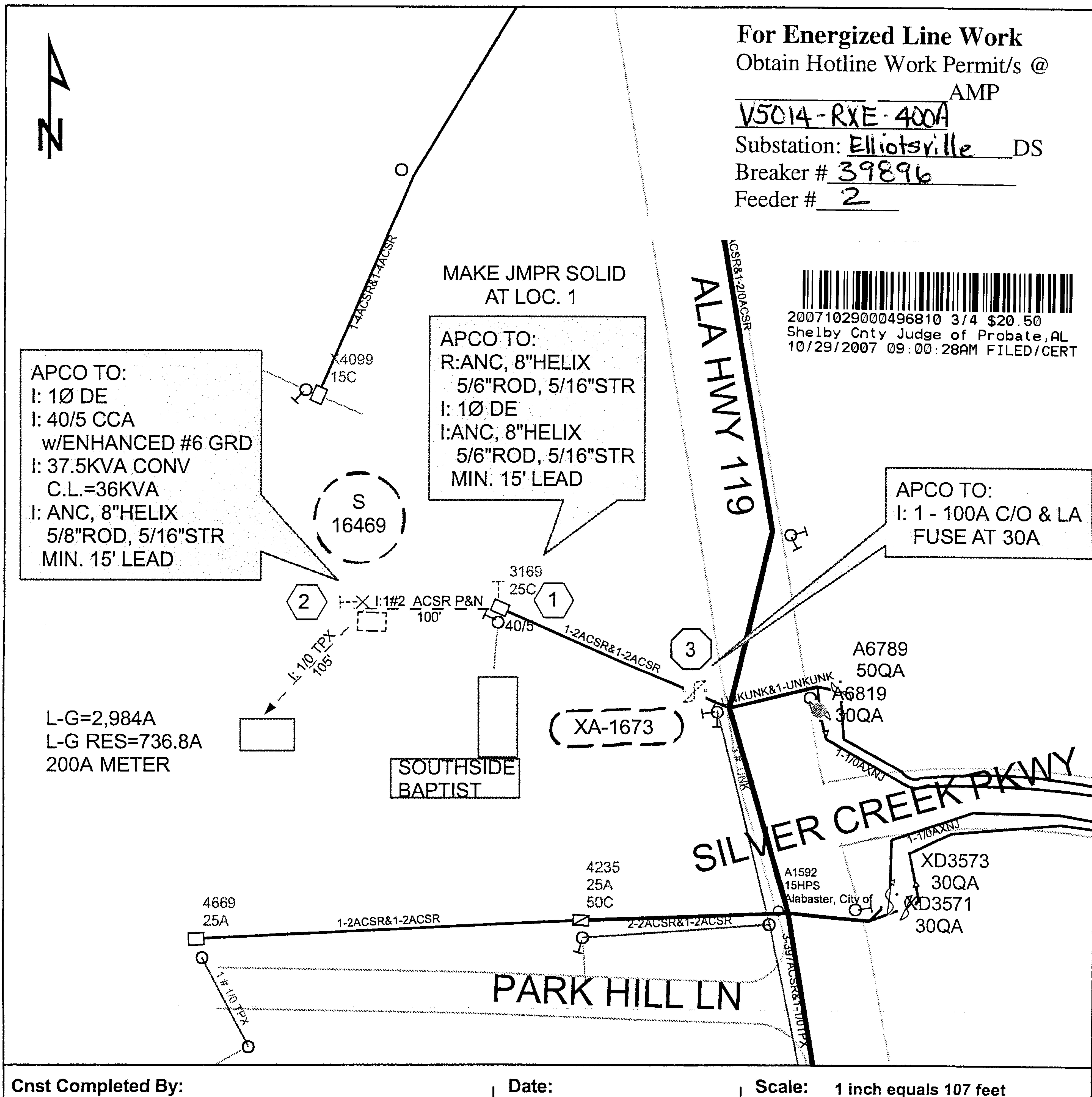

70199236

Sub Ellitsville DS.  
bkr 39896

Sheet 2 of 2

61700-00-03517

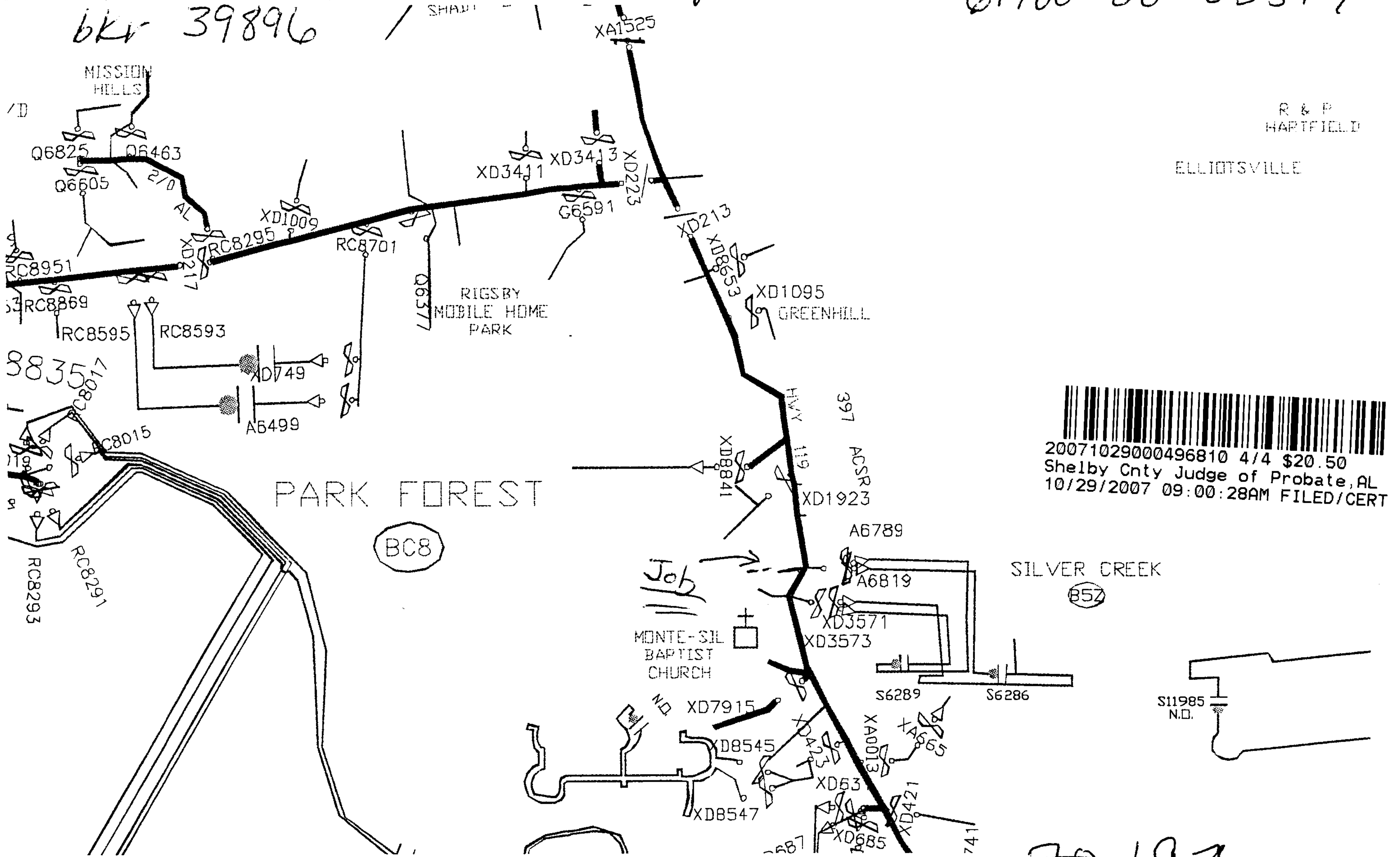

SECTIONALIZING SKETCH

70192

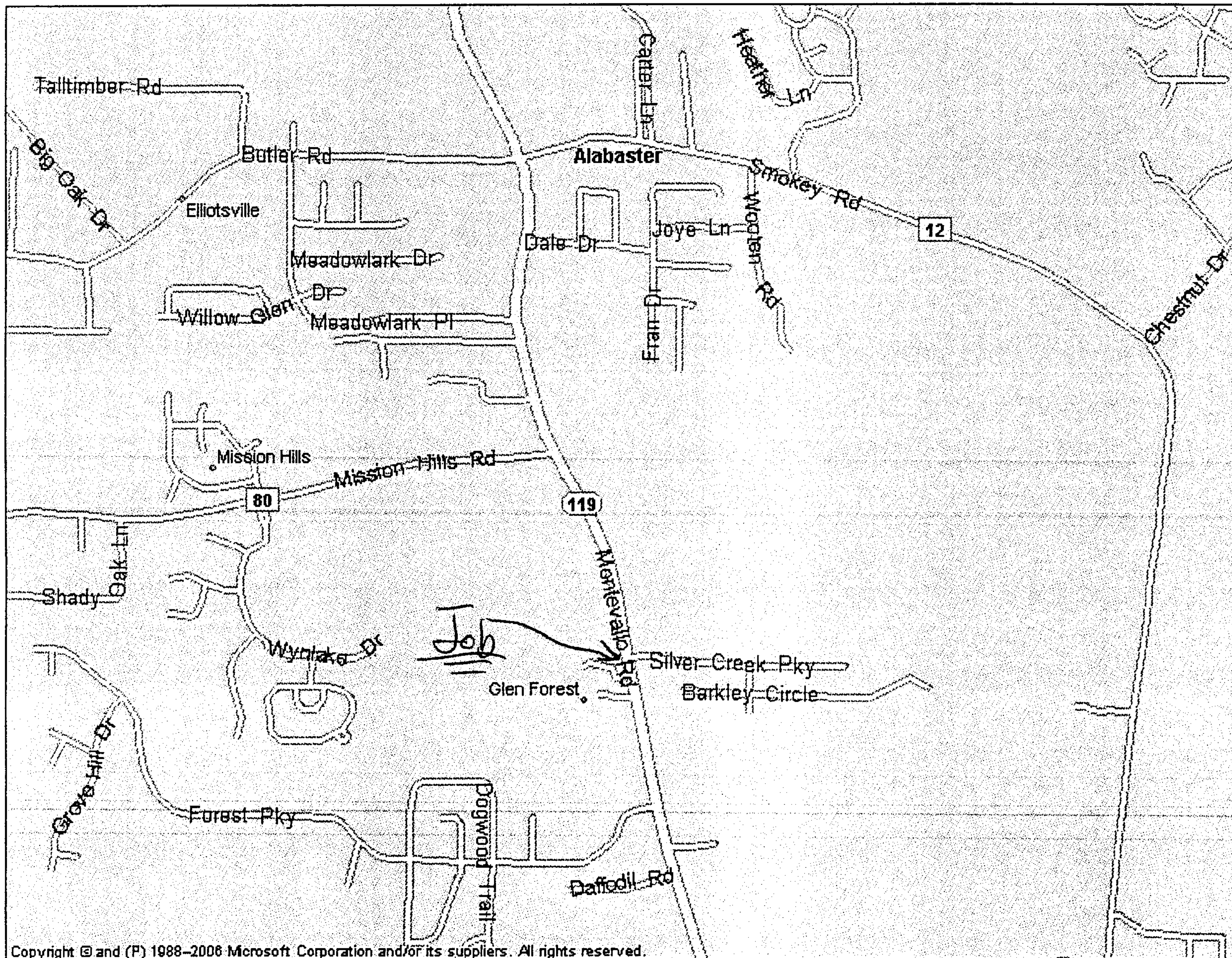

LOCATION SKETCH

70199236