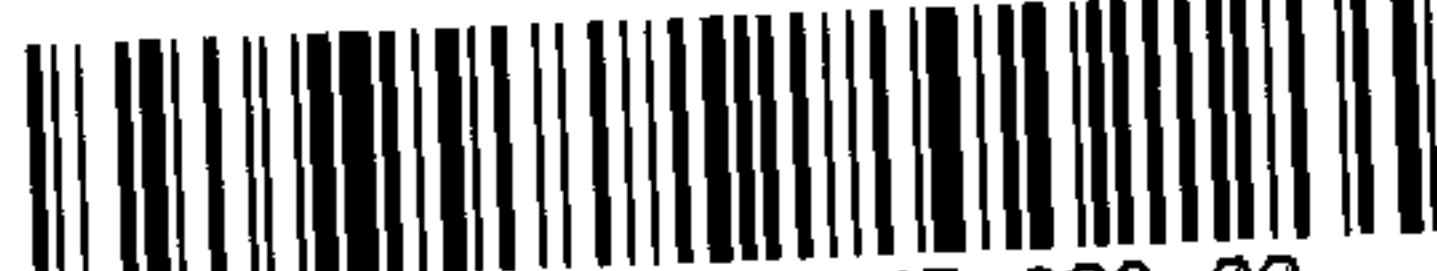

**Town of Westover**  
P.O. Box 356  
Westover, Alabama 35185

  
20070814000383520 1/5 \$23.00  
Shelby Cnty Judge of Probate, AL  
08/14/2007 03:37:09PM FILED/CERT

**Certification  
Of  
Annexation Ordinance**

Ordinance Number: 2007-07-17-134

Property Owner(s): James and Jennifer Crisman

Property: 08-8-33-0-000-014.002

I, Wayne Jones, town clerk of the Town of Westover, Alabama  
Hereby certify the attached to be a true and correct copy of an  
Ordinance adopted by the Town Council of Westover, at the regular  
meeting held on July 17, 2007 as same appears in the minutes  
of record of said meeting, and published by posting copies thereof on  
August 1, 2007 at the places listed below, which copies remained posted  
for five (5) business days through August 8, 2007 .

Westover Town Hall, 3312 Westover Road, Westover, Alabama 35147  
Westover Water Authority, US Highway 280, Westover, Alabama 35147  
Westover Leisure Wear, 4769 Old Highway 280, Westover, Alabama 35147  
Westover Post Office, Hwy 55, Westover, Alabama 35147

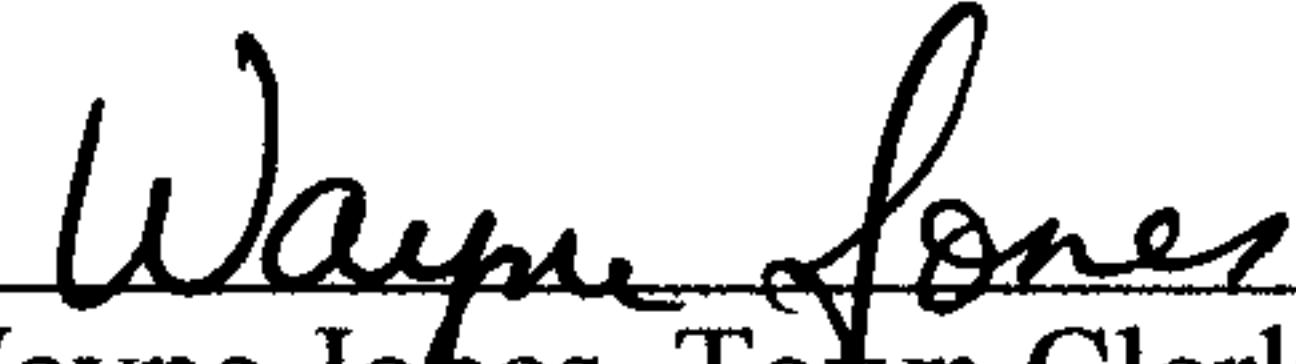
  
\_\_\_\_\_  
Wayne Jones, Town Clerk

ORDINANCE NO. 2007-07-17-134

WHEREAS, on the 17<sup>th</sup> day of July, 2007, James C. Crisman, III and wife, Jennifer Kay Crisman filed a petition with the Town of Westover, Alabama, as required by §§ 11-42-20 and 11-42-21, Code of Alabama 1975, as amended, petitioning and requesting that the property hereinafter described be annexed to the municipality of the Town of Westover, Alabama, which petition contained an accurate description of the property proposed to be annexed together with a map of the said property showing its relationship to the corporate limits of the Town of Westover, Alabama, and the signatures of the owners of the property described were signed thereto;

NOW, THEREFORE, BE IT ORDAINED BY THE TOWN COUNCIL OF THE TOWN OF WESTOVER, ALABAMA, AS FOLLOWS:

1. That the Town of Westover, Alabama, does adopt this Ordinance assenting to the annexation of the following described property to the municipality of the Town of Westover:

Lot 2, Blue Horizon, First Sector, as recorded in the Office of the Judge of Probate, Shelby County, Alabama, in Map Book 14, Page 106, less and except the following described part: From the Northeast corner of Lot 2, Blue Horizon, First Sector, as recorded in the Office of the Judge of Probate, Shelby County, Alabama, in Map Book 14, Page 106, run in a Westerly direction along the North line of said Lot 2 for a distance of 212.10 feet to the Northwest corner of said Lot 2; thence turn an angle to the left of 91 degrees 21 minutes 10 seconds and run in a Southerly direction along the West line of said Lot 2 for a distance of 86.38 feet; thence turn an angle to the left of 90 degrees 50 minutes 30 seconds and run in an Easterly direction for a distance of 212.84 feet to a point on the East line of said Lot 2; thence turn an angle to the left of 89 degrees 43 minutes 25 seconds and run in a Northerly direction along the East line of said Lot 2 for a distance of 78.25 feet, more or less, to the point of beginning.

2. That the corporate limits of the Town of Westover, Alabama, be extended and rearranged so as to embrace and include such property, and such property shall become a part of the corporate area of such municipality upon the date of publication or posting of this Ordinance, as provided for in the Code of Alabama as cited above.

3. That the Town Clerk be and he is hereby authorized and directed to file a copy of this Ordinance, including an accurate description of the property being annexed, together with a map of the said property showing its relationship to the corporate limits of the Town of Westover, Alabama, to which said property is being annexed, in the office of the Judge of Probate of Shelby County, Alabama.

4. That the Zoning Map of the Town of Westover, Alabama, and any other official maps or surveys of the Town shall be amended to reflect the annexation of the above-described property, and that a copy of this Ordinance be transmitted to the Town Planning Commission.

5. That this property is temporarily zoned AP as provided in the Zoning Ordinance of the Town of Westover, Alabama.

This ordinance was adopted and passed by the Town Council of the Town of Westover, Alabama, this the 17<sup>th</sup> day of July, 2007.

Town of Westover, Alabama

by

  
Mayor

Attest:

  
Clerk

PETITION FOR ANNEXATION  
TOWN OF WESTOVER, AL.

20070814000383520 4/5 \$23.00  
Shelby Cnty Judge of Probate, AL  
08/14/2007 03:37:09PM FILED/CERT

The undersigned owner(s) of the property described below, which is described in the attached "Exhibit A" and is contiguous to the corporate limits of Westover, Alabama do hereby petition the town of Westover to annex said property into the corporate limits of the municipality.

Name: James and Jennifer Crisman

Property Address: 1073 Rock School Rd

City/State/Zip Code: Harpersville, AL 35078

Telephone Number: 205-678-3530

Parcel ID Number: 088330000014.003 + 088330000014.002  
(As listed on property tax notice)

Number of registered voters residing at this Parcel 2

SIGNATURE OF PROPERTY OWNER(S)

(All owners listed on the deed must sign)

James Crisman

Jennifer Crisman

\_\_\_\_\_  
\_\_\_\_\_  
\_\_\_\_\_

\_\_\_\_\_  
\_\_\_\_\_  
\_\_\_\_\_

PLEASE RETURN COMPLETED PETITION IMMEDIATELY TO THE PERSON  
PROVIDING THE PETITION, OR MAIL TO:  
**WESTOVER ANNEXATION COMMITTEE • P.O. BOX 356 • WESTOVER, AL**  
**35185 Phone 678-3376**

20070814000383520 5/5 \$23.00  
 Shelby Cnty Judge of Probate, AL  
 08/14/2007 03:37:09PM FILED/CERT

SCGIS - Shelby County, Alabama - Geographic Information System

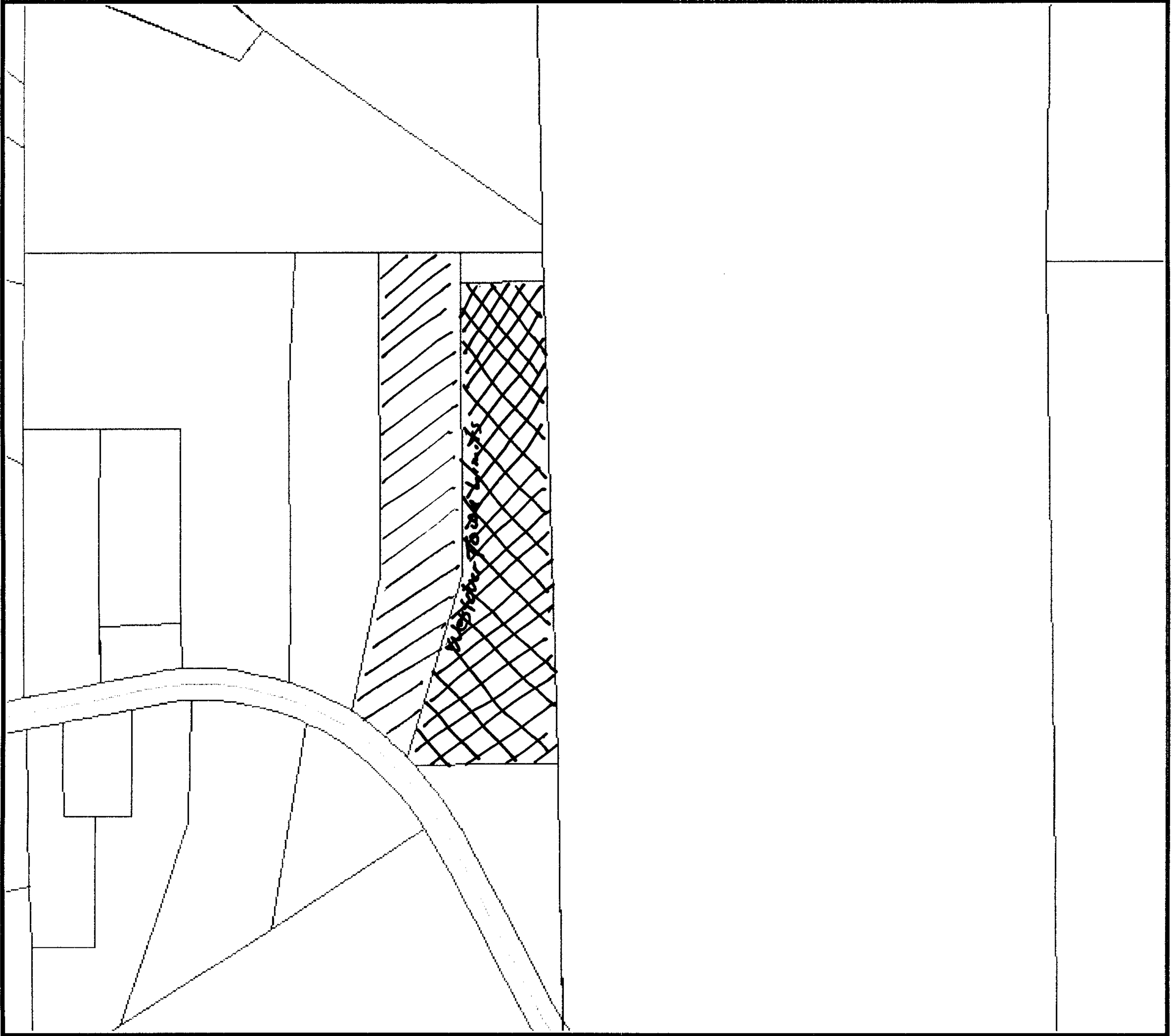

Map by SCGIS - Copyright 2007

Range: 2979.21 feet

**Disclaimer.** The Shelby County Commission, Shelby County, Alabama, its employees, agents and personnel, Shelby County Elected Officials, MAKES NO WARRANTY OF MERCHANTABILITY OR WARRANTY FOR FITNESS OF USE FOR A PARTICULAR PURPOSE, EXPRESS OR IMPLIED, NOR ANY OTHER WARRANTY WITH RESPECT TO THE INFORMATION CONTAINED ON THIS WEB SITE OR IN ANY WAY RELATED THERETO. MAP AND ALL OTHER INFORMATION IS TO BE USED FOR TAX PURPOSES ONLY, NOT TO BE USED FOR CONVEYANCE. Any user of this information accepts the same AS IS, WITH ALL FAULTS, and assumes all responsibility for the use thereof, and futher convenants and agrees to hold the The Shelby County Commission, Shelby County, Alabama, its employees, agents and personnel, Shelby County Elected Officials, harmless from and against any damage, loss or liability arising from any use of the information.

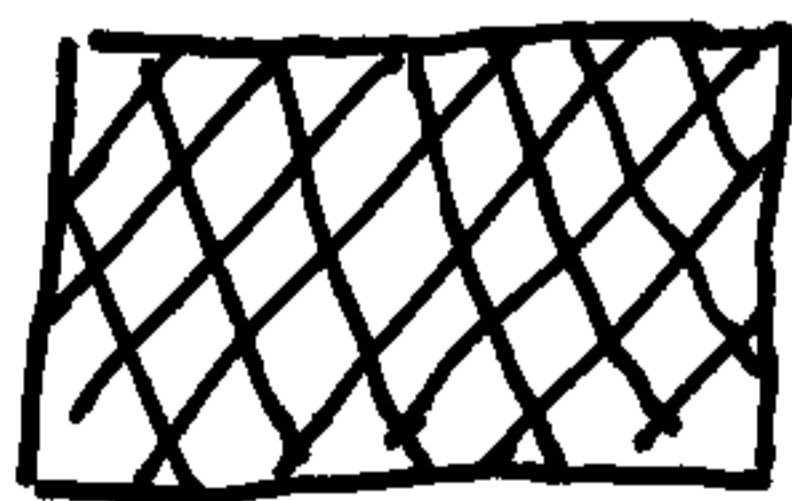

Annexed

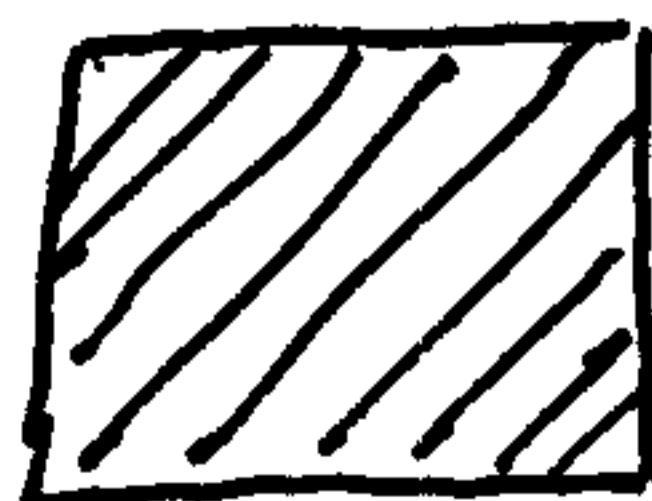

TO BE ANNEKED