

EASEMENT - DISTRIBUTION FACILITIES
(Metes and Bounds)

STATE OF ALABAMA }
COUNTY OF Shelby }
TAX ID # _____

TO BE RECORDED: YES ☒ NO ☐

W.E. No. 61730-00-00157
Parcel No. 70190854
Transformer No. X 6729

Sta. 1+00 to 1+120

This instrument prepared by:

Matt Fields

Alabama Power Company

P. O. Box 2641

Birmingham, Alabama 35291

A. GRANT KNOW ALL MEN BY THESE PRESENTS, That Carter Homebuilders Inc

as grantors (s), (the "Grantor", whether one or more) for and in consideration of One and No/100 (\$1.00) and other good and valuable consideration, to Grantor in hand paid by Alabama Power Company, a corporation, the receipt and sufficiency of which are hereby acknowledged, does hereby grant to Alabama Power Company, its successors and assigns (the "Company"), the easements, rights and privileges described and designated in Section B below.

B. RIGHTS The easements, rights and privileges granted hereby are as follows:

- Overhead and/or Underground.** The right from time to time to construct, install, operate and maintain, upon, over, under and across the Property described in Section C below, along a route to be selected by the Company which is generally shown on the Company's final location drawing (which shows the general location of underground Facilities, if any, by indicating an area not greater than ten feet (10') in width), all poles, towers, wires, conduits, fiber optics, cables, trans closures, transformers, anchors, guy wires and other Facilities useful or necessary in connection therewith (collectively, "Facilities"), for the overhead and/or underground transmission and distribution of electric power, and also the right to clear and keep clear a strip of land extending five feet (5') to either side of the center line of underground Facilities and fifteen feet (15') to either side of the center line of overhead Facilities; further, the right in the future to install and utilize intermediate poles in line for overhead Facilities and the right to trim and cut and keep trimmed and cut all dead, weak, leaning or dangerous trees or limbs outside of the thirty foot (30') strip for overhead Facilities that, in the sole opinion of the Company, might now or may hereafter endanger, interfere with or fall upon any of the overhead Facilities.
- Line Clearing.** The right to trim and cut and keep trimmed and cut all dead, weak, leaning or dangerous trees or limbs that, in the sole opinion of the Company, might now or may hereafter endanger, interfere with or fall upon the electric transmission or distribution lines, poles, towers or other Facilities now or hereafter located adjacent to the Property described in Section C below along a route to be selected by the Company generally shown on the Company's final location drawing, and also the right to clear and keep clear all trees, undergrowth, and other obstructions on property in which Grantor has an interest within fifteen feet (15') of the center line of the lines of such poles, towers or other Facilities.
- Guy Wires and Anchors.** The right to implant, install and maintain anchor(s) of concrete, metal or other material on and under the Property described in Section C below, and to construct, extend and maintain guy wires from such anchor(s) to structures now or hereafter erected adjacent to such Property or property adjacent thereto (collectively, "Guy Wire Facilities") along a route to be selected by the Company generally shown on the Company's final location drawing; and also the right to trim and cut and keep trimmed and cut all dead, weak, leaning or dangerous trees or limbs that, in the sole opinion of the Company, might now or may hereafter endanger, interfere with or fall upon any of the Guy Wire Facilities.

Grantor hereby grants to the Company all easements, rights and privileges necessary or convenient for the full enjoyment and use thereof, including without limitation the right of ingress and egress to and from the Facilities and Guy Wire Facilities, as applicable, and the right to excavate for installation, replacement, repair and removal thereof; and also the right to cut, remove and otherwise keep clear any and all structures, obstructions or obstacles of whatever character, on, under and above said Facilities and Guy Wire Facilities, as applicable.

C. PROPERTY DESCRIPTION The easements, rights and privileges granted hereby shall apply to, and the word "Property" as used in this instrument shall mean, the following described real property situated in Shelby County, Alabama (the "Property"):

A parcel of land NW 1/4 NW 1/4 of Section 10, Township 19S, Range 2W
Recorded in 20050209000065040 Acre Instrument in the office of Judge
of probate Shelby County, Alabama

D. ADDITIONAL PROVISIONS. In the event it becomes necessary or desirable for the Company to move any of the Facilities in connection with the construction or improvement of any public road or highway in proximity to the Facilities, Grantor hereby grants to the Company the right to relocate the Facilities and, as to such relocated Facilities, to exercise the rights granted above; provided, however, the Company shall not relocate the Facilities on the Property at a distance greater than ten feet (10') outside the boundary of the right of way of any such public road or highway as established or re-established from time to time. This grant and agreement shall be binding upon and shall inure to the benefit of Grantor, the Company and each of their respective heirs, personal representatives, successors and assigns and the words "Company" and "Grantor" as used in this instrument shall be deemed to include the heirs, personal representatives, successors and assigns of such parties.

TO HAVE AND TO HOLD the same to the Company, its successors and assigns, forever.

IN WITNESS WHEREOF, the undersigned Grantor(s) has/have set his/her/their hand(s) and seal(s) this the 11 day of December, 2006.

Witness

Witness

Witness

(Grantor)

Carter Homebuilders Inc (SEAL)

(Grantor)

By: [Signature] (SEAL)

As:

President
Kerry Carter
369 4435

IN WITNESS WHEREOF, the said Grantor, has caused this instrument to be executed by _____, its authorized representative, as of the _____ day of _____, 20_____.

ATTEST (if corporation) or WITNESS:

(Grantor - Name of Corporation/Partnership/LLC)

By: _____
Its: _____

By: _____ (SEAL)
Its: _____

[indicate President, General Partner, Member, etc.]

INDIVIDUAL NOTARIES

STATE OF ALABAMA }
COUNTY OF _____ }

I, the undersigned, a Notary Public, in and for said County in said State, hereby certify that _____ whose name(s) is/are signed to the foregoing instrument and who is/are known to me, acknowledged before me on this day that being informed of the contents of the instrument, he/she/they executed the same voluntarily, on the day the same bears date.
Given under my hand and official seal this the _____ day of _____, _____.

[SEAL]

Notary Public
My commission expires: _____

STATE OF ALABAMA }
COUNTY OF _____ }

I, the undersigned, a Notary Public, in and for said County in said State, hereby certify that _____ whose name(s) is/are signed to the foregoing instrument and who is/are known to me, acknowledged before me on this day that being informed of the contents of the instrument, he/she/they executed the same voluntarily, on the day the same bears date.
Given under my hand and official seal this the _____ day of _____, _____.

[SEAL]

Notary Public
My commission expires: _____

TRUSTEE/CORPORATION/PARTNERSHIP/LLC NOTARY

STATE OF ALABAMA }
COUNTY OF Shelby }

I, the undersigned, a Notary Public, in and for said County in said State, hereby certify that Kerry Carter whose name as President of Carter Homebuilders Inc. a _____ [as _____], is signed to the foregoing instrument, and who is known to me, acknowledged before me on this day that being informed of the contents of the instrument, he/she, as such President and with full authority, executed the same voluntarily for and as the act of said _____ [acting in such capacity as aforesaid].

Given under my hand and official seal, this the 11 day of December, 2006.

[SEAL]

Matthew Tyler Fuld
Notary Public
My commission expires: 10-18-08

For Alabama Power Company Corporate Real Estate Department Use Only

All facilities on Grantor: _____ Station to Station: _____

Shelby County, AL 05/17/2007
State of Alabama
Deed Tax: \$.50

20070517000230530 2/3 \$17.50
Shelby Cnty Judge of Probate, AL
05/17/2007 02:01:03PM FILED/CERT

70190854

SKETCH OF PROPOSED WORK - SIMPLIFIED W.E.

Map Center:
270-10542

LatLon Center:
32.7287613270839; -86.9532983308018



Customer CARTER HOME BUILDERS		Location 5060 CALDWELL MILL RD			Agreed Serv. Date		Estimate No. 61730-00-00157					
Region PD-BIRMINGHAM		Oper. Cntr. METRO SOUTH		Town/City HOOVER		UserID: RWLOWMAN		Created: 2/21/2005 4:59:04 PM				
County: Shelby		Section 10	Township 19S	Range 02W	Add'l Info REF# 8855206							
Acquisition Agent FIELDS		Date R/W Assigned		Date R/W Cleared		Map Reference		Xfmr Loading 13 KVA	V _D 1.30%	F _{VD} 4.25%		
Voltage	Phone Co	CATV Co	Accessible	Tree Crew	Rock Hole		R/W	City	County	State	Miss All	Other
120/240V			Y				Permits Y					

MISSALL REFERENCE NUMBER:

VALID FROM: TILL



R: 15 KVA CV, 25 KVA CV, TRI MT,
R: (1) CO, (1) LA T: (1) CO, (1) LA
I: 37.5 KVA CV, T-BKT, CO, LA
I: 2 #250 & 1 #3/0 UG, SVC RISER

* 37.5 kVA INSTALLED
FOR FLICKER.

CUSTOMER TO INSTALL CONDUIT
APCO PROVIDES.

320 A SOCKET
STON
UNIT

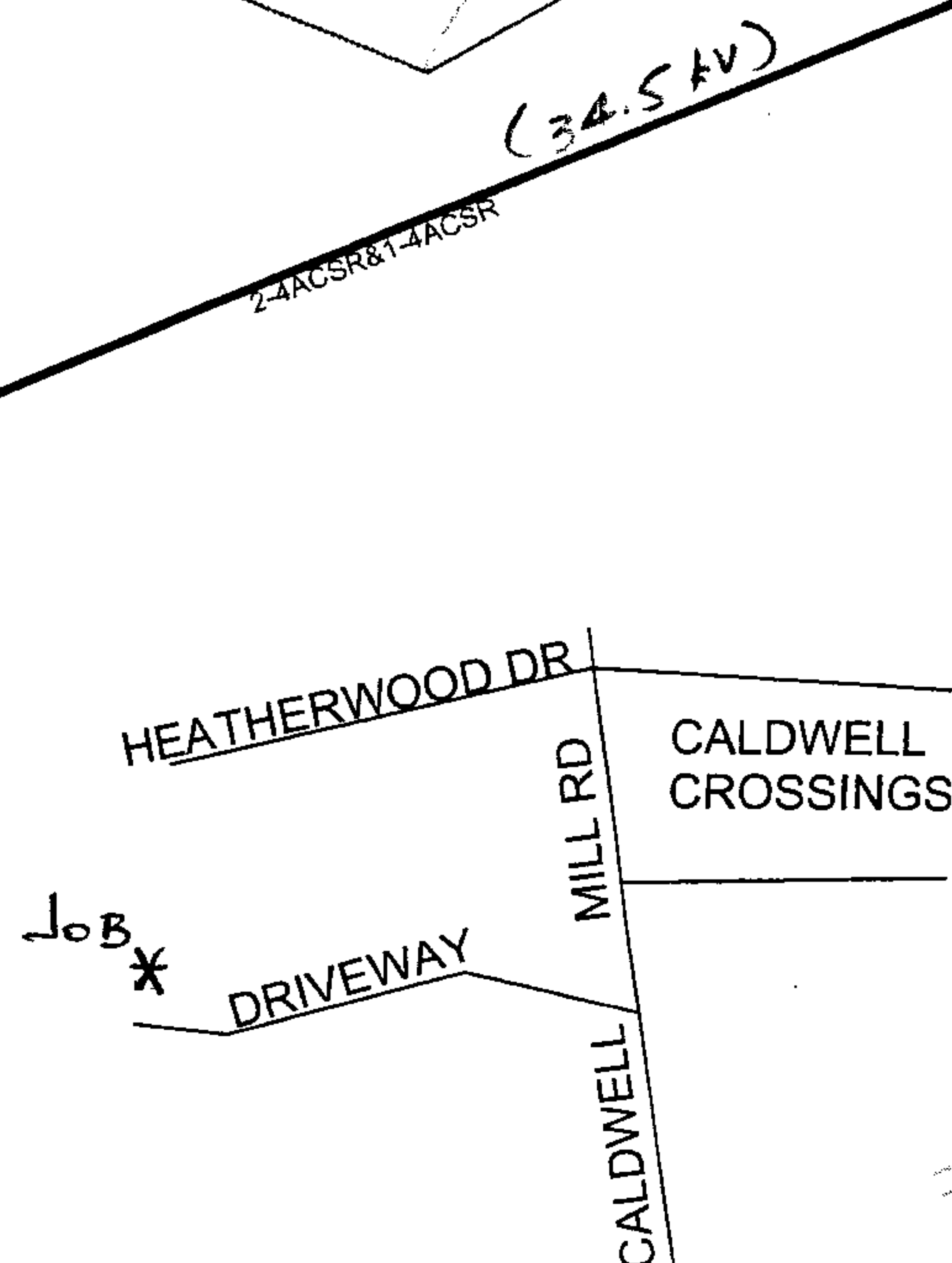

20070517000230530 3/3 \$17.50
Shelby Cnty Judge of Probate, AL
05/17/2007 02:01:03PM FILED/CERT

FAULT CURRENT = 3428 A

SUBSTATION: INDIAN SPRINGS #1

48716 L8435

Date:

Scale: 1 inch equals 100 feet

Foreman : Holding for : Material : Arrivial: