

• 49.50 • Lay Dam - Calera T.S. Tap Reconnector  
A-403998 (FL-6-4-4)  
Sta 873+93



Norfolk Southern Corporation  
Real Estate  
1200 Peachtree Street, N.E.  
12<sup>th</sup> Floor  
Atlanta, GA 30309-3504

In SE 1/4 of NE 1/4 of  
Section 21, Township  
22 South, Range 2 West,  
Shelby County, Alabama

Sheila K. Billingsley  
Property Manager  
Phone: (404) 962-5650  
Mobile: (404) 558-7503  
FAX: (404) 653-3422  
E-Mail: [skbillin@nscorp.com](mailto:skbillin@nscorp.com)

January 12, 2007  
Activity No. 1094743

70188960



20070418000180050 1/7 \$29.50  
Shelby Cnty Judge of Probate, AL  
04/18/2007 12:56:57PM FILED/CERT

Mr. Jerry D. Roberson  
Alabama Power  
600 North 18<sup>th</sup> Street  
P. O. Box 2641  
Birmingham, Alabama 35291

**RE: Calera, Shelby County, Alabama** - Wire line crossing located at Mile Post 130-N plus 3,295 feet (No. 24 of the Letter Agreement revised October 24, 2006); application fee \$500.00; crossing fee \$2,500.00.

Dear Mr. Roberson:

In response to your submission of the referenced application, please be advised that under the terms of the "Letter Agreement" between our respective companies dated February 14, 2006, and last revised October 25, 2006, construction of the referenced crossing is approved in accordance with and limited to the installation shown on drawing numbered A-403998 dated June 15, 2005, and last revised October 19, 2006, attached hereto as Exhibit A and made a part hereof. Enclosed please find one duly execute original of the Letter Agreement covering No. 24 which has been executed by Mr. Cataland.

Receipt of Check No. 0003094 in the amount of \$3,000.00 dated October 25, 2006, as payment of the above fees is hereby acknowledged.

Insurance requirements for this and other projects for Southern Company and its subsidiaries have been approved by Railway Risk Manager, Mr. Scott Dickerson, through April 30, 2007. If you have questions regarding insurance, Mr. Dickerson's telephone number is 757/629-2364.

Please contact the following Railway personnel at least one week prior to the beginning of construction within Railway's right-of-way to schedule protection and inspection for this project.

Mr. W. B. Kerchof, Alabama Div. Engineer, Birmingham, AL - (205) 951-4723  
Mr. R. B. Smith, Alabama Div. C&S, Birmingham, AL - (205) 951-8069

The Division Engineer will advise you of the costs for protection.

Very truly yours,

Sheila K. Billingsley

SKB/blp:iManage#432643v1  
Enclosures - as indicated





NS INTERNAL PROCESSING FORM FOR  
APPLICATION FOR WIRE LINE AGREEMENT, FORM 11600

DEC 05 2006

I.D. No. 24

BARBARA PRESSLEY

REAL ESTATE & CONTRACT SERVICES: (RE&CS File I.D. No. 1094743)

Date Issued: \_\_\_\_\_  
Date Received: \_\_\_\_\_

1. Upon receipt of completed application and drawing, add application I.D. Number to this Form and to Form 11600. 70188960
2. Complete the information in this section and attach Form 11600 and the drawing to this page.
3. Forward a copy of this form and all attachments to the Office of Chief Engineer, Signal and Electrical and the Division Superintendent.

UTILITY REQUESTED: Wire Line Upgrade ☒ Crossing ☐ Parallel Occupation

Applicant: Alabama Power Company

Formal NS Railroad Name: Southern Railway Company

Operating Division: Alabama

Reporting Location (City, State): Calera, Alabama

(Distance, Direction, and Prefix or Suffix): M.P. 130-N minus 1320 Feet

Is there existing agreements covering the wire line? ☒ Yes ☐ No

If yes, identify and attach copies: \_\_\_\_\_

Does the applicant have a master agreement that will cover the wire line? ☐ Yes ☐ No

If yes, identify Negotiations in process

Has Railroad negotiated any special agreement language with this applicant (indemnification, self-insurance, No

If yes, specify: \_\_\_\_\_

Does this installation serve a Railroad facility or a Railroad tenant? ☐ Yes ☒ No

If yes, specify: \_\_\_\_\_

Approved by: Barbara Pressley Date: 11/10/06

OFFICE OF CHIEF ENGINEER, [S&E File I.D. No. \_\_\_\_\_] Date Received: \_\_\_\_/\_\_\_\_/\_\_\_\_  
SIGNAL AND ELECTRICAL:

Review application and complete this section.

Forward with all attachments to Real Estate

And Contract Services

Approved by: \_\_\_\_\_ Date: \_\_\_\_/\_\_\_\_/\_\_\_\_

OFFICE OF CHIEF ENGINEER, DESIGN [S&E File I.D. No. \_\_\_\_\_] Date Received: \_\_\_\_/\_\_\_\_/\_\_\_\_  
AND CONSTRUCTION:

Review application and complete this section.

Forward with all attachments to Real Estate DESIGN

And Contract Services

CITY: CALERA STATE: AL  
MP 130-N ☒ Plus ☐ Minus 3,295 feet  
RR: SCV V 84 196  
R/W: 50' / 50'  
PARCEL NO. 4

If applicable, has applicant provided sufficient evidence that wire line/cable is located entirely within the confines of a public street?

☐ Yes ☒ No

Will there be any additional facilities on the right of way? ☐ Yes ☒ No

If yes, specify: \_\_\_\_\_

List any other special provisions to be included: \_\_\_\_\_

Prepared by (initials): \_\_\_\_\_ Approved by: M. J. DEVEREAUX / B.P. Date: 12/1/06

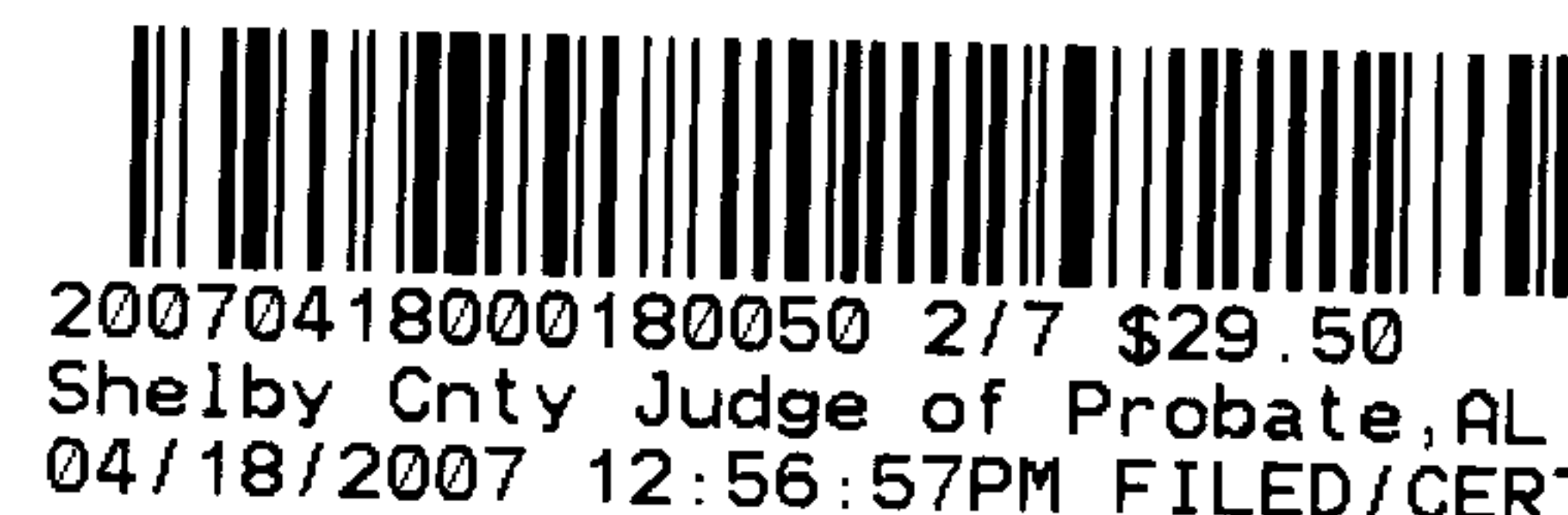



42095721  
86-11-11-11

70188960

**APPLICATION FOR PIPE OR WIRE OCCUPANCY**  
(Please fill out questions 1-7 and include these pages with your application)

Please answer all questions and return to:

DMJM+HARRIS  
260 South Broad Street  
Suite 1500  
Philadelphia, PA 19102  
(215) 735-0832  
Attn: NS Pipe and Wire Administrator

1) Legal Name and Address of Applicant (party to agreement)

Legal Name\*\*: ALABAMA POWER COMPANY  
Street: 600 NORTH 18TH STREET, P.O. BOX 2641  
City: BIRMINGHAM State: AL Zip: 35291

\*\*Please ensure that the exact legal name is provided with no abbreviations. This name will be used for agreement preparation, as well as the information below.

2) Applicant (party to agreement) is a:

- ☐ Corporation – give state of formation: Alabama  
☐ Limited Partnership – give state of formation: \_\_\_\_\_  
☐ General Partnership – give state of formation: \_\_\_\_\_  
☐ Sole Proprietorship – give state of formation: \_\_\_\_\_  
☐ Individual  
☐ Government Entity  
☐ Other: \_\_\_\_\_

3) Name and Address of Applicant's Representative:

Name: JERRY ROBERSON  
Title: CHIEF TECHNICAL SPECIALIST  
Company: ALABAMA POWER COMPANY  
Street: 600 NORTH 18TH STREET, P.O. BOX 2641  
City: BIRMINGHAM State: AL Zip: 35291  
Telephone: (205) 257-4643 Fax: (205) 257-1220  
E-Mail Address: JROBERSON@SOUTHERNCO.COM

4) Location of Proposed Facility:

City/Municipality: CALERA County: SHELBY State: AL  
Name of Closest Street Crossing of Railroad: HWY 29  
Street Grade Crossing AARDOT #: \_\_\_\_\_  
GPS Coordinates: Latitude \_\_\_\_\_ Longitude \_\_\_\_\_  
Footage (1320) and direction (N/S/E/W) from Railroad Mile Post No. 130.8  
or center of public Highway Crossing or Bridge \_\_\_\_\_  
(Name of Street)

DMJM+HARRIS

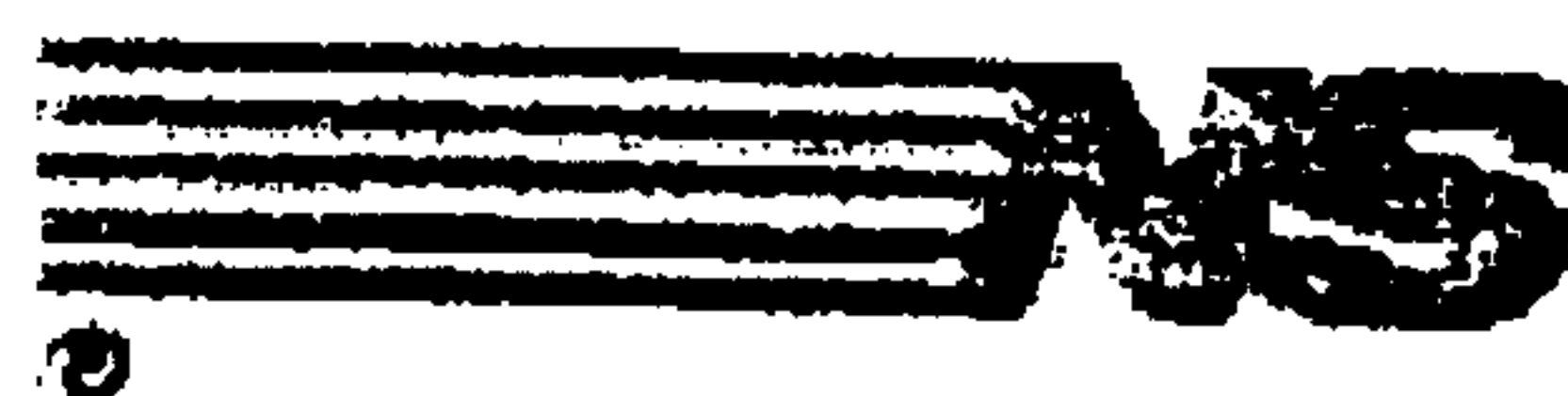

NORFOLK  
SOUTHERN



20070418000180050 3/7 \$29.50  
Shelby Cnty Judge of Probate, AL  
04/18/2007 12:56:57PM FILED/CERT

70188960

- 5) Will Facility be Located Entirely Within Confines of a Public Right of Way?  
( ) Yes \* (✓) No

\* If yes, provide conclusive evidence for verification in the form of a letter or memo from the appropriate Road Authority indicating that proposed installation is acceptable to the Road Authority

Street width: \_\_\_\_\_ Street Right of Way width: \_\_\_\_\_

Road Authority Responsible for Street Maintenance

Name: \_\_\_\_\_

Address: \_\_\_\_\_

Contact: \_\_\_\_\_

Telephone: \_\_\_\_\_

- 6) Proposed Facility to be Installed is a:

( ) New facility (✓) Upgrade of an existing facility\*

\*If an upgrade, please identify and attach copy of current agreement for the facility.

- 7) Proposed Installation/Construction Date(s): \_\_\_\_\_

If application is approved, applicant agrees to reimburse the Railroad for any cost incurred by the Railroad incident to installation, maintenance, and/or supervision necessitated by this pipeline or wireline installation, and further agrees to assume all liability for accidents or injuries which arise as a result of this installation.

October 25, 2006  
Date

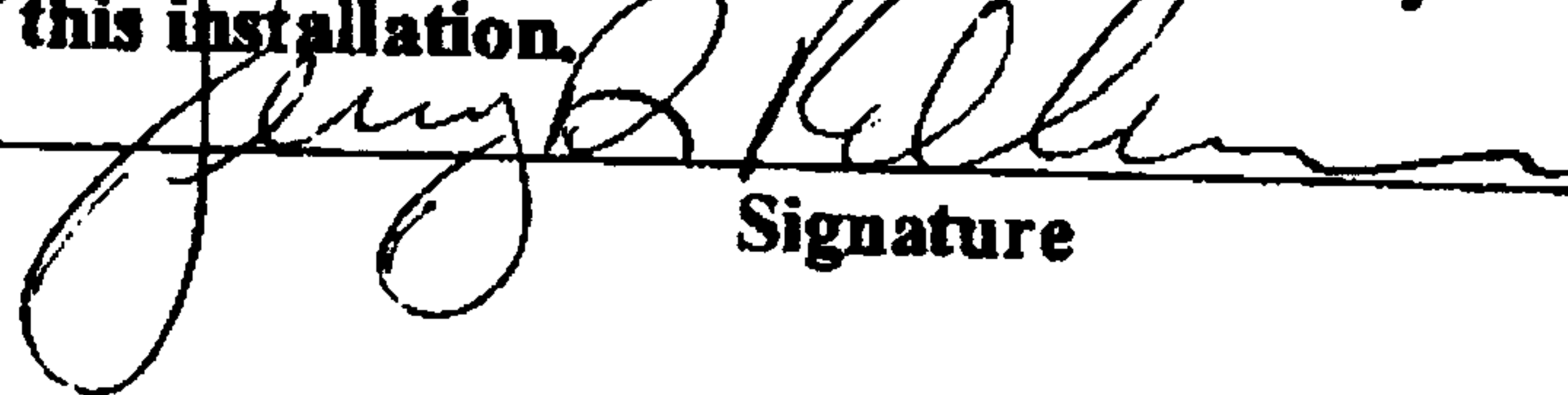
  
Signature

DMJM HARRIS

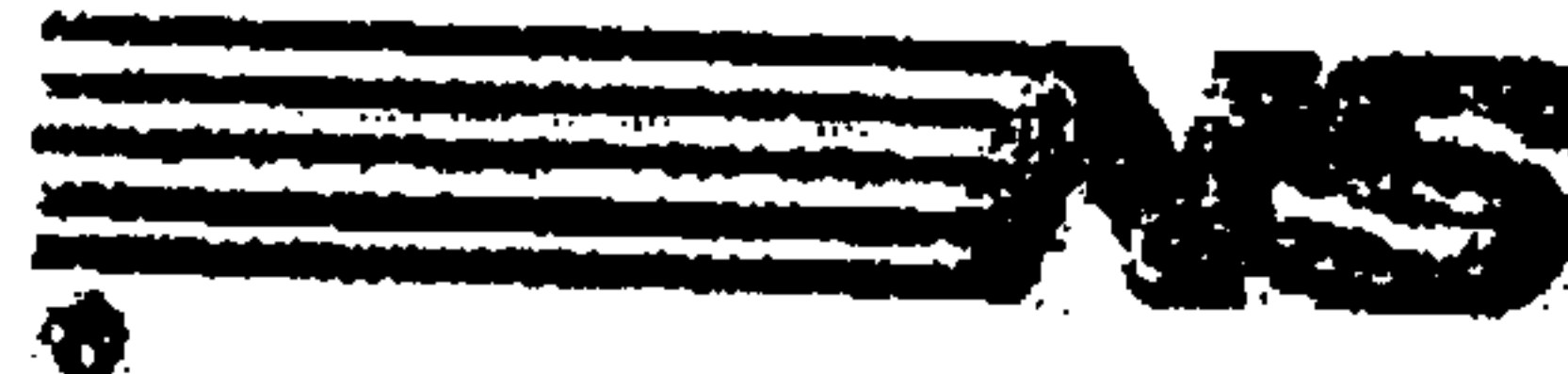

NORFOLK  
SOUTHERN



20070418000180050 4/7 \$29.50  
Shelby Cnty Judge of Probate, AL  
04/18/2007 12:56:57PM FILED/CERT



70188960

## Aerial Wire Lines or Cable Lines (Complete all Applicable Information)

- a. Type of Proposed Installation:
- i. ☒ Transverse Crossing Only
  - ii. ☐ Longitudinal (parallel to tracks) Occupancy Only
  - iii. ☐ Longitudinal and Transverse Crossing(s)
  - iv. ☐ Wire line in highway under railroad bridge
  - v. ☐ Wire line on highway bridge over railroad
- b. Type of wire: ( ) Cable TV ( ) Telephone ( ☒ ) Electric Power ( ) Fiber Optic ( ) Other – please specify: \_\_\_\_\_
- c. Will poles be located on Railroad Company's right of way?  
( ) Yes ( ☒ ) No
- d. Are the poles existing or new poles? Steel or wood poles?  
( ☒ ) Existing - ( ☒ ) Steel or ( ) Wood  
( ) New - ( ) Steel or ( ) Wood
- e. Will there be any guy wires on the Railroad right of way?  
( ) Yes, # of guy wires - \_\_\_\_\_ ( ☒ ) No
- f. Will wire line cross existing Railroad communication and/or signal lines?  
( ) Yes ( ☒ ) No
- g. Minimum height of wire above top of rail at 65oF 37 (ft.)  
Minimum height of wire above railroad communication and signal wires at 65oF \_\_\_\_\_ (ft.)
- h. Specification of Wire Line:  
Gauge of Wire: 3-795 26/7 ACSR + 3/8" H.S. STEEL  
Total Number of Wires: 4  
Material of Wire: ALUMINUM + STEEL  
Maximum circuit voltage (phase to ground): 69,000 VOLTS  
Total Number of Fibers or pairs in FOC: \_\_\_\_\_  
Cable type and capacity: 795 ACSR - 900 AMPS

All wire line applications shall include a Plan and Profile View of the proposed facility. See the NSCE-4 for the required format. Below is a suggested check-list for your plan development.

### Plan View (See NSCE-4 Specification, Plate I)

- ☒ All railroad tracks
- ☒ Indicates distance (in feet) to Norfolk Southern Mile Post or Grade Crossing
- ☒ Angle of Crossing relative to railroad track(s)
- ☒ Dimensioned Property Lines
- ☒ Location of Poles and distance to butt of pole to nearest railroad track centerline
- ☒ Location of all existing railroad pole lines and all utility lines
- ☒ Indicate span length across tracks from pole to pole
- ☒ Location of Railroad pole lines or signal facilities
- ☒ Location of any above ground utilities

DMJM ■ ■ HARRIS

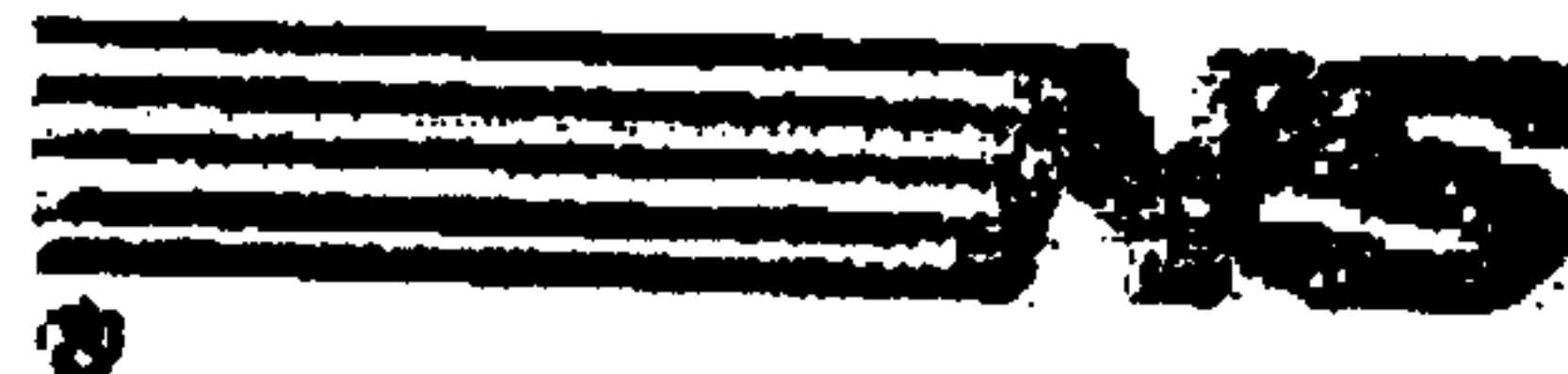
NORFOLK  
SOUTHERN

20070418000180050 5/7 \$29.50  
Shelby Cnty Judge of Probate, AL  
04/18/2007 12:56:57PM FILED/CERT

70188960

☒ If proposed wire line is within highway limits or in the vicinity of a grade crossing, location and type of grade crossing traffic control devices (Mast flashers, cantilever flashers, gates, etc.) and clearance from existing devices to proposed wire line

Cross Section View (See NSCE-4 Specification, Plate II)

- ☐ All railroad tracks
- ☐ Dimensioned Property Lines
- ☐ Location of Poles and distance to butt of pole to nearest railroad track centerline
- ☐ Vertical clearance from top of rail of all tracks to bottom of sag
- ☐ Location of all existing railroad pole lines and all utility lines
- ☐ Vertical clearance from existing railroad pole lines and proposed wire line
- ☐ Indicate span length across tracks from pole to pole
- ☐ If proposed wire line is within highway limits or in the vicinity of a grade crossing, location and type of grade crossing traffic control devices (Mast flashers, cantilever flashers, gates, etc.) and clearance from existing devices to proposed wire line

DMJM HARRIS

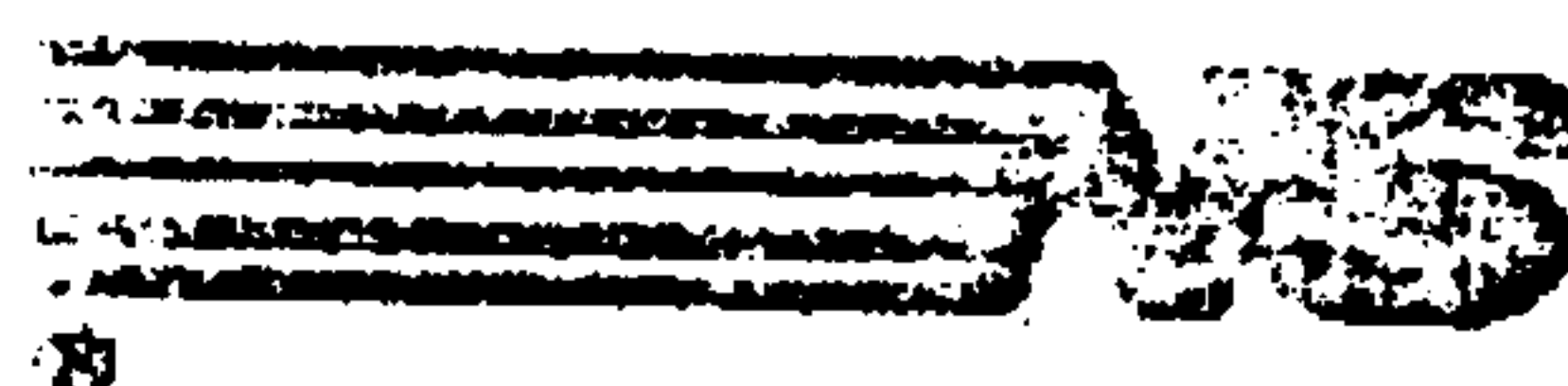

NORFOLK  
SOUTHERN



20070418000180050 6/7 \$29.50  
Shelby Cnty Judge of Probate, AL  
04/18/2007 12:56:57PM FILED/CERT



SHELBY COUNTY  
T-22-S, R-2-W  
S.E. 1/4 OF N.E. 1/4 SECTION 21

70188960

NOTE: THIS IS AN EXISTING CROSSING WITH NEW CONDUCTORS BEING INSTALLED!!

INSTALL (1) 3/8" H.S. STEEL SHEILD WIRES

INSTALL (3) 795 KCMIL 26/7 ACSR

CALERA, AL.  
120-3-524  
Sou. Rwy. 11-84/28

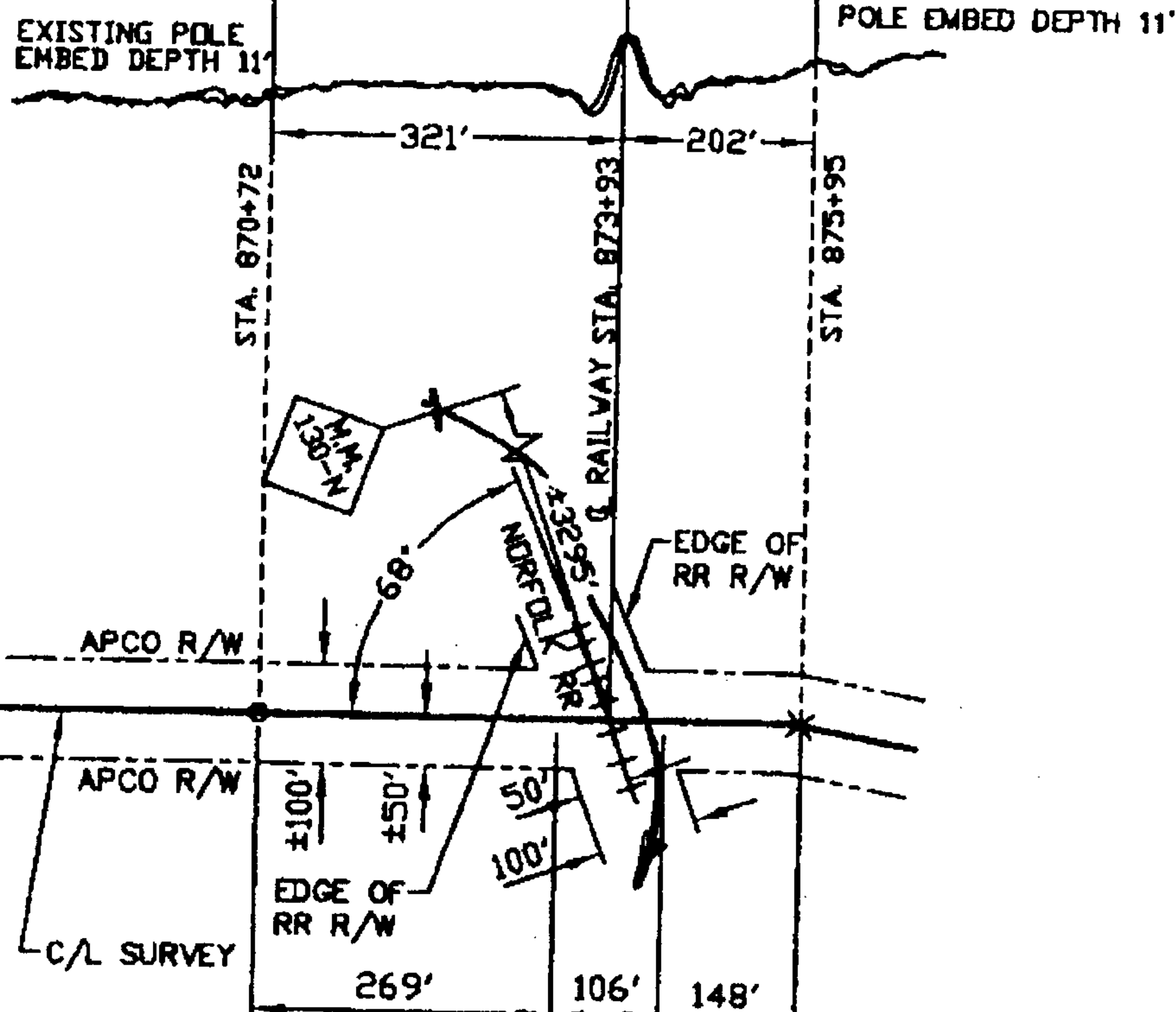
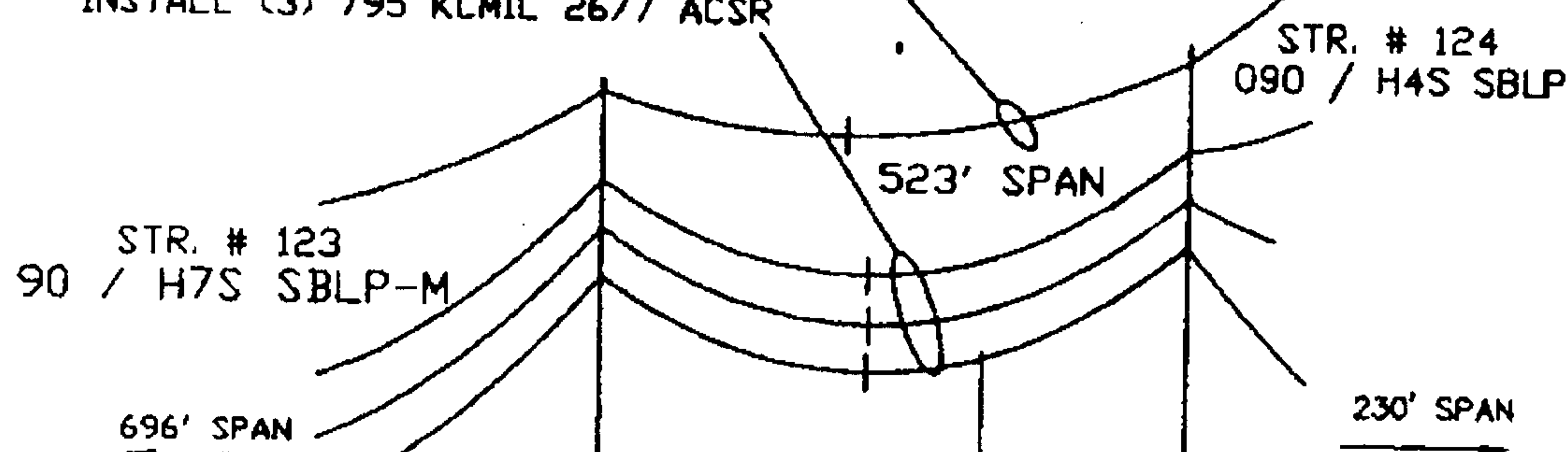

DESIGN SPECIFICATIONS:  
1) STRUCTURES DESIGNED FOR NESC 2002 MEDIUM LOADING, GRADE B CONSTRUCTION.  
2) CLEARANCES SHOWN AT 100°C FINAL SAG.  
3) STRUCTURES ARE STEEL OR CONCRETE SINGLE POLE STRUCTURES

ACC LINE NAME:  
ACC LINE NUMBER:  
SD. DIV. DIVISION LINE NAME:  
SD. DIV. DIVISION LINE NUMBER:  
ACC LINE NAME:  
ACC LINE NUMBER:  
B'HAM DIV. DIVISION LINE NAME:  
B'HAM DIV. DIVISION LINE NUMBER:

CALERA - LAY DAM  
202  
LAY DAM - BESSEMER STR. #62  
125000  
CALERA - LAY DAM  
202  
LAY DAM - BESSEMER 115KV (SOUTHERN SECTION)  
1212A0A

LEGEND:  
● DENOTES POLE TO BE RETIRED  
X DENOTES POLE TO BE INSTALLED  
○ DENOTES EXISTING POLE  
— DENOTES GUY & ANCHOR TO BE RETIRED  
- - - DENOTES GUY & ANCHOR TO BE INSTALLED

COMPUTER PREPARED DRAWING. MAKE  
NO MANUAL CHANGES. RETURN TO  
POWER DELIVERY TRANSMISSION

CAD  
CV  
MEDUSA  
REV. 14.1

DR	WRP	NO.	DATE	REVISION
DA	6/15/05	01	07/29/05	STR. NO. CHANGE
CK	JRM	02	10/19/06	ADDED R/W DIM'S
APP				
DATE	6/15/05	SUPERSEDES		

ALABAMA POWER COMPANY

SUBJECT LAY DAM H.P.-CALERA T.S. TAP RECONDUCTOR  
DETAIL NORFOLK RAILROAD CROSSING  
BETWEEN STR. #123 AND STR. #124

SCALE V: 1"=30' H: 1"=300' SH. 01 OF 01 SHEETS

A-403998

A-403998-001-02

P/L 37260AX TYPE X2

Shelby County, AL 04/18/2007  
State of Alabama

Deed Tax: \$.50



20070418000180050 7/7 \$29.50  
Shelby Cnty Judge of Probate, AL  
04/18/2007 12:56:57PM FILED/CERT