

NOTICE OF LIS PENDENS

IN THE PROBATE COURT OF SHELBY COUNTY, ALABAMA

SHELBY COUNTY, ALABAMA, a
political subdivision of the State of
Alabama,

Plaintiff,

vs.

CASE NO. PR 2007- 000159

JANE SHAW ETHEREDGE; JOEL H. ETHEREDGE; DONALD ARMSTRONG,
in his official capacity as Property Tax
Commissioner of Shelby County, Alabama;
BLANK COMPANY, a corporation, the
owner of the property described in the
Complaint; **JOHN DOE** and **MARY DOE**, the
persons who own the property described in the
Complaint, or some interest therein; **BLANK
COMPANY**, the entity which is the
mortgagee in a mortgage on the above-
described property or claims some lien or
encumbrance against the same, all of whose
names are otherwise unknown but whose true
names will be added by amendment when
ascertained,

Defendants.

TO THE HON. PATRICIA YEAGER FUHRMEISTER, JUDGE OF PROBATE OF SHELBY
COUNTY, ALABAMA:

Comes now Shelby County, Alabama, a political subdivision of the State of Alabama, by its
attorney, and files herewith notice to all persons concerned that on the 19 day of **March, 2007**,
condemnation proceedings were commenced in the Probate Court of Shelby County, Alabama,
whereby said Shelby County, Alabama, a political subdivision of the State of Alabama, seeks to
obtain certain ownership to real property, easements, and public rights of way and other rights, and
said proceedings are now pending.

The name of the property owner concerned, together with the property sought to be
condemned, is as set forth below:

Property Owner(s): Jane Shaw Etheredge; Joel H. Etheredge; Donald Armstrong, in his official capacity as Property Tax Commissioner of Shelby County, Alabama.

Property described on Exhibit "A" attached hereto and made part and parcel hereof as fully as if set out herein.

Description of above property is taken from right of way map of said project on file in the office of Shelby County Water Services, 200 West College Street, Columbiana, Alabama, and in the Office of the Probate Judge of Shelby County, Alabama.

The title of the action and the case number thereof are as hereinabove designated.

SHELBY COUNTY, ALABAMA,
a political subdivision of the State of Alabama

By 
Attorney for said Plaintiff

STATE OF ALABAMA
SHELBY COUNTY

IN THE PROBATE COURT OF SHELBY COUNTY, ALABAMA

I hereby certify that the within Lis Pendens was filed in this office for record on the _____ day of March, 2007, at _____ o'clock _____ .m. and duly recorded as Instrument No. _____, and examined.

Judge of Probate

20070319000124730 3/4 \$.00
Shelby Cnty Judge of Probate, AL
03/19/2007 03:02:05PM FILED/CERT

Tract Sketch (not to scale):

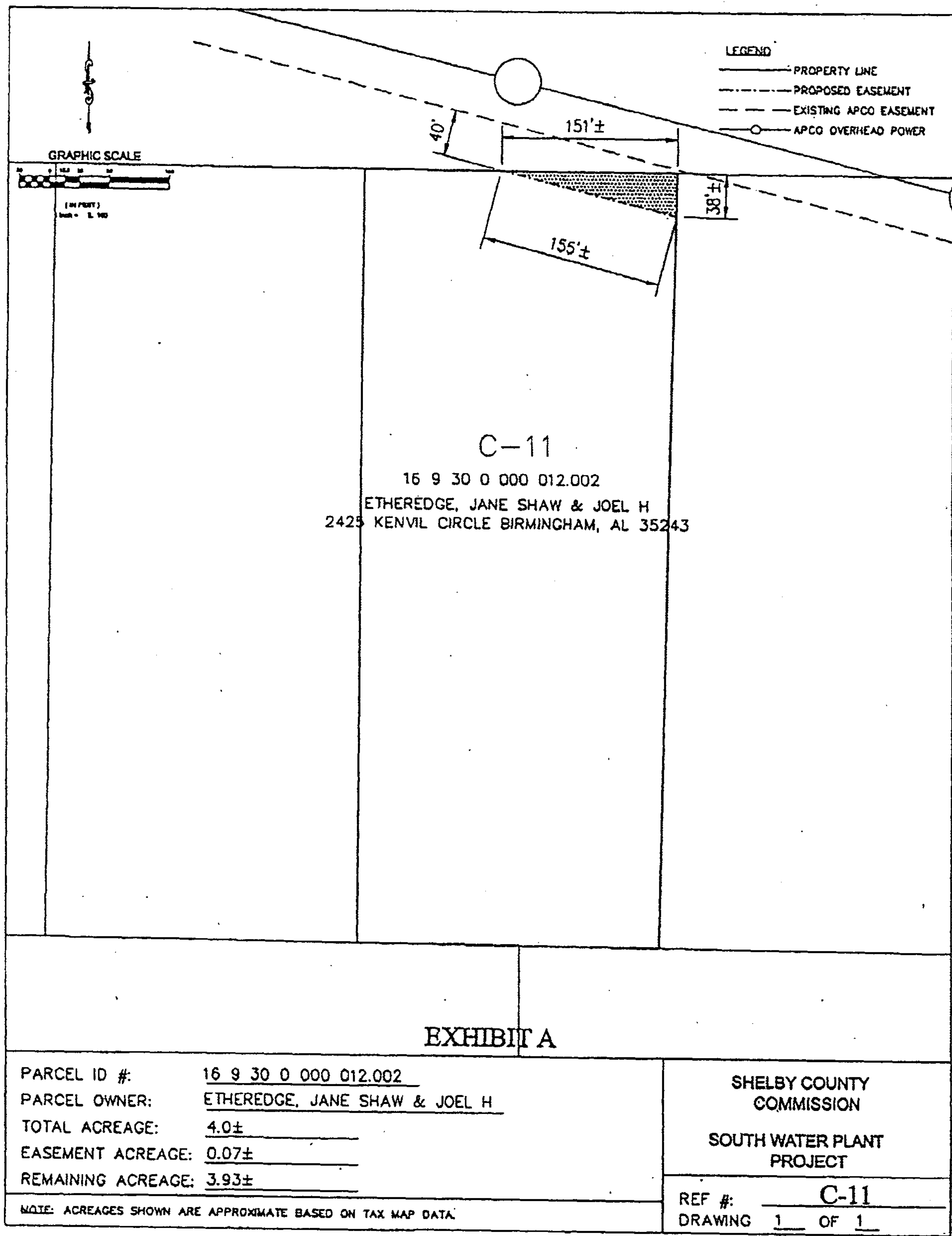

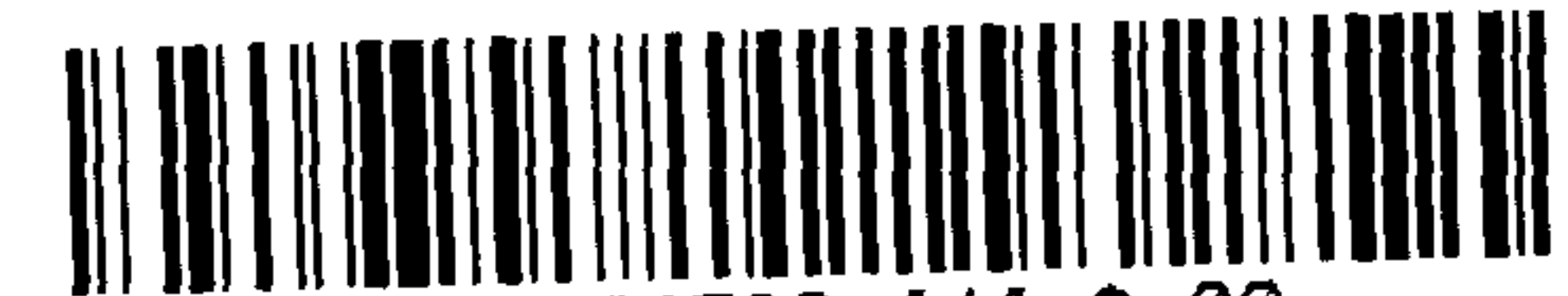

20070319000124730 4/4 \$.00
Shelby Cnty Judge of Probate, AL
03/19/2007 03:02:05PM FILED/CERT

Project Easement Reference: C11

Shelby County Parcel ID 16-9-30-0-000-012.002

Owner of Record To Be Determined By County Attorney

Description:

A 40 foot utility easement for a water line situated in the North half of Section 30, Township 20 South, Range 1 East, Shelby County, Alabama, Lying South of, parallel with and adjacent to a 100 foot Alabama Power Transmission Main right-of-way, and within the property recorded in Deed Book 309 Page 257 in the Office of the Probate Judge of Shelby County, Alabama containing 0.07 acres more or less.